

A&N Model Trucks



FRENCH TRUCK T HIGH Conversion kit, scale 1/24

Warning!

Read carefully this instruction and please follow it during assembling, otherwise you could face problems with assembling the model.

Photo-etched parts have sharp edges, please be careful.

This model kit contains very small parts and is not suitable for children. THIS IS NOT A TOY!

This kit requires chassis - Italeri Volvo FH4 recommended.

Symbols:

 - glue parts;

 - do not glue parts;

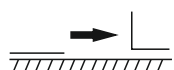
 - bend parts;

 - attention;

 - moving parts;

 - your choice;

 - cut;

 - drill;

1. 

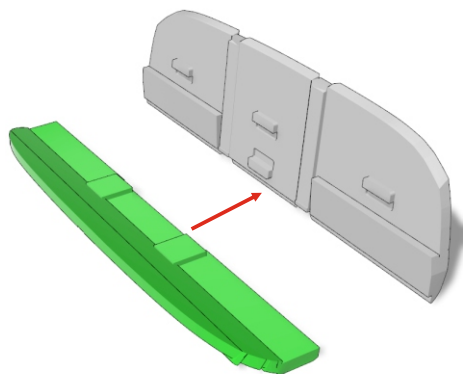

2. 

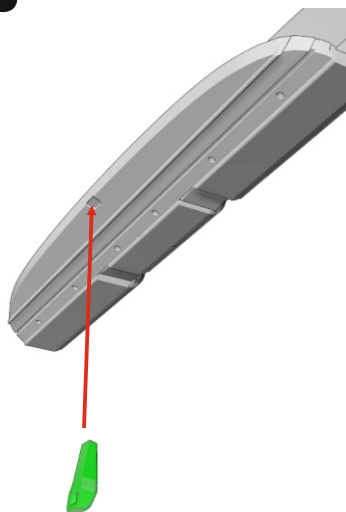

3. 

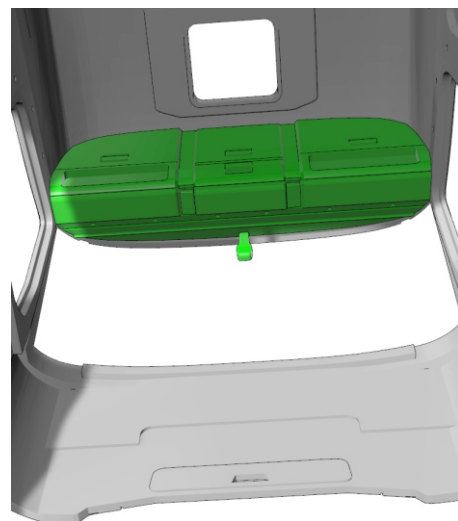

4. 

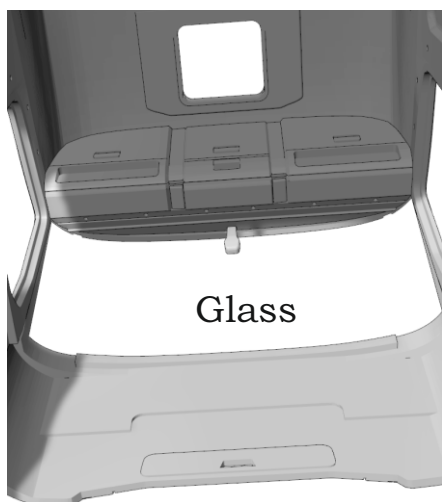

5.  x2

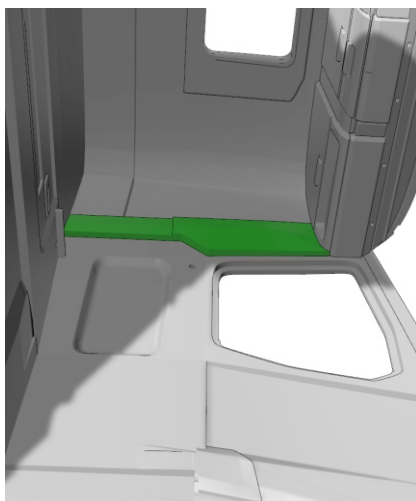

6.  x2

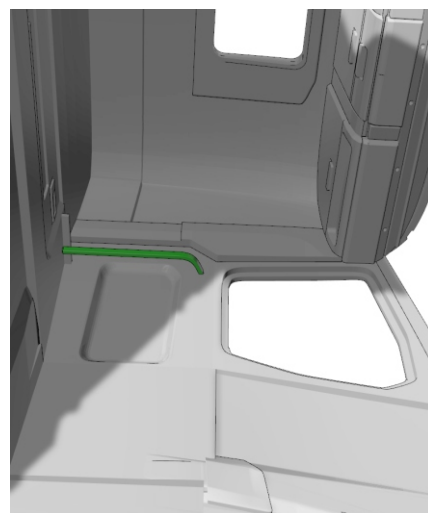

7. 

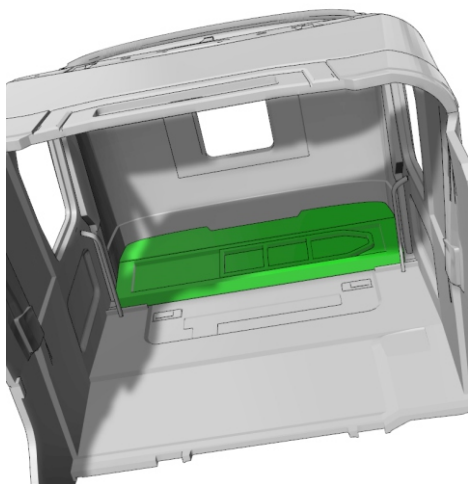

8.  x2

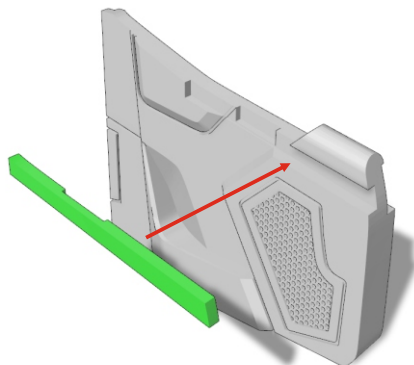

9.  x2



10.  x2

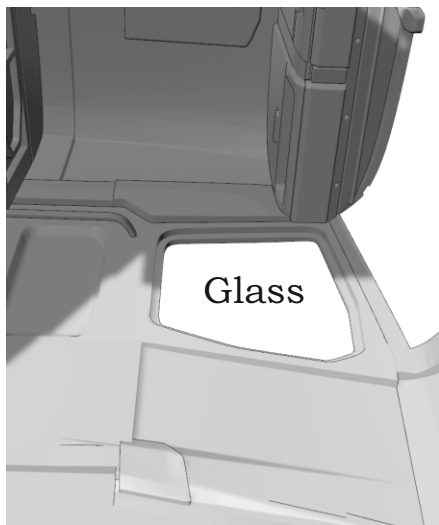

11.  x2

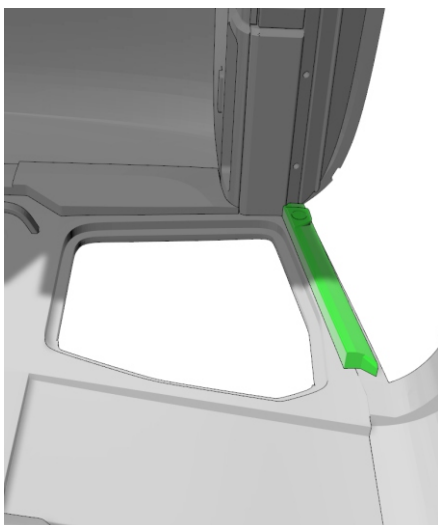

12.  x2

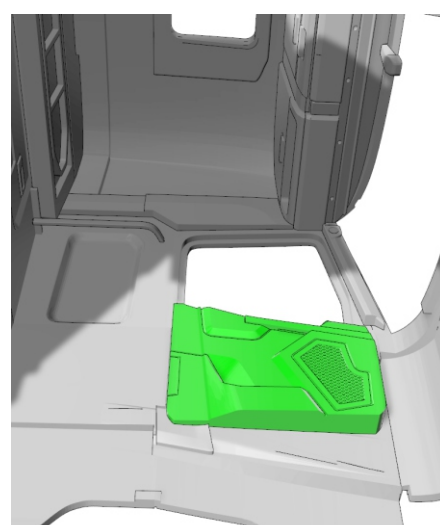

13. 

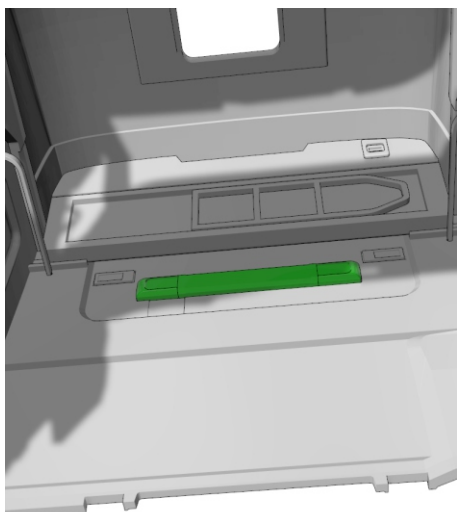

14. 

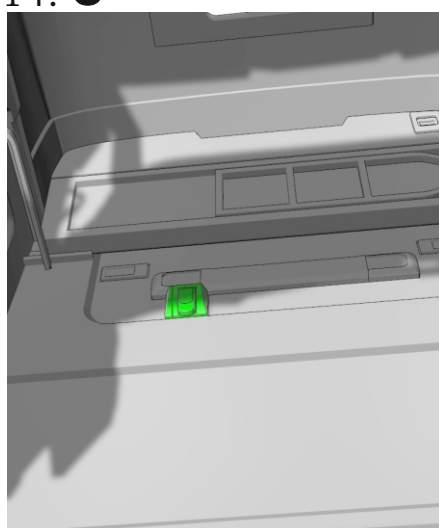

15. 

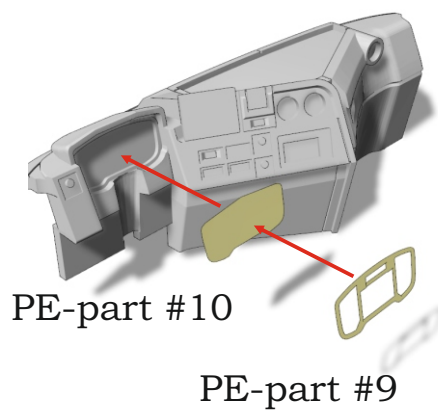

16. 

PE-part #13

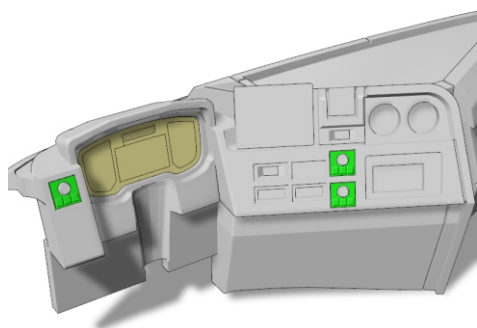

17. 

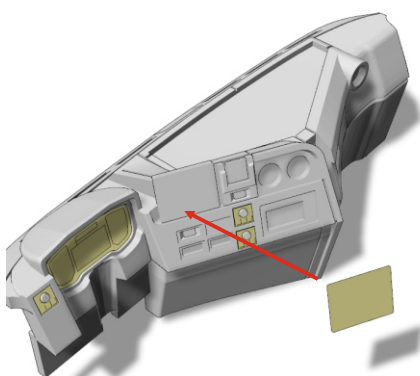

PE-part #14

18.  x2

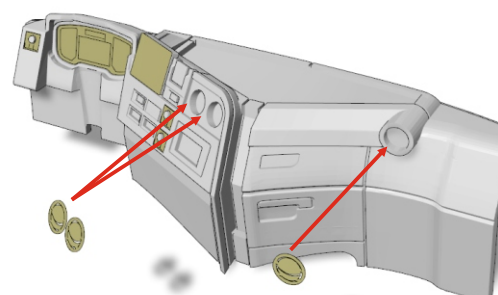

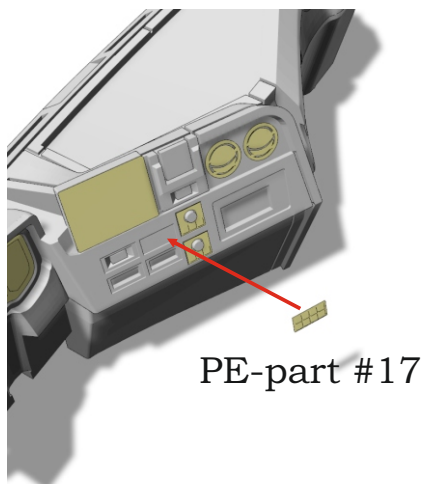

PE-part #3

19. 

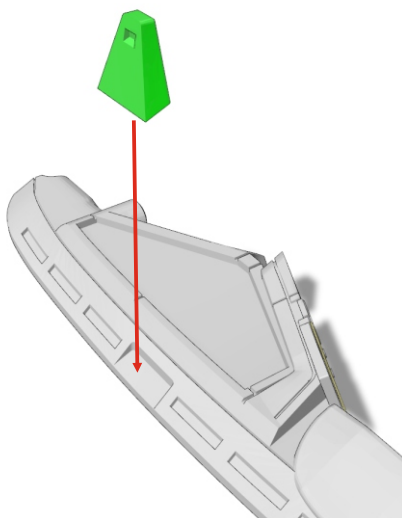

20. 



21. 

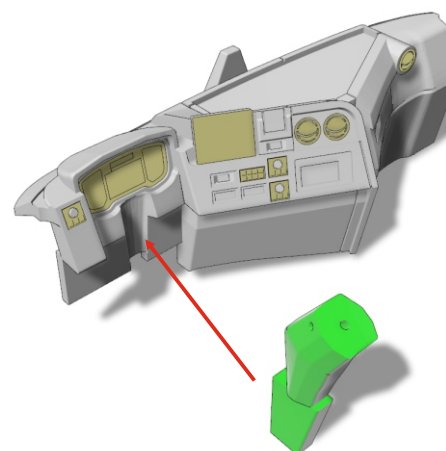

22. 

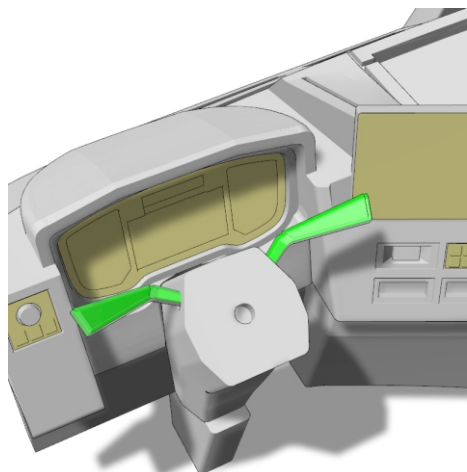

23. 

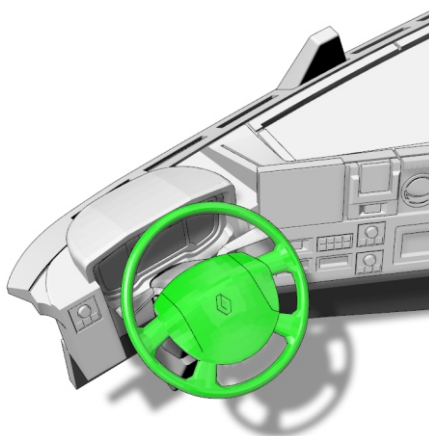

24. 

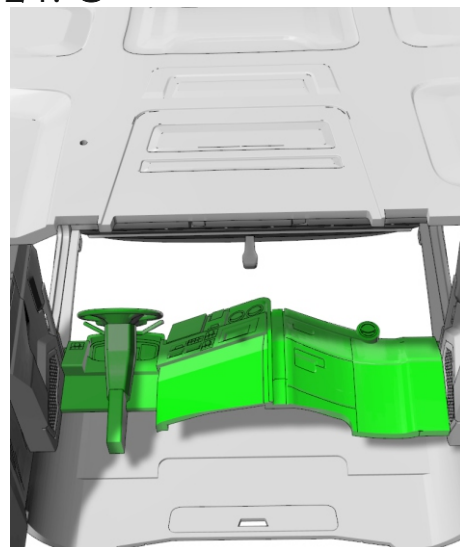

25.  x2



Seatbelt

26.  x2

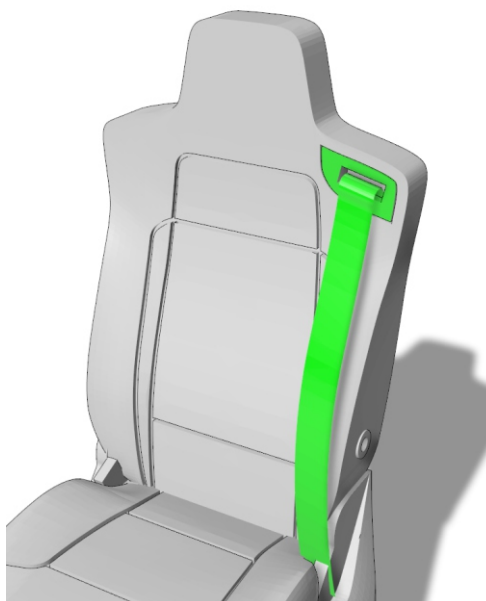

27.  x2



28.  x2

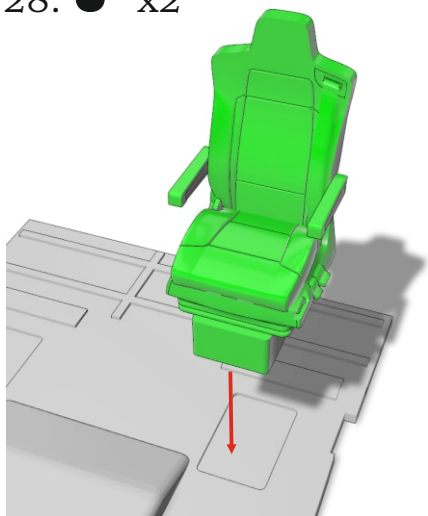

29. 

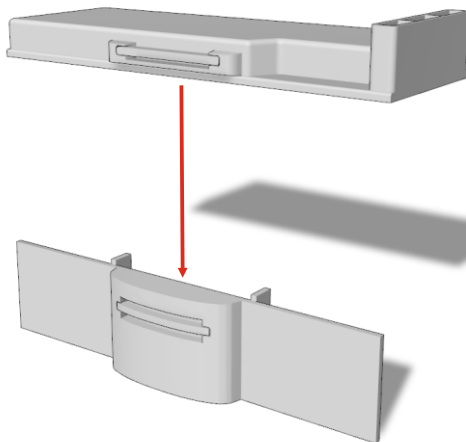

30. 

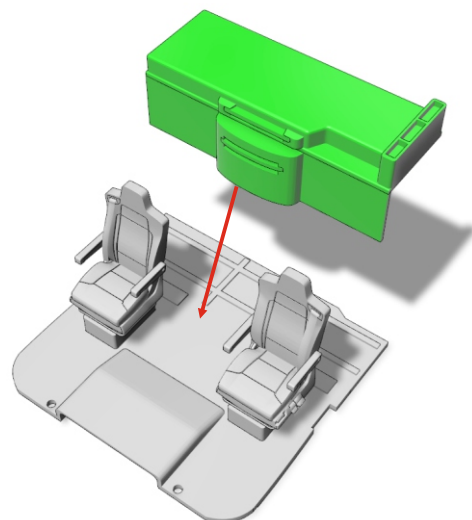

31. 

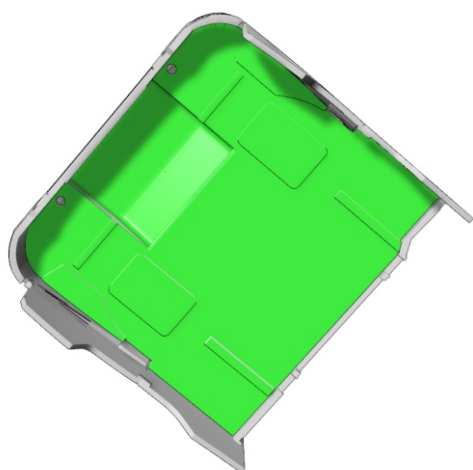

32.  x4

PE-part #7

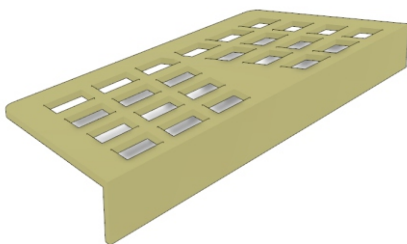

33.  x2

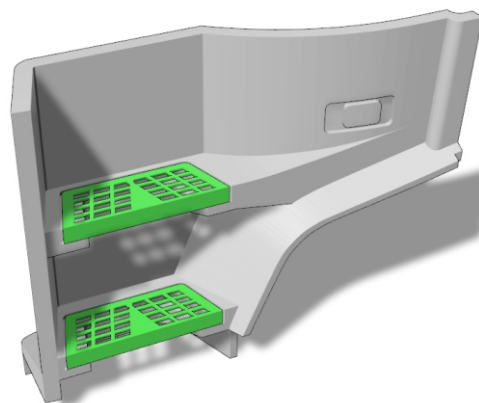

34.  x2

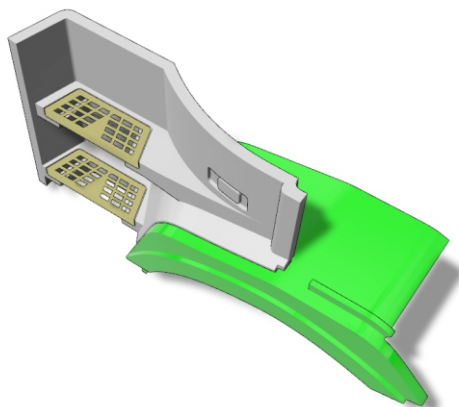

35.  x2

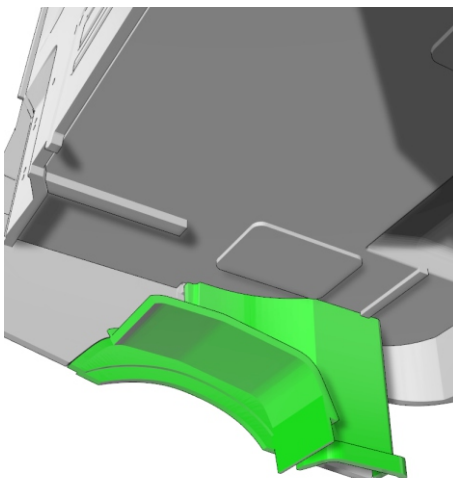

36.  x2

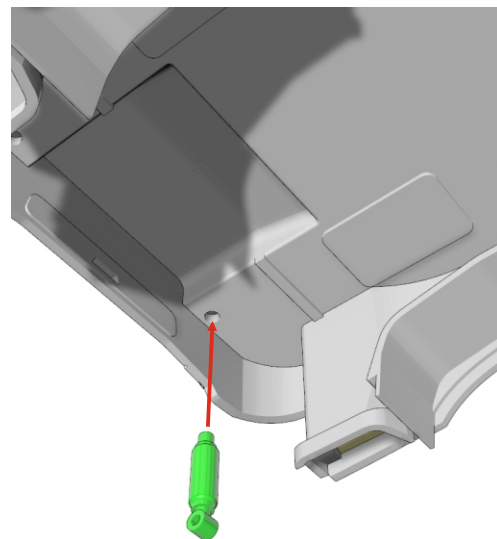

37. 

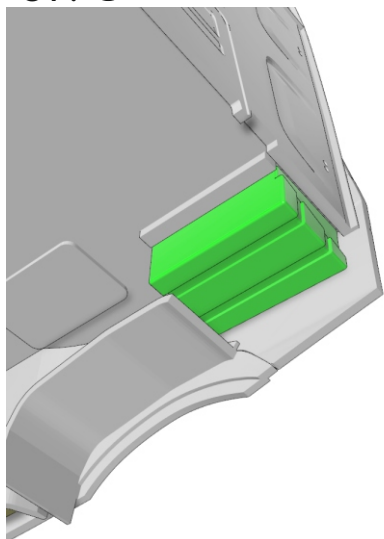

38.  x2

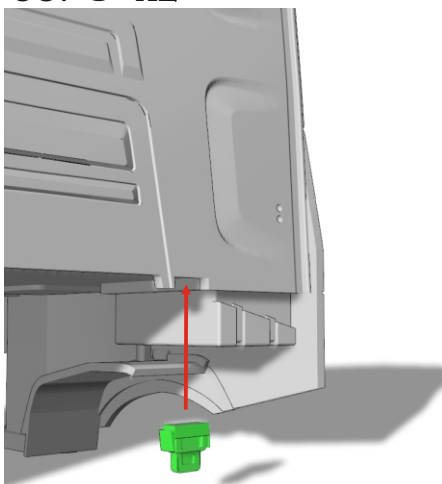

!

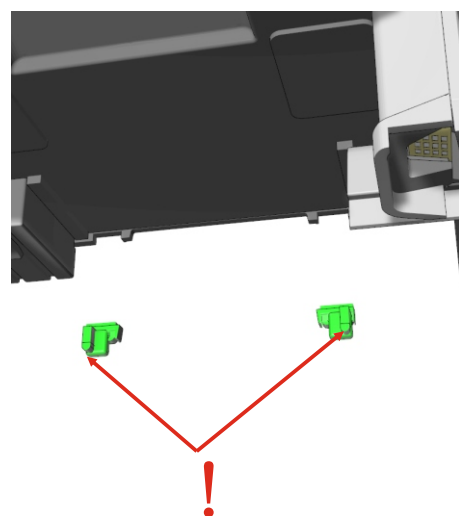

39. 

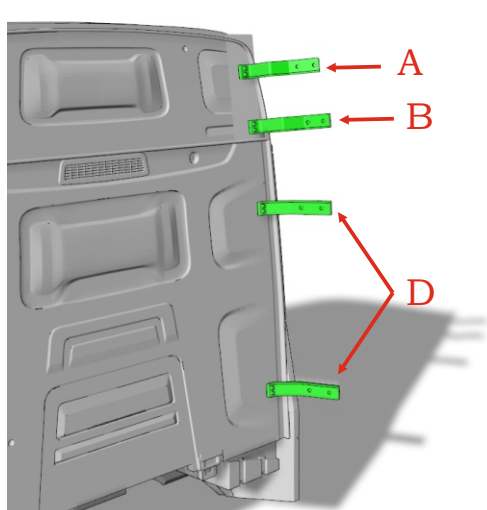

40. 

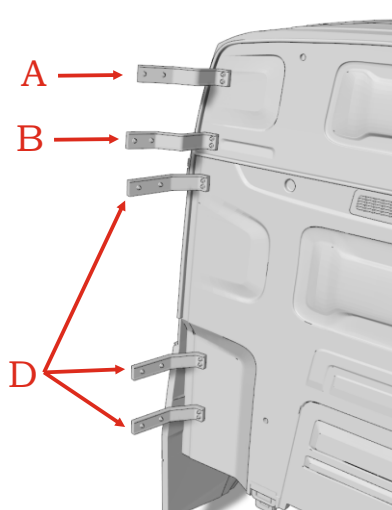

41. 

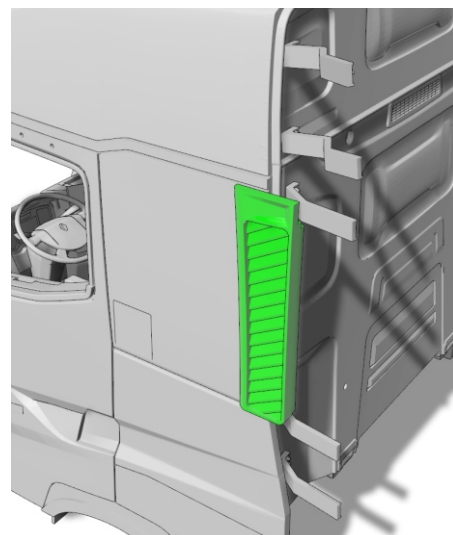

42. 

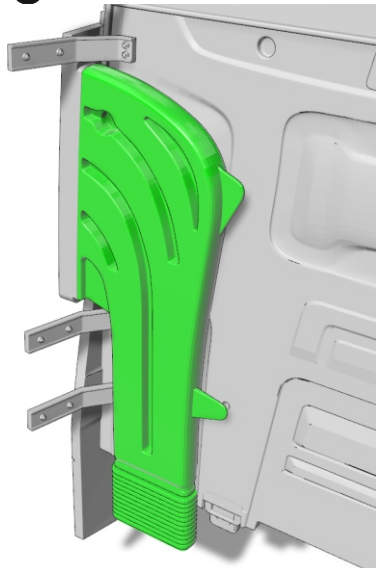

43. 

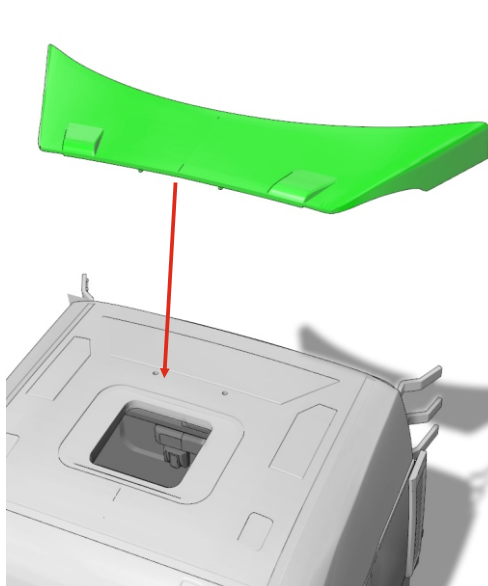

44.  x2

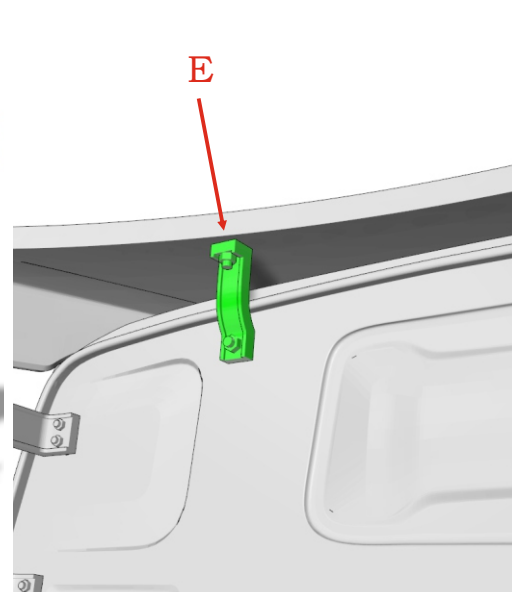

45. 

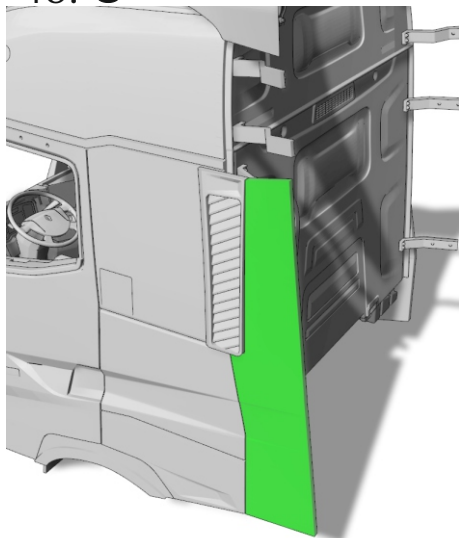

46. 

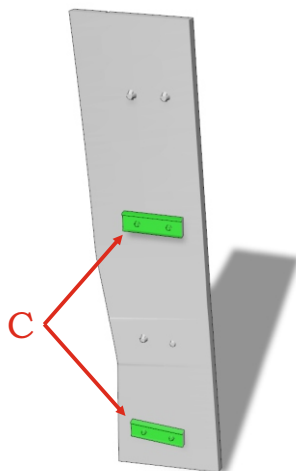

47. 

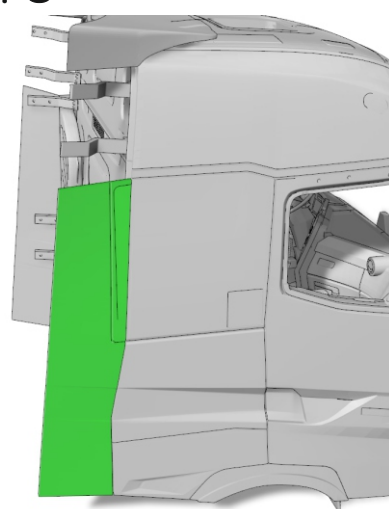

48.  x2

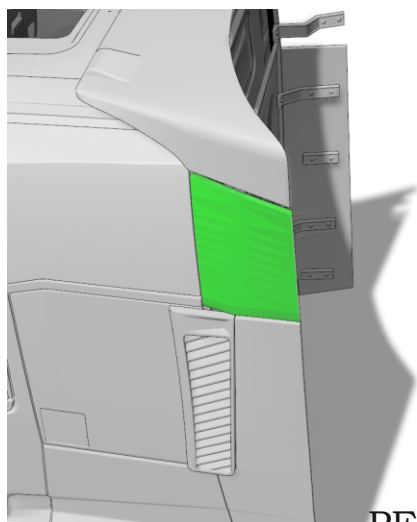

49.  x2 PE-part #16

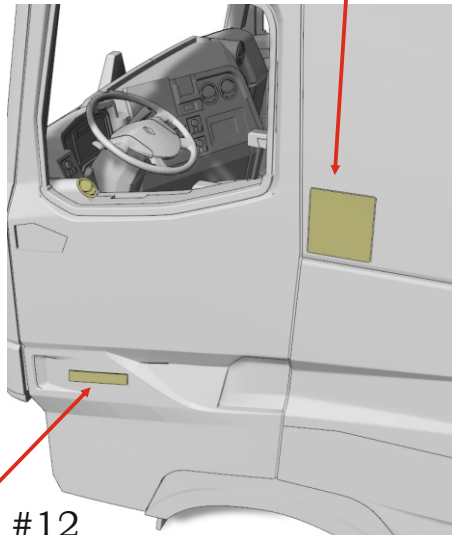

50.  x2

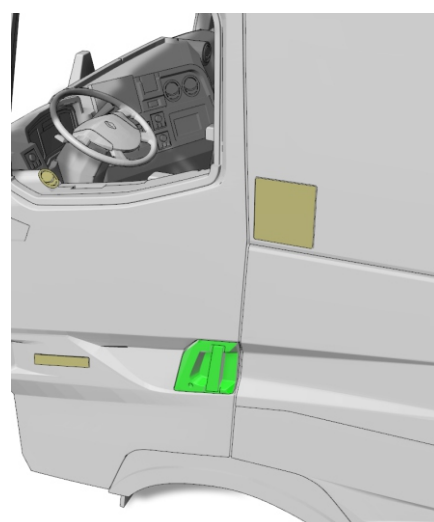

51.  x2

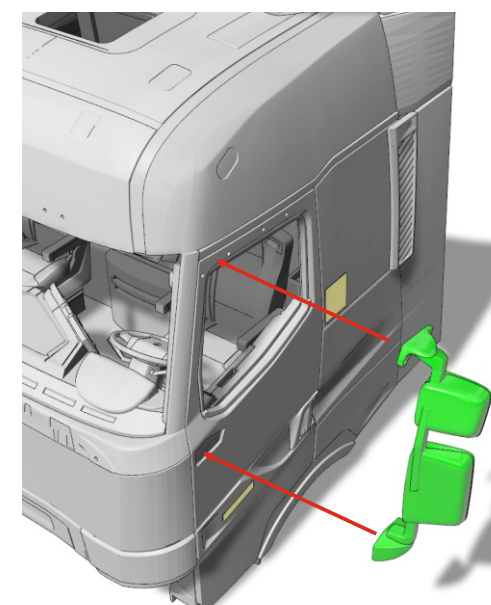

52.  x2

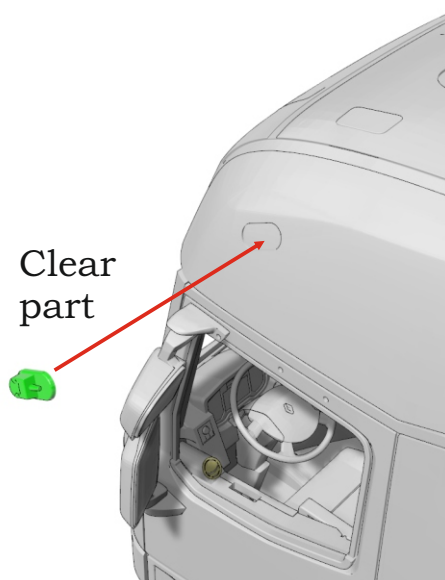

53. 

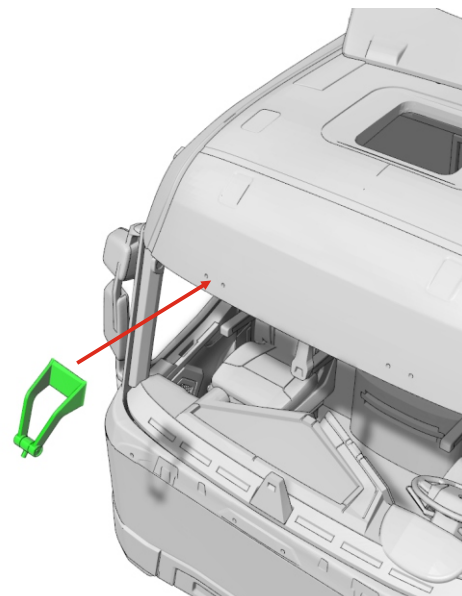

54. 

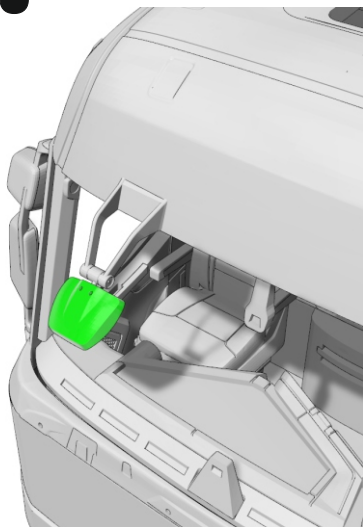

55. 



56. 

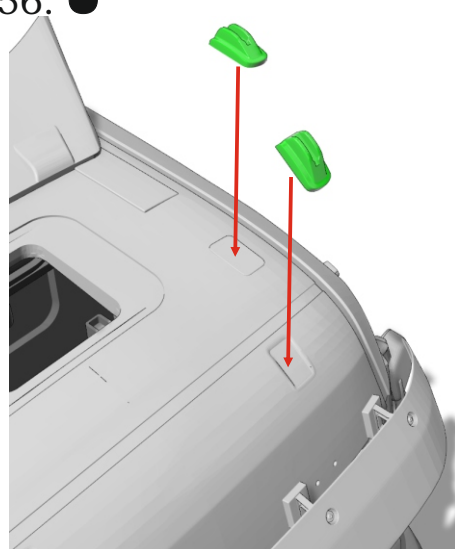

57. 

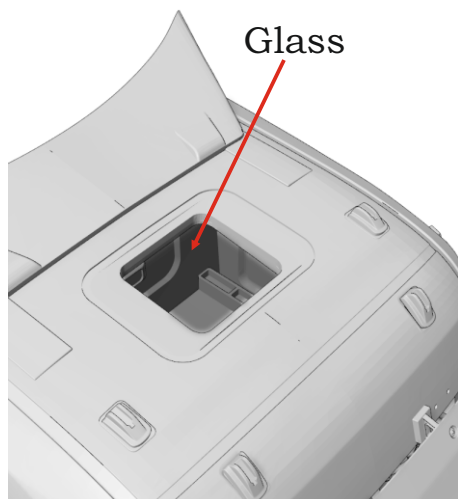

58.  x2

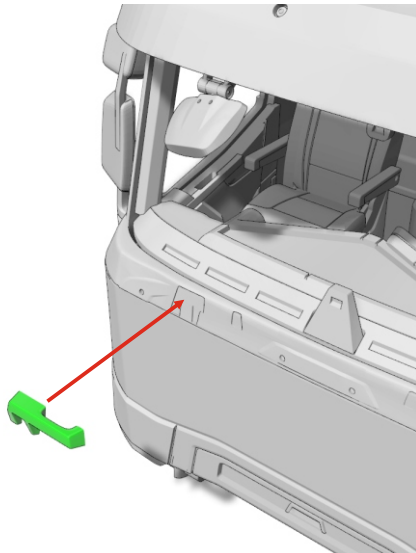

59.  x2

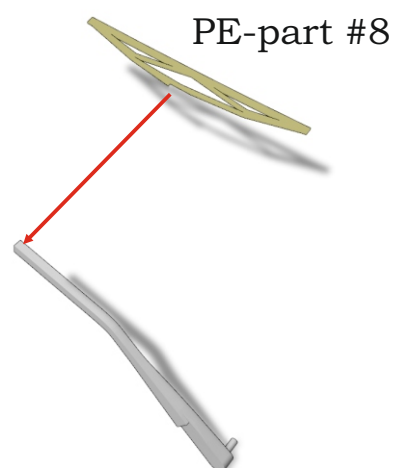

60. 

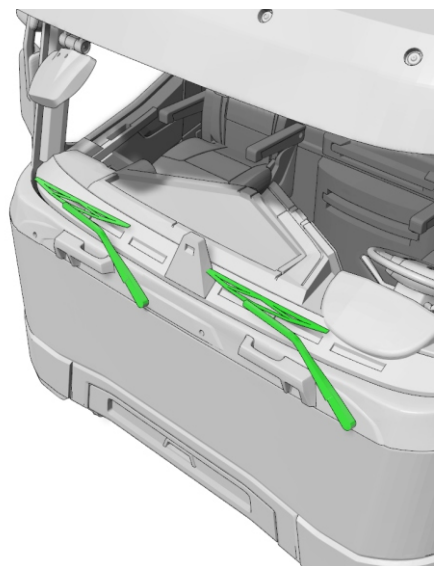

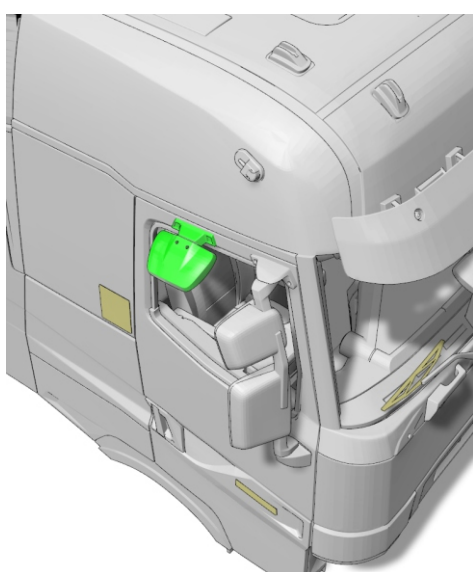

61. 

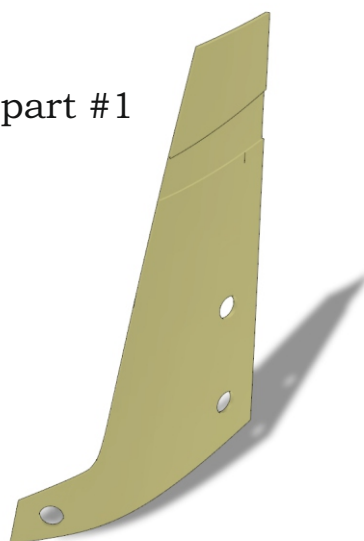

62. 

PE-part #1



63. 

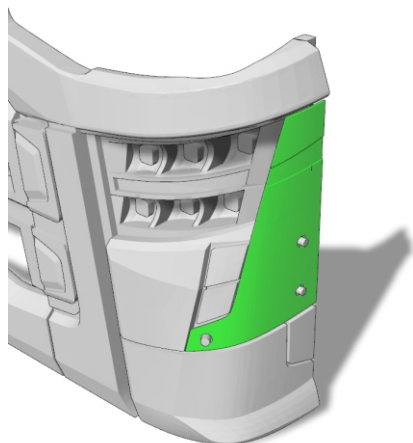

64. 

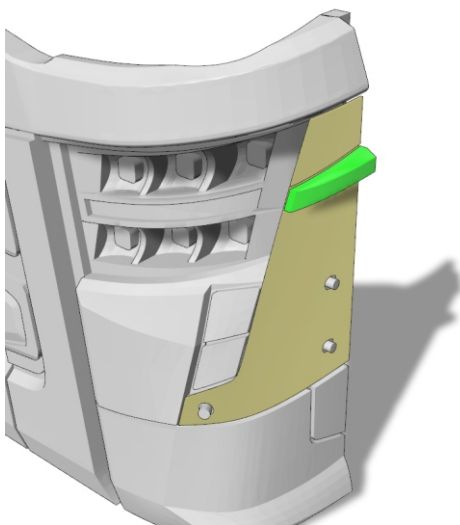

65. 

Repeat steps 62-64
for right side

66. 

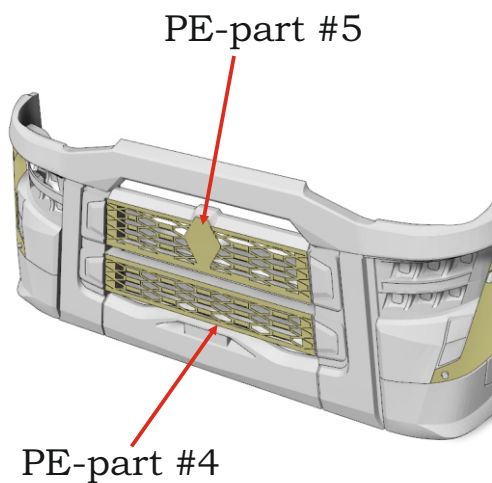

67. 

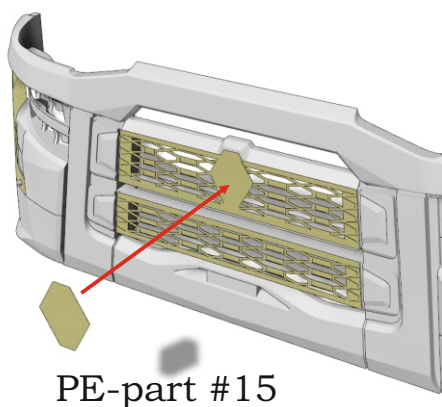

68.  x2

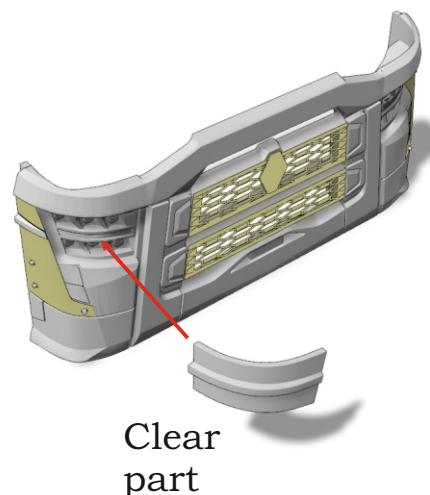

69.  x2

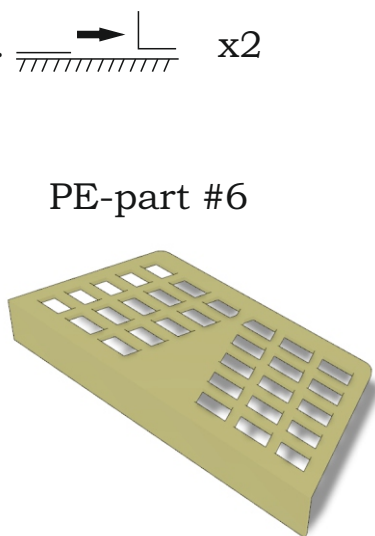

70.  x2

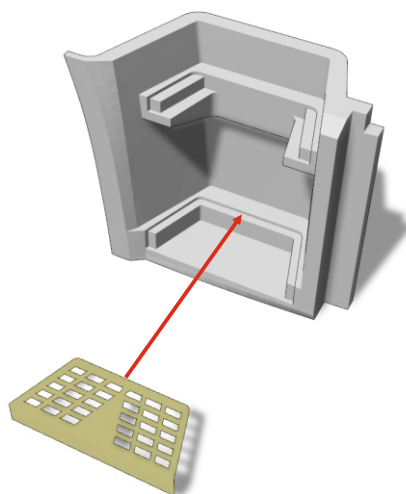

71.  x2

PE-part #7

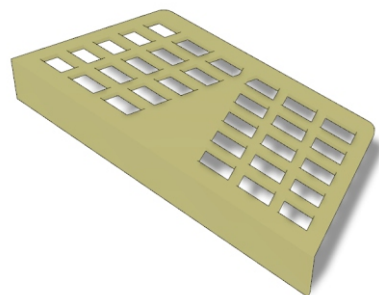

72.  x2

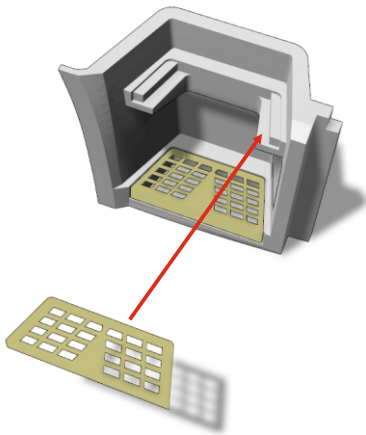

73.  x2

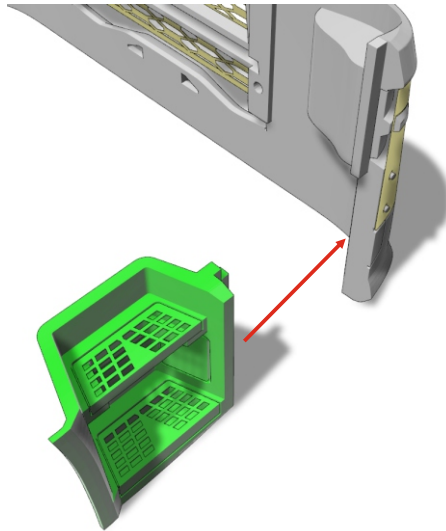

74.  x2

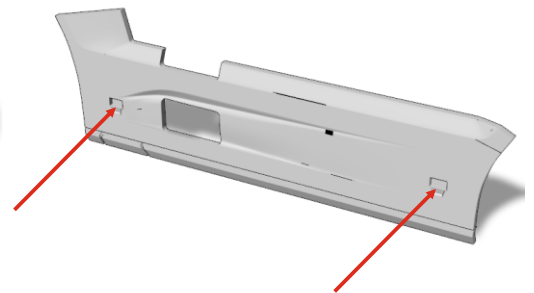

Italeri 10h parts

75.  x2

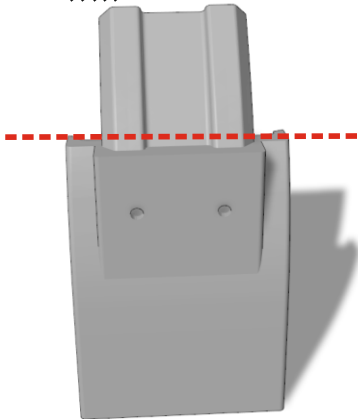

Italeri 63e parts

76. 

Mount all parts
on donor chassis.