

A&N Model Trucks

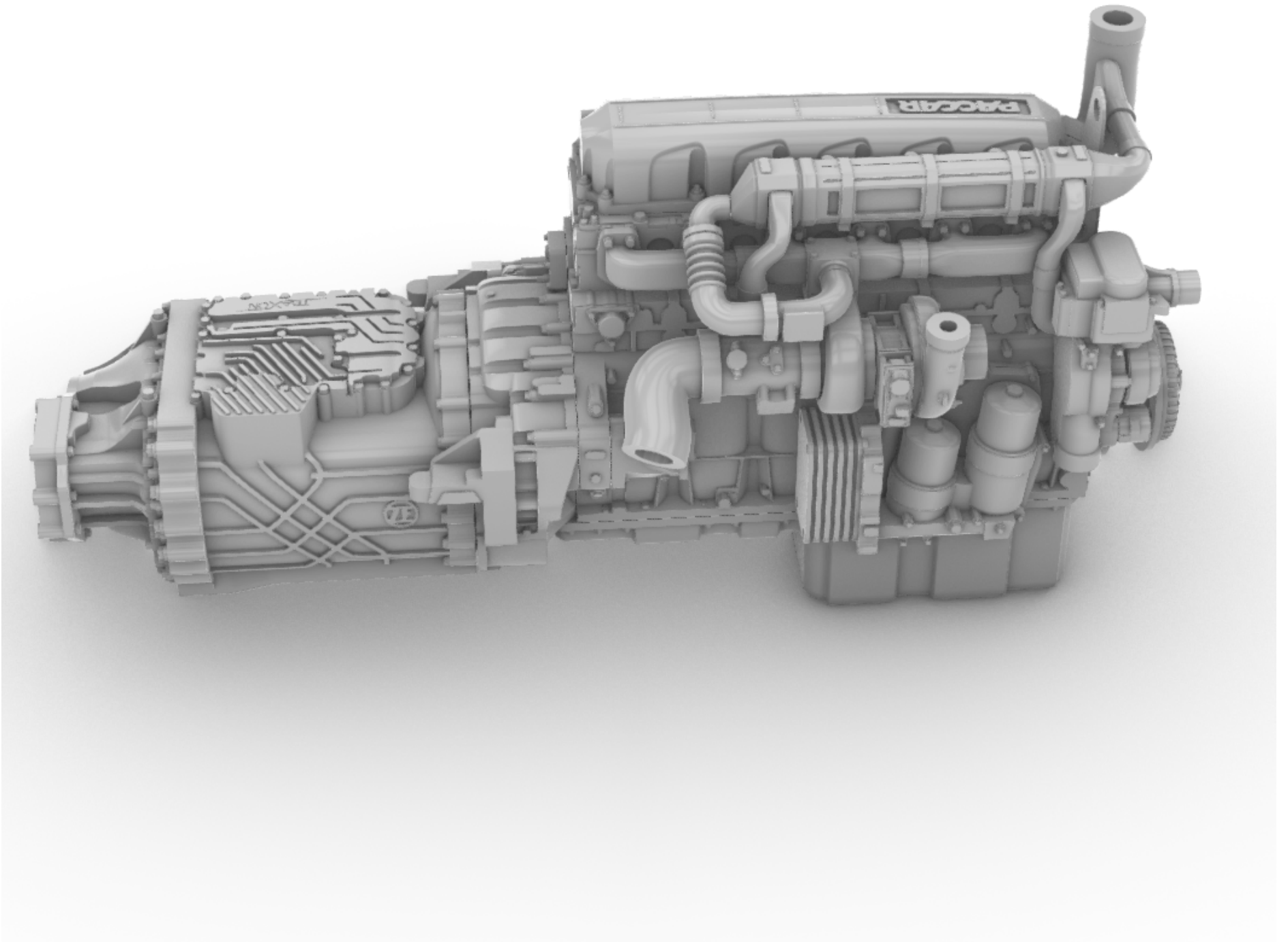

MX-13 ENGINE

Resin kit, scale 1/24

Made in Latvia
© 2024 A&N Model Trucks

Warning!

Read carefully this instruction and please follow it during assembling, otherwise you could face problems with assembling the model.

Photo-etched parts have sharp edges, please be careful.

This model kit contains very small parts and is not suitable for children. THIS IS NOT A TOY!

Symbols:

- - glue parts;
- - do not glue parts;
- - bend parts;
- ! - attention;

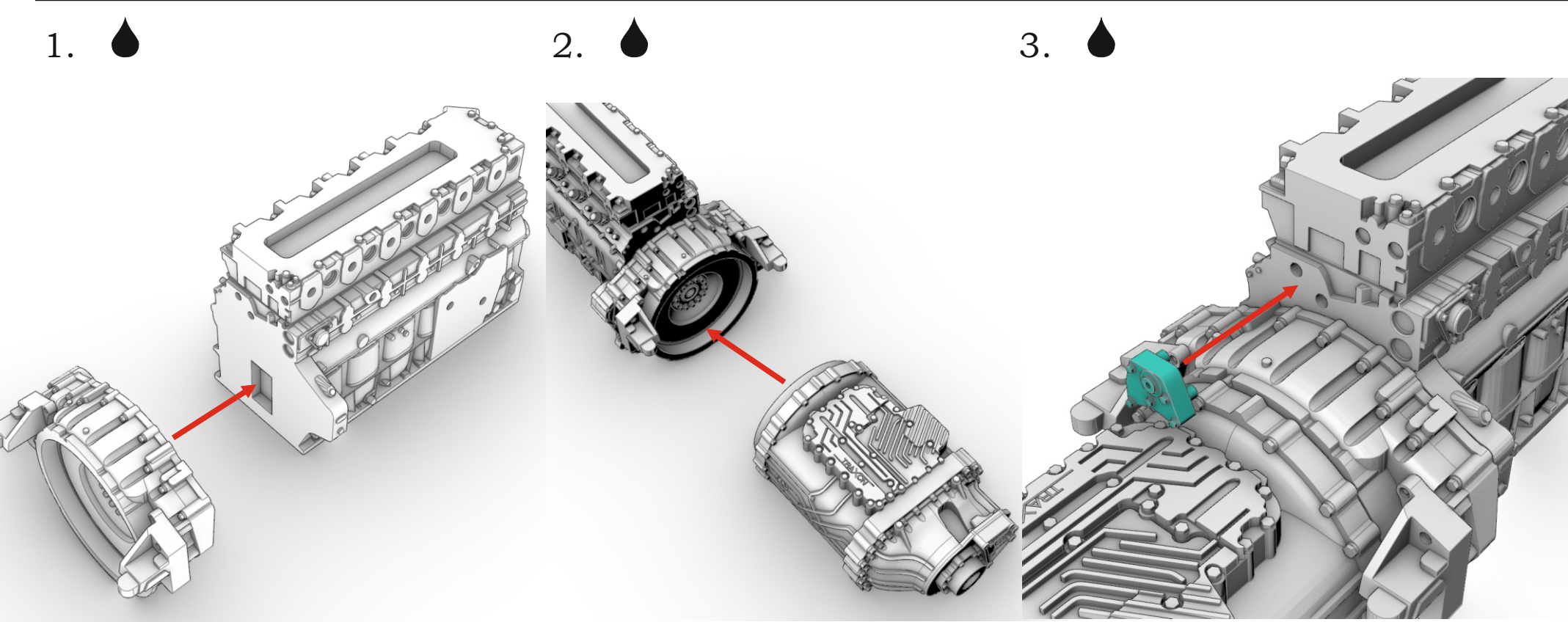

MX-13 engine. Resin kit, 1/24

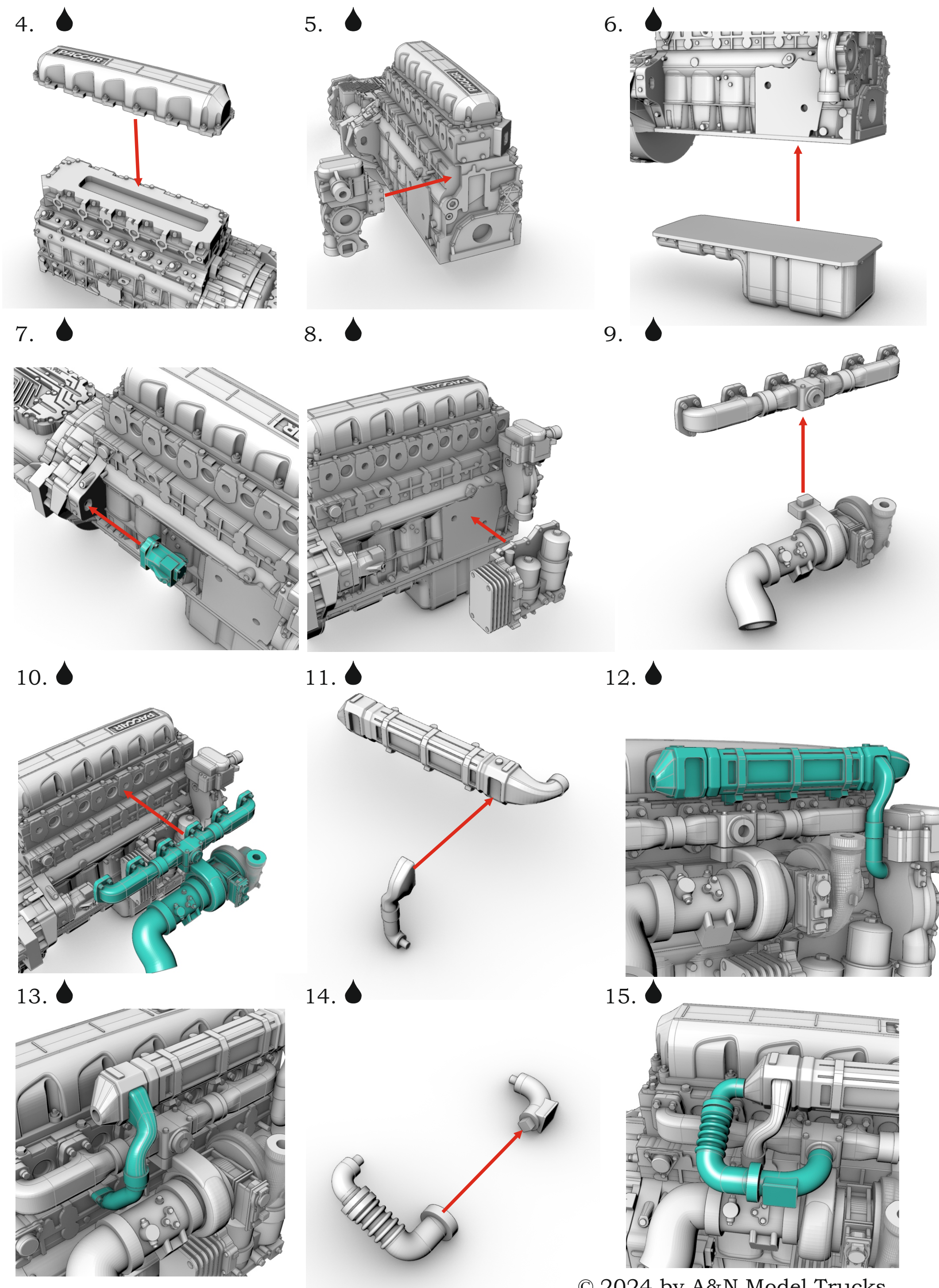

16. 

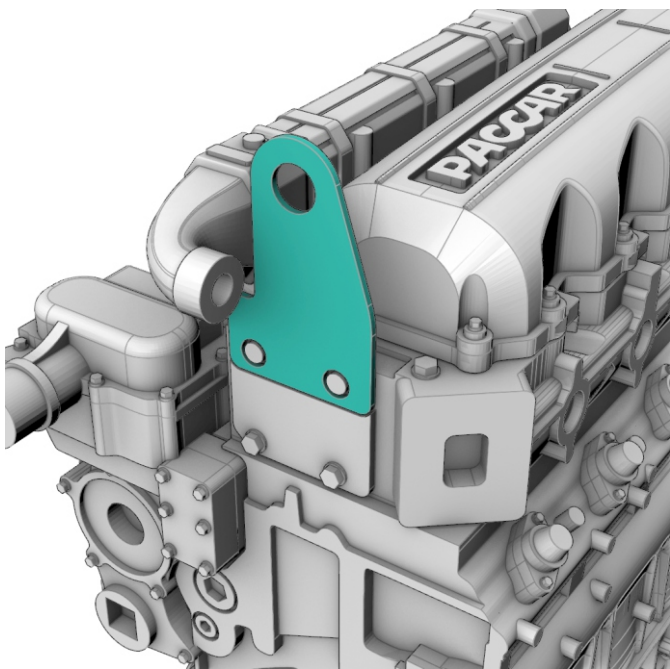

17. 

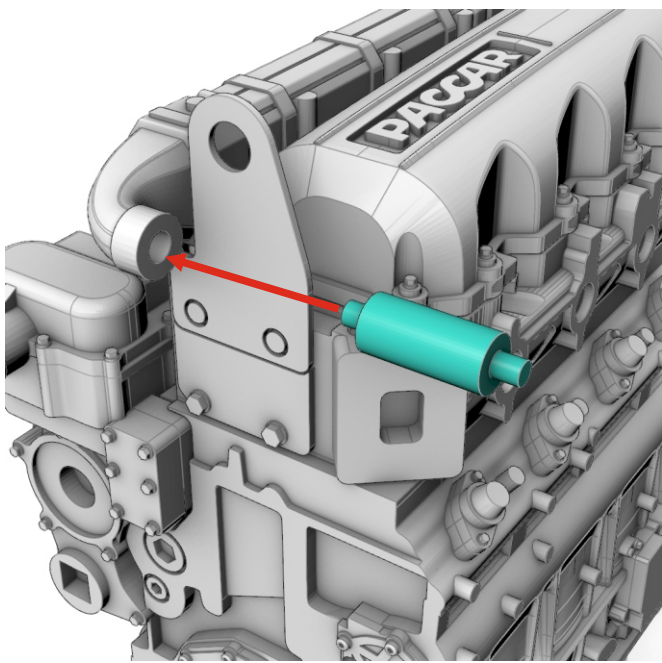

18. 

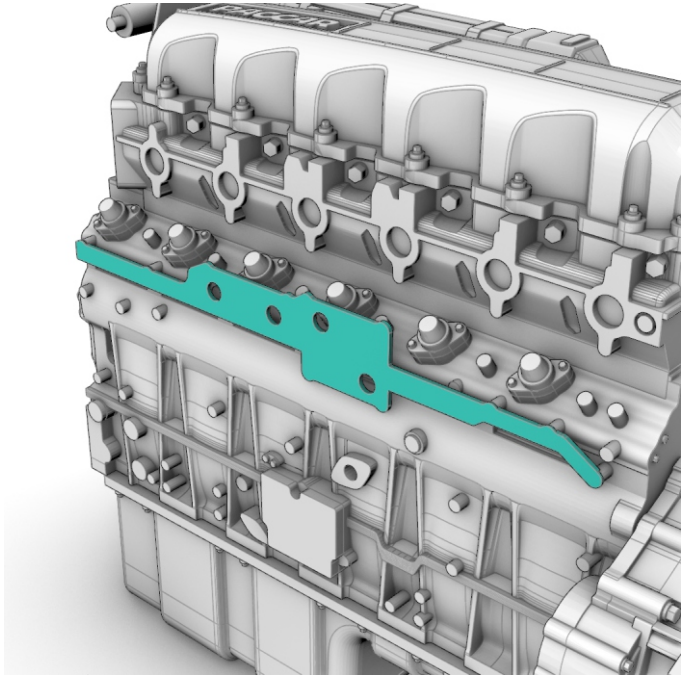

19. 

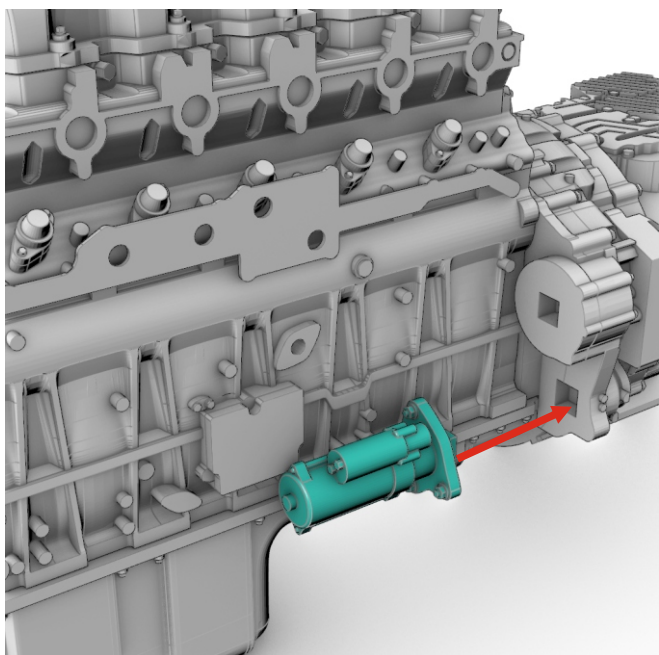

20. 

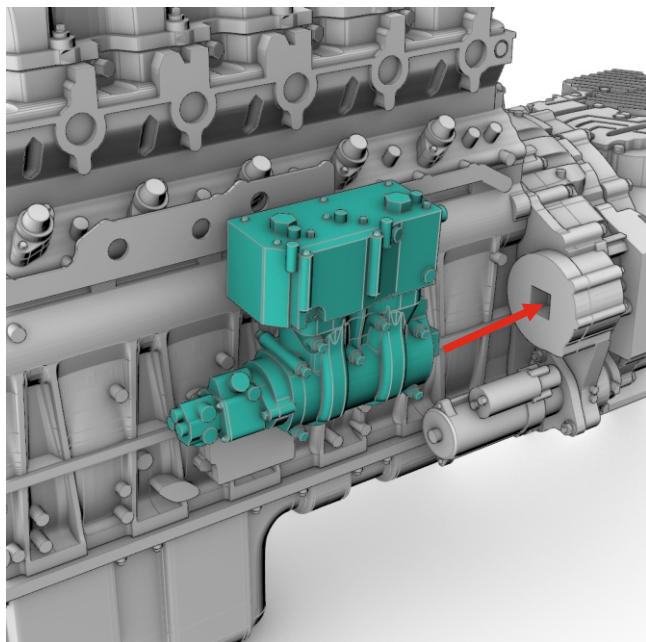

21. 

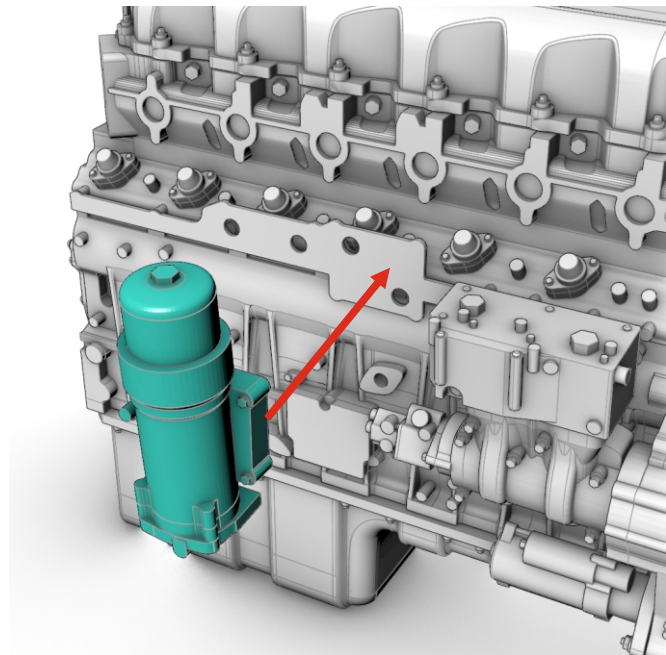

22. 

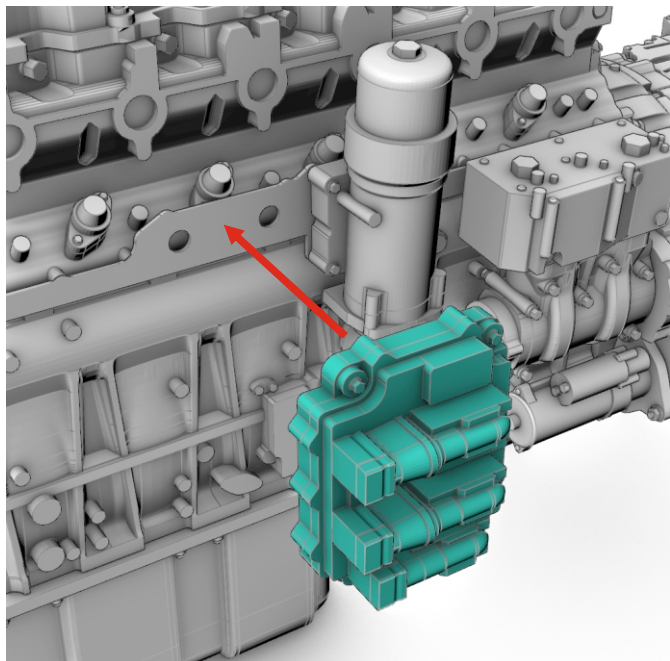

23. 

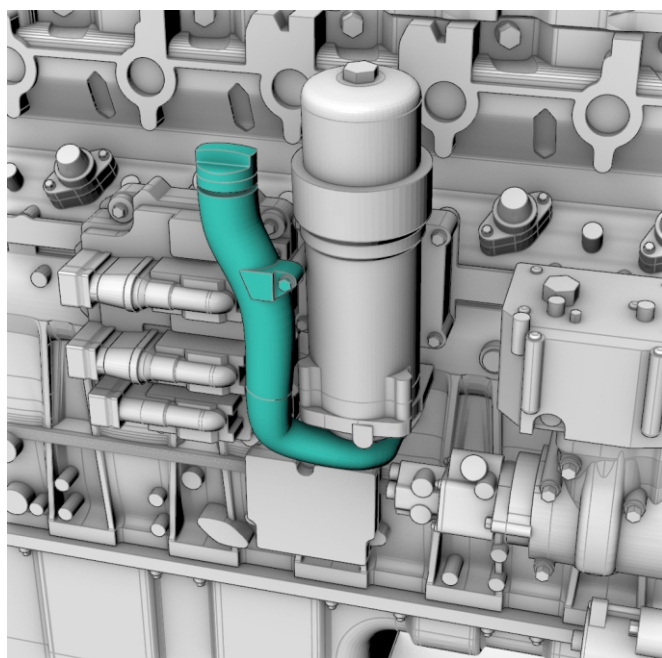

24. 

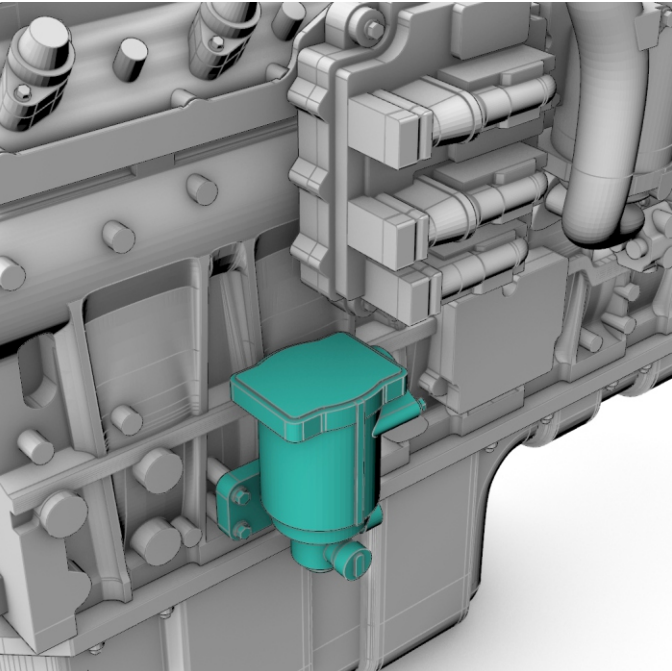

25. 

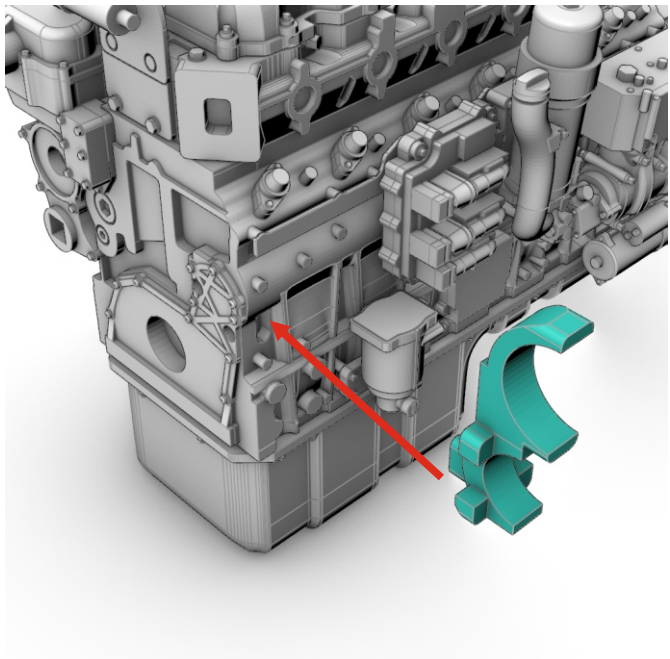

26. 

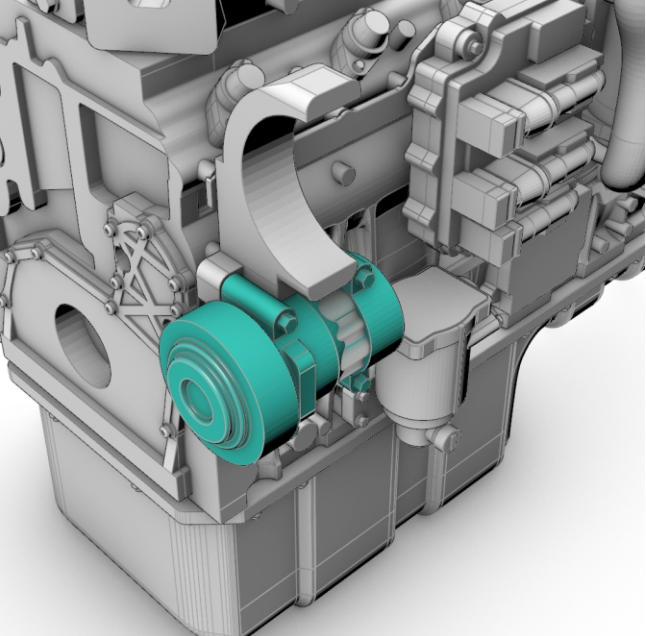

27. 

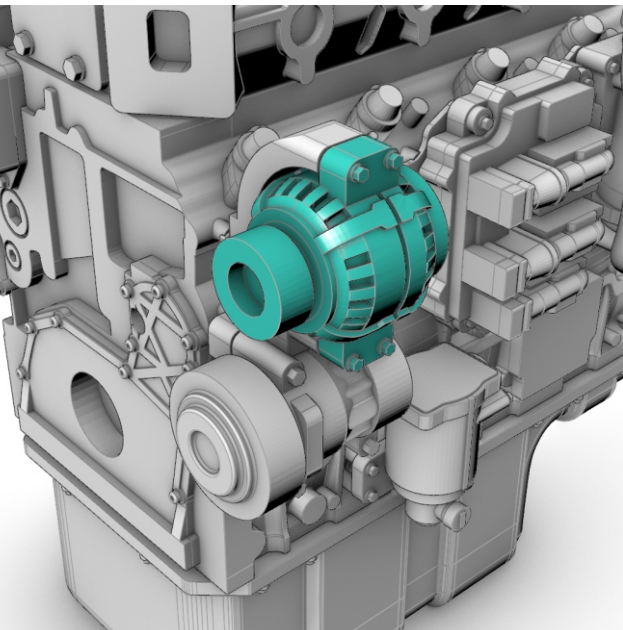

28. 

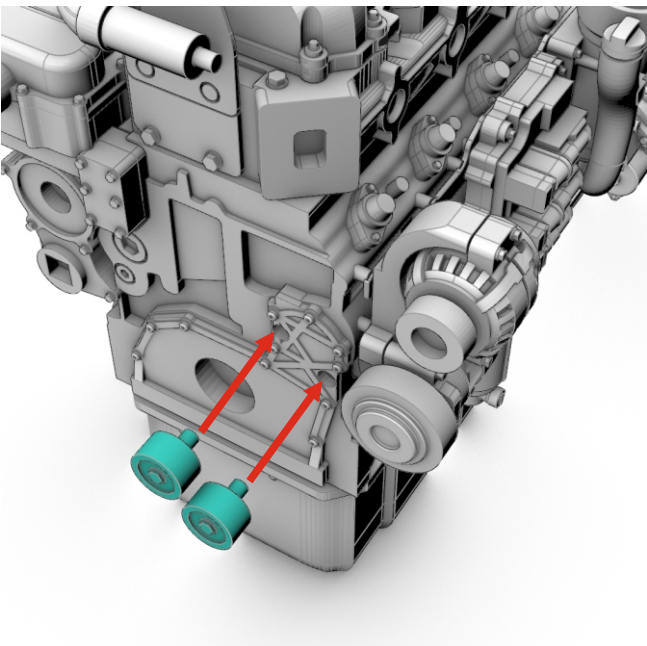

29. 

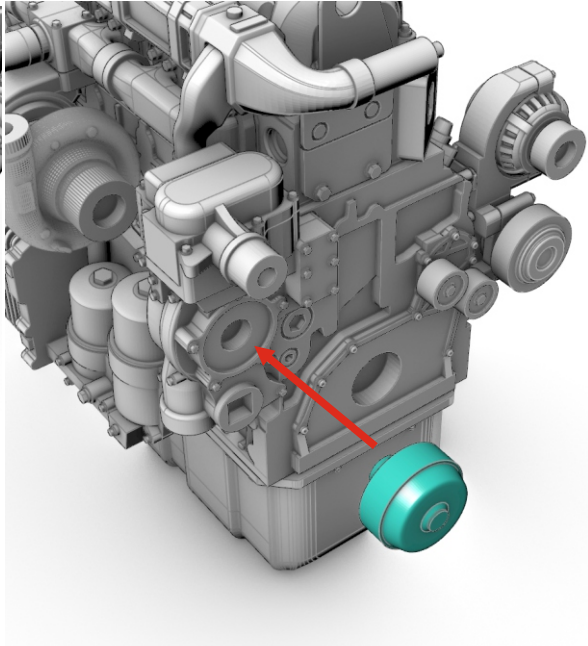

30. 

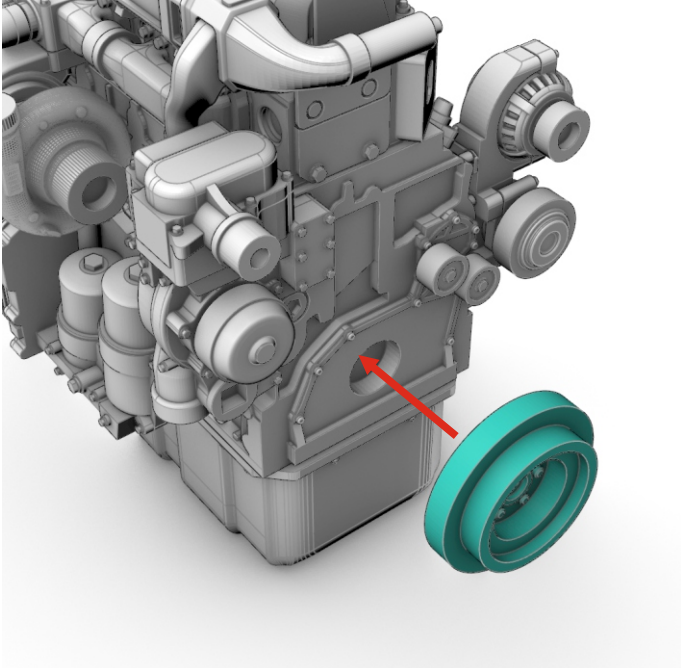

31. 

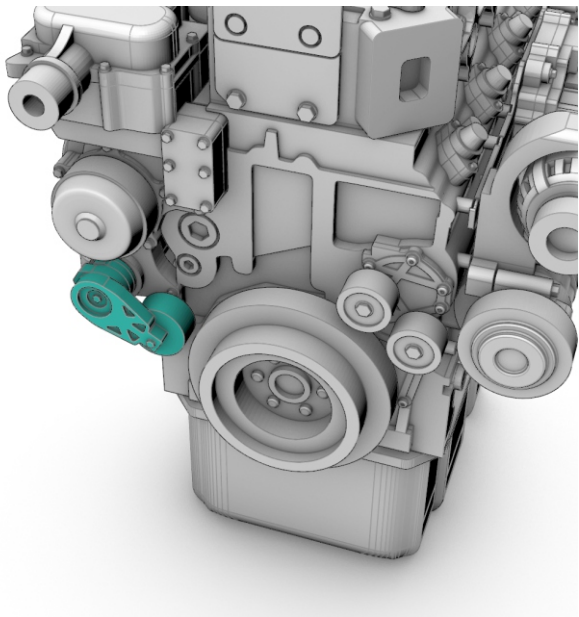

32.

For timing belt imitation
use an isolation tape.
Width - 1.5 mm

33. 

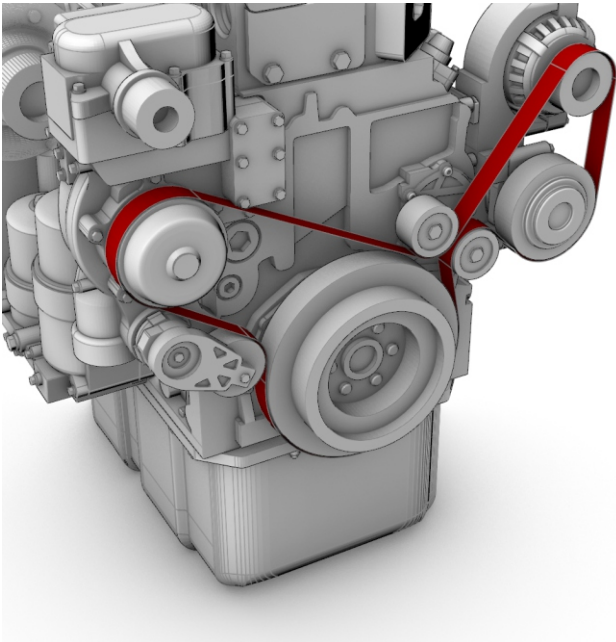

34. 

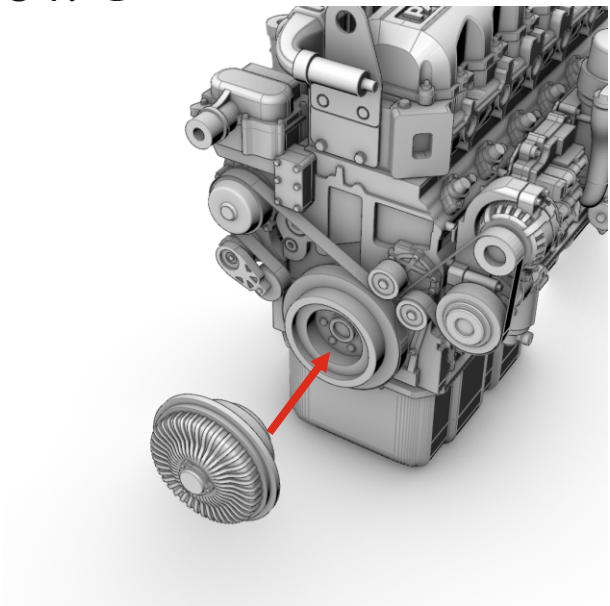

35. 

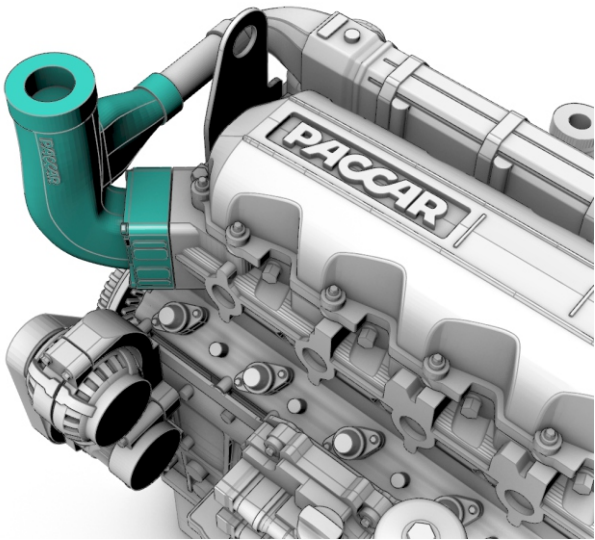

36. 

