

A&N Model Trucks



DUTCH TRUCK XG+ Multimedia kit, scale 1/24

Made in Latvia
© 2024 A&N Model Trucks

Warning!

Read carefully this instruction and please follow it during assembling, otherwise you could face problems with assembling the model.

Photo-etched parts have sharp edges, please be careful.

This model kit contains very small parts and is not suitable for children. THIS IS NOT A TOY!

This kit requires chassis - photo-etched chassis by A&N Model Trucks or Italeri DAF XF105 recommended.

Symbols:

 - glue parts;

 - do not glue parts;

 - bend parts;

 - attention;

 - moving parts;

 - your choice;

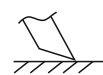
 - cut;

 - drill;

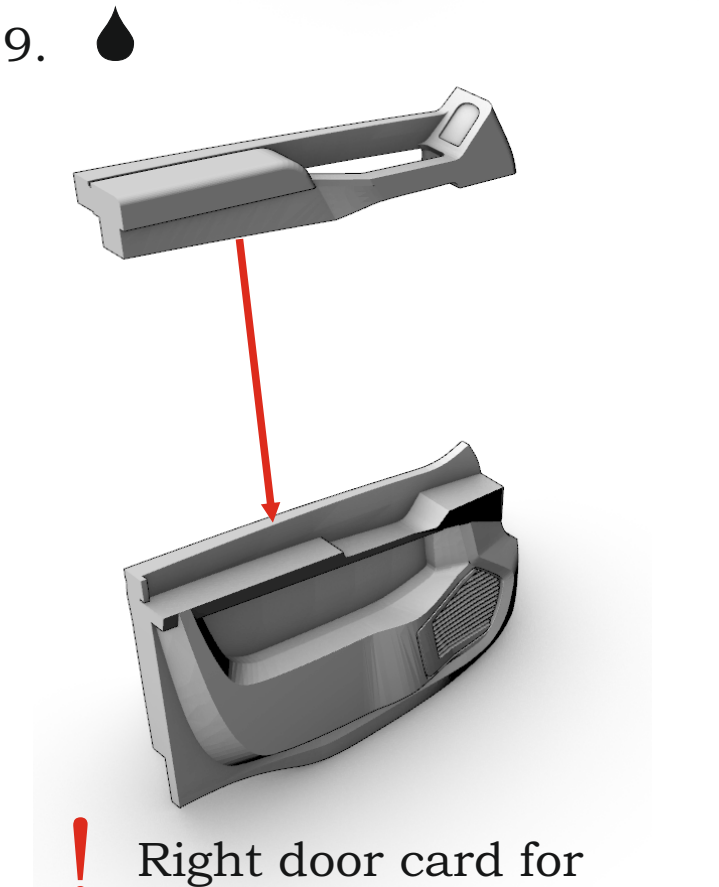
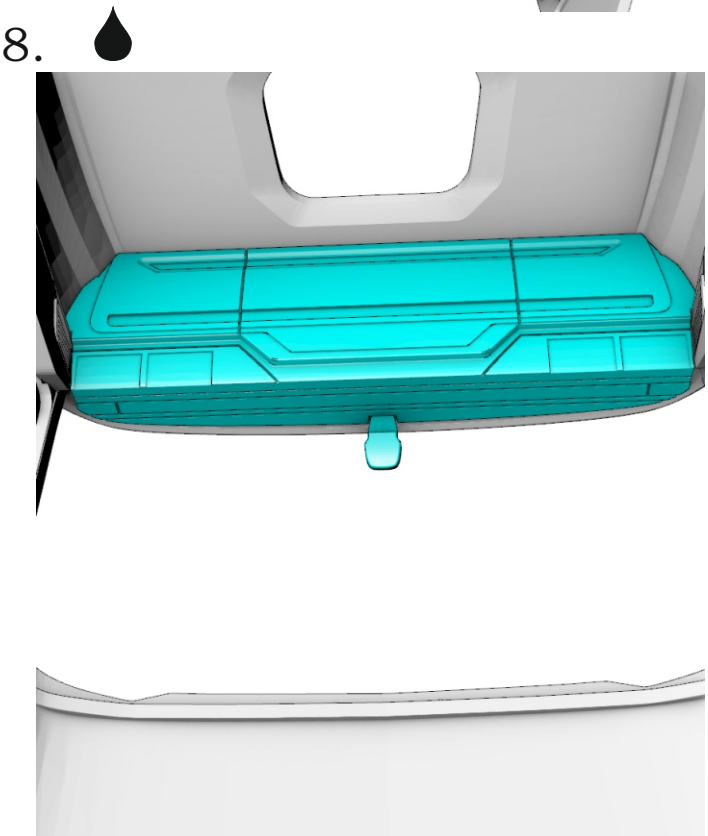
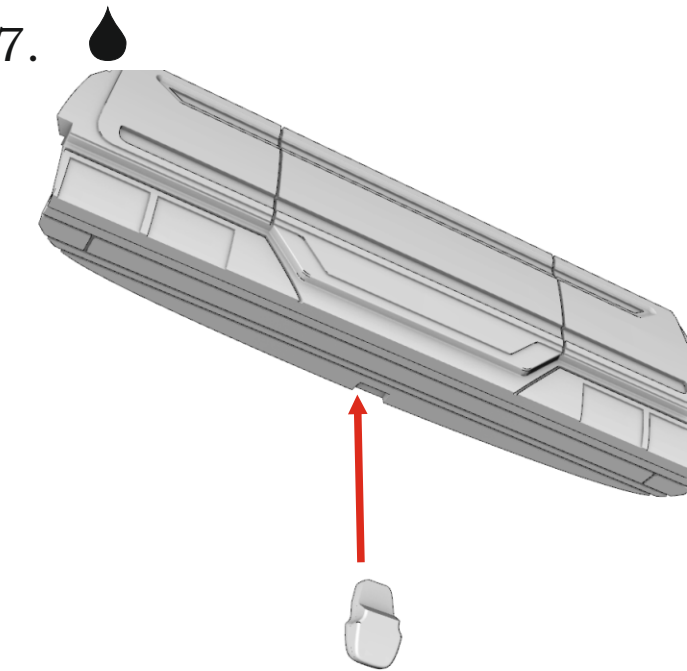
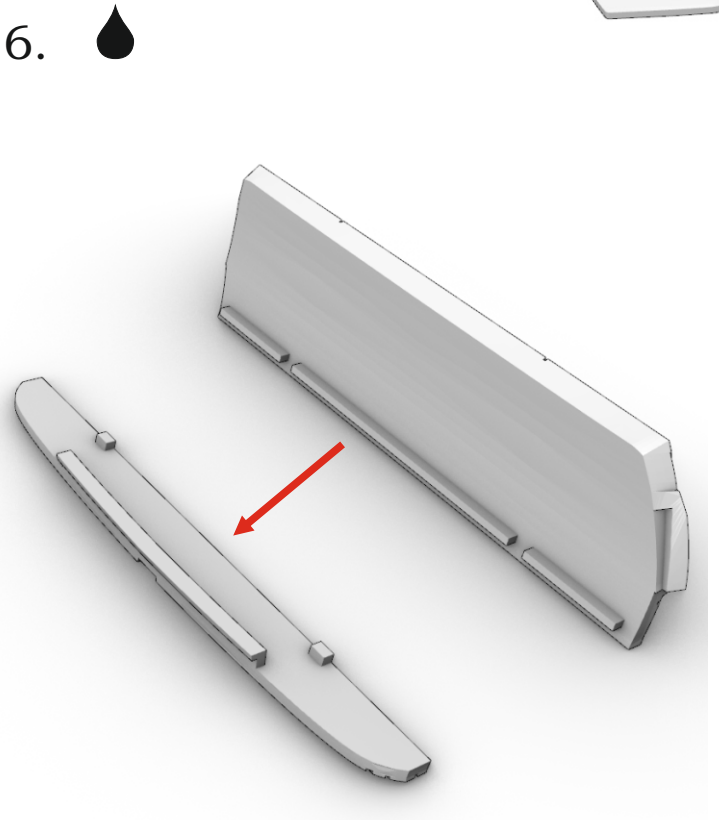
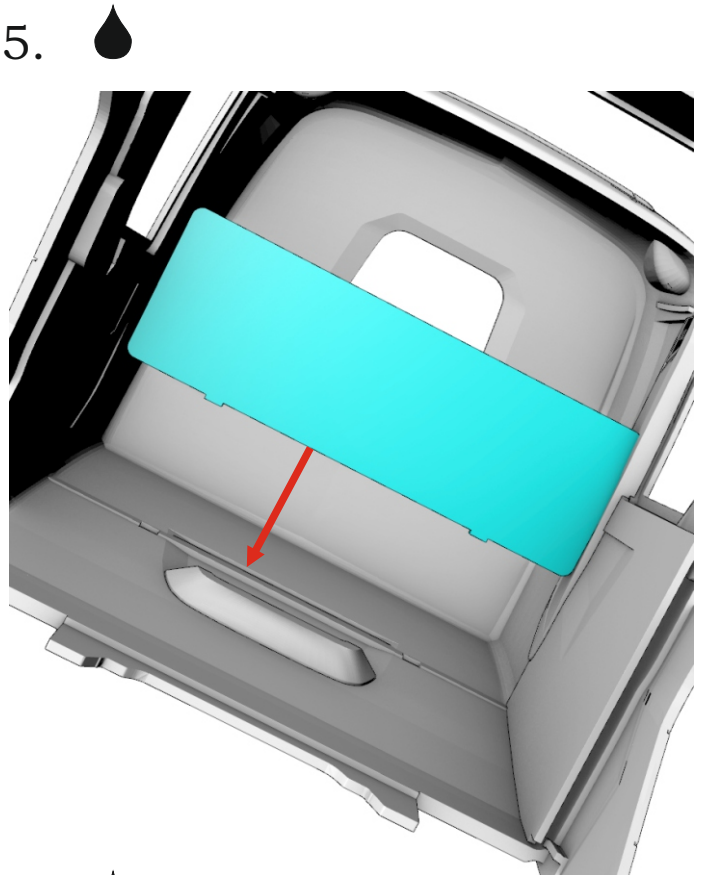
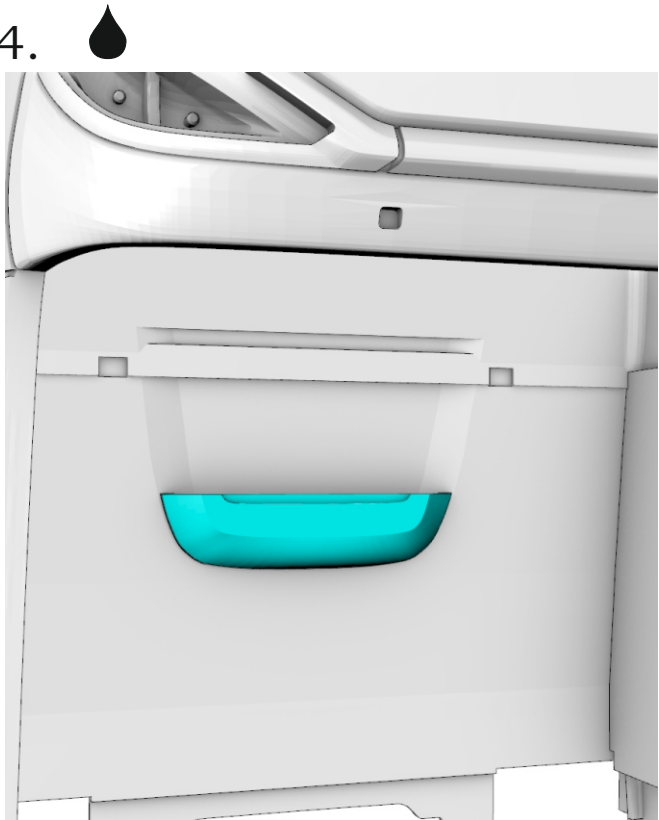
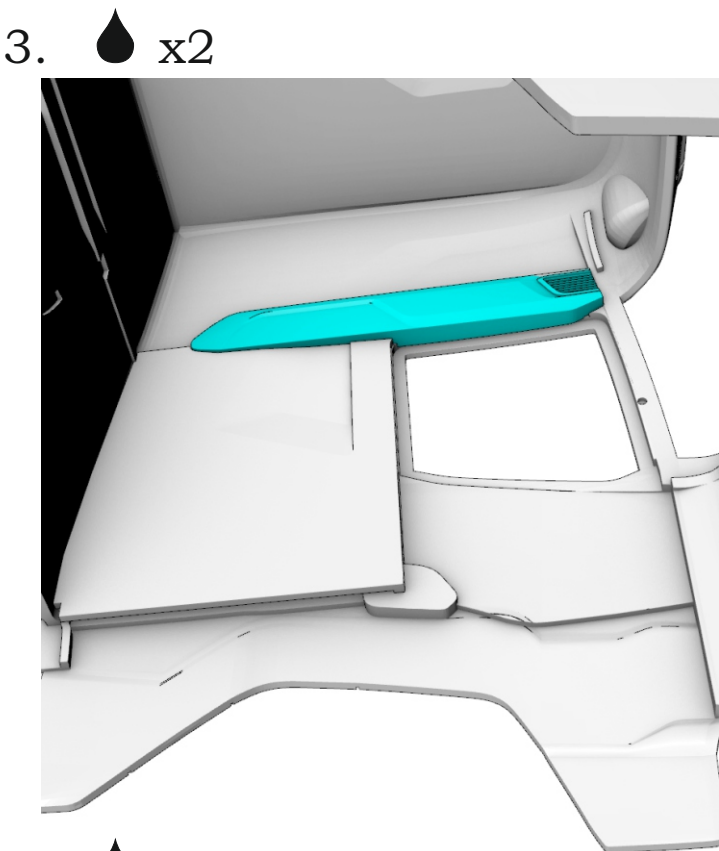
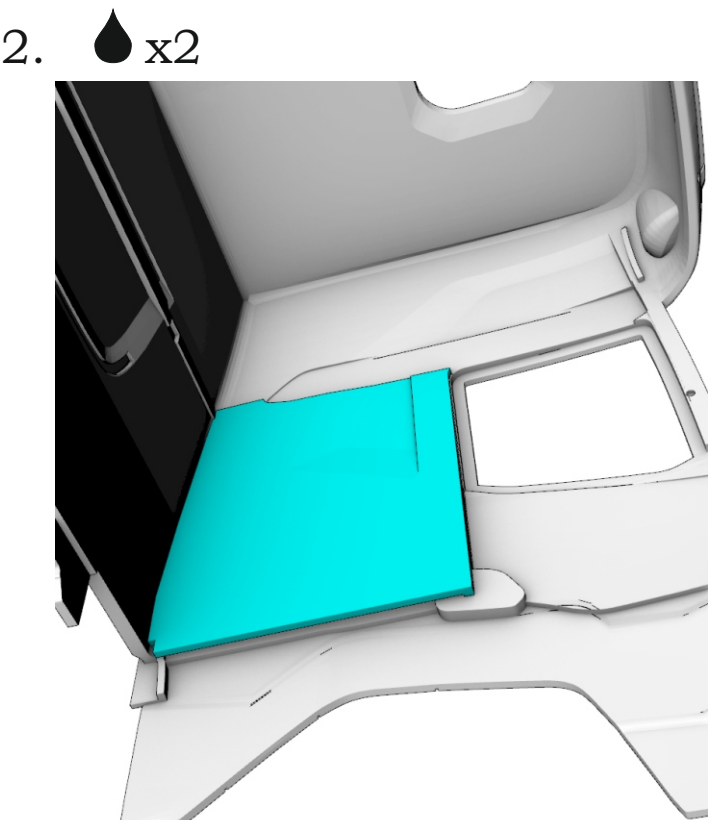

! Right door card for right-hand drive

10.

PE-part #13

11.

12.

PE-part #14

13. x2

Glass

14. x2

15.

Glass

16. x2

17.

18.

PE-part #18

PE-part #17

PE-part #15

19. 

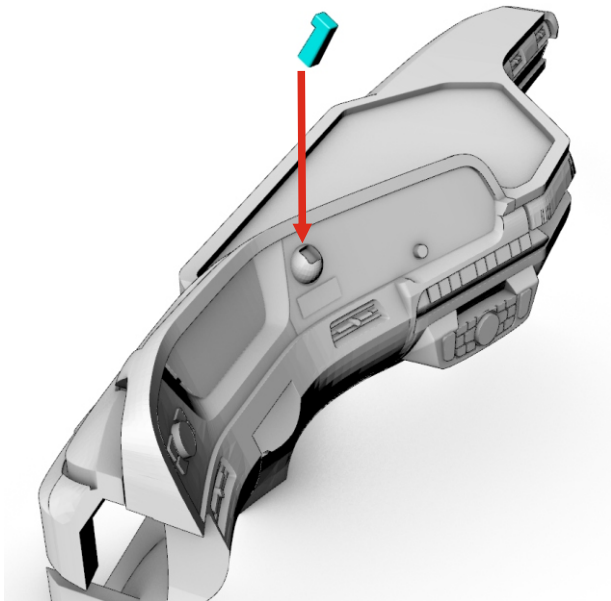

20. 

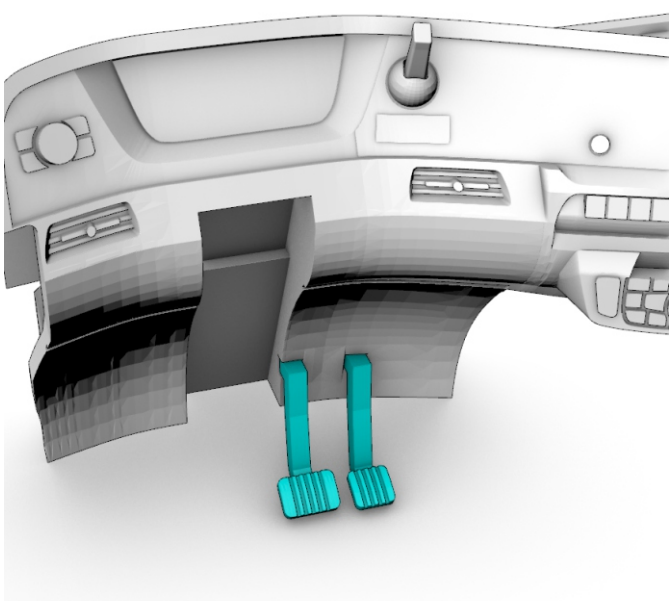

21. 

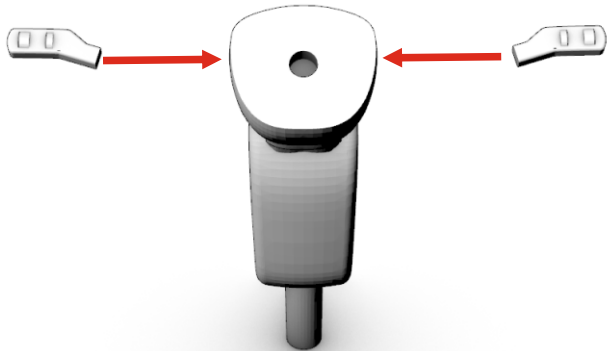

22. 

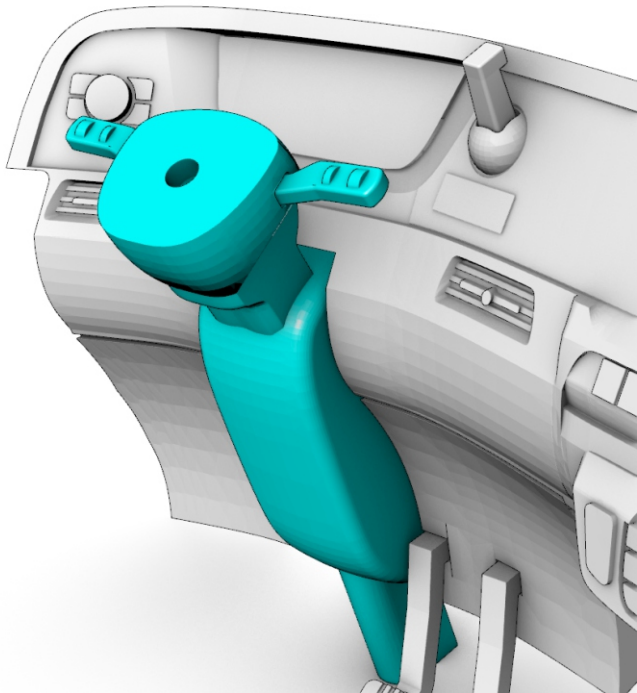

23. 

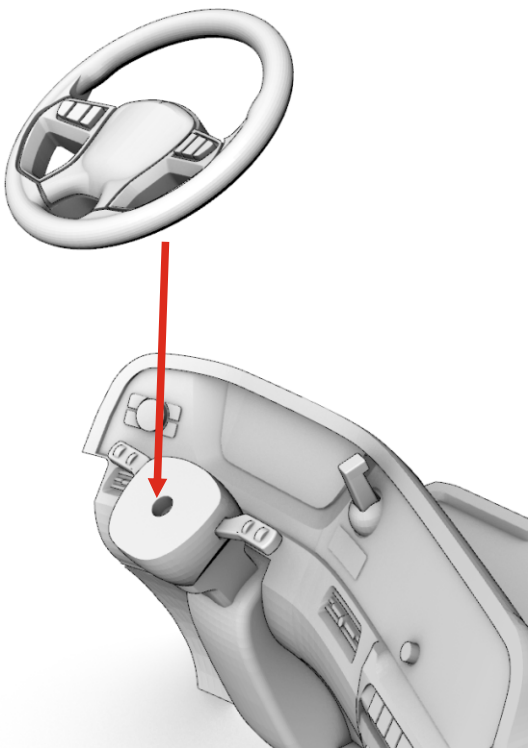

24. 

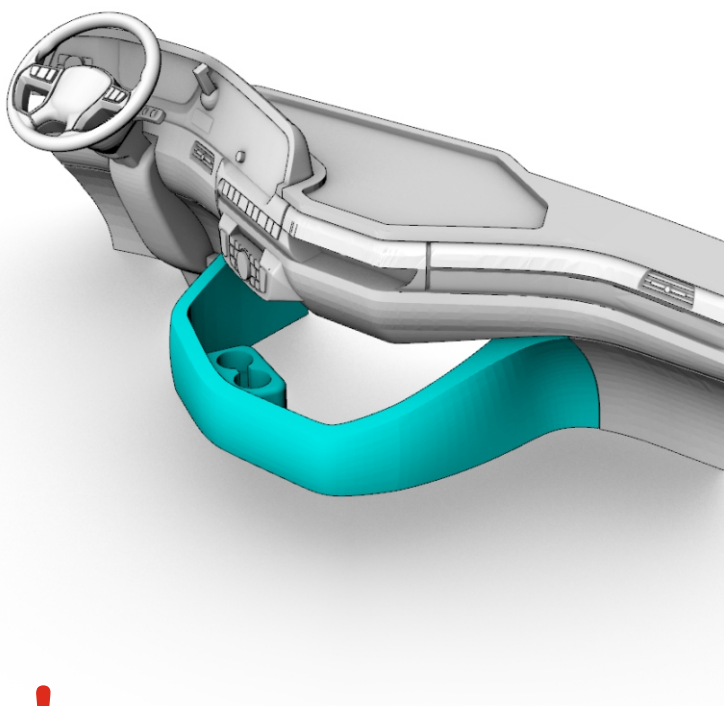

25. 

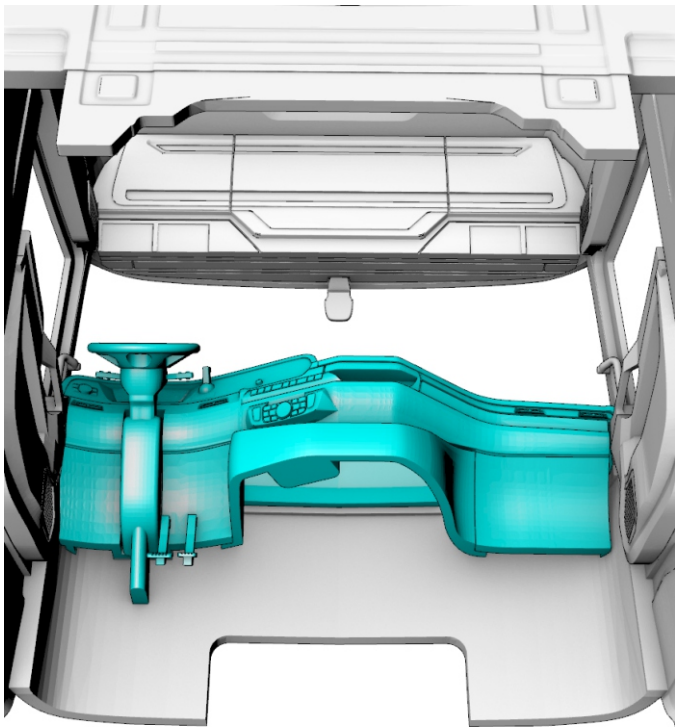

26.  x2
PE-part #12



!



27.  x2



28.  x2



29. 

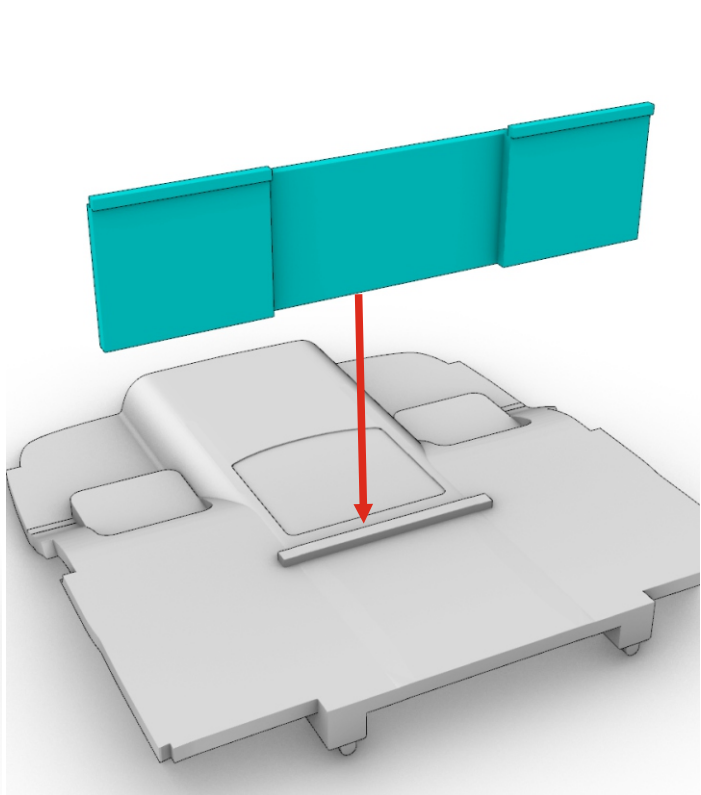

30. 

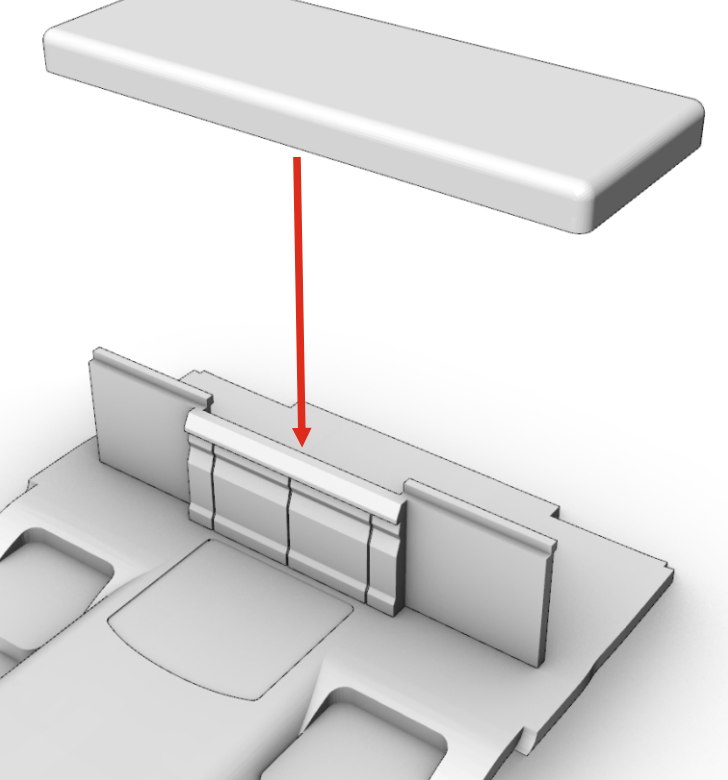

31. 

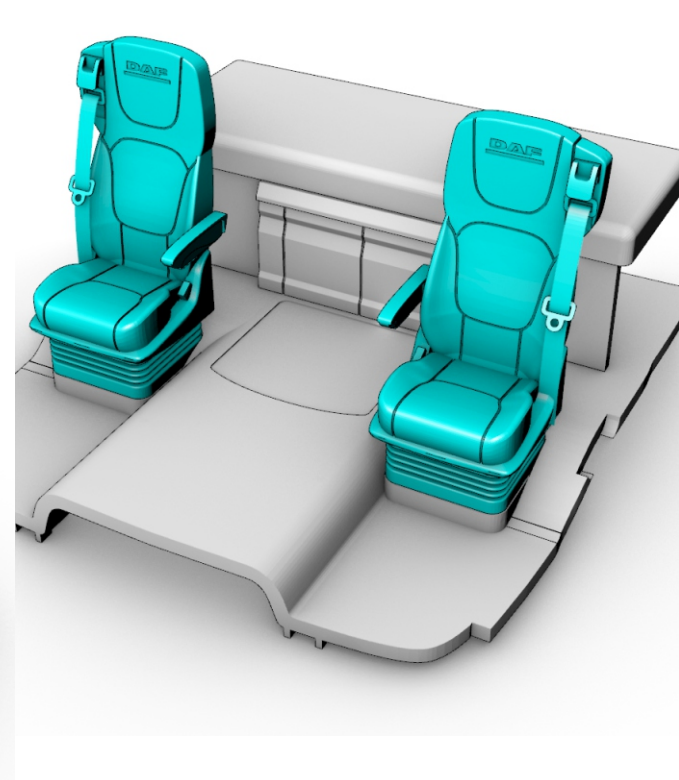

32.  x2

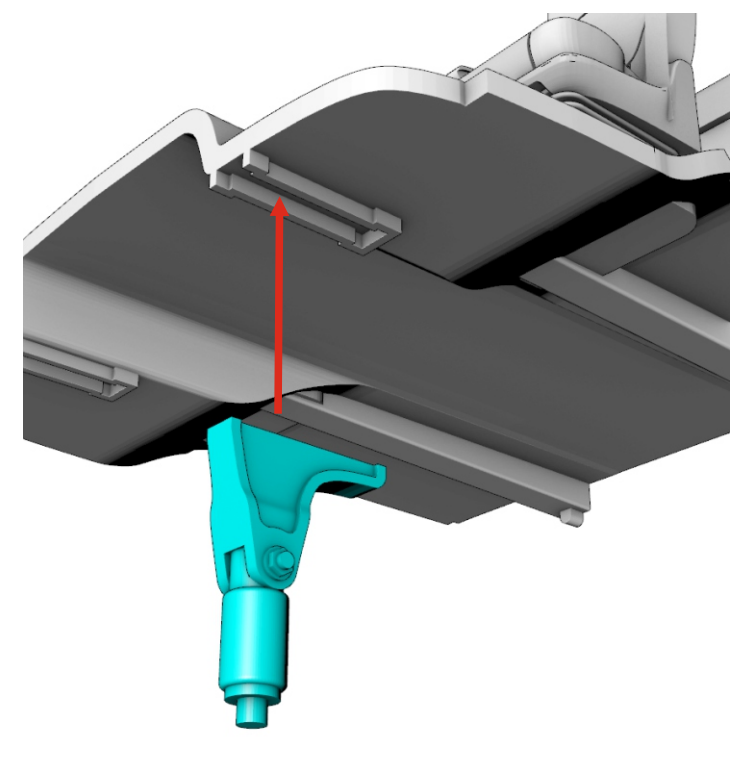

33. 

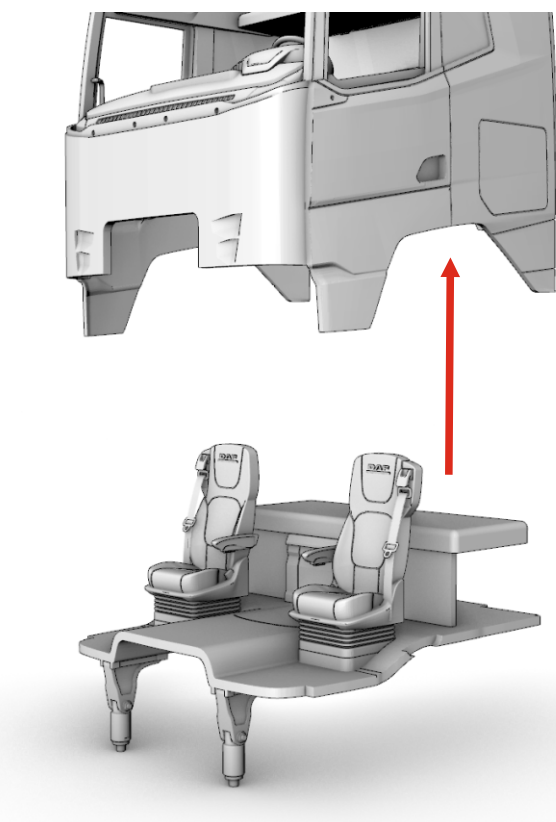

34.  x2

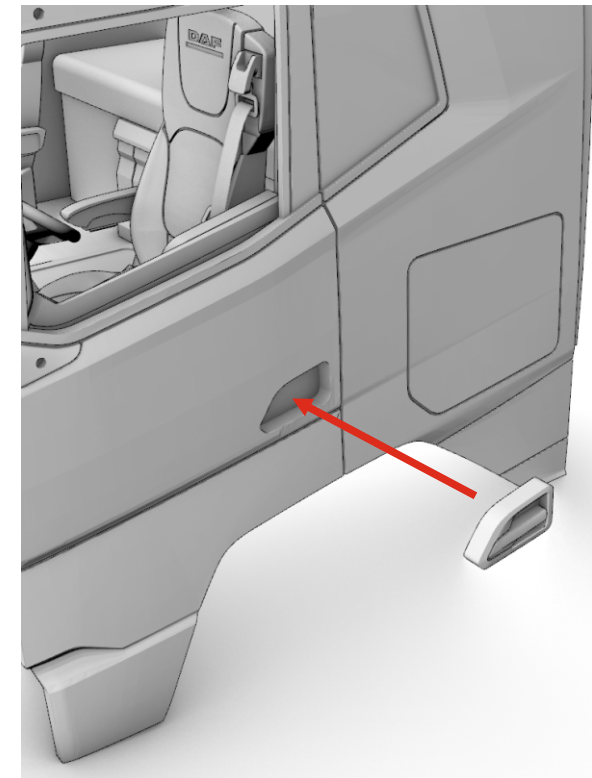

35.  x2

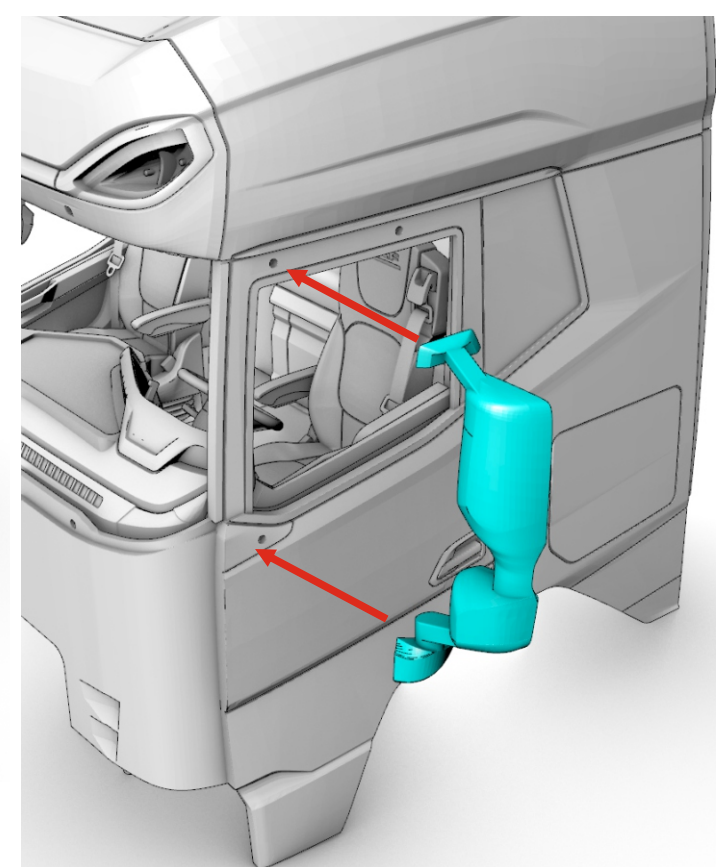

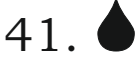
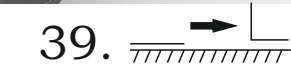
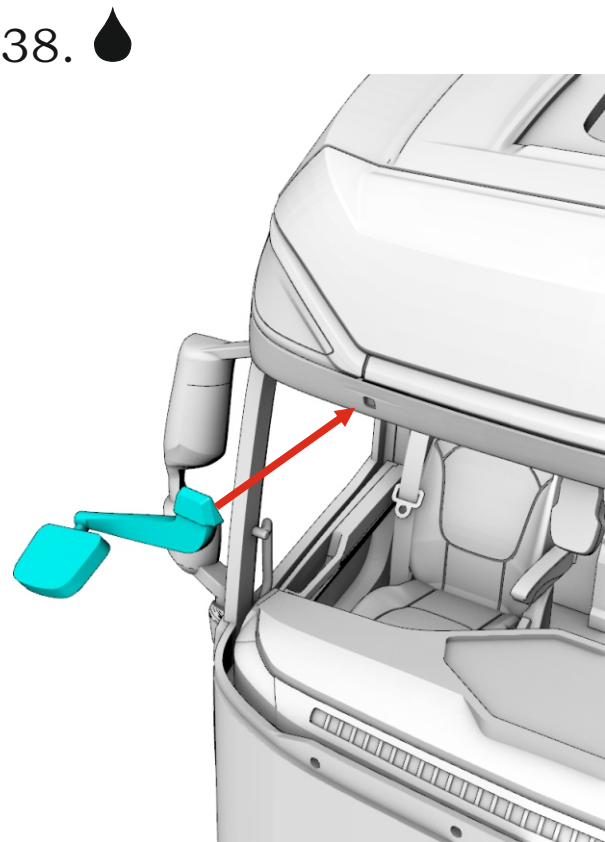
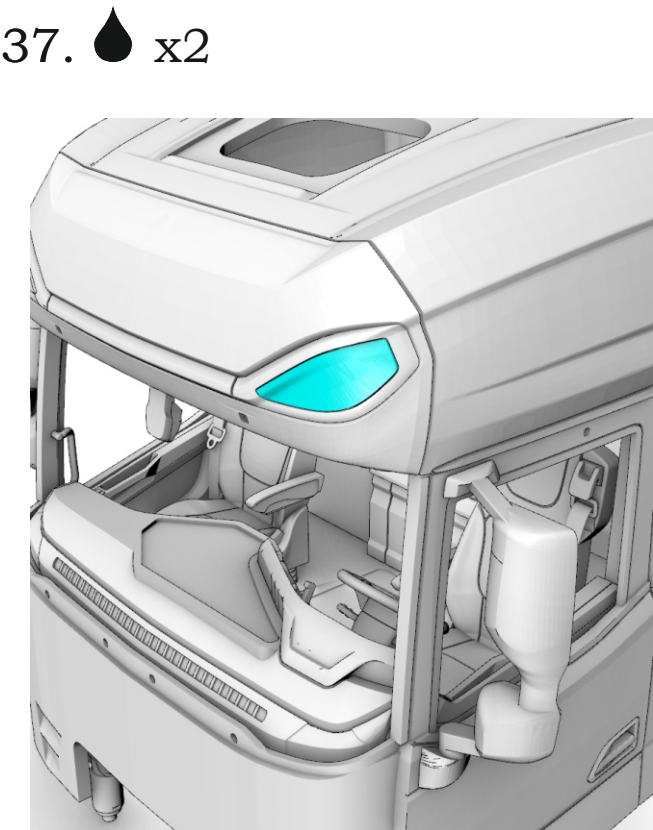
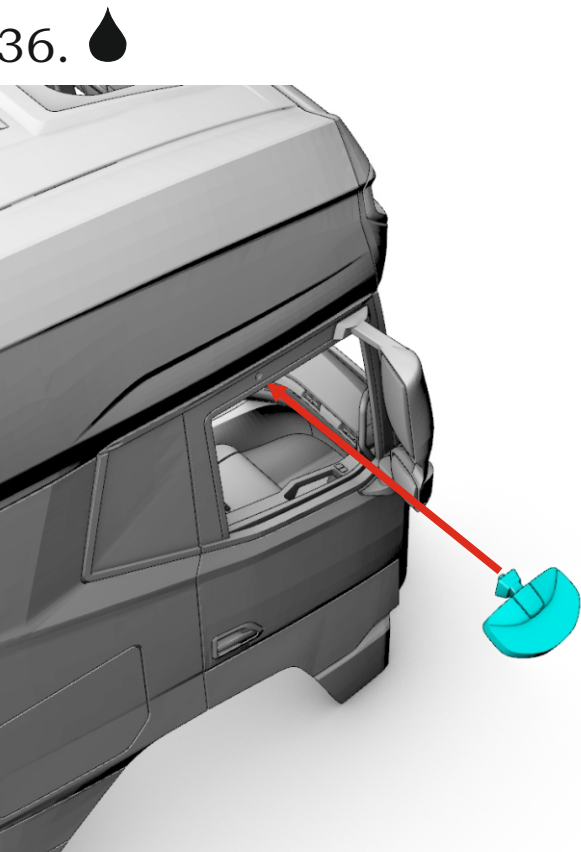

PE-part #10

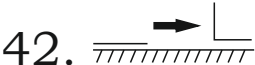
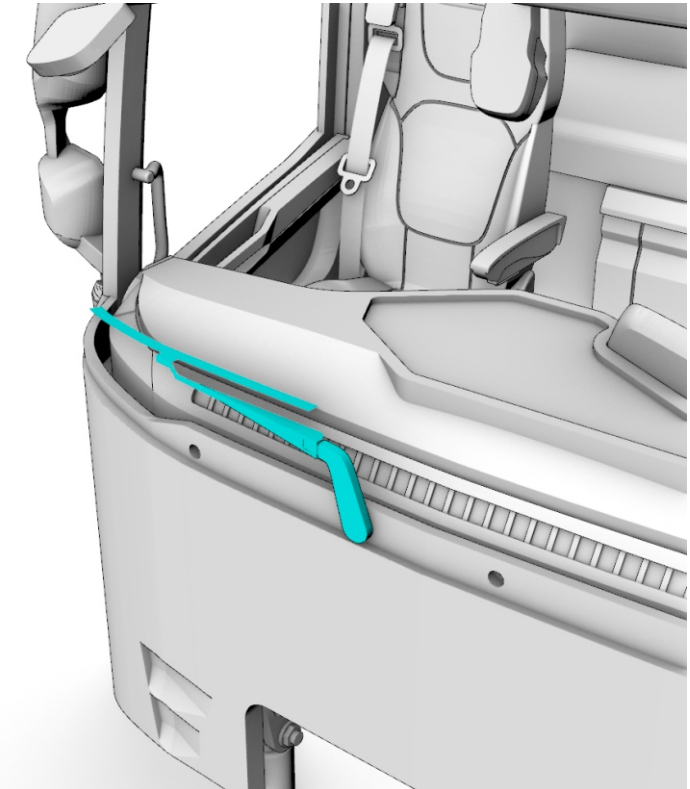
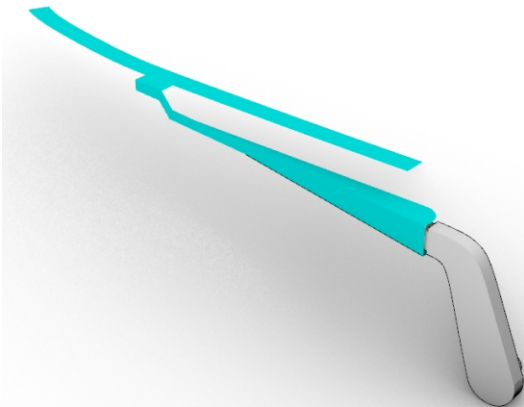
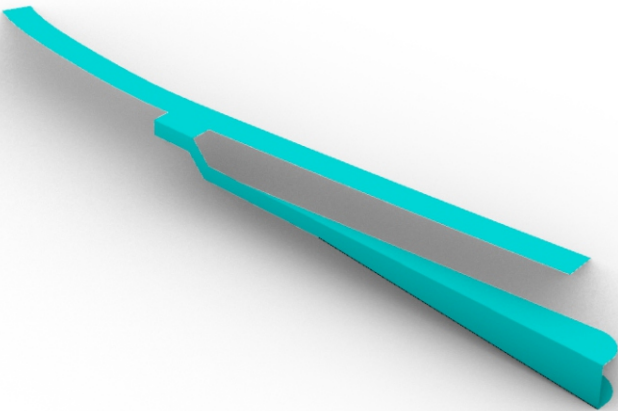

PE-part #11

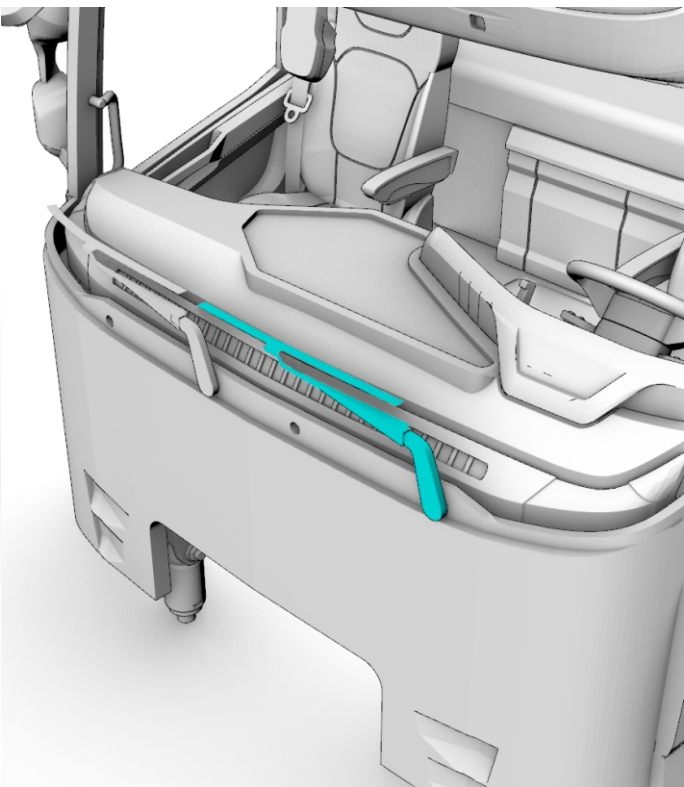
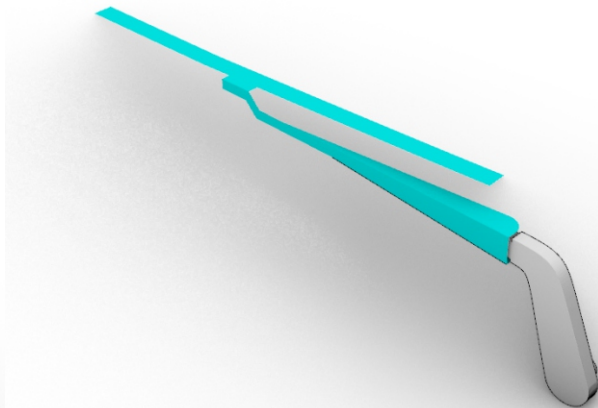
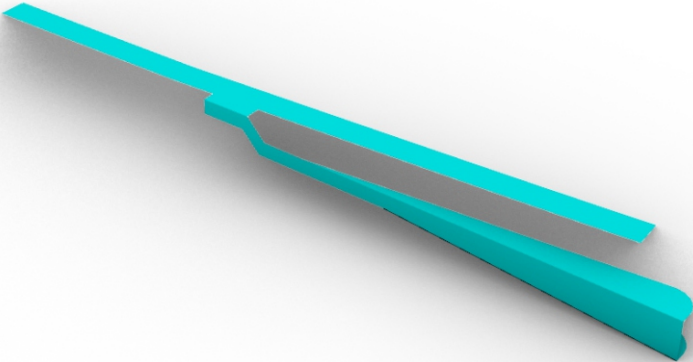

45. 
Glass

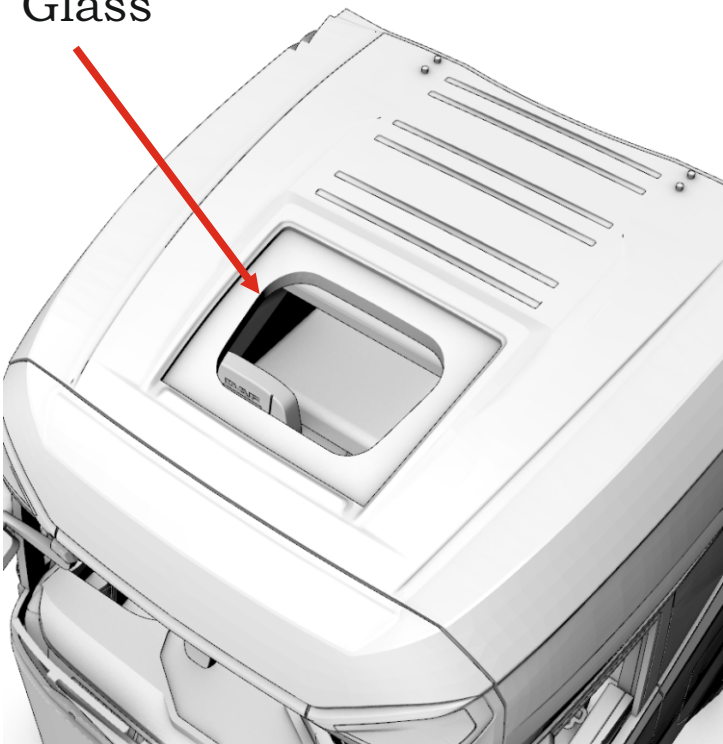

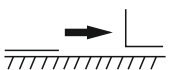
46.  x2
PE-part #4

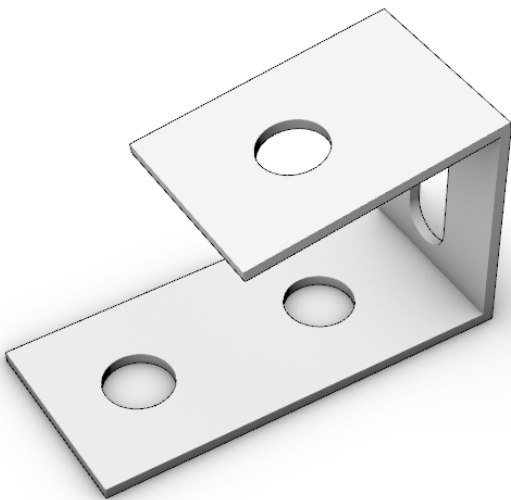

47.  x2

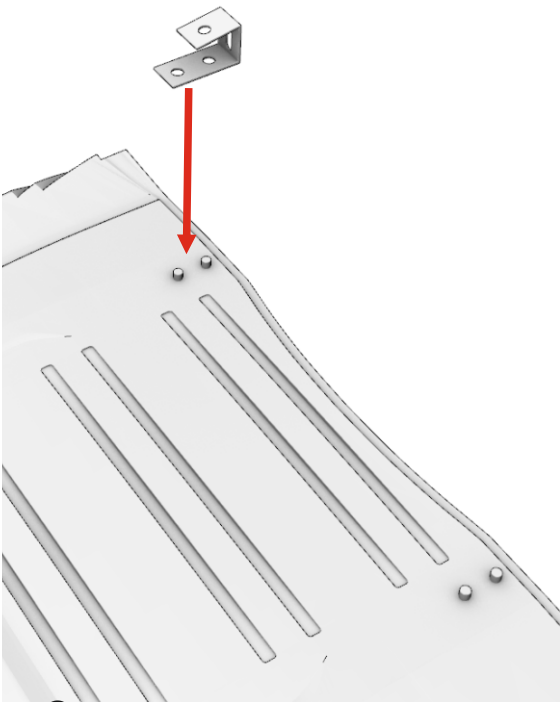

48. 
PE-parts #8

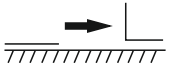

49.  x2

PE-part #2



PE-part #1

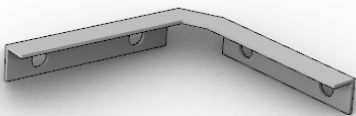

50.  x2



51.  x4

PE-part #5

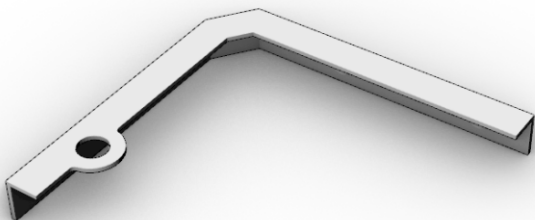

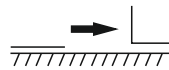
51.  x4

PE-part #3

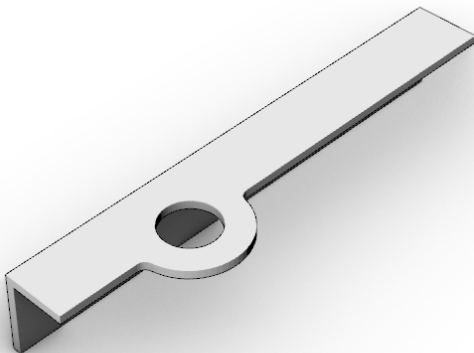

53.  x4



54.  x2



55.  x2

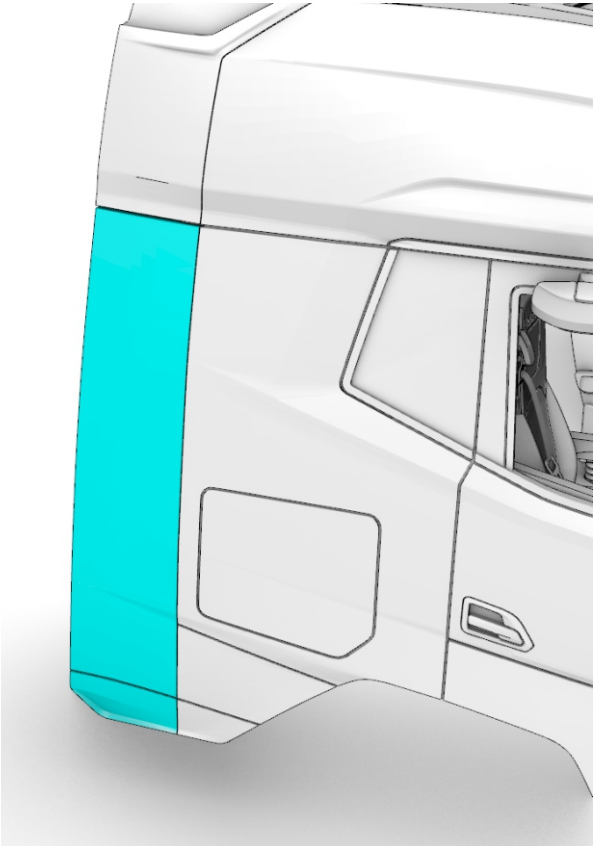

56.  x2



57.  x2

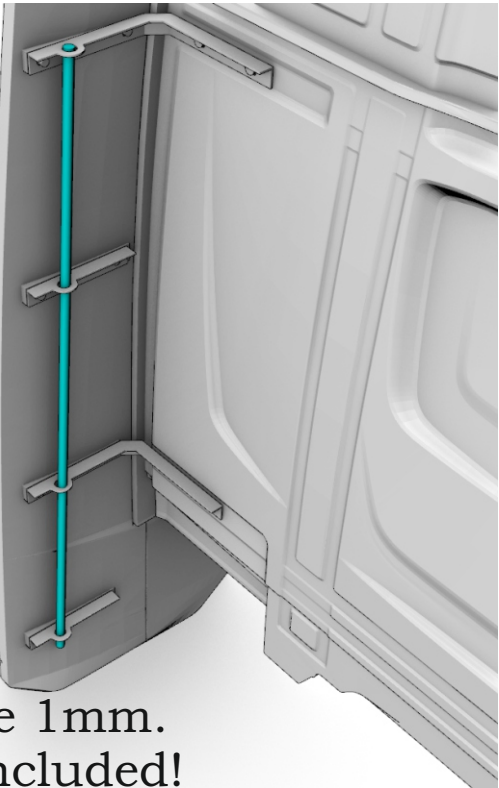

58. 

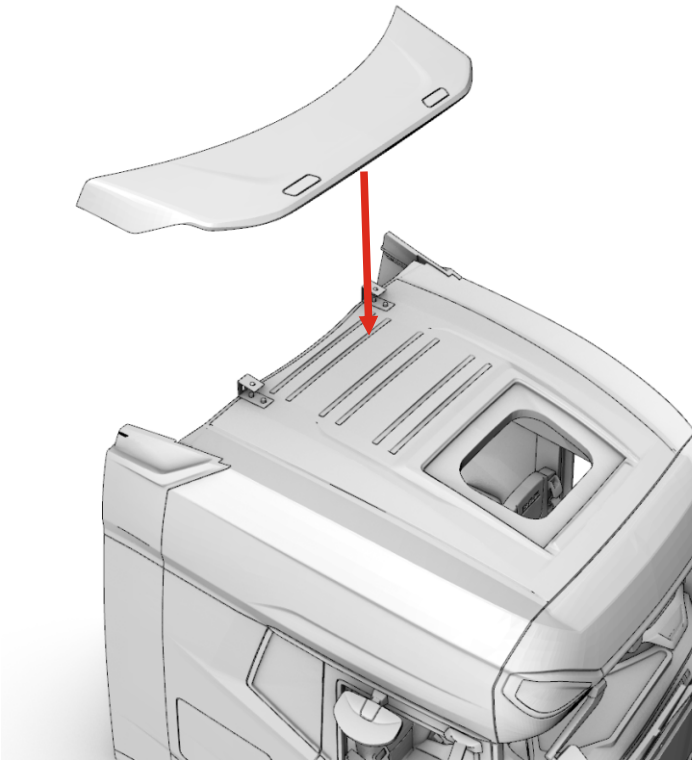

59.  x2

PE-part #6

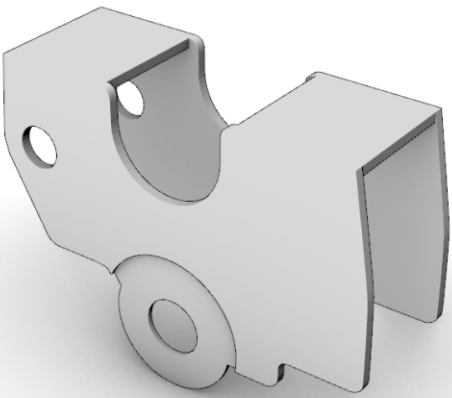

Profile 1mm.
Not included!

60. 

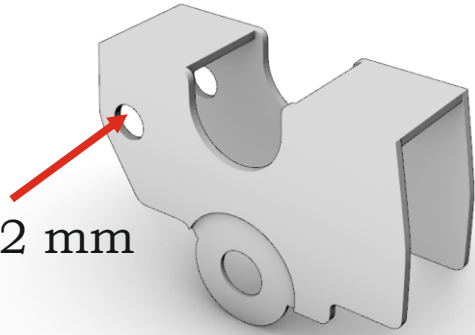

61.  x2

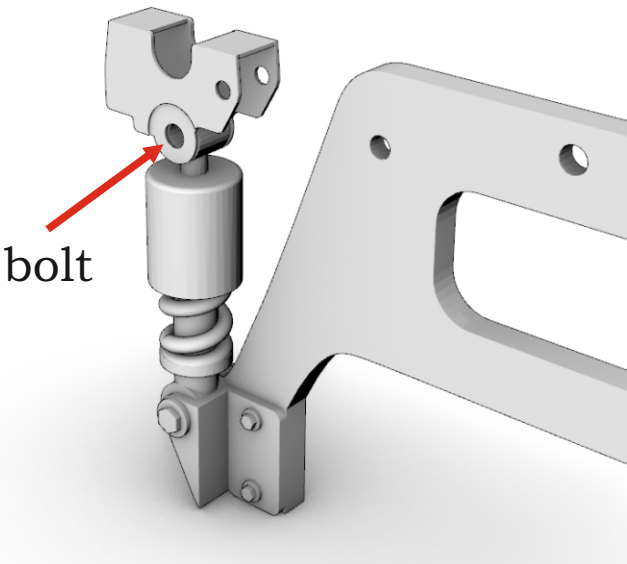

62.  x2

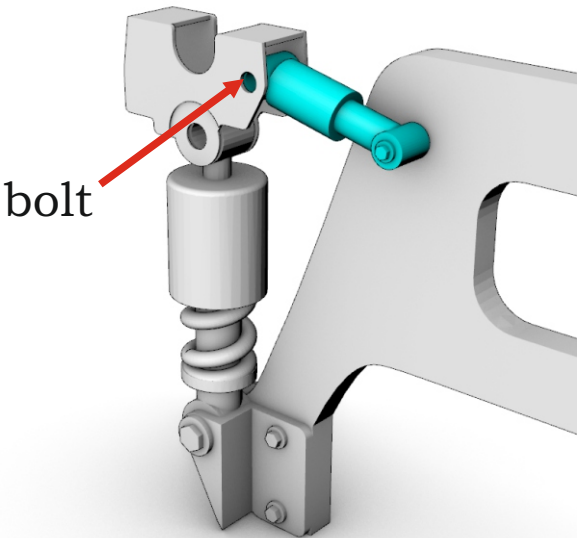

Dutch truck XG+. Scale 1/24

63.  x2

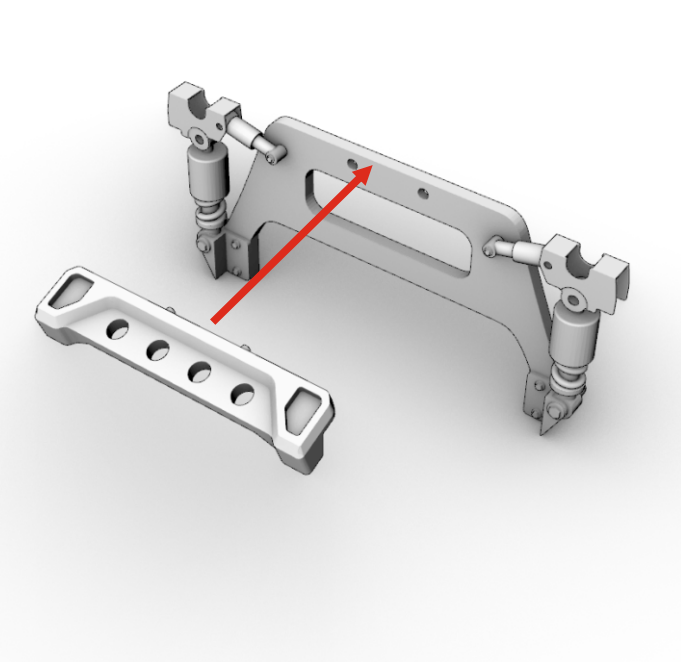

64.  x4

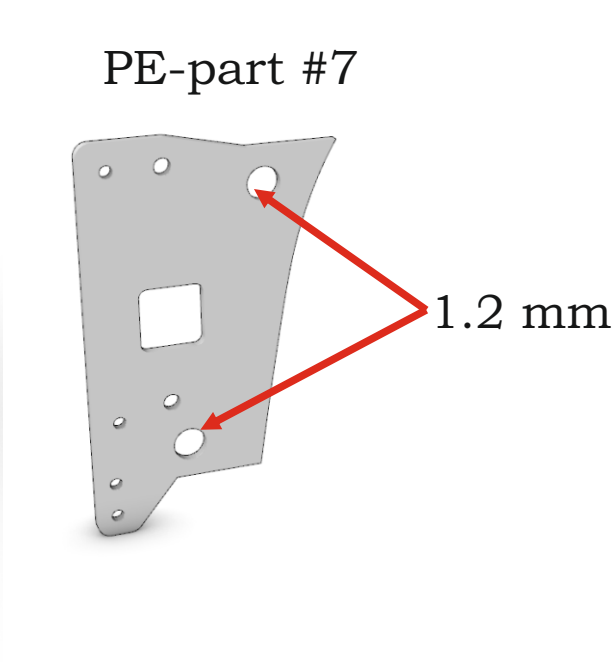

65.  x2

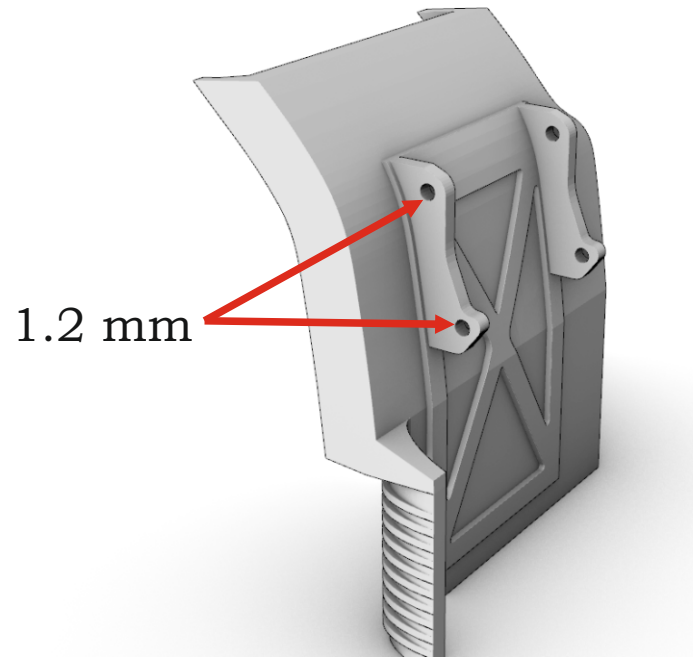

66.  x2

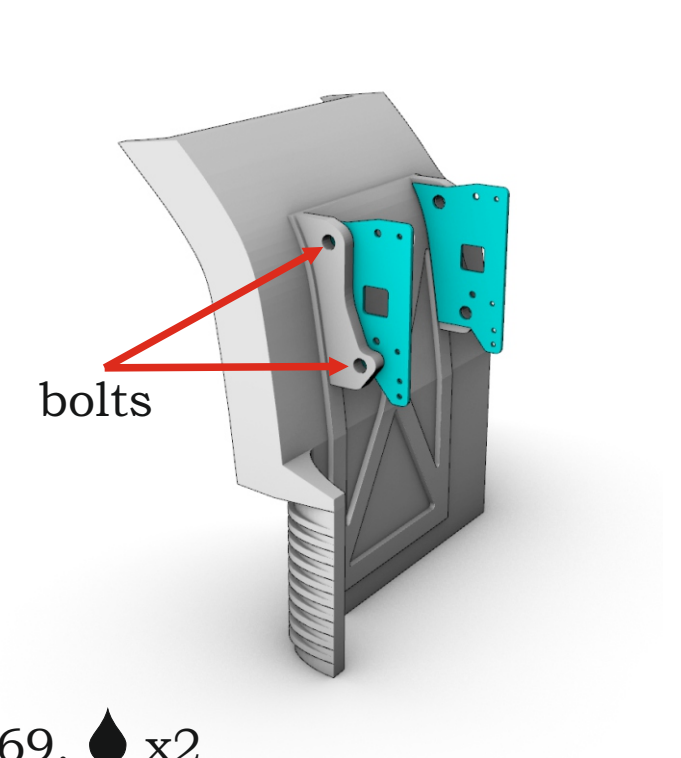

67.  x2

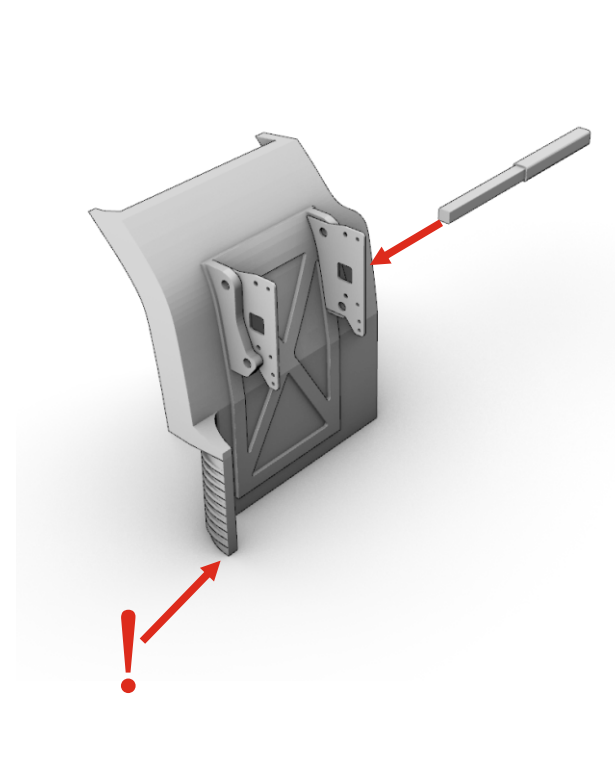

68.  x2

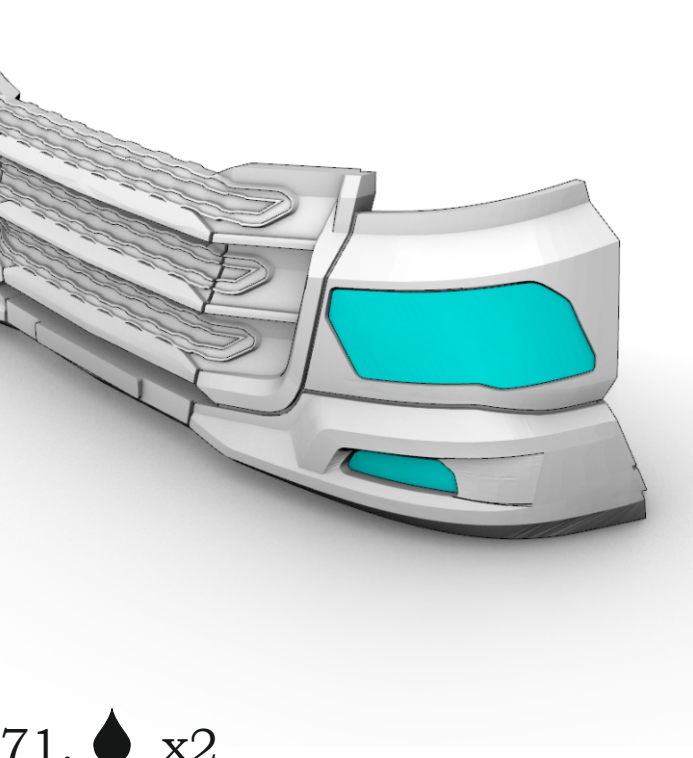

69.  x2

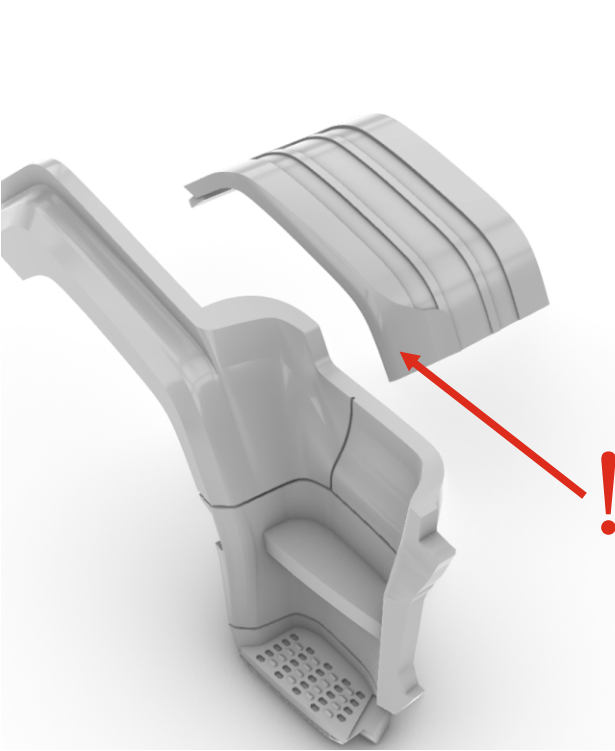
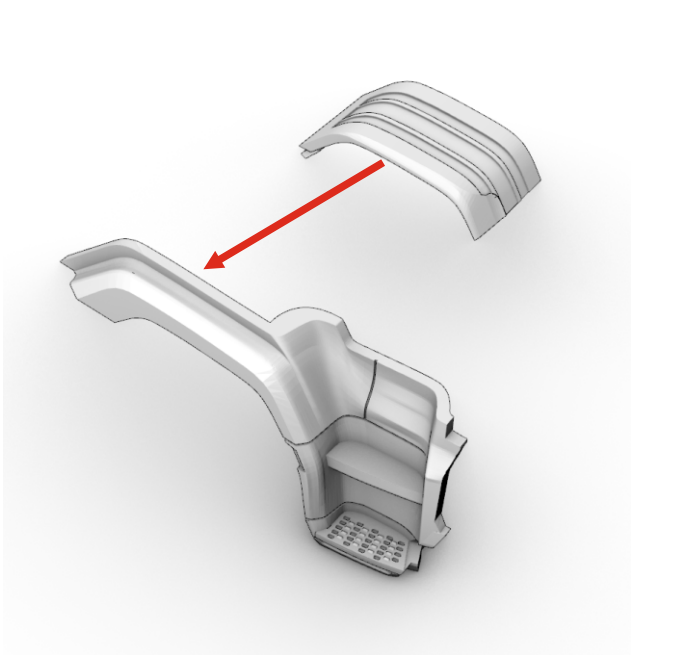

71.  x2

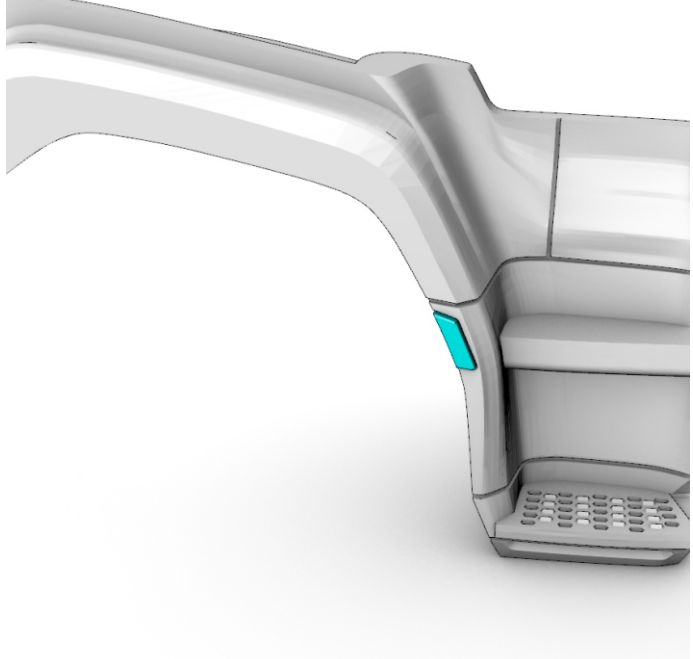

72.  x2

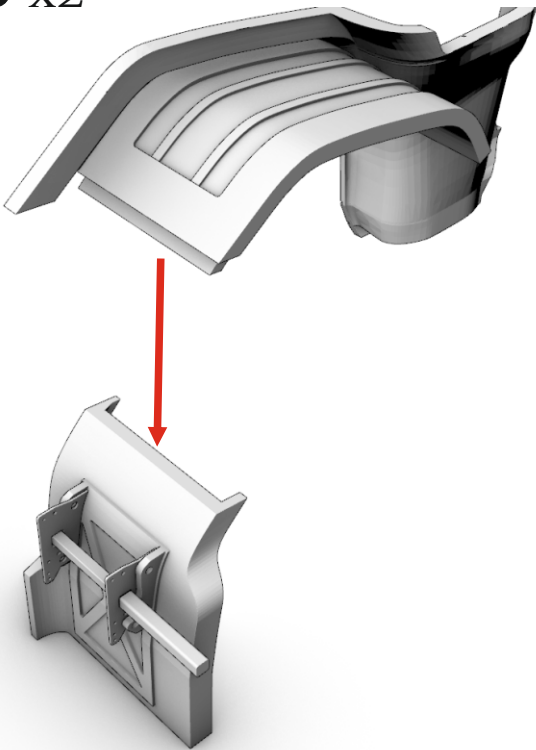

!

The following steps for Italeri donor chassis.
If you use photo-etched chassis by A&N - refer assembling instruction for chassis.

73.  x2

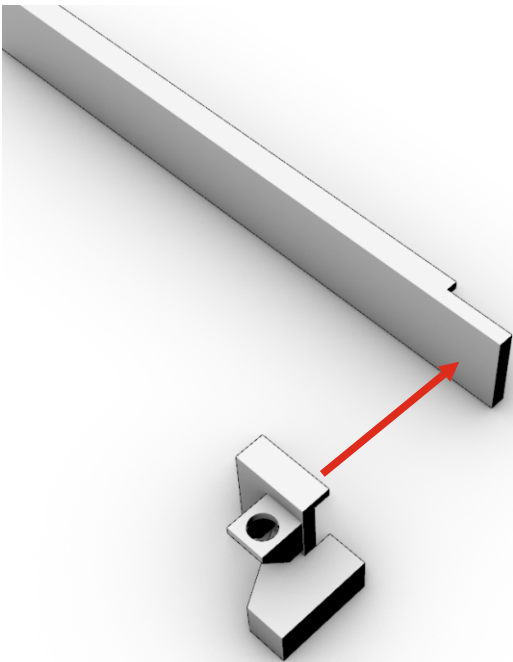

74. 

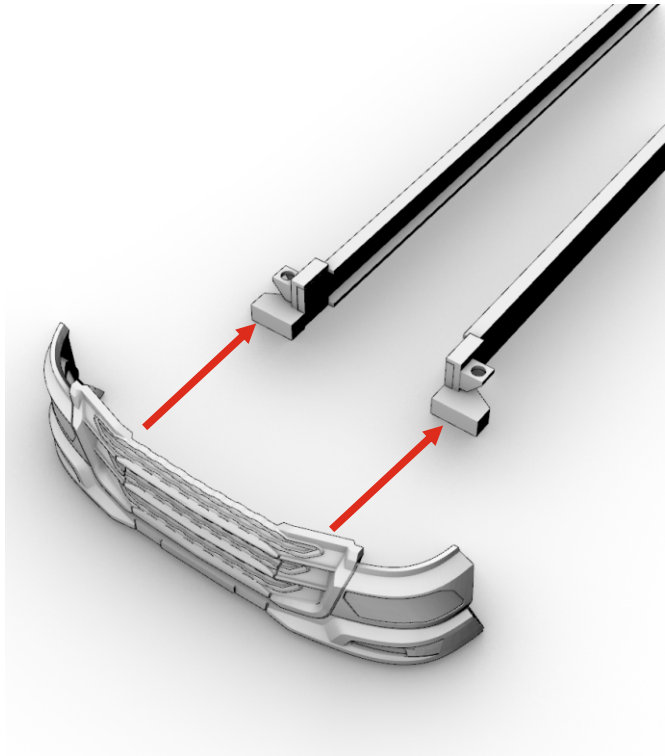

75.  x2

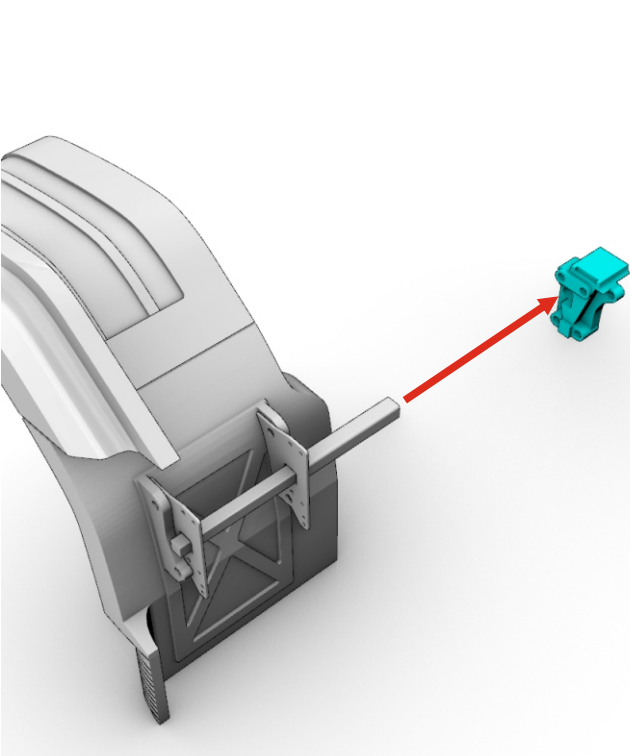

76.  x2

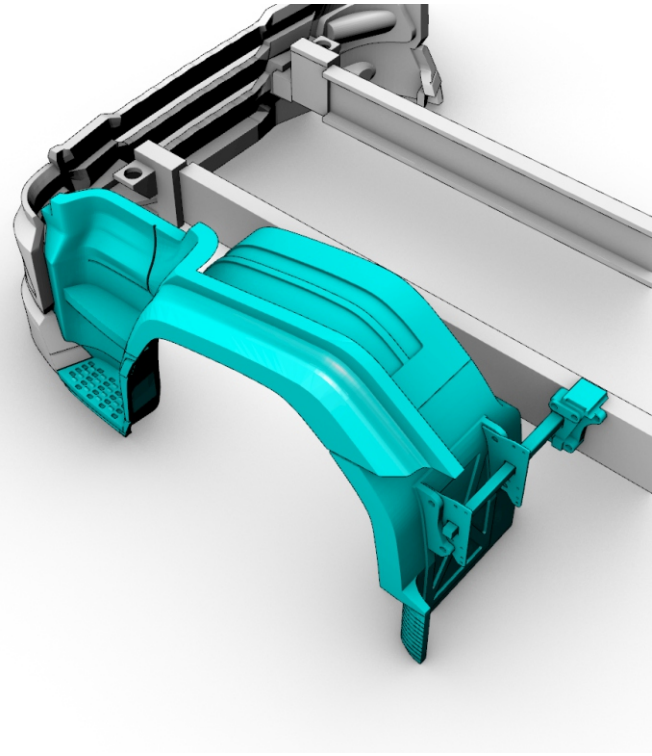

77.  x2

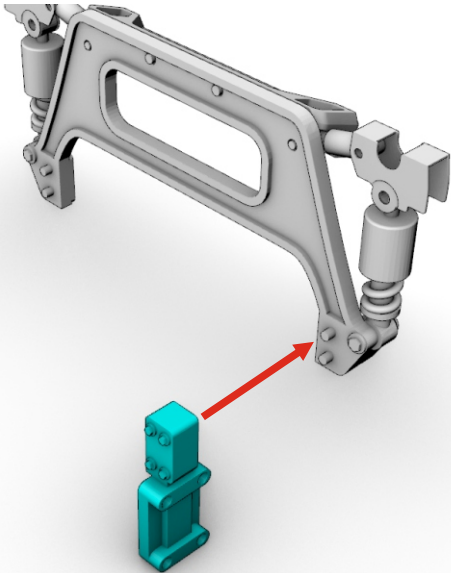

78. 

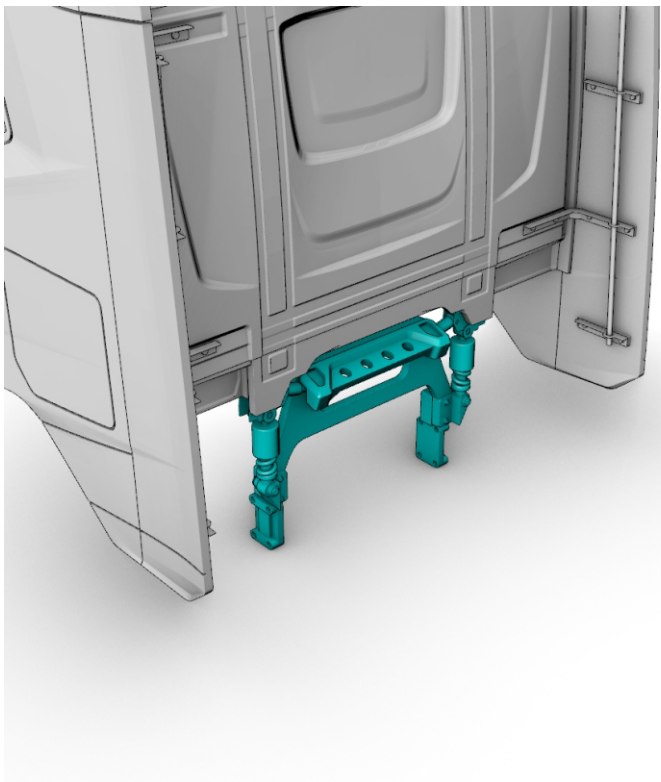

79. 

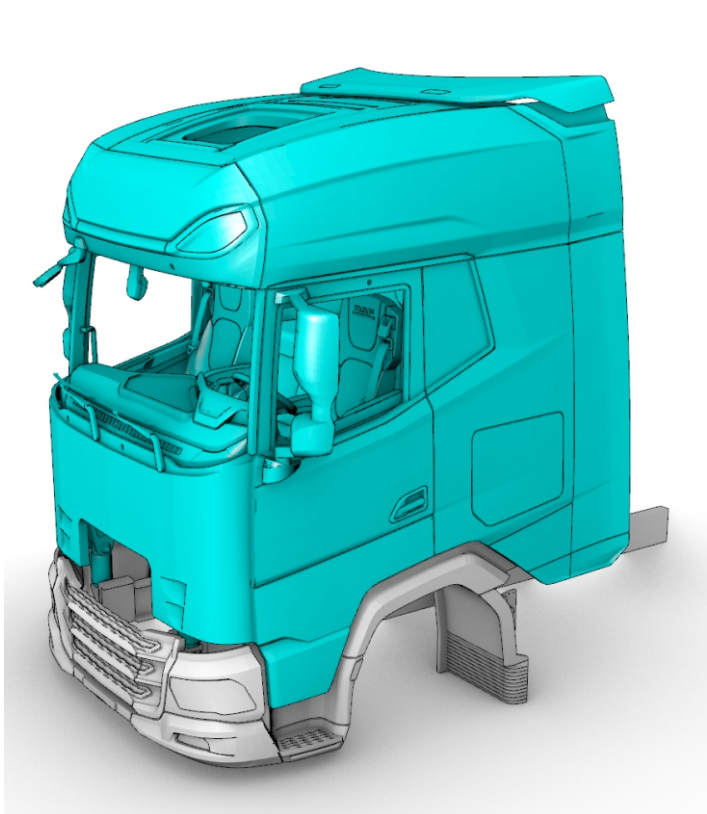

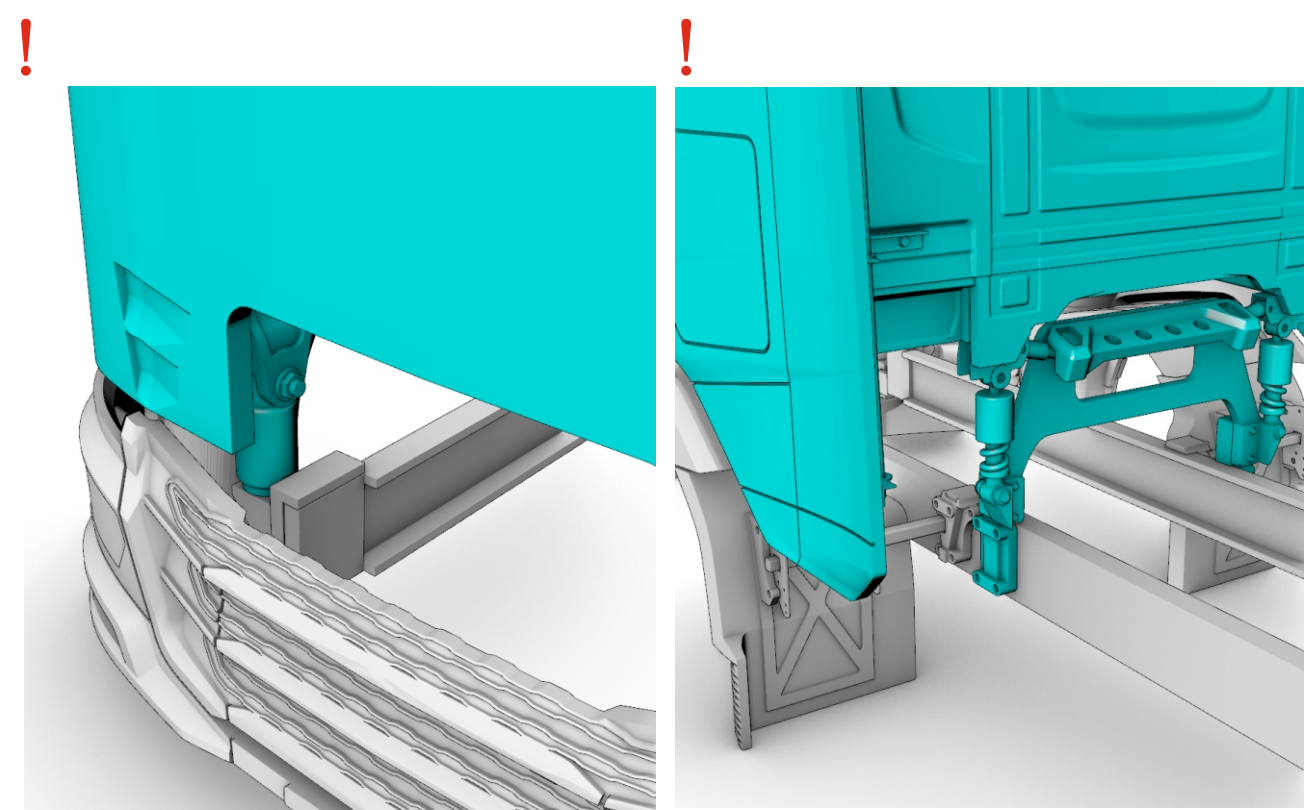

80. 

PE-parts #9

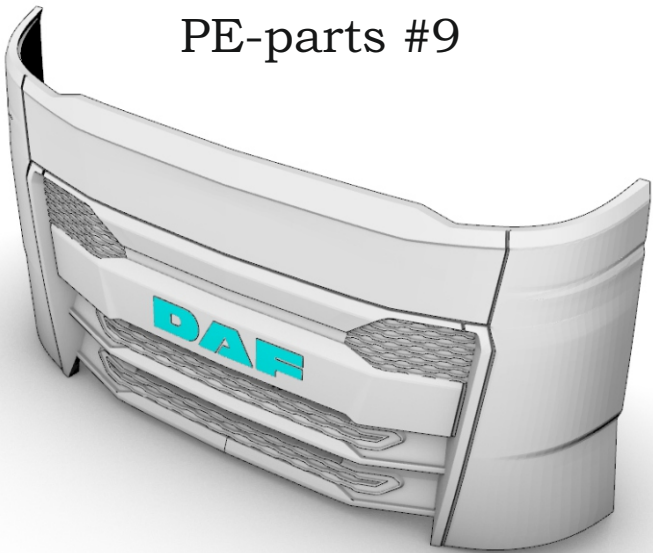

81. 

