

A&N Model Trucks

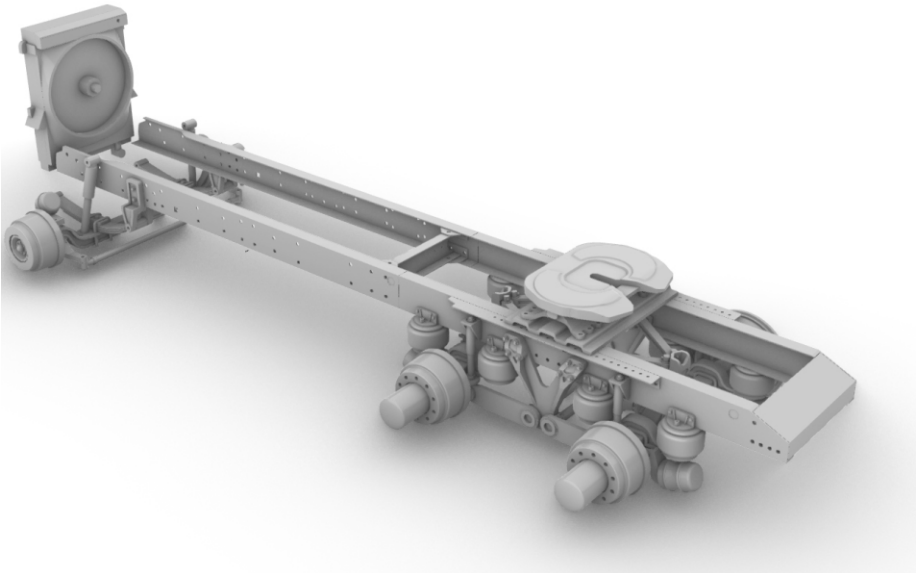

Chassis for Aussie
T610 SAR truck
(day cab).

Resin kit, 1/24

Warning!

Please follow this instruction while assembling, otherwise you could face problems with assembling the model.

Photo-etched parts have sharp edges, please be careful.

This model kit contains small parts and is not suitable for children.

This model is for advanced modellers only.

Symbols:

 - glue parts;

 - do not glue parts;

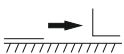
 - bend parts;

 - attention;

 - moving parts;

 - your choice;

 - frame rails holes' numbers;

Chassis for Aussie T610 SAR (dav cab) truck. Resin kit, 1/24

1. 

2. 

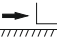
3.  x4

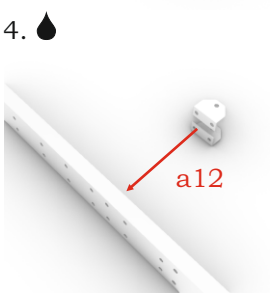
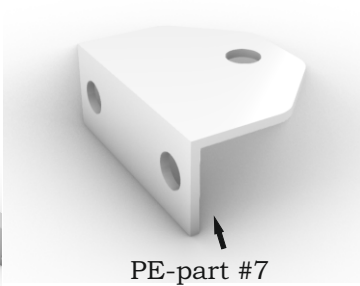
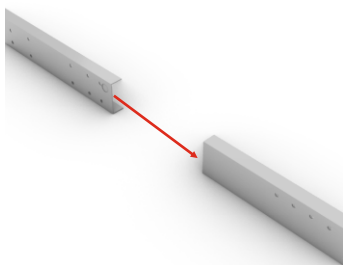
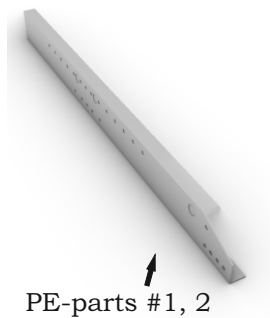

5.  x4

6. 

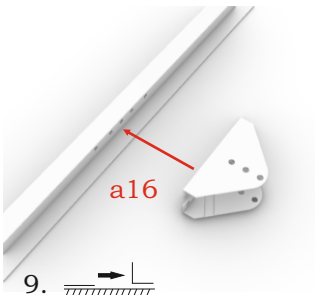
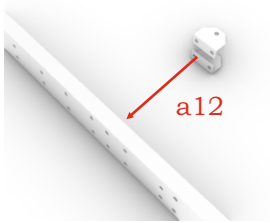

7. 

8. 

9. 

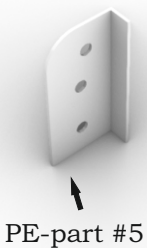
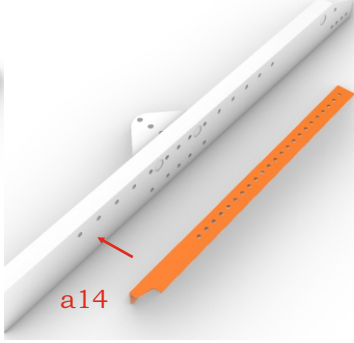
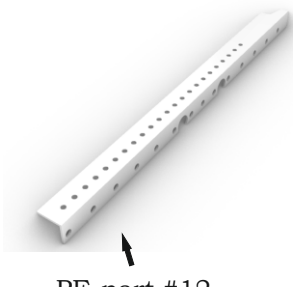

10. 

11.

12. 

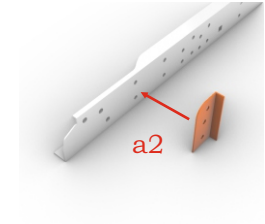

Repeat steps
1-10 for right
side

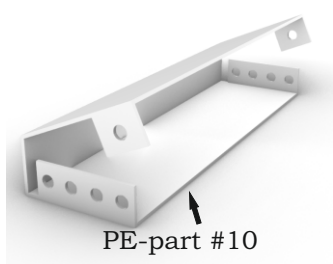

Chassis for Aussie T610 SAR (day cab) truck. Resin kit, 1/24

13. 

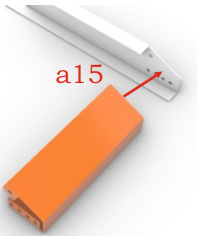

14. 

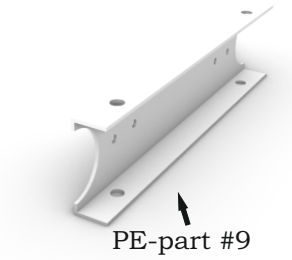

15. 

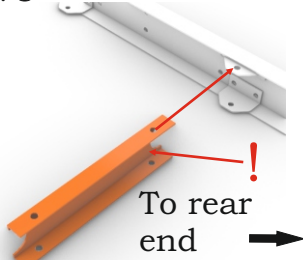

16. 

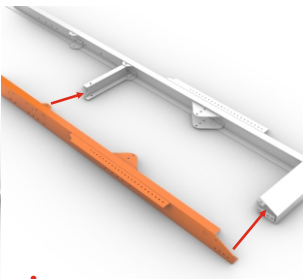
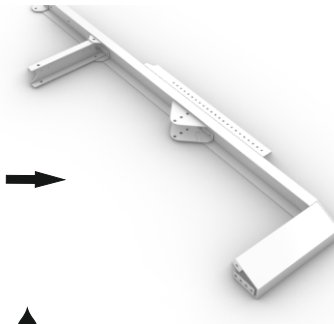

17. 

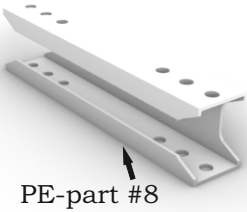

18. 

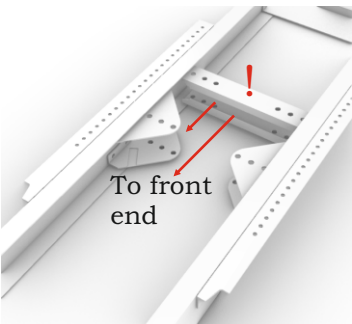

!

Green parts in this instruction are from T610 cab kit.

19.  x2

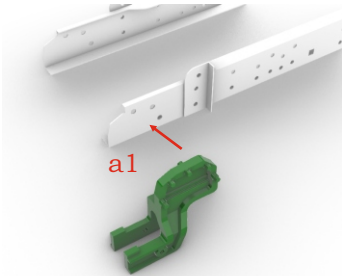

20. 

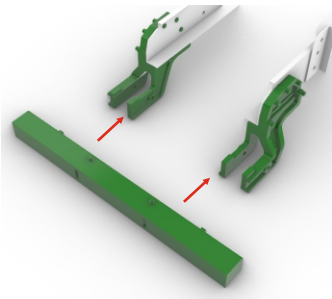

21.  x2

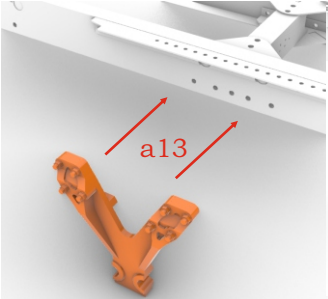

22.  x2

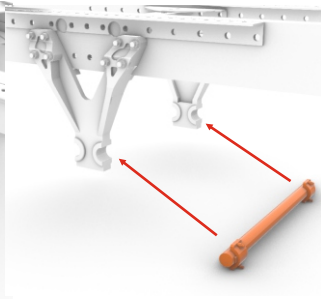

Chassis for Aussie T610 SAR (day cab) truck. Resin kit, 1/24

23. 1 x2

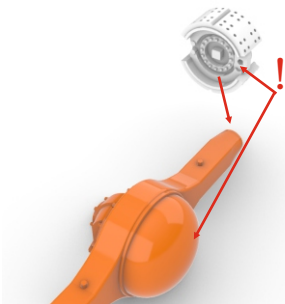

! Find this mark

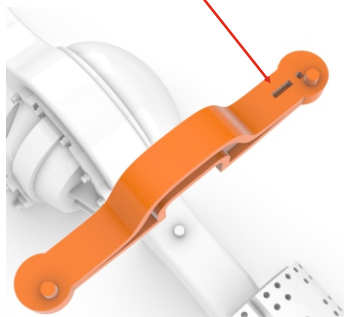

24. 1

To rear end;
! left side

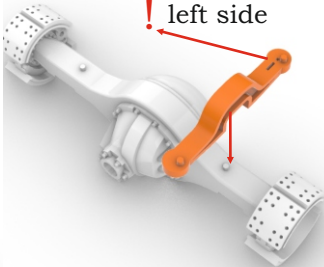

25. 1

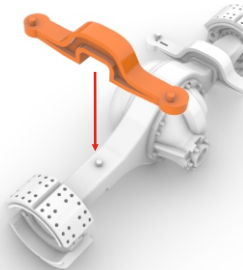

26. 1 x2

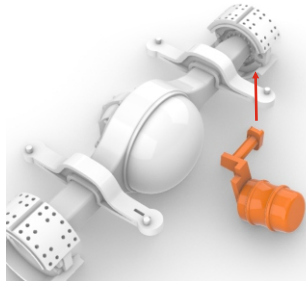

27. 1 x2

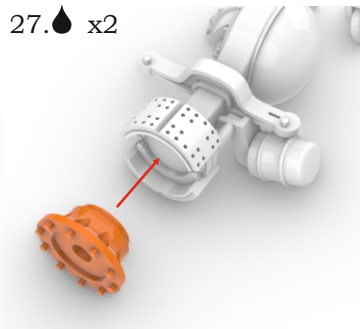

28. 1 x2

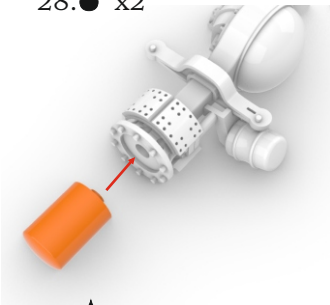

29. 1 x2

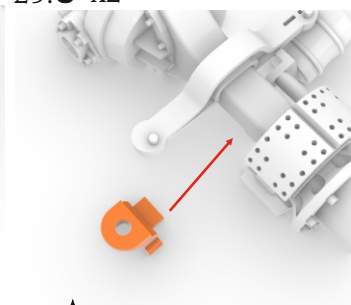

30. 1

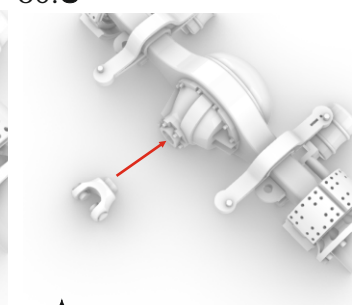

31. 1 x4

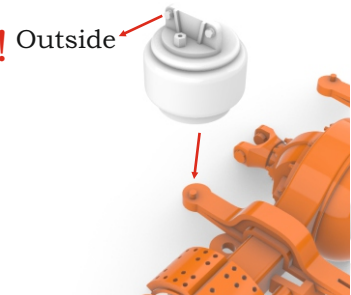

32. 1

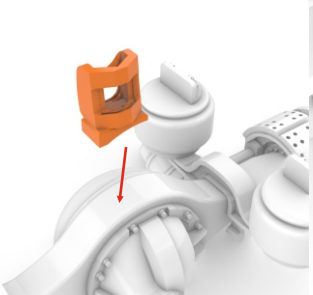

33. 1 x2

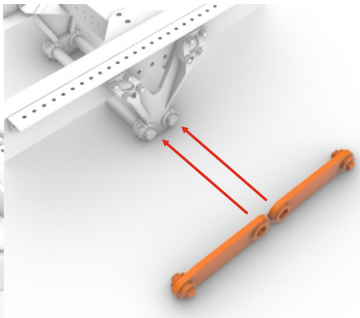

Chassis for Aussie T610 SAR (day cab) truck. Resin kit, 1/24

34.●

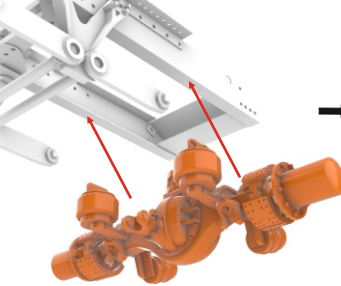

35.●

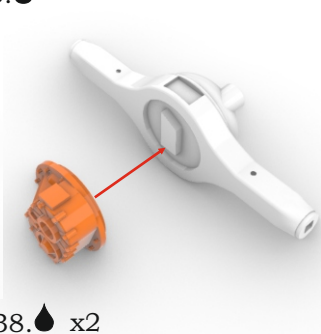

36.● x2

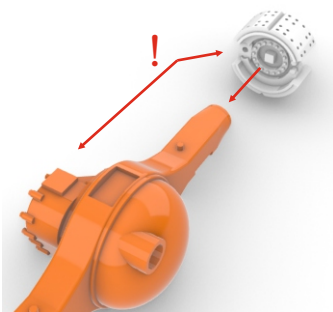

37.● x2

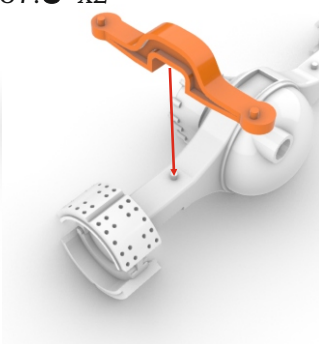

38.● x2

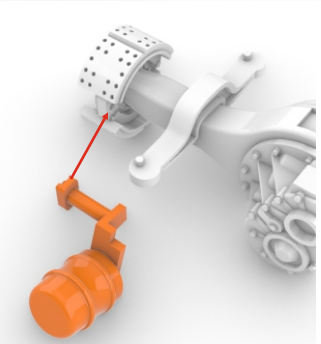

39.● x2

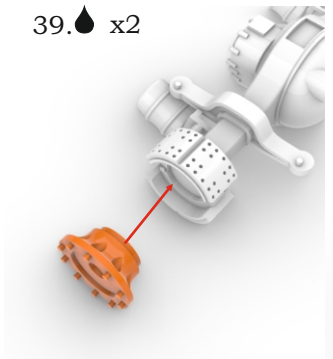

40.● x2

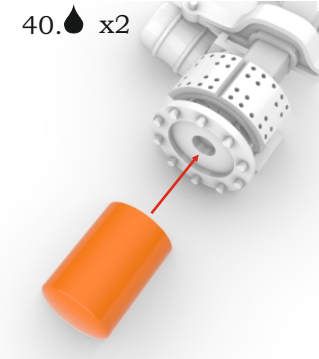

41.● x2

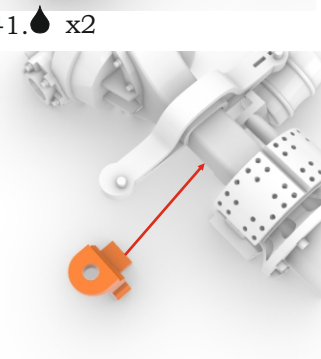

42.●

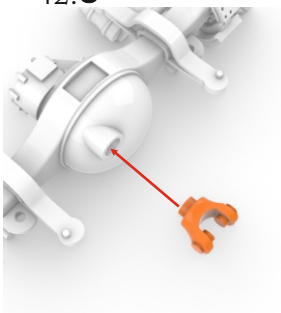

43.●

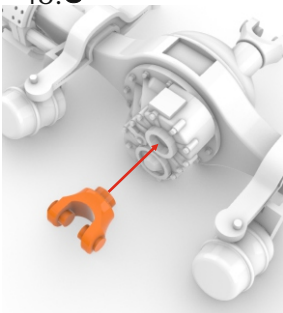

44.● x4

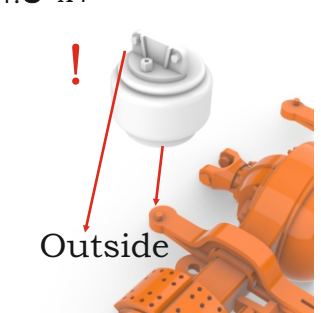

Chassis for Aussie T610 SAR (day cab) truck. Resin kit, 1/24

45.🔹

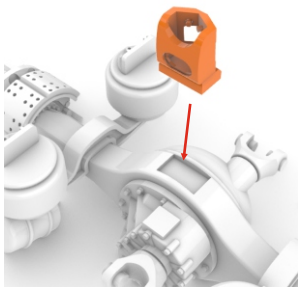

46.🔹

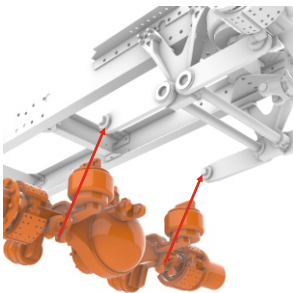

47.🔹 x4

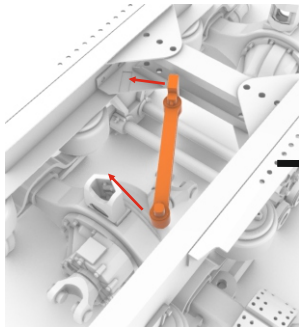

48.🔹

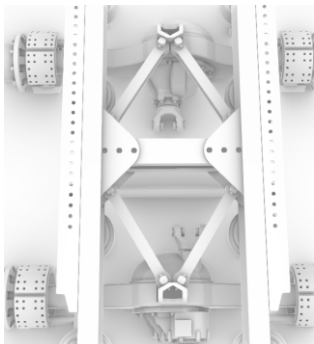

49.🔹 x4

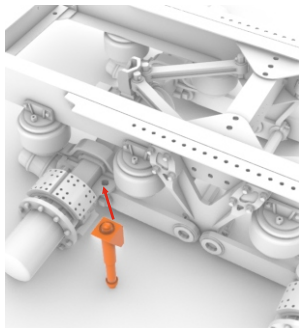

50.🔹 x4

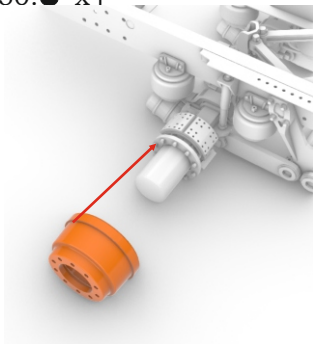

51.🔹

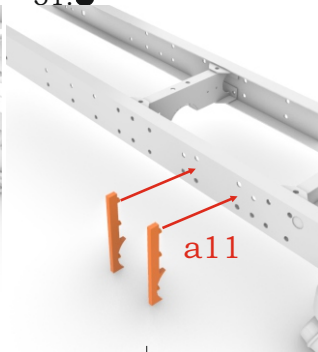

52.🔹

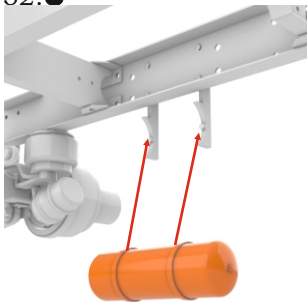

53.🔹

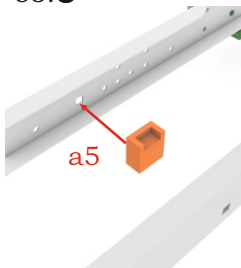

54.🔹

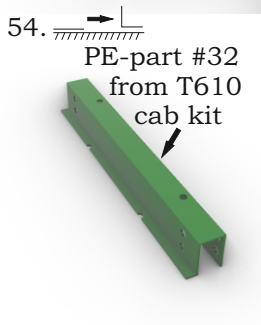

55.🔹

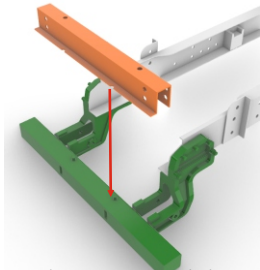

Chassis for Aussie T610 SAR (day cab) truck. Resin kit, 1/24

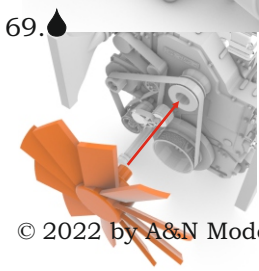
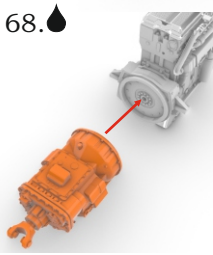
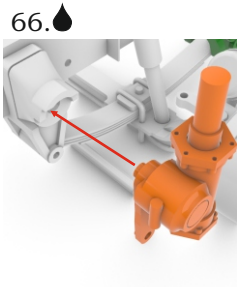
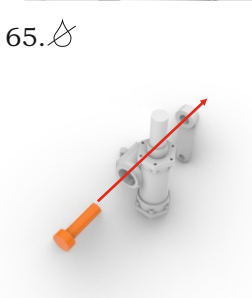
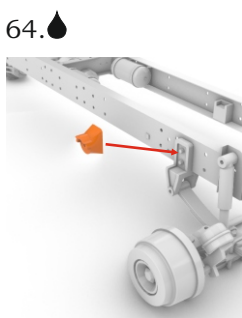
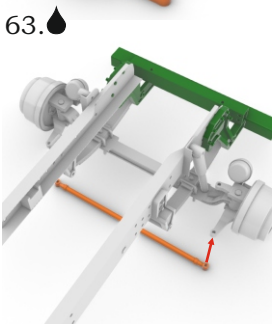
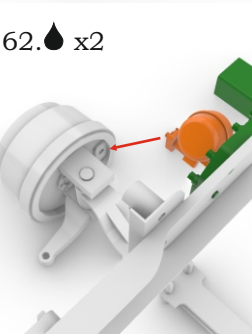
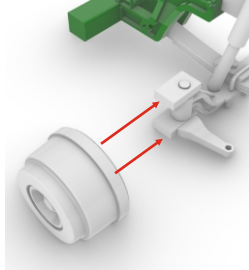
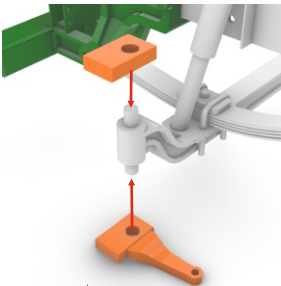
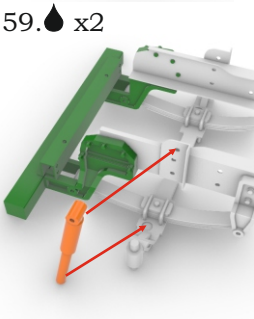
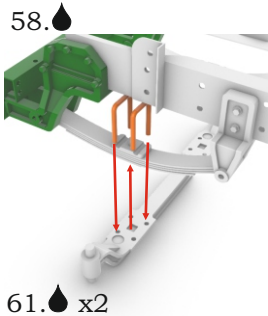
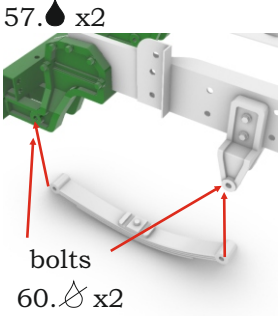
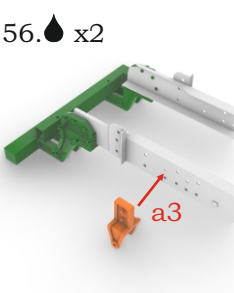

!

The engine in
this instruction -
X15 engine by
A&N Model Trucks

Chassis for Aussie T610 SAR (day cab) truck. Resin kit, 1/24

