

A&N Model Trucks

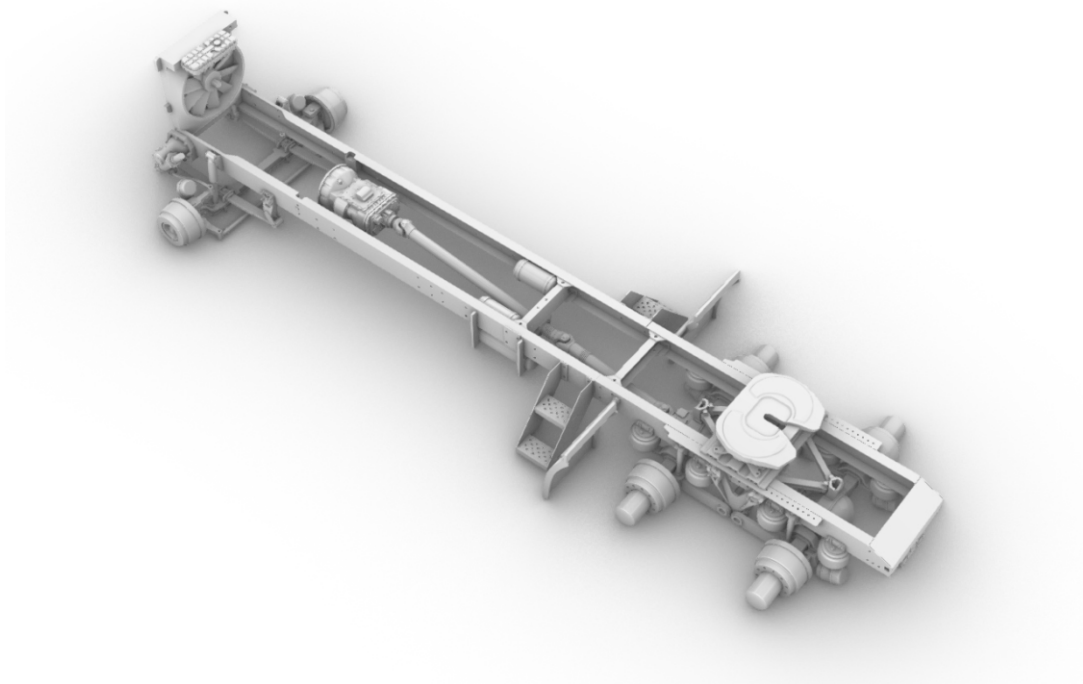

Chassis for
US W990 truck
(day cab)

Scale 1/24

Warning!

Read carefully this instruction and please follow it during assembling, otherwise you could face problems with assembling the model.

Photo-etched parts have sharp edges, please be careful.

This model kit contains very small parts and is not suitable for children.

This model kit is for advanced modellers only!

Symbols:

 - glue parts;

 - do not glue parts;

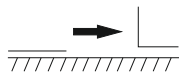
 - bend parts;

 - attention;

 - moving parts;

 - your choice;

 - cut;

A1 - apertures' number;

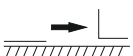
1. 

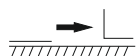
2. 

3. 

PE-part #1

PE-part #3

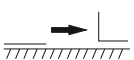
4.  x4

5. 

6. 

PE-part #5

a16

a17

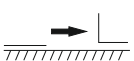
7.  x8

8. 

9. 

PE-part #6

a11

a13

a5

Chassis for US W990 truck (day cab), Resin kit, 1/24

10.

11.

12.

Repeat steps
1-9 for
right side

PE-part #7

a18

13.

14.

15.

PE-part #10

16.

17.

18.

PE-part #9

PE-part #18

19. 

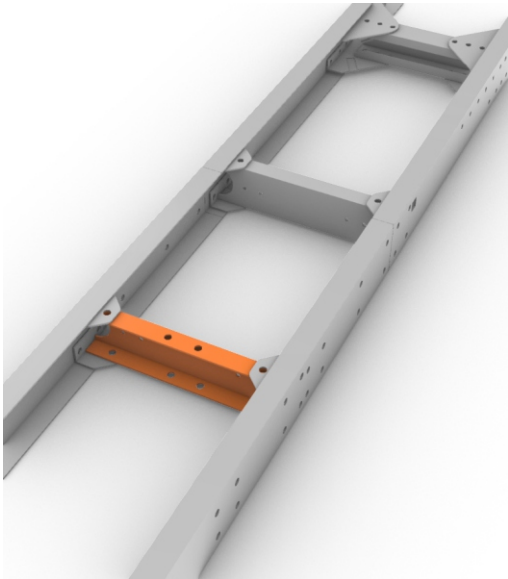

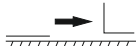
20.  x2

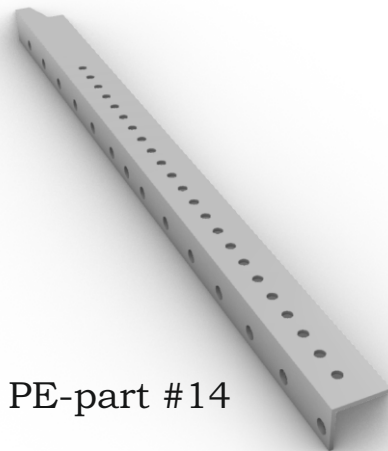

PE-part #14

21.  x2

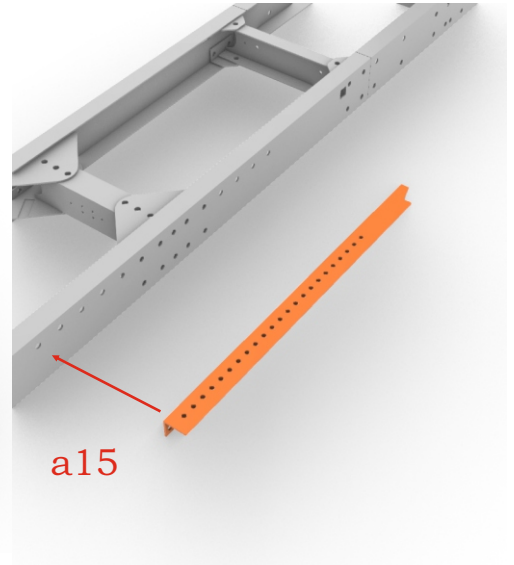

22.  x2

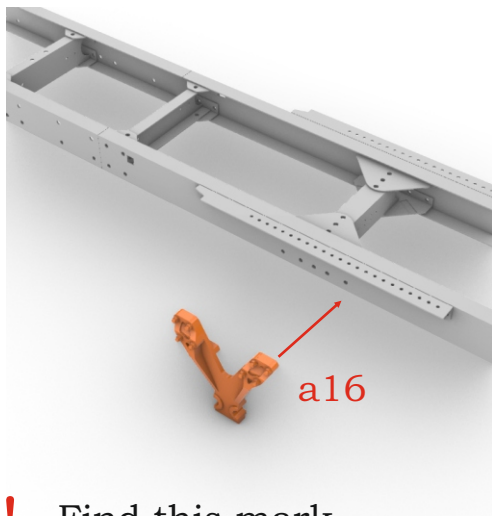

23.  x2

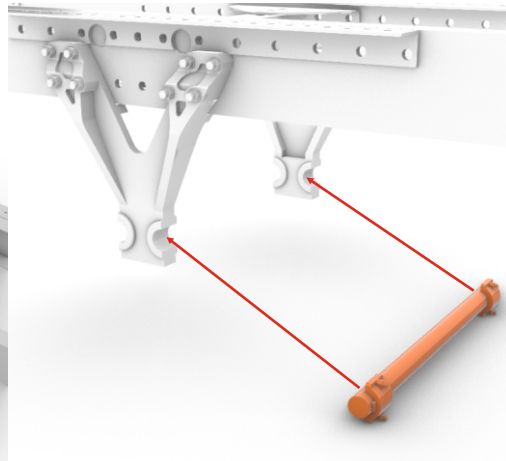

24.  x2

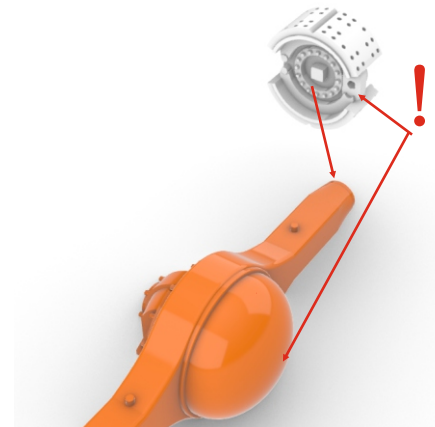

! Find this mark

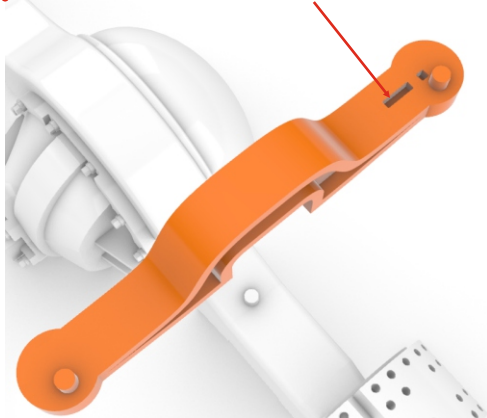

25.  To rear end;
! left side

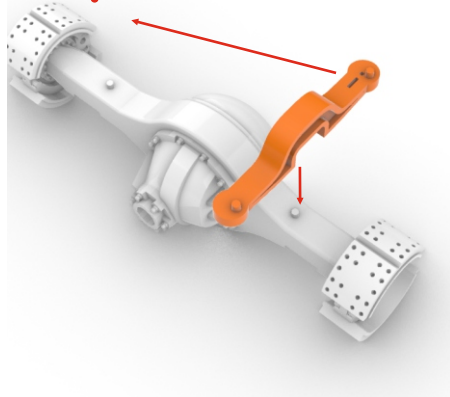

26. 

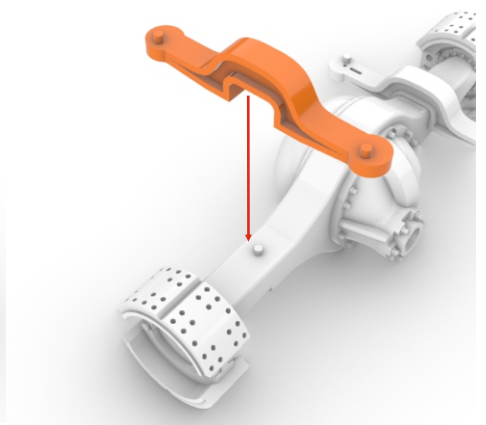

27.  x2

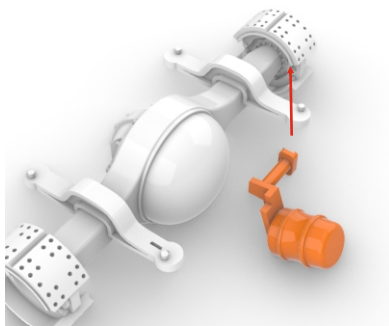

28.  x2

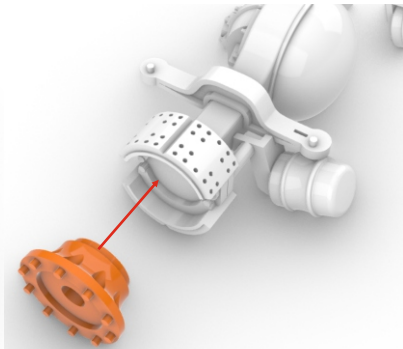

29.  x2

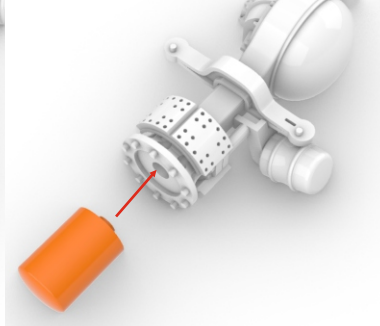

30.  x2

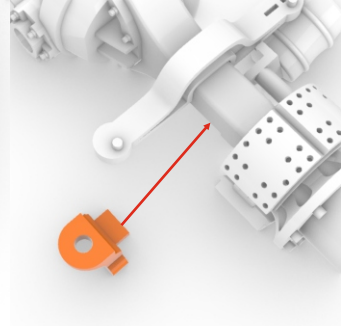

31. 

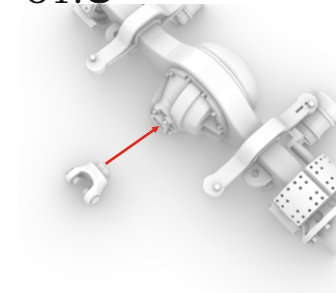

32.  x4

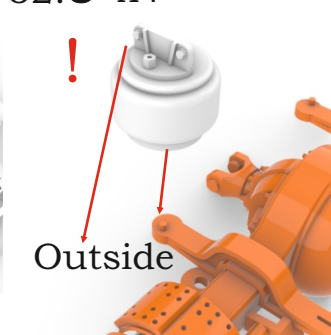

33. 

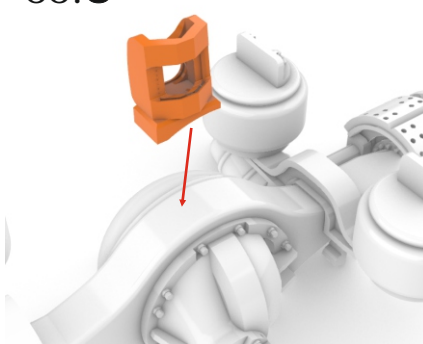

34.  x2

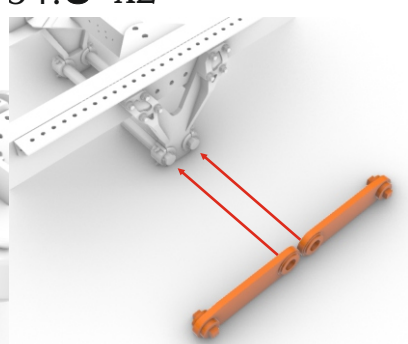

35. 

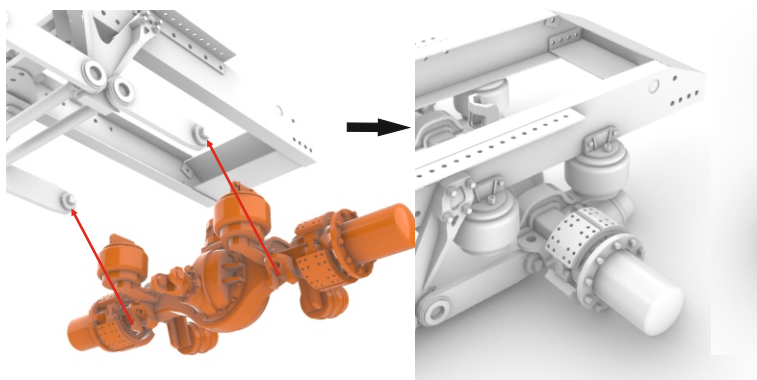

36. 

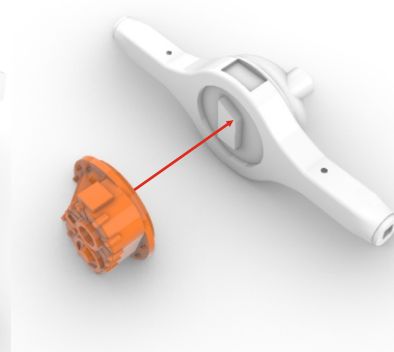

37.  x2

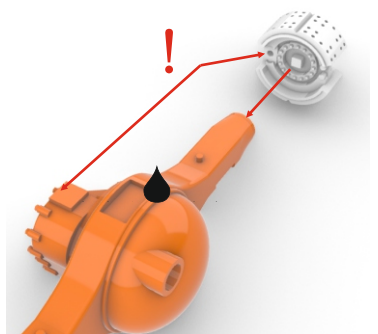

38.  x2

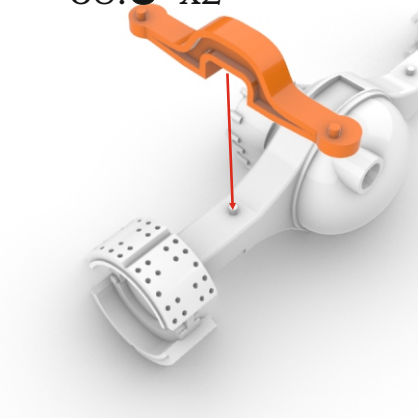

39.  x2

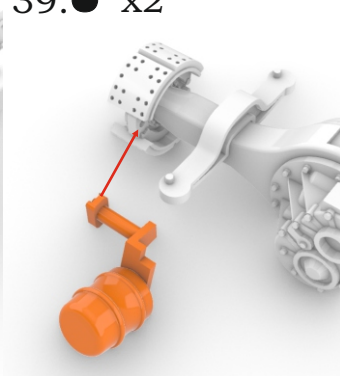

40.  x2

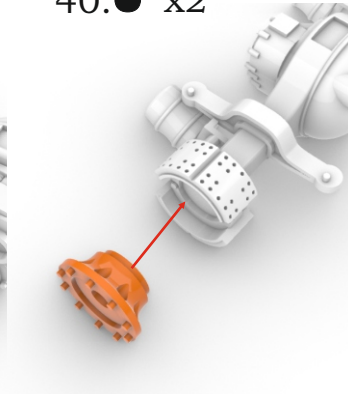

41.  x2

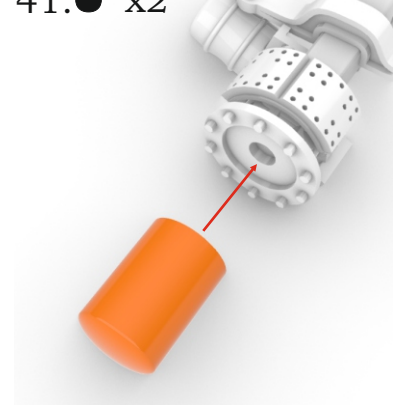

42. x2

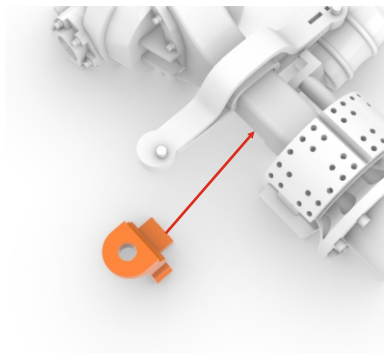

43.

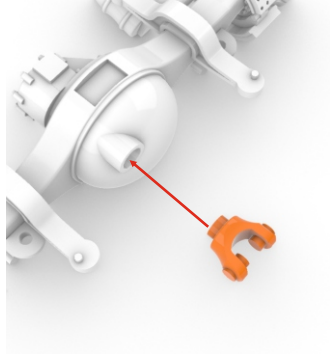

44.

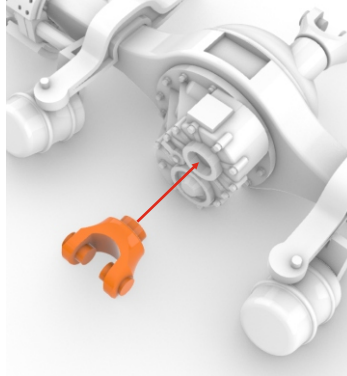

45. x4

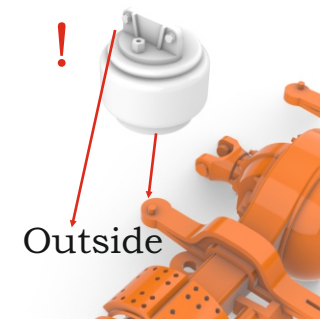

46.

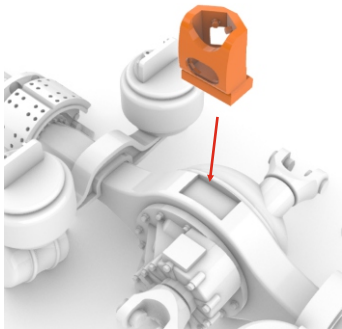

47.

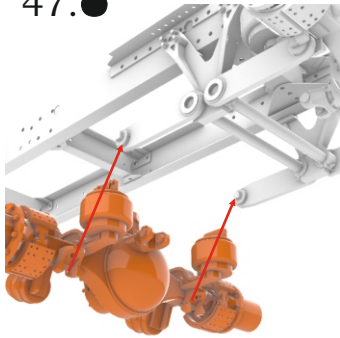

48. x4

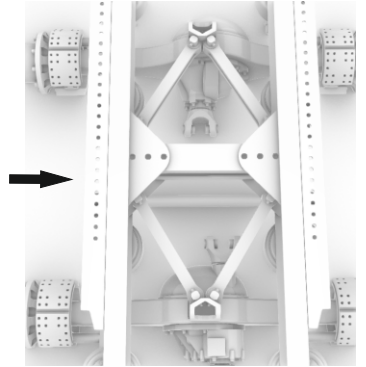
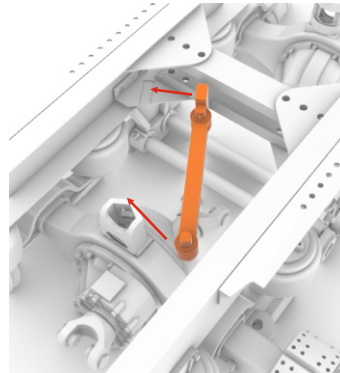

49.

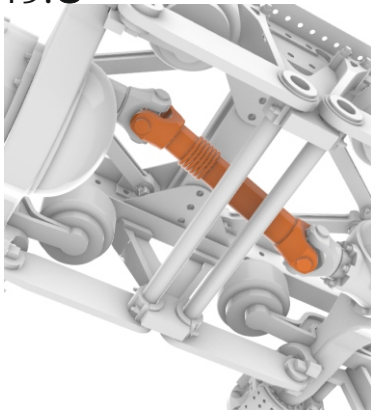

50. x4

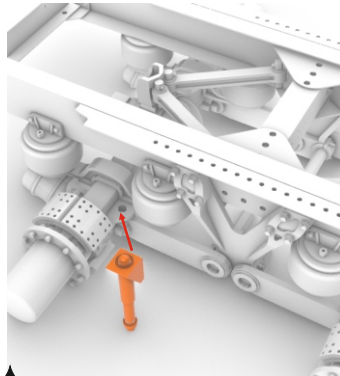

51. x4

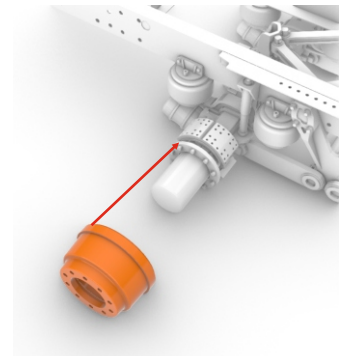

52.

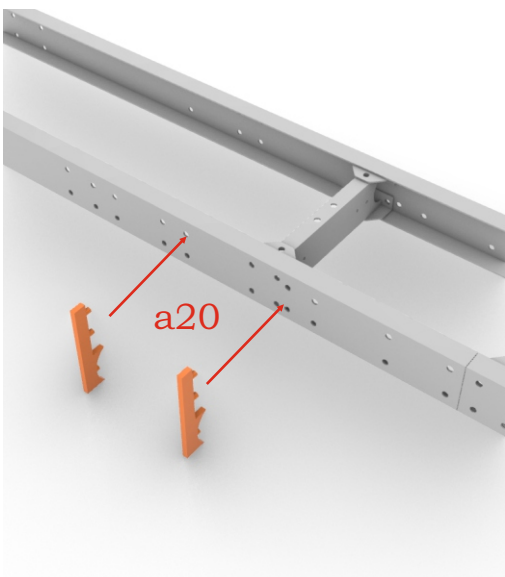

53.

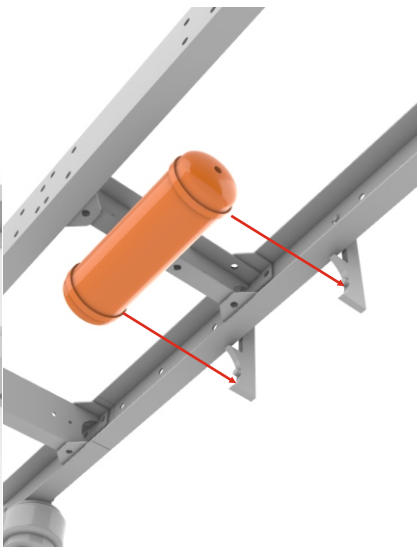

54. x2

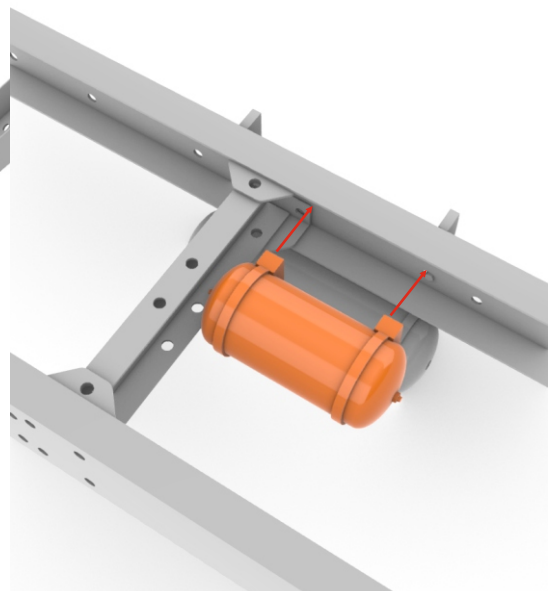

55.

Perform steps 37-40
of US W990 truck
assembling instruction.

56.  x2

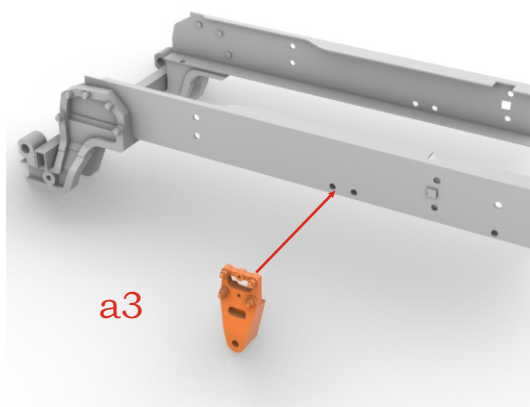

57.  x2

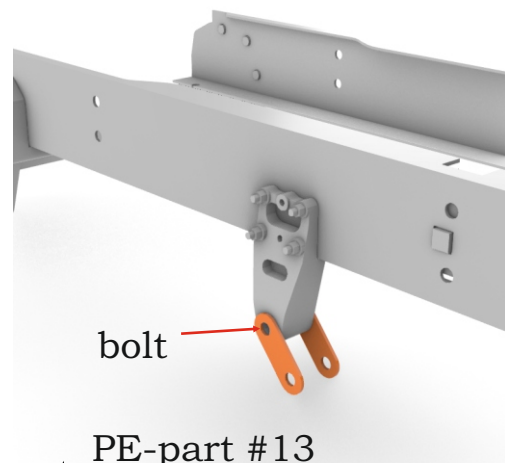

58.  x2

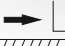
59.  x2

60.  x2

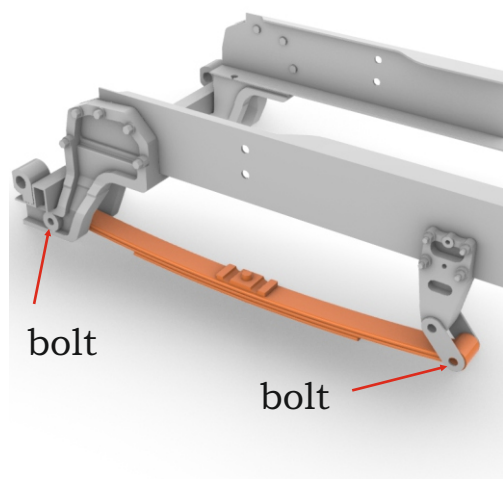

PE-part #15

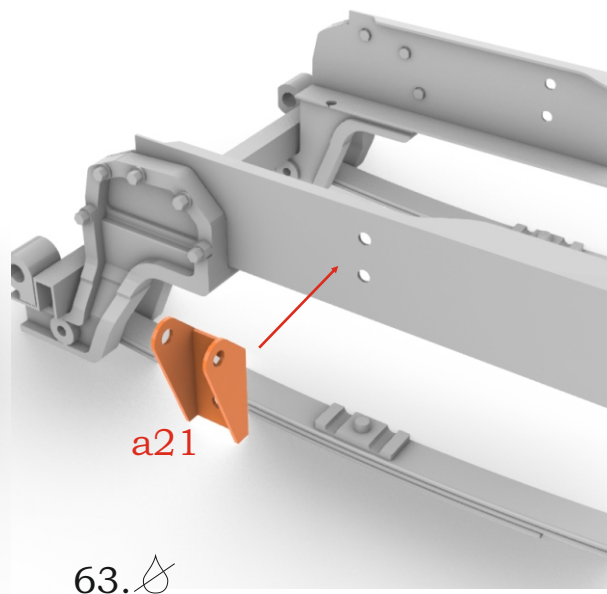
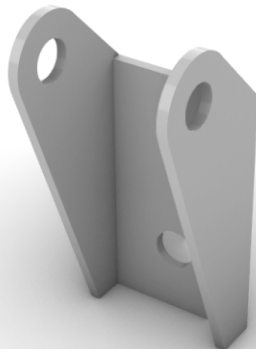

61. 

62. 

63. 

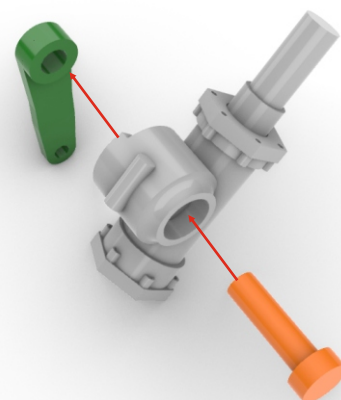
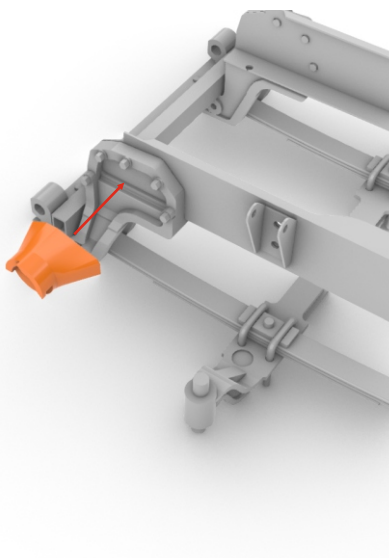
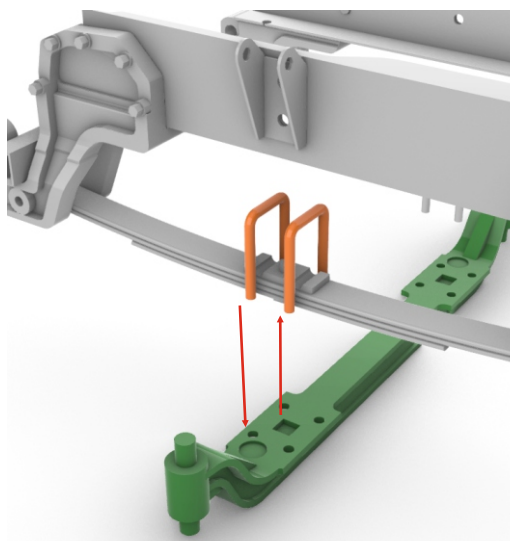

64.●

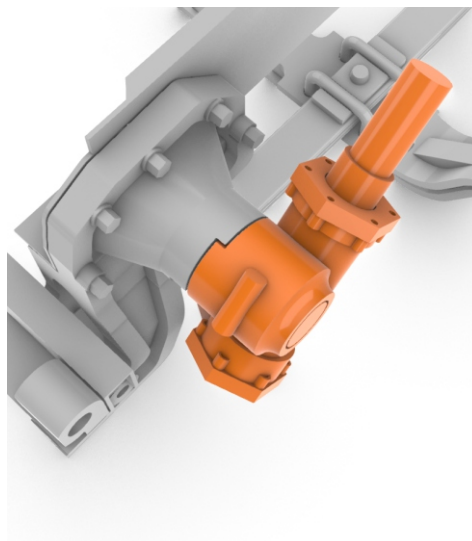

65.●

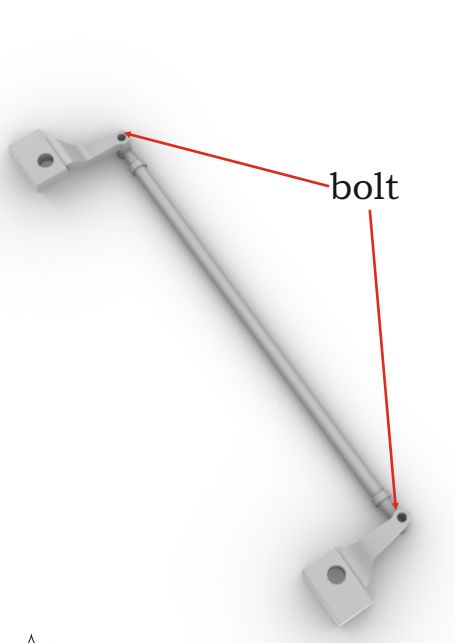

66.✂

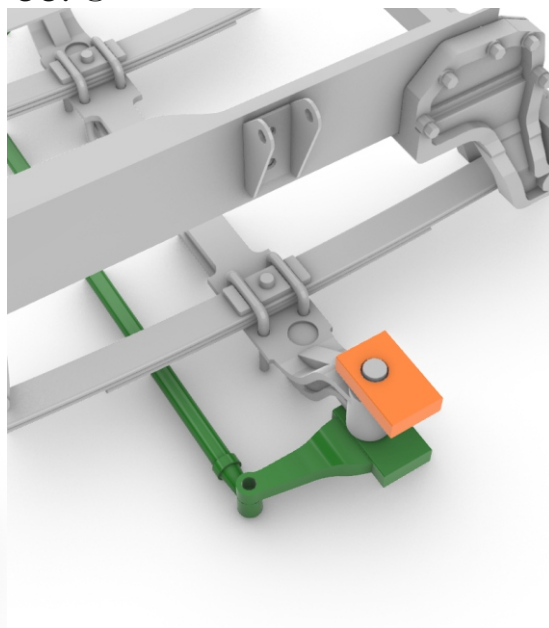

67.●

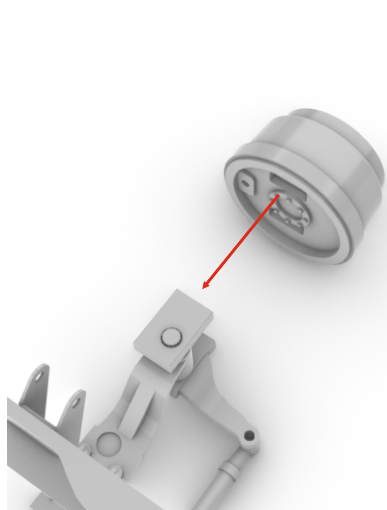

68.✂

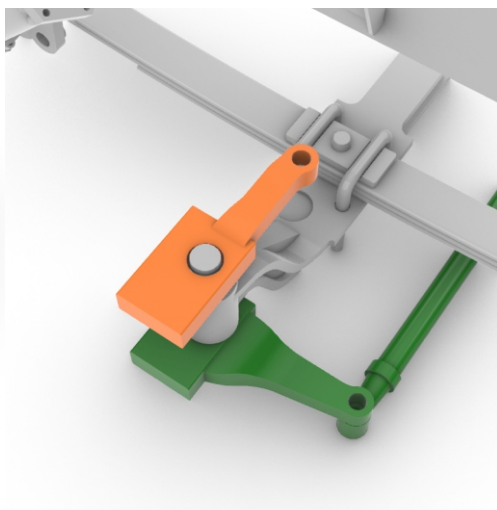

69.●

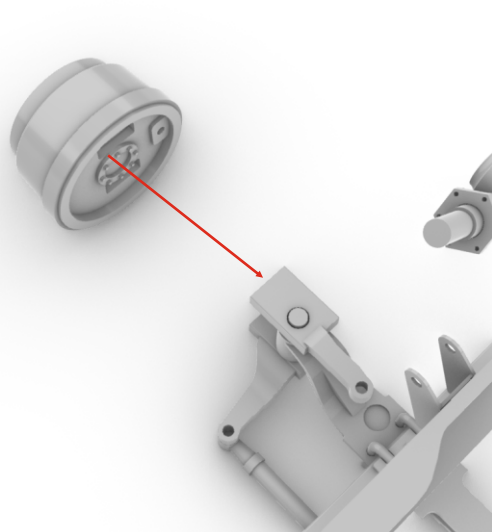

70.● x2

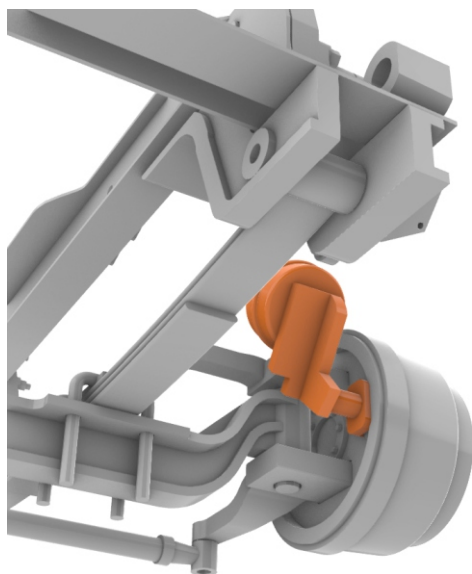

71.● x2

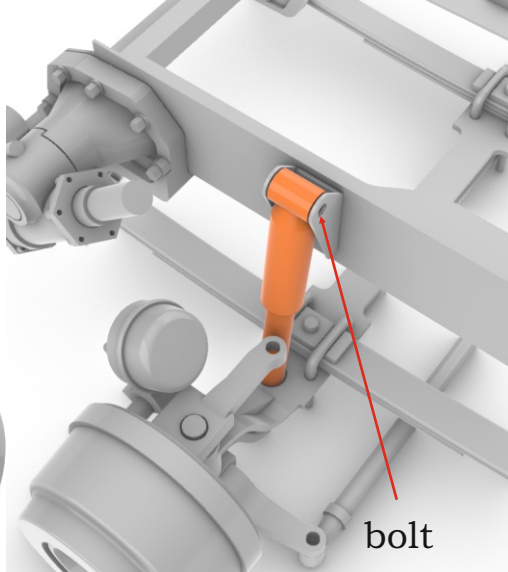

72.●

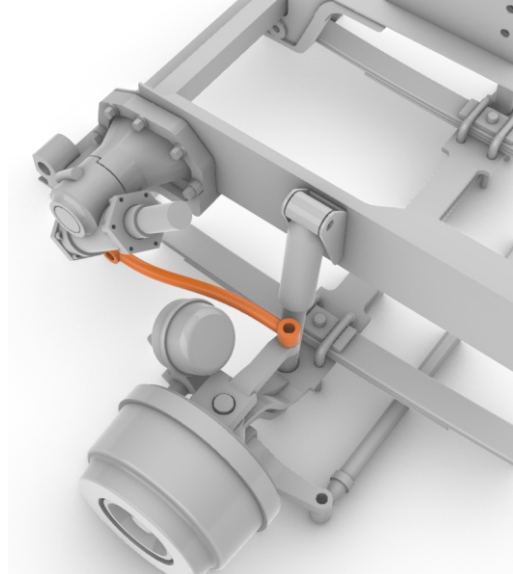

73. 

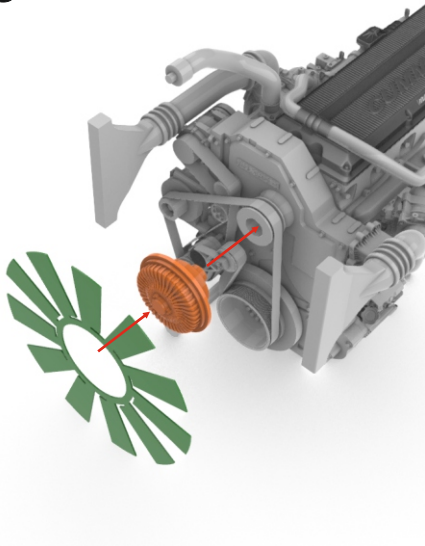

74. 

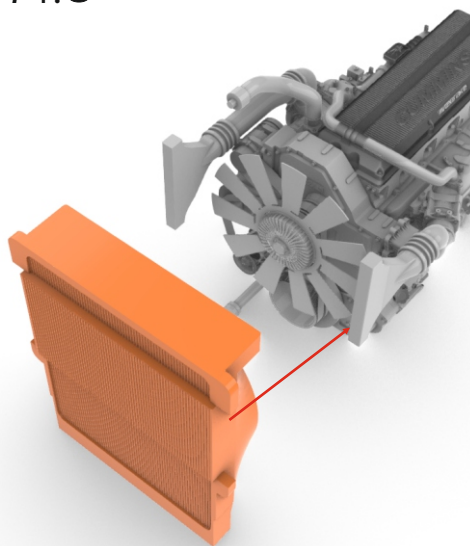

75. 

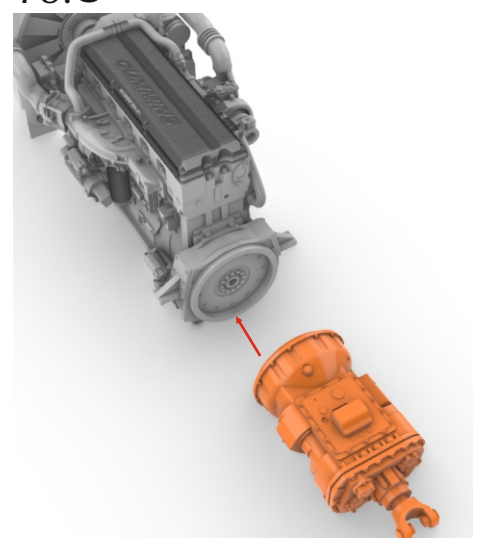

76. 

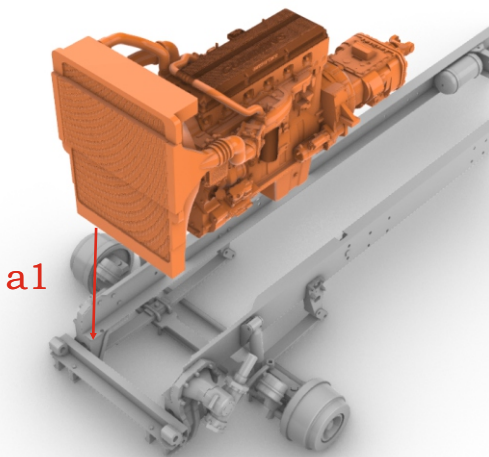

77.

Perform steps 41-83
of US W990 truck
assembling instruction.

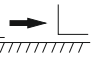
78.  x4

PE-part #12

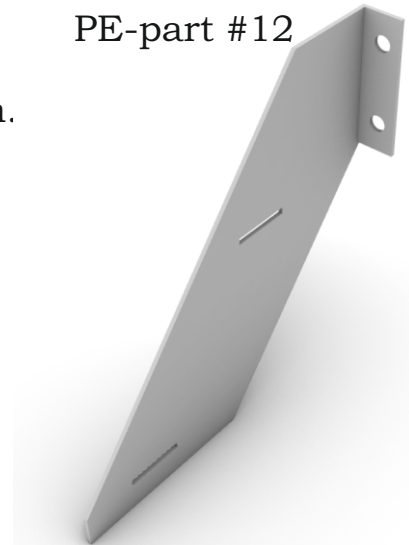

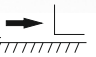
79.  x4

PE-part #17

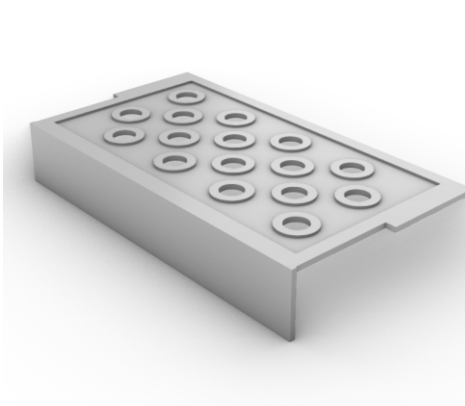

80.  x2

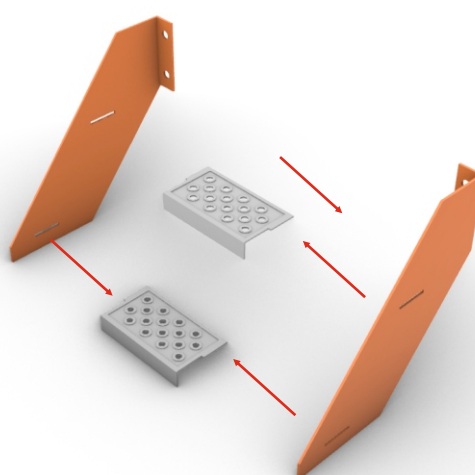

81.  x2

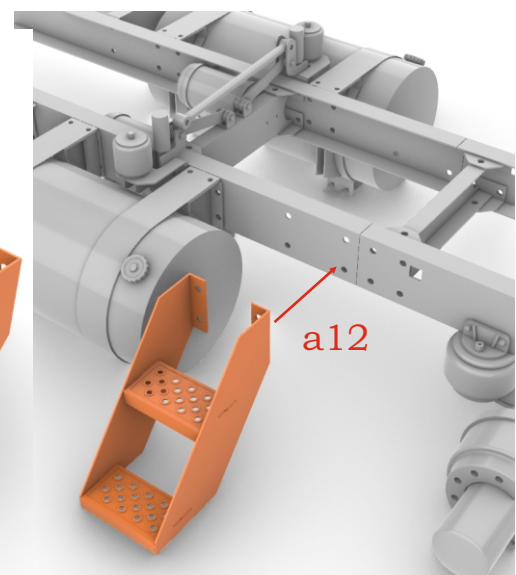

82.  x2

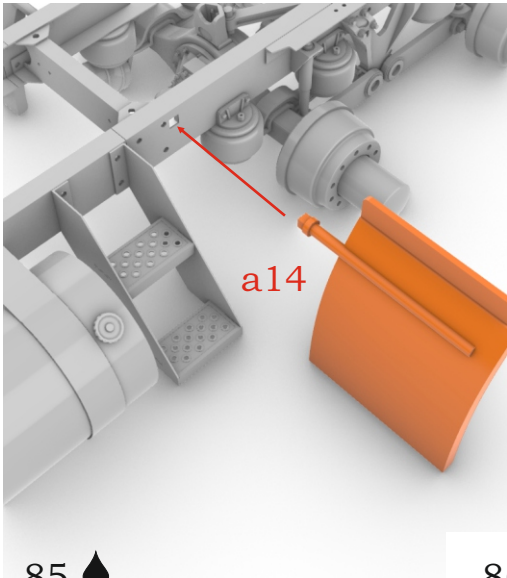

83. 

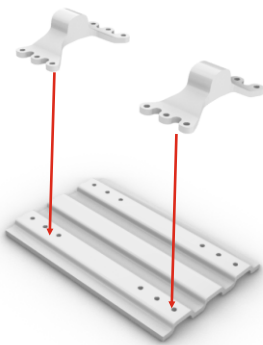

84. 

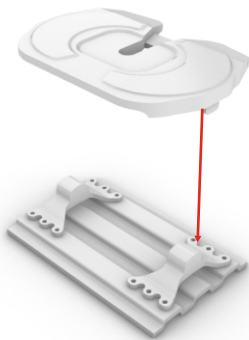

85. 

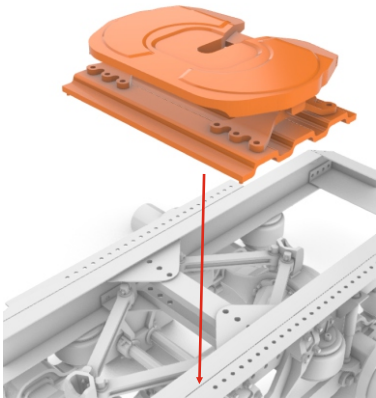

86. 

PE-part #11

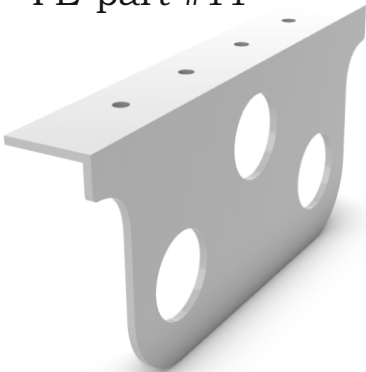

87. 

clear parts

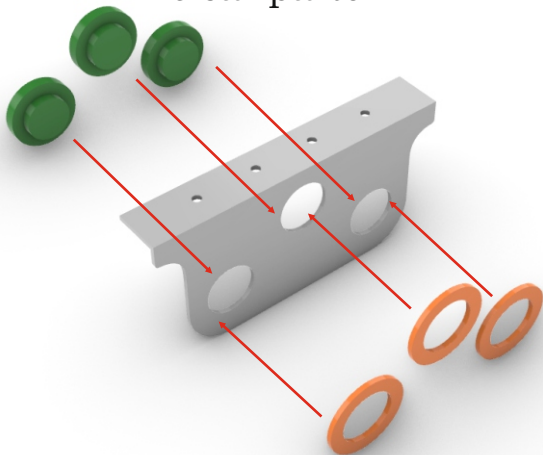

PE-part #16

88. 

