

A&N Model Trucks



Aussie Argosy truck.
Resin kit, 1/24

Warning!

For the best results we highly suggest to use our photo-etched chassis for Aussie Argosy truck. But you still can use an Italeri's generic American chassis (except Volvo VN and Peterbilts).

Read carefully this instruction and please follow it during assembling, otherwise you could face problems with assembling the model.

Photo-etched parts have sharp edges, please be careful.

This model kit contains very small parts and is **not suitable for children**.

This model kit is for advanced modellers only!

You can download this instruction as PDF-file at the our site at «Instructions» section, or use QR-code on the last page.

Symbols:

 - glue parts;

 - do not glue parts;

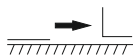
 - bend parts;

 - attention;

 - moving parts;

 - your choice;

 - cut;

! Basic guidelines for modification of Italeri's chassis

(skip this section and jump on page 7 if you use photo-etched chassis).

WARNING! We didn't test our cab kits with Italeri chassis, we can provide only basic dimensions (in mm) for chassis.

1. Frame length.

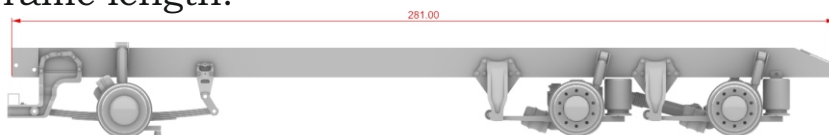

2. Wheelbase and distance between center of front wheels and front end of a frame

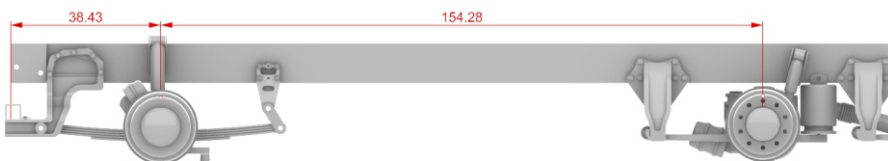

3. Dimensions for front suspension.

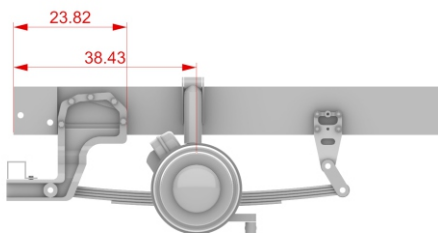

4. Installing front cab's supports.

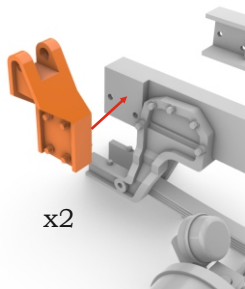

5. Max height of radiator.

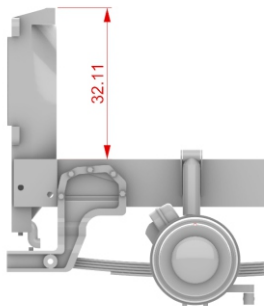

6. Distance between front end of frame and rear cab's supports.

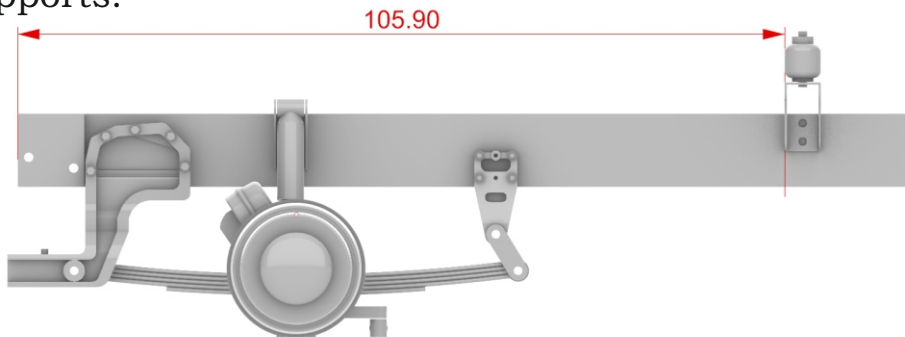

7. Distance between front end of frame and front end of fuel tanks.

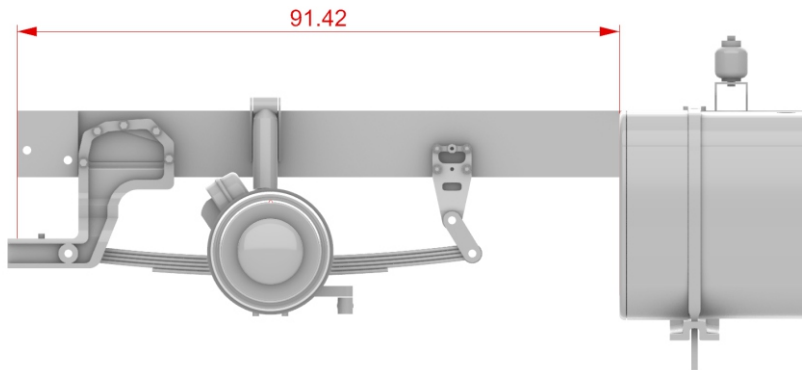

8. Distance between front end of frame and front end of battery box.

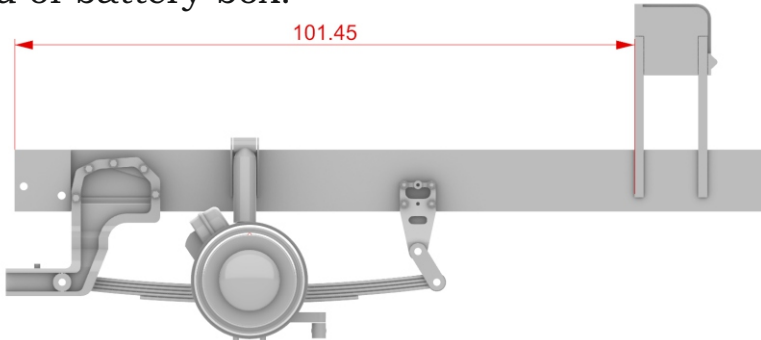

9. Distance between front end of frame and silencer's brackets.

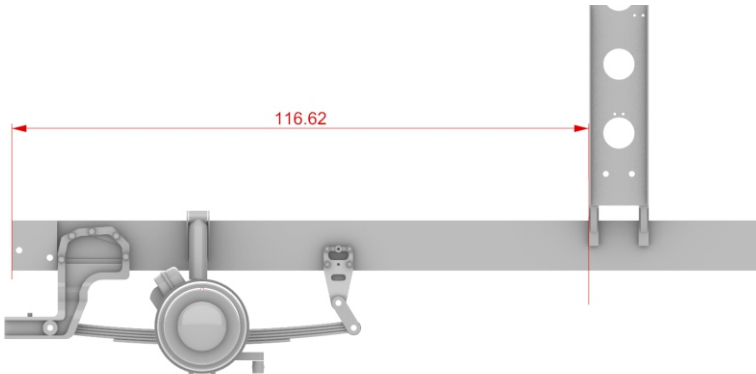

Numbers of photo-etched parts

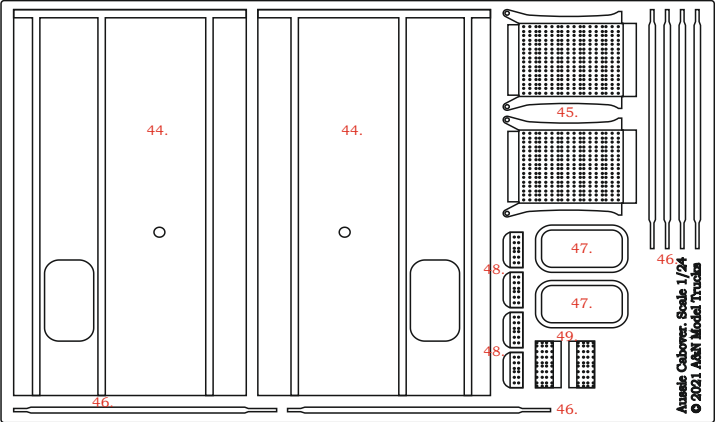
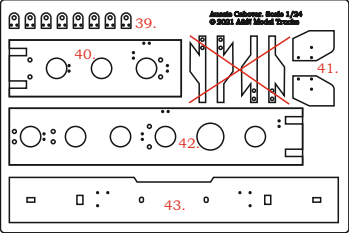
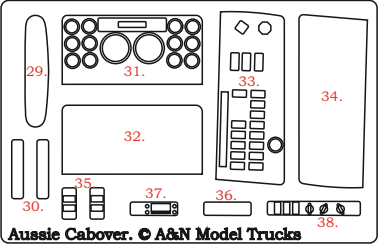
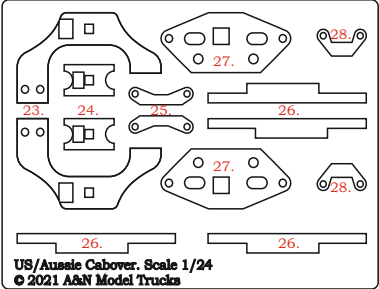
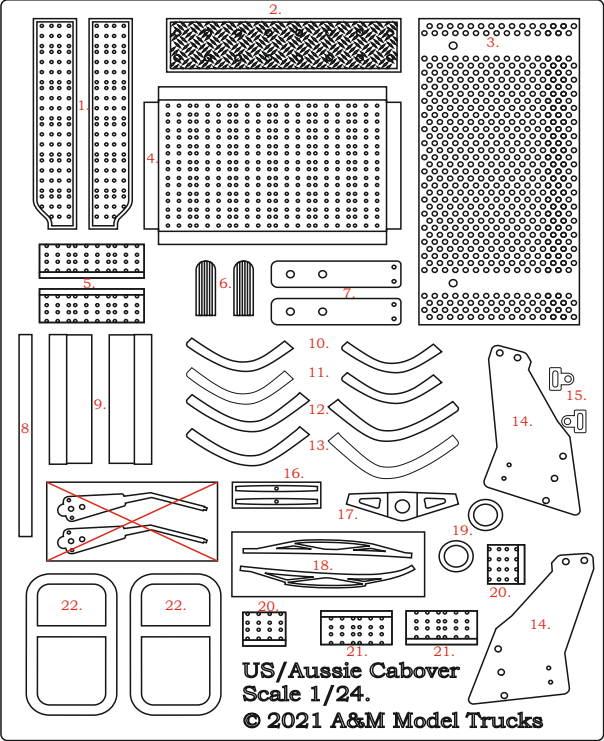

Main section

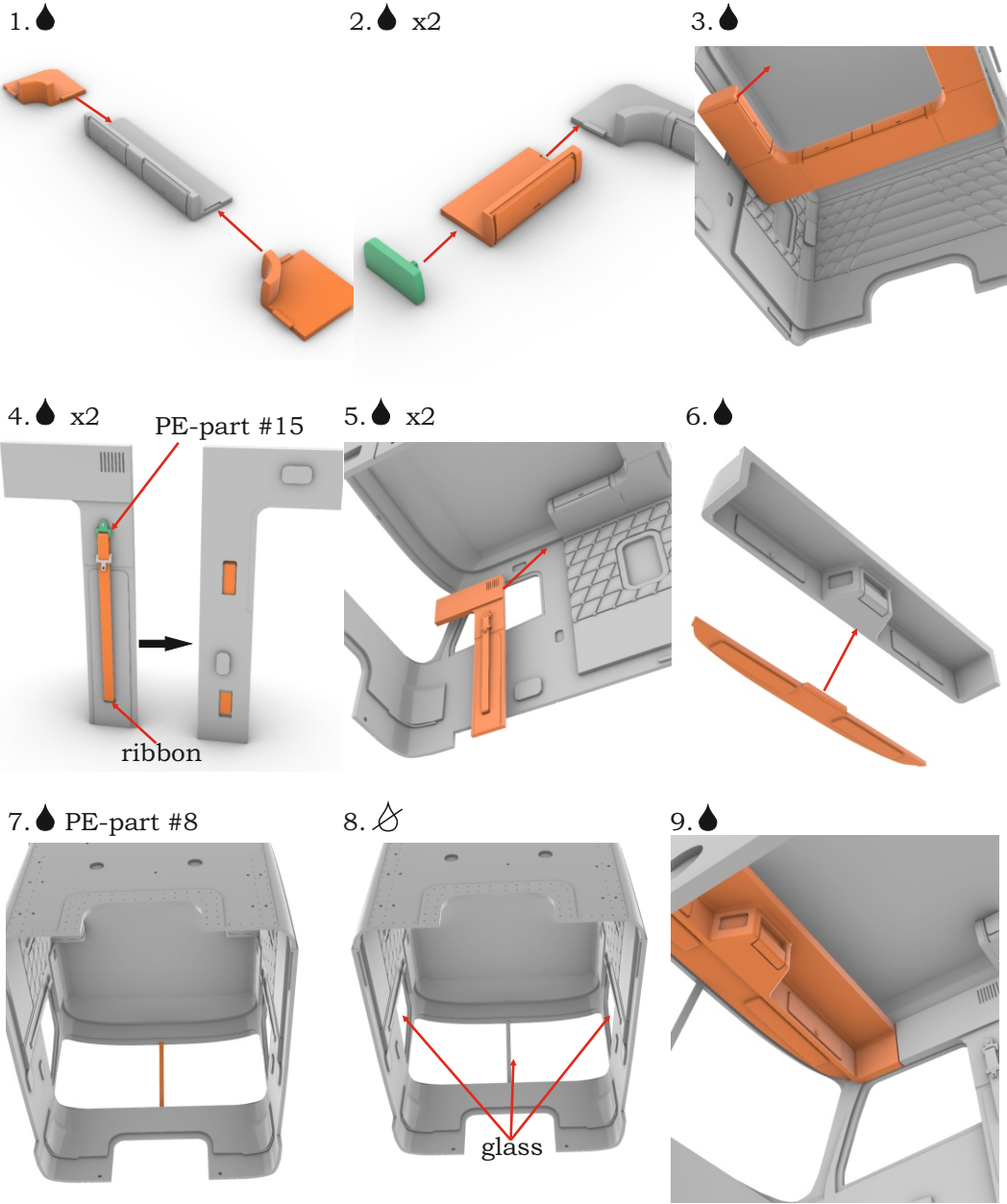

10.  x2

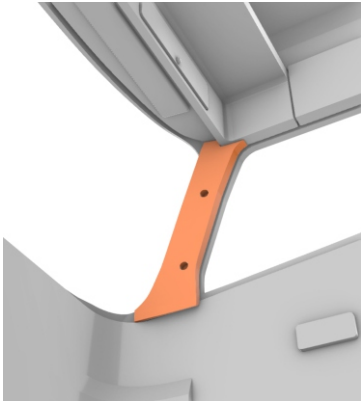

11.  x2

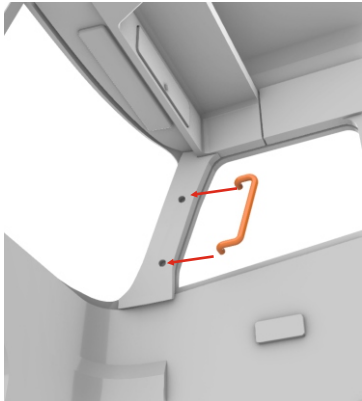

12. 

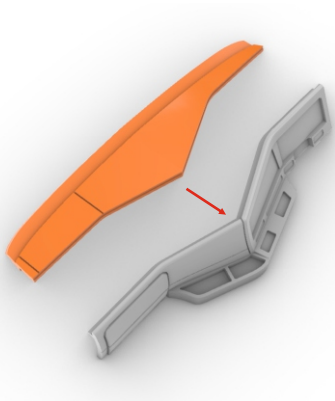

13.  PE-parts

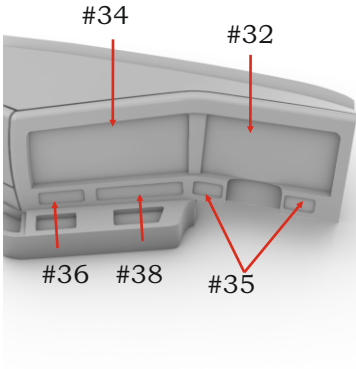

14.  PE-parts

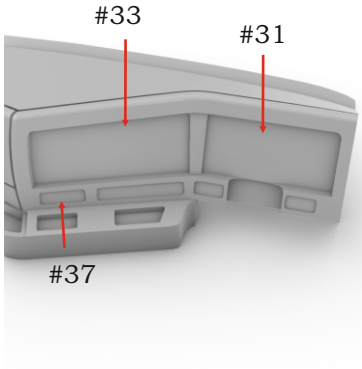

15. 

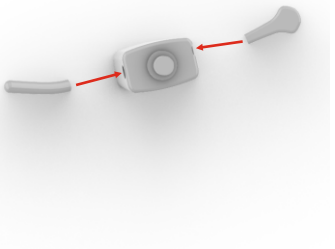

16. 

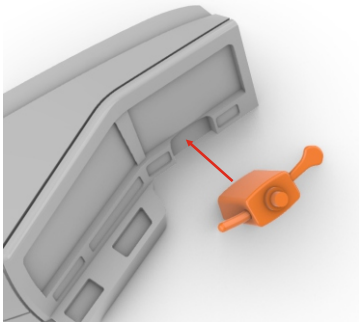

17. 

PE-part #17

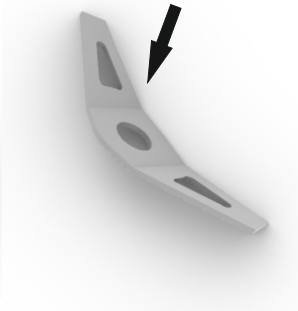

18. 



19. 



20. 



21.  x2

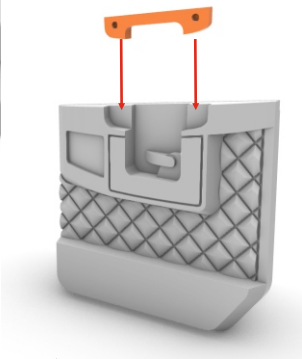

22.  x2

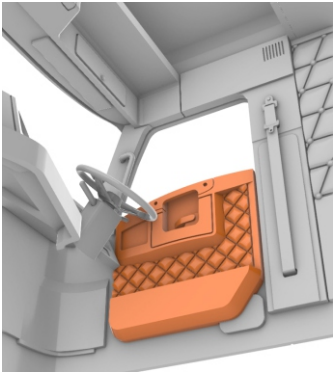

23.  x2
PE-part #27

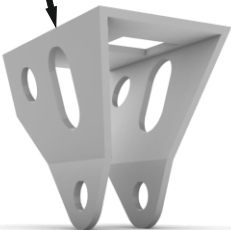

24.  x2



25.  x2

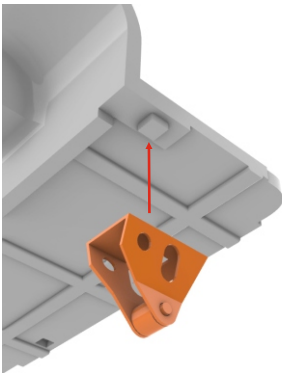

26.  x2

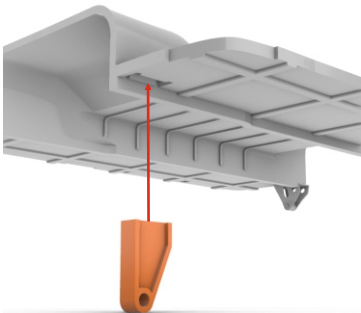

27. 

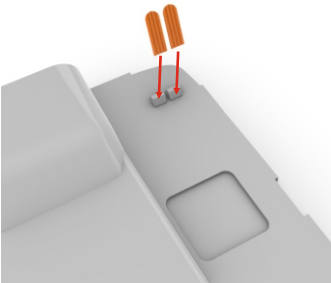

28. 

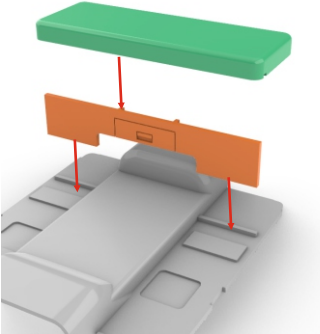

29.  x2

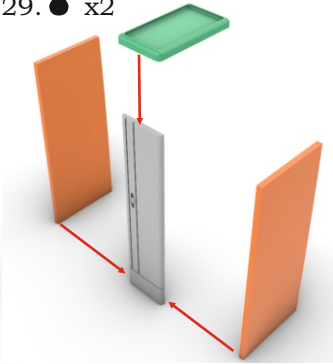

30.  x2

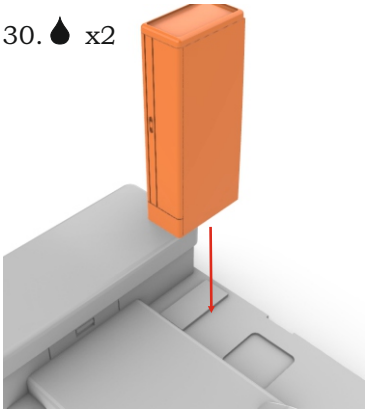

31.  x2



32.  x2

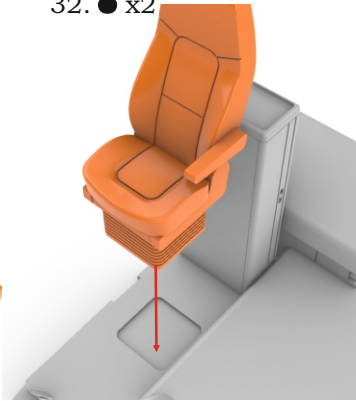

33. 

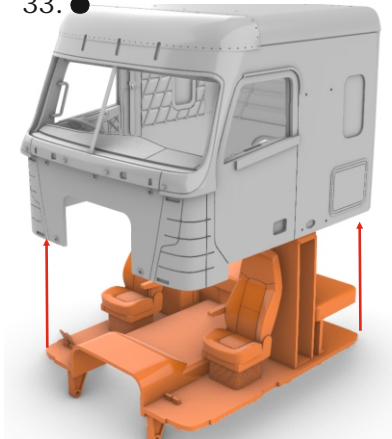

34.  x2 PE-parts

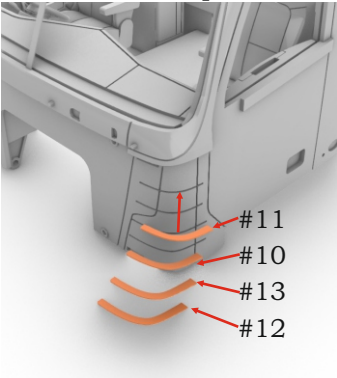

35.  x2

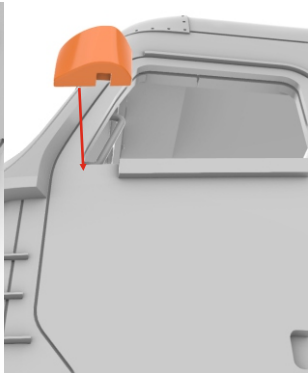

36.  x2
PE-part #14

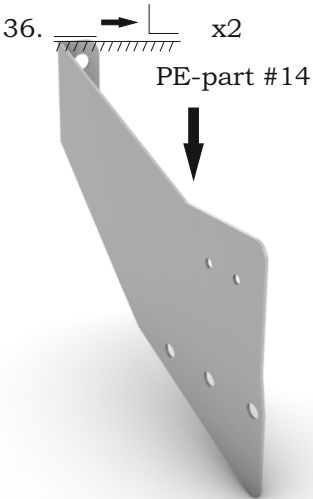

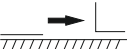
37.  x2

38.  x2

39.  x2

PE-part #7

Bolts 0.5

bolts 1.0

40.  x2

41.  x2

42.  x2
PE-parts

43.  x2

44.  x2

#1
#5
#21
#20

Aussie Argosy truck. Resin kit, 1/24

45.  x2

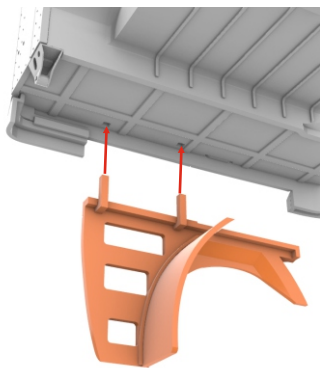

46.  x2

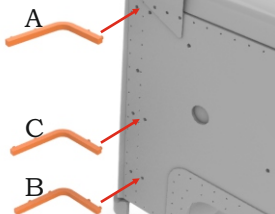

47.  x2

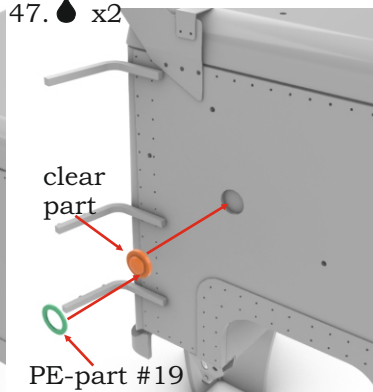

! In next stage A&N photo-etched chassis is used.
! Holes' numbers you can find on a paper sheet in our chassis kit.
In case if you use Italeri chassis kit as donor, please refer previous section for dimensions.

48.

Jump on step #1 of instruction for A&N Aussie Argosy chassis

49.  x2

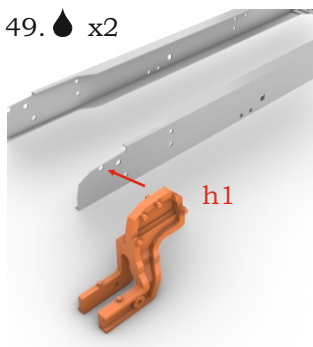

50.

Jump on step #27 of instruction for A&N Aussie Argosy chassis

51.  PE-part #23

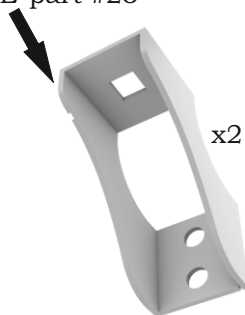

52.  PE-part #28

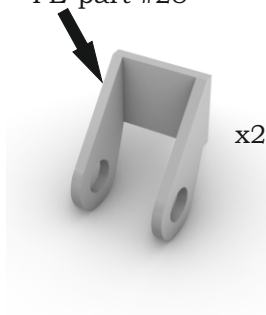

53.  x2

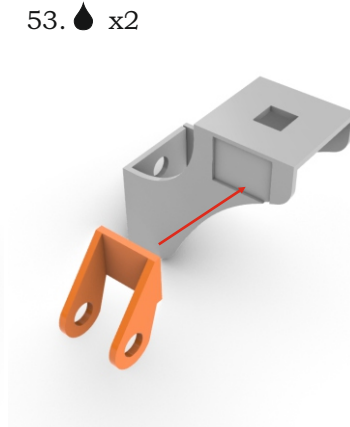

54.  x2

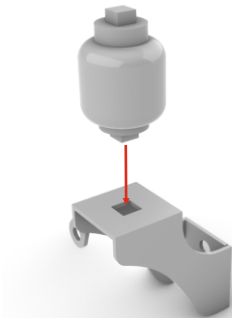

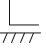
55.  
PE-part #24

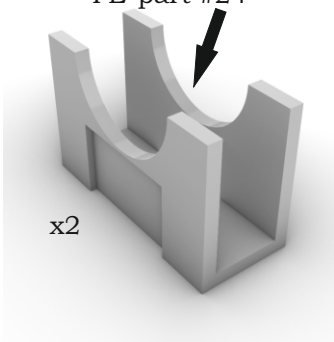

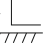
56.  
PE-part #25

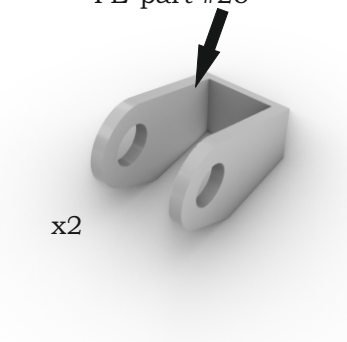

57.  x2

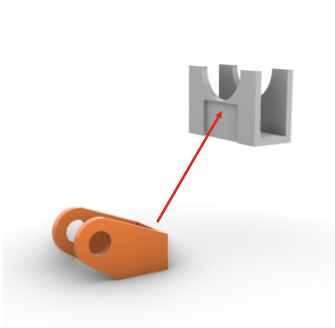

58.  x2

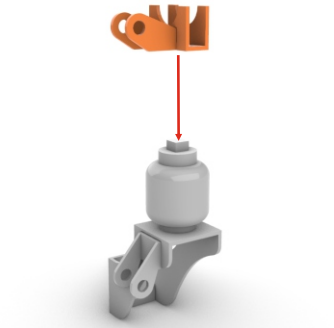

59.  x2

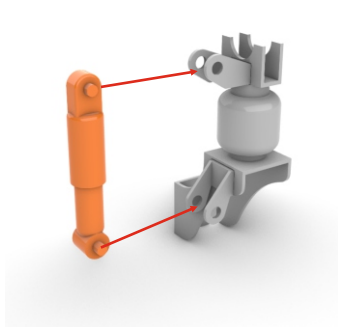

60.  x2

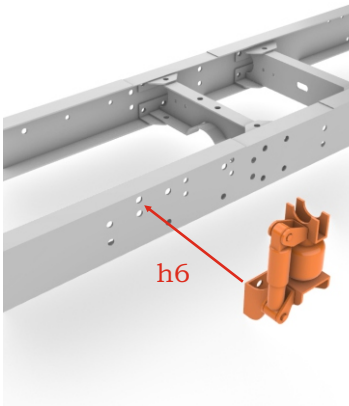

61.  x2

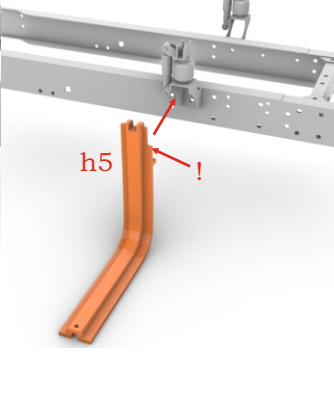

62.  x4

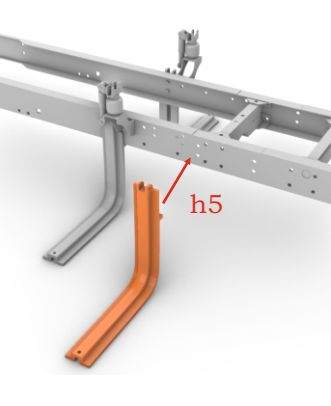

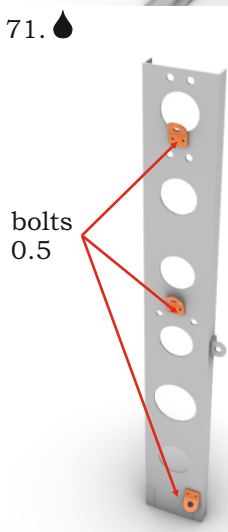
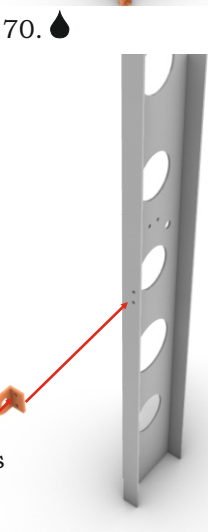
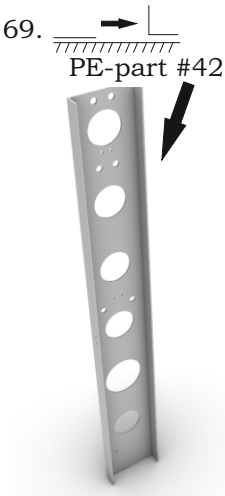
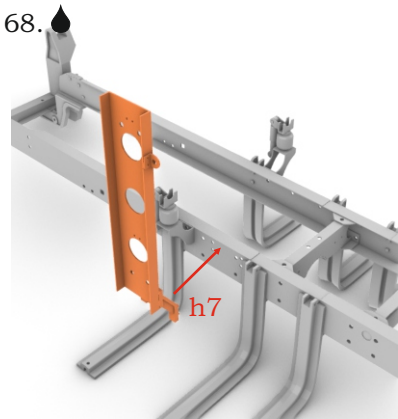
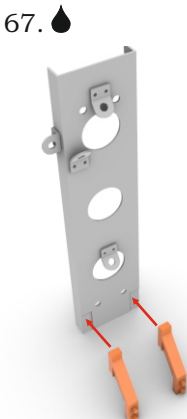
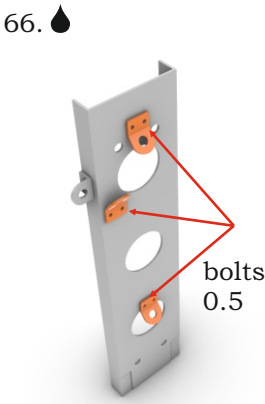
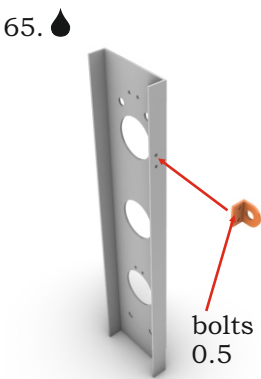
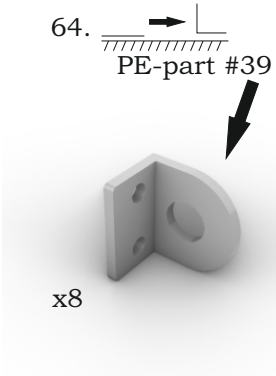
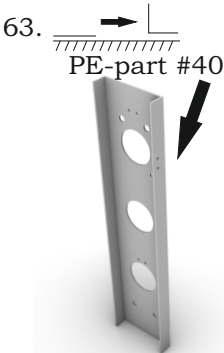

72. 



73. 

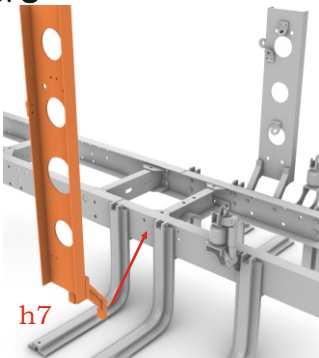

Round profiles
1 mm

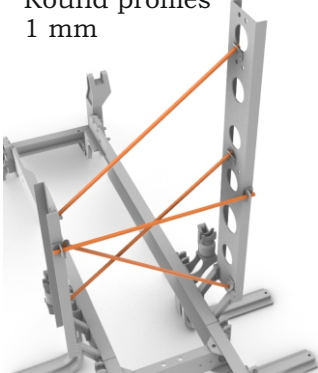

74. 

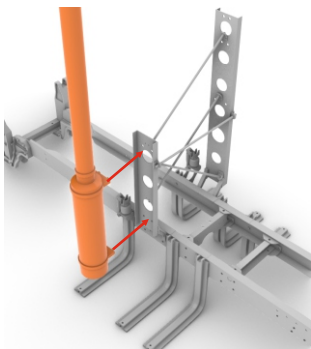

75. 

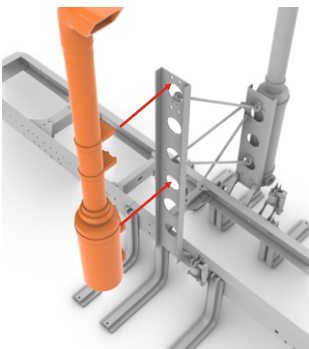

76. 
PE-part #44

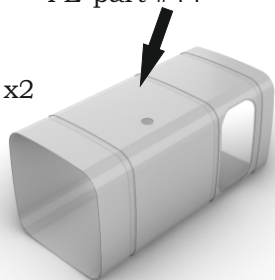

77.  x2

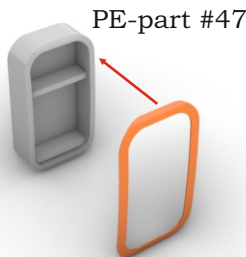

78. 
PE-part #48

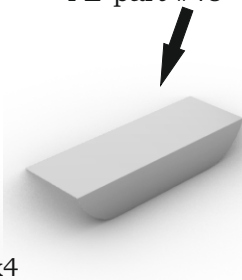

79.  x2

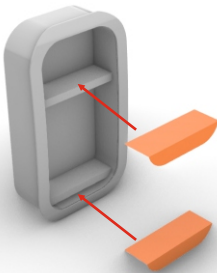

Aussie Argosy truck. Resin kit, 1/24

80.  x2

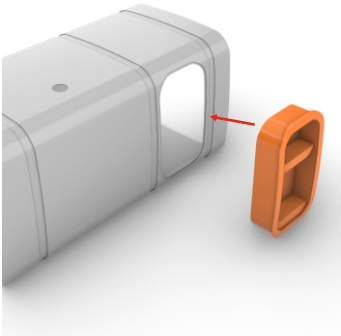

81.  x2

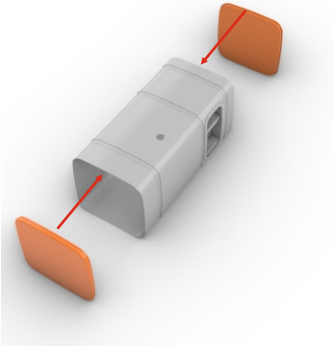

82.  x2

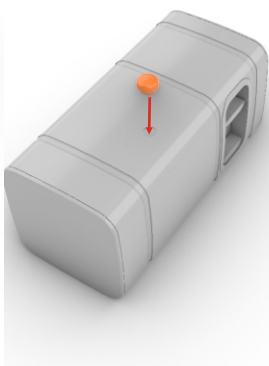

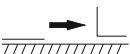
83.  PE-part #49

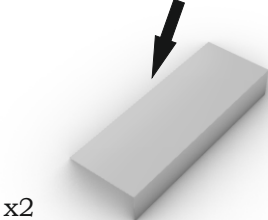

84.  x2

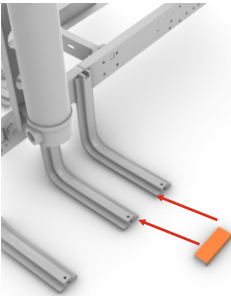

85.
Jump on step #48
of instruction for
A&N Aussie Argosy
chassis's

86.  PE-part #45

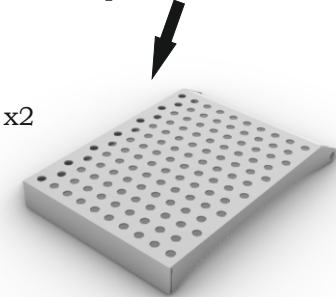

87.  x2 bolt 1mm

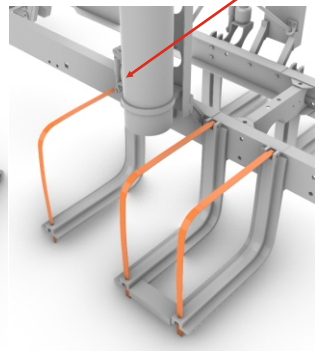

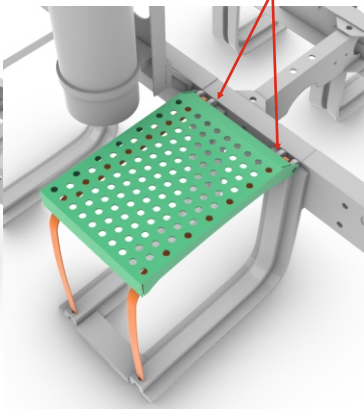

88.  x2 bolt 1mm



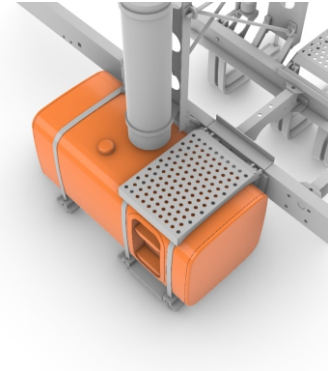

PE-part #46

89.  x2

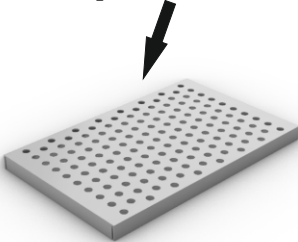

90.  
PE-part #4



91.  
PE-part #9

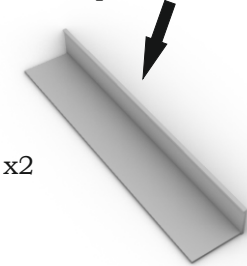

92.  x2

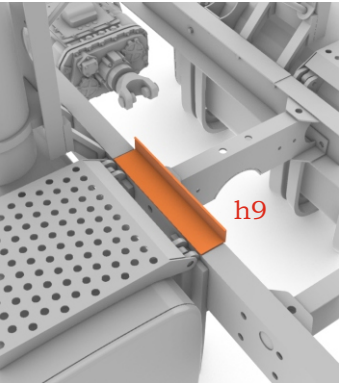

93. 

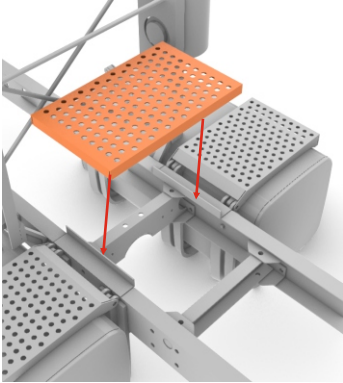

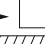
94.  
PE-part #26



95.  x2

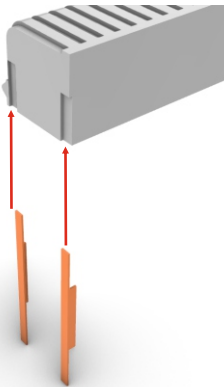

96. 

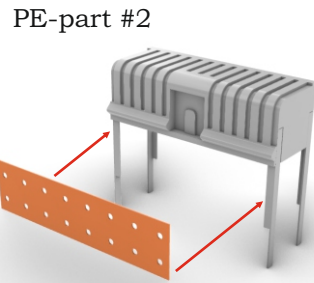

97. 

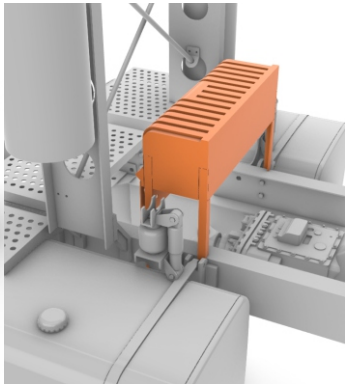

98. 

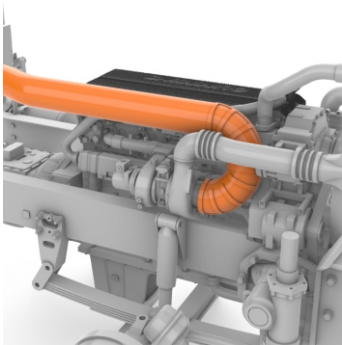

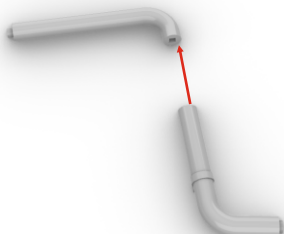
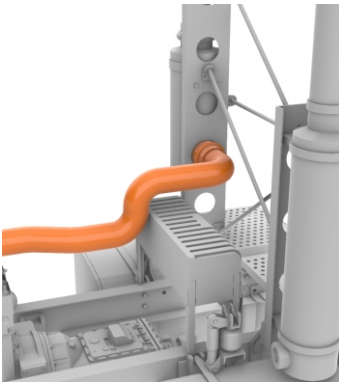

99. 

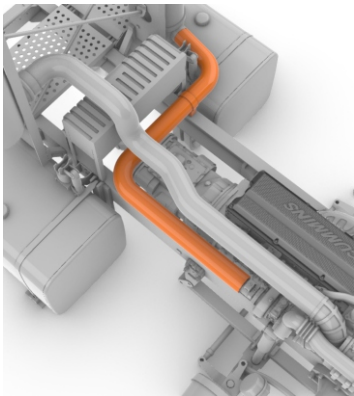

100. 



101.  
PE-part #3



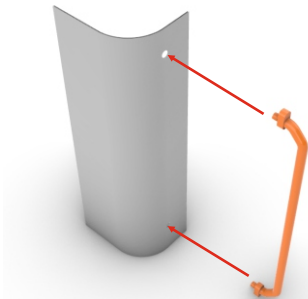

102. 



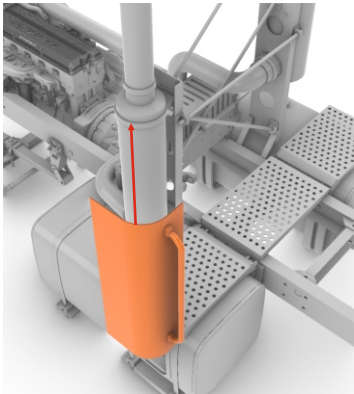

103. 

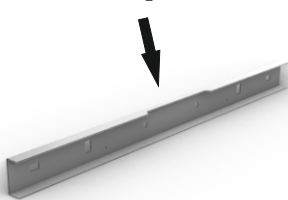

104.  
PE-part #43



105.  
PE-part #41



x2

Aussie Argosy truck. Resin kit, 1/24

106.  x2

bolts 0.5 mm

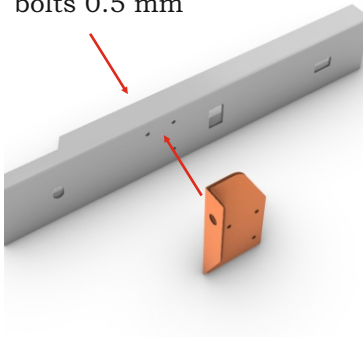

107.  x2

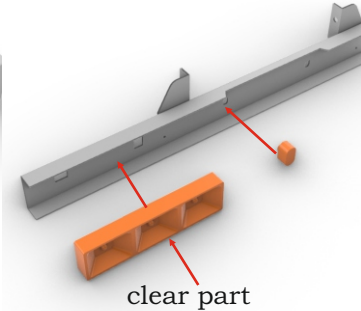

108. 

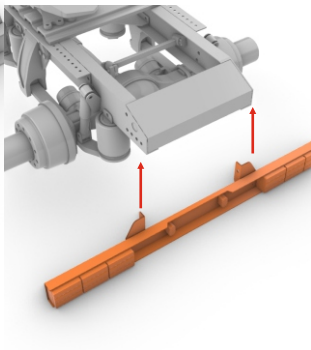

109. 

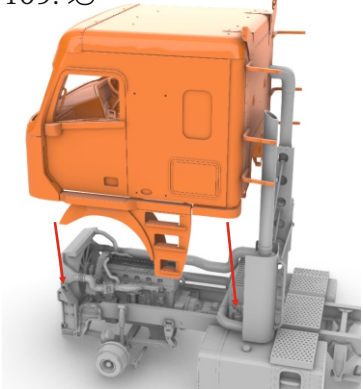

110.  x2 round profile 2mm

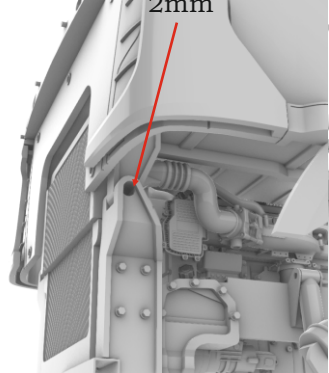

111.  x2

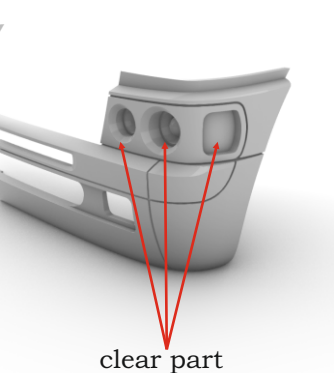

112. 

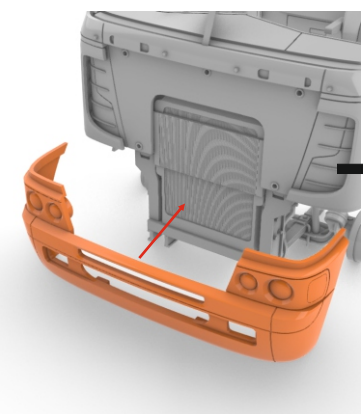

113.  x2

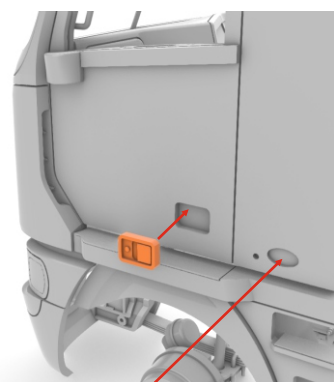
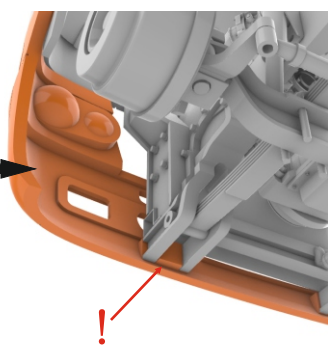

Aussie Argosy truck. Resin kit, 1/24

114. x2

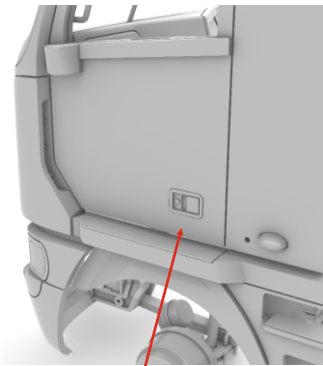

PE-part #30

115. x2

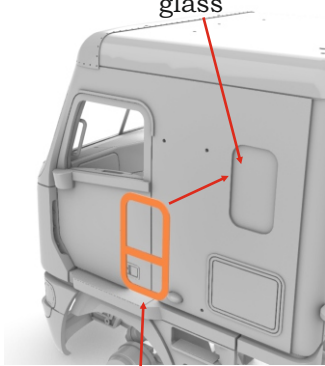

PE-part #22

116. x2

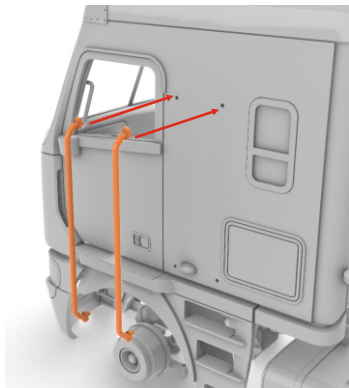

117. x2

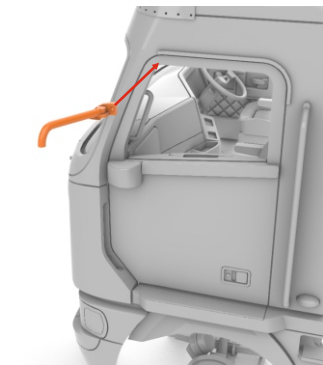

118. x2



119. x2

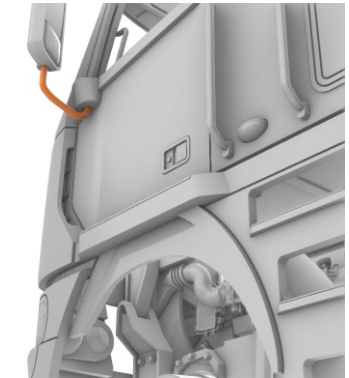

120.

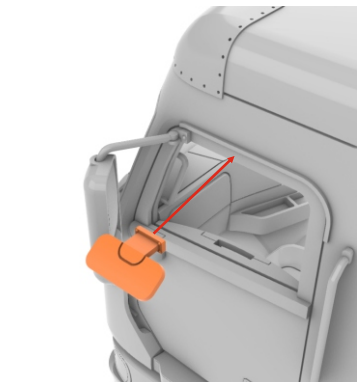

121. x2

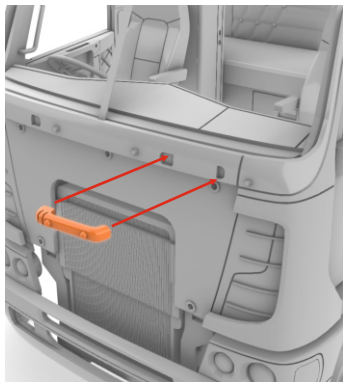

122. x2

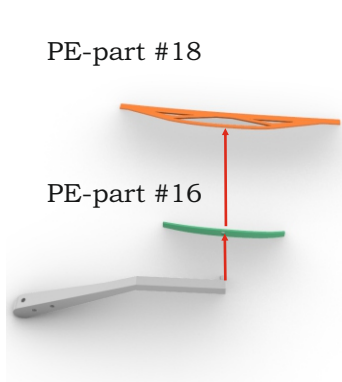

Aussie Argosy truck. Resin kit, 1/24

123. x2

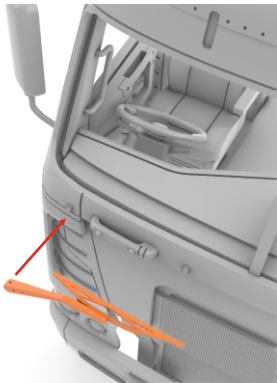

124.

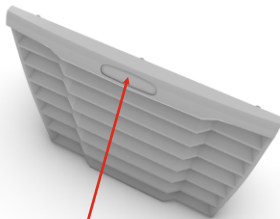

PE-part #29

125.

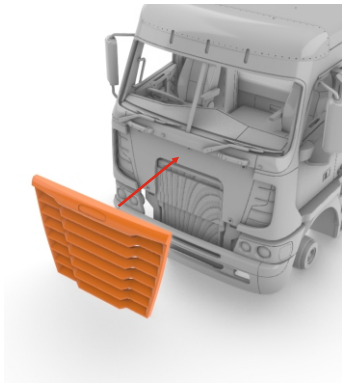

126. x2



127.

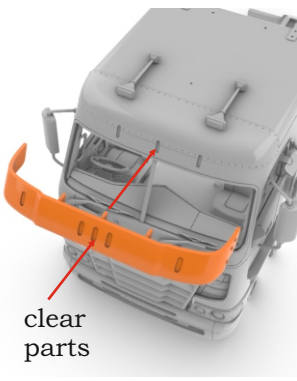

128.

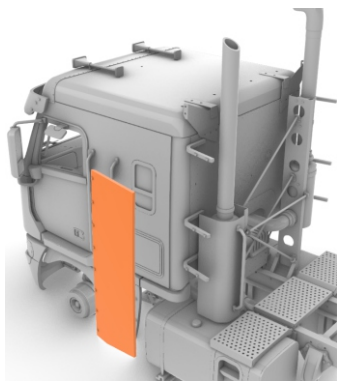

129.

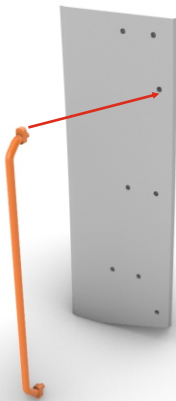

130.

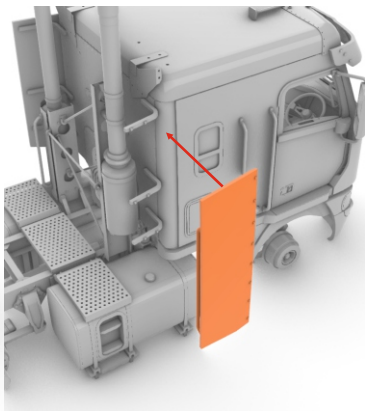

131. x2

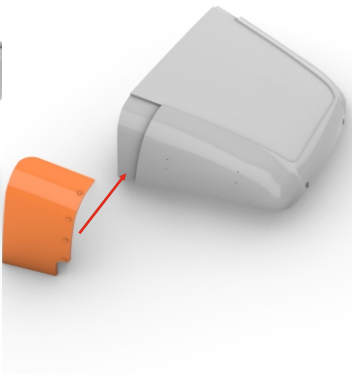

Aussie Argosy truck. Resin kit, 1/24

132. 

