

Swedish engine D13

Resin kit, 1/24

© 2021 A&N Model Trucks

Made in Latvia

Swedish engine D13

Highest detailed replica of modern Euro 6 13 litres Swedish diesel engine with automatic gearbox. Designed to use with our Swedish construction truck chassis kits. Can be fitted to Italeri's Volvo FH4 kit. 3D printed master patterns with many small details.

Warning!

This kit for advanced modellers only!

Contains many small parts, not suitable for children!

Please read this instruction carefully and follow it during assembling.

Symbols:



- glue parts;

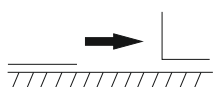

- bend parts;



- attention;

Swedish engine D13

1. 

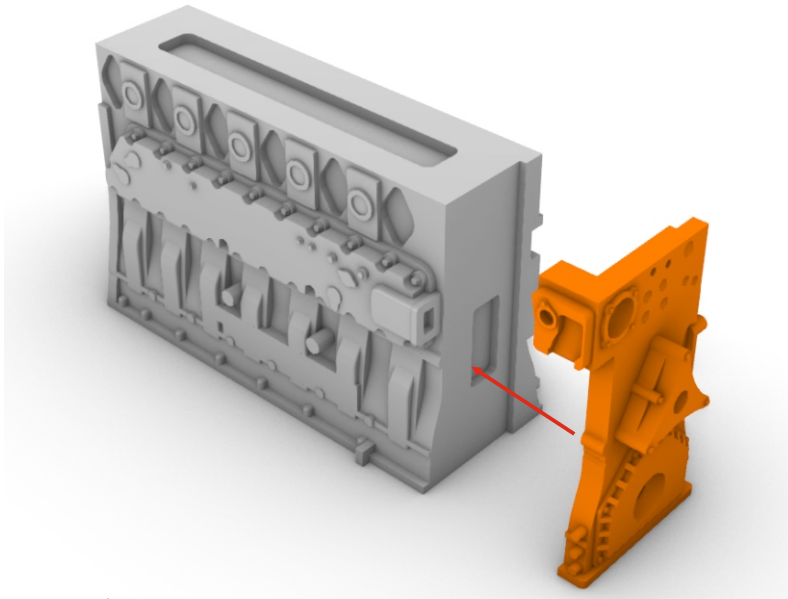

2. 

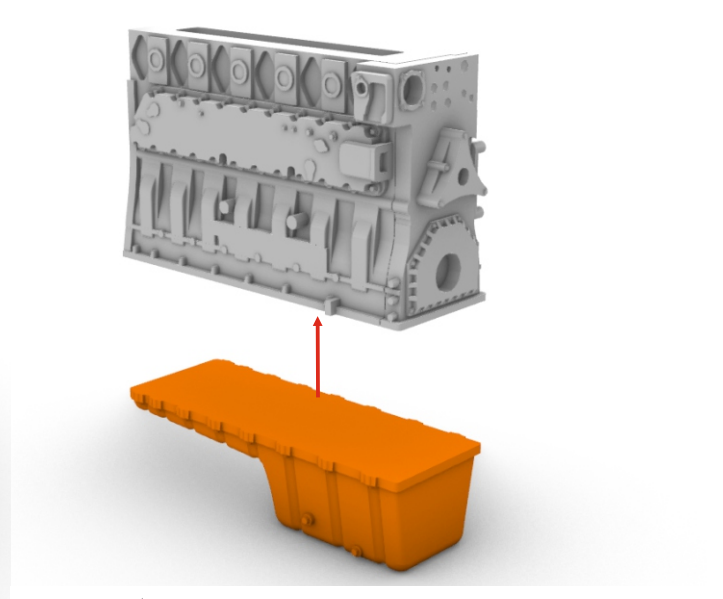

3. 

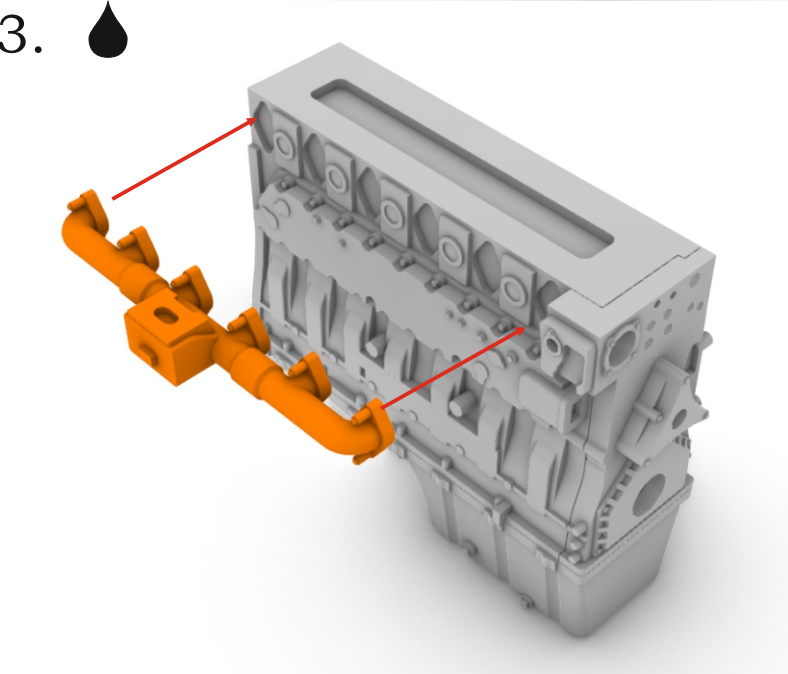

4. 

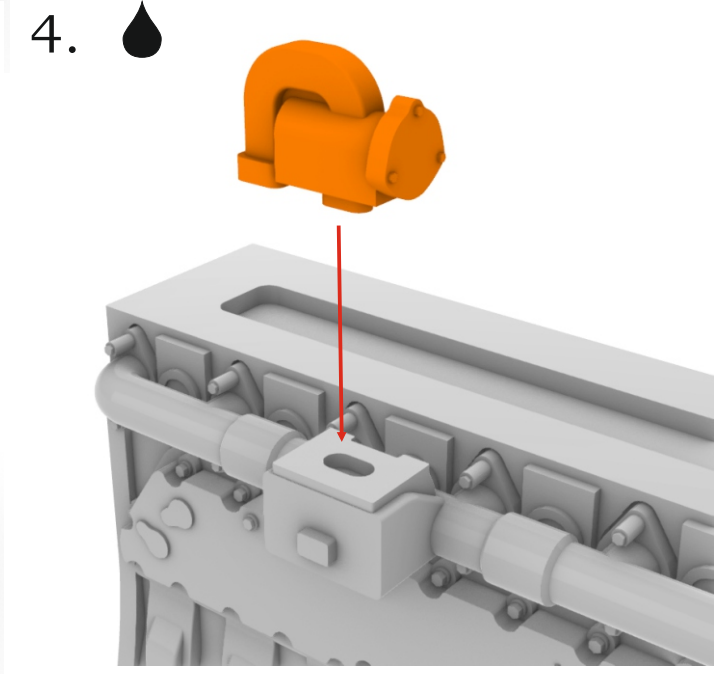

5. 

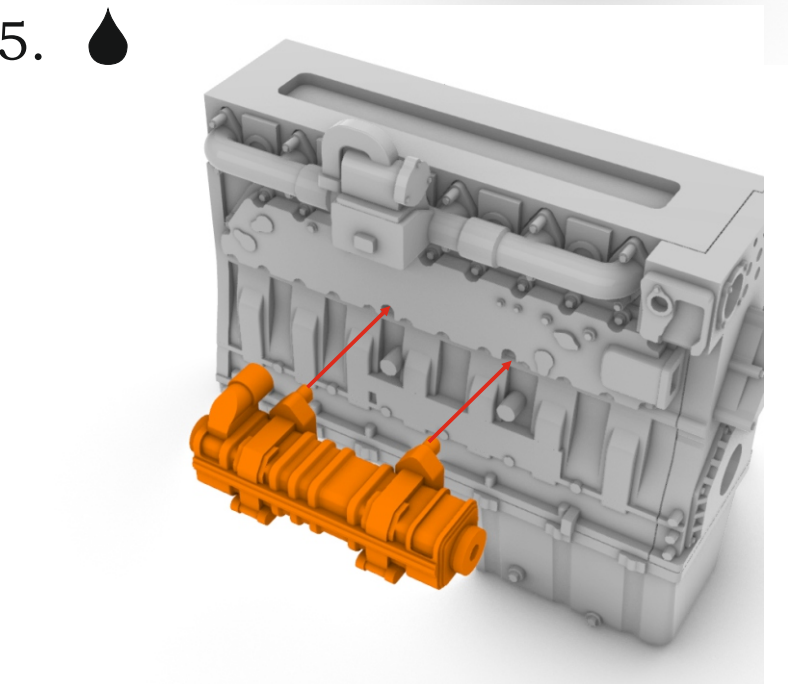

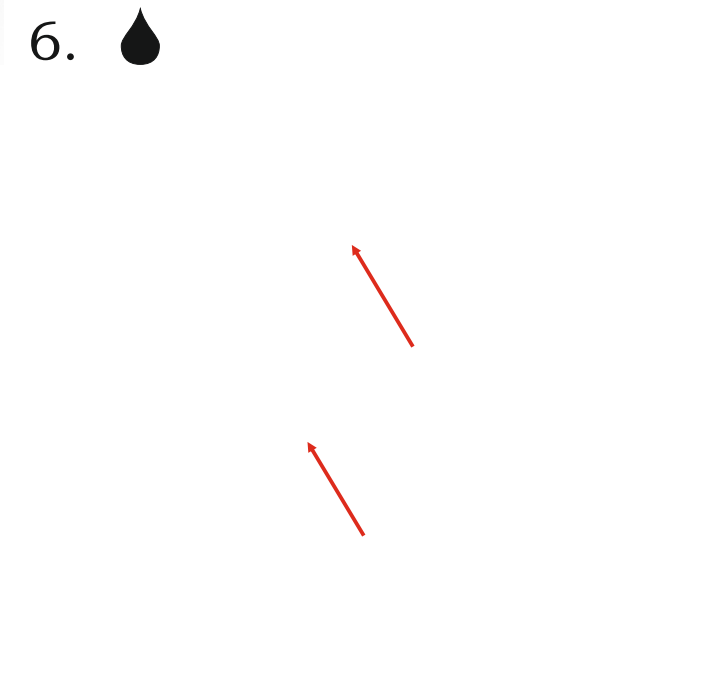

6. 

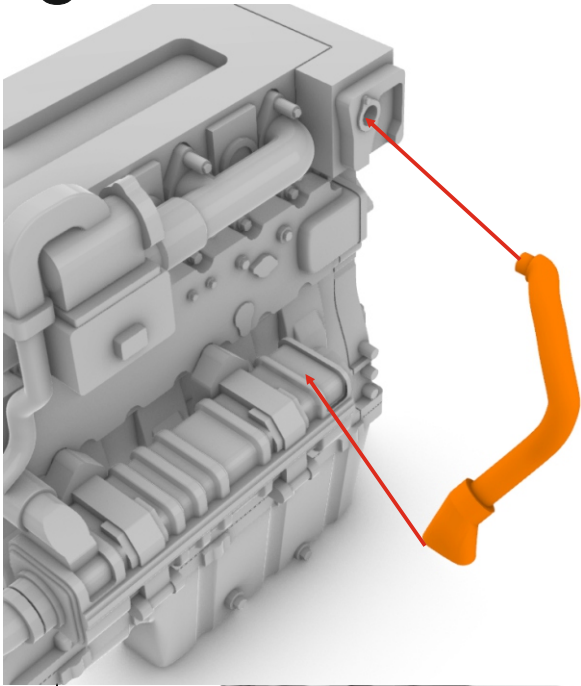

Swedish engine D13

7. 



8. 

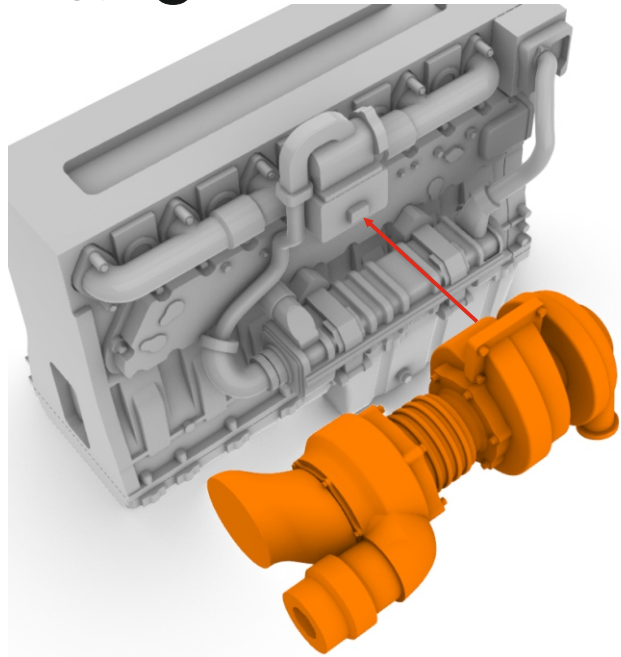

9. 

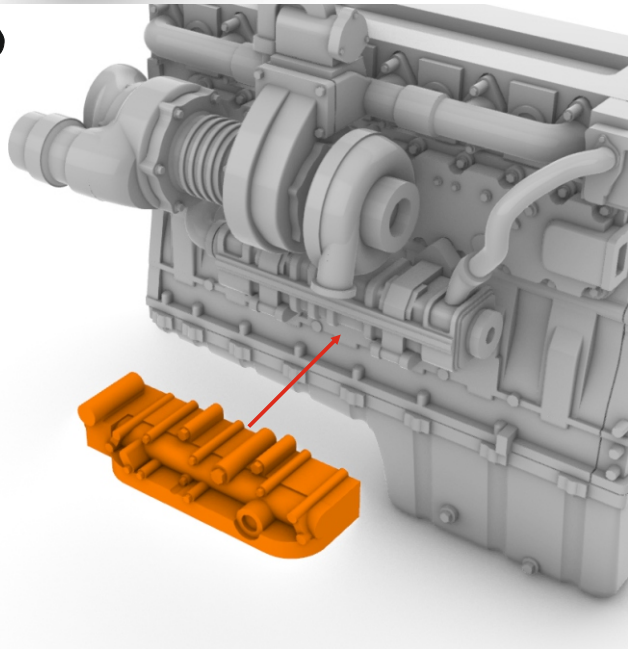

10. 

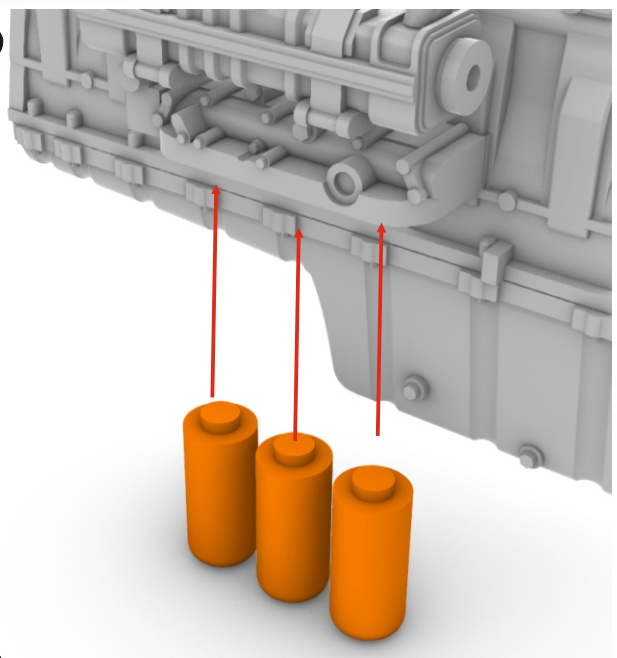

11. 

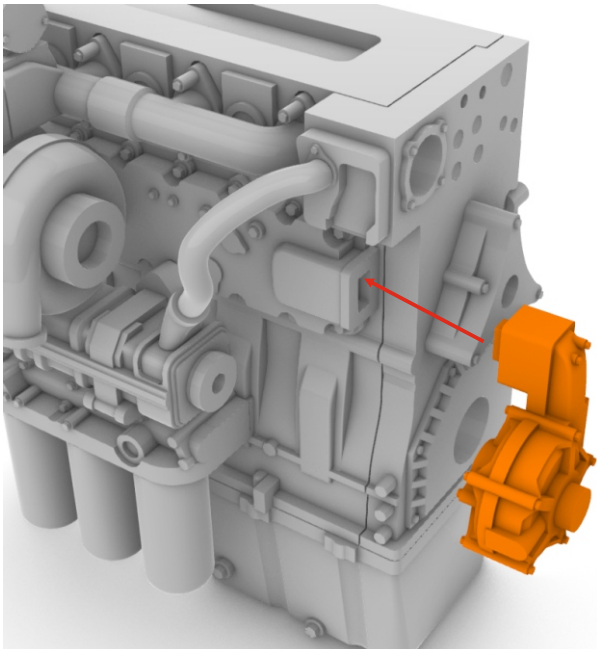

12. 

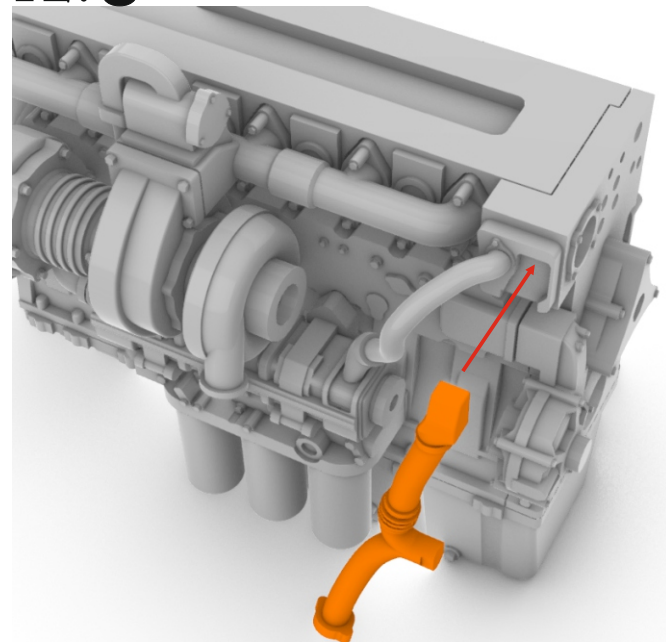

Swedish engine D13

13.💧

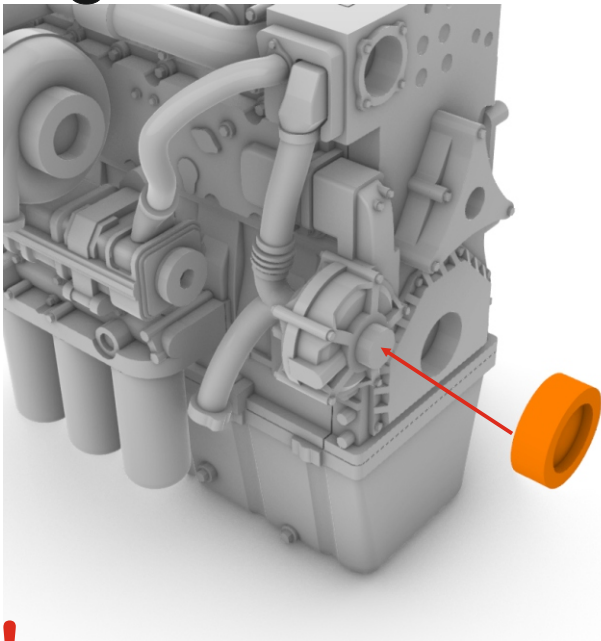

14.💧

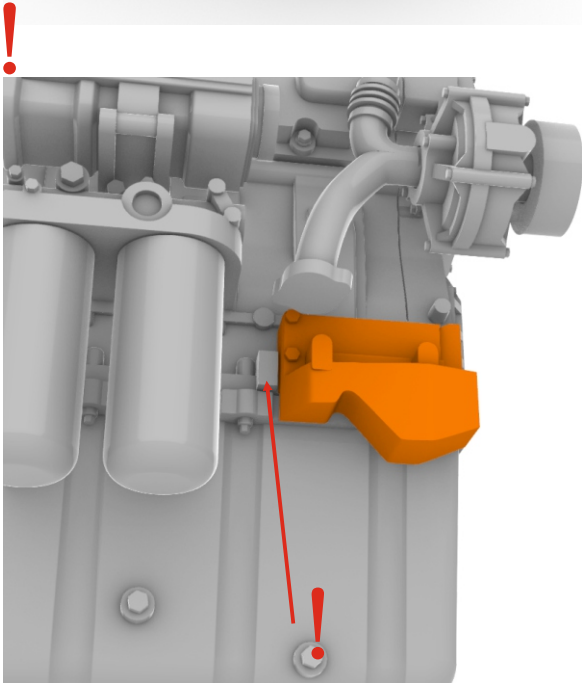
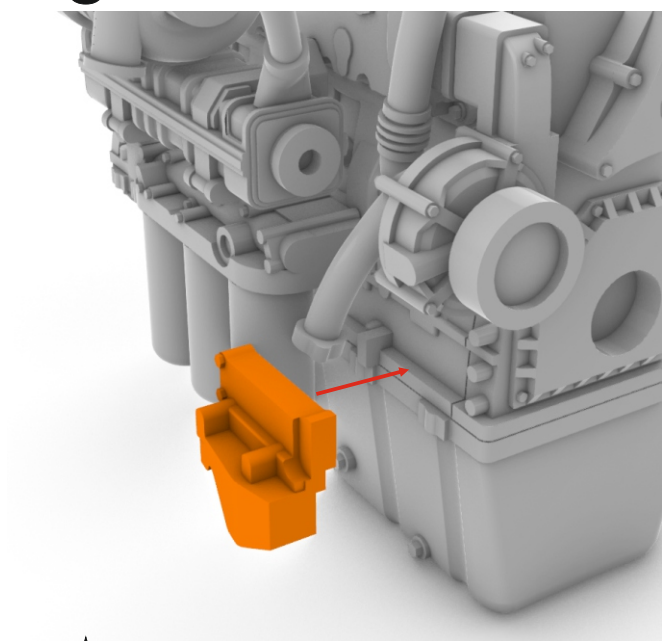

15.💧

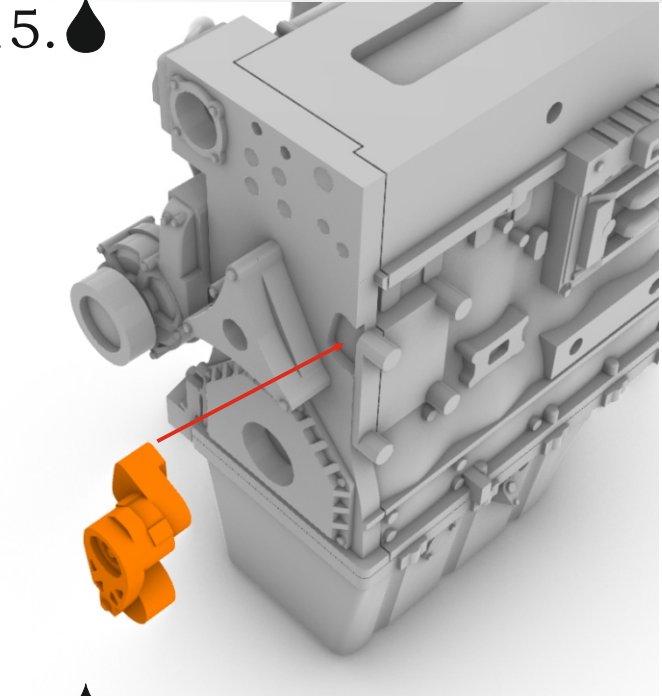

16.💧

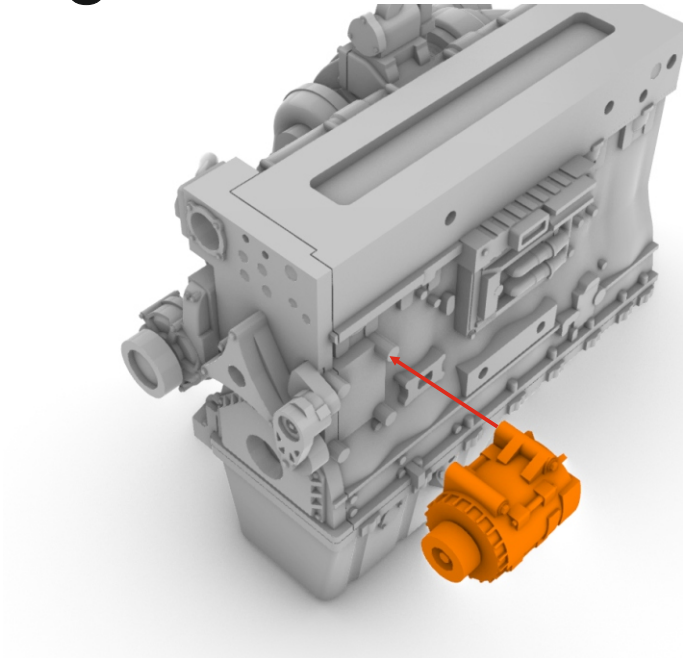

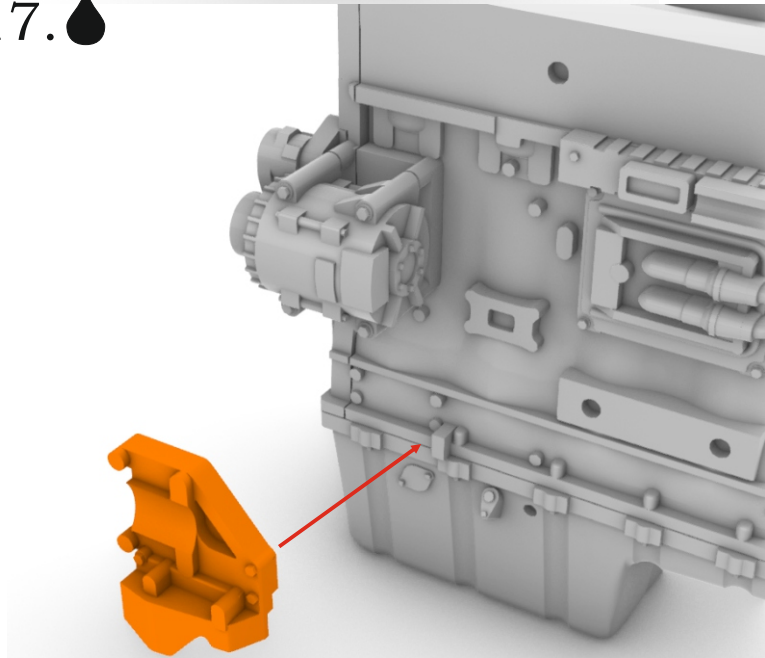

17.💧

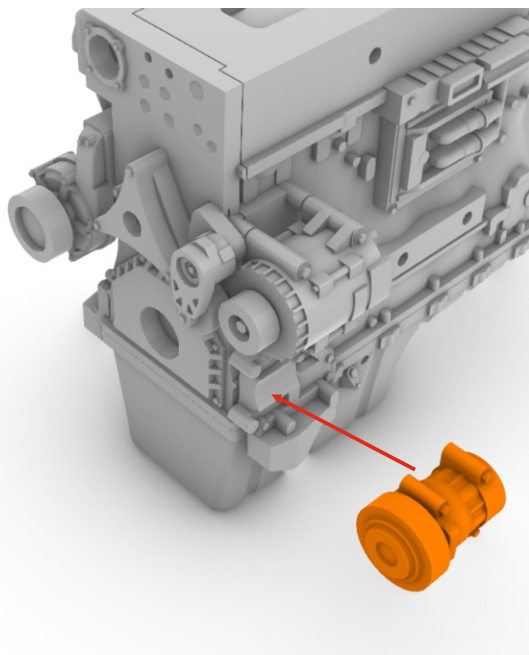

Swedish engine D13

18. 



19. 

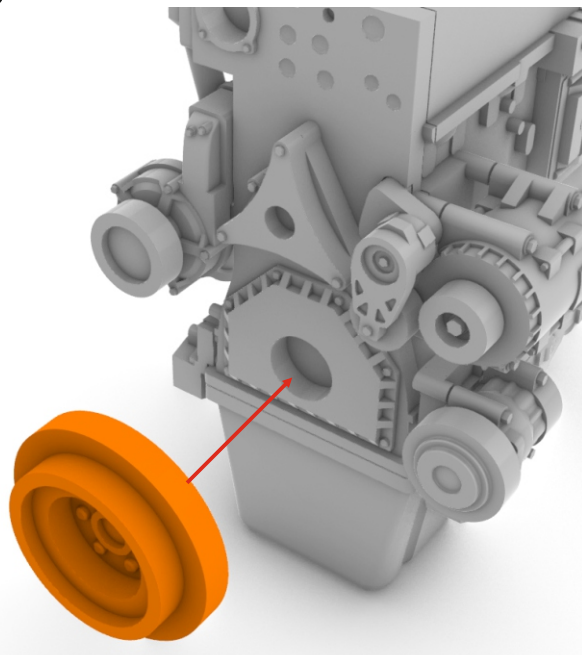



Use black isolating tape
for belts imitation.
Width of belt - 1.5 mm

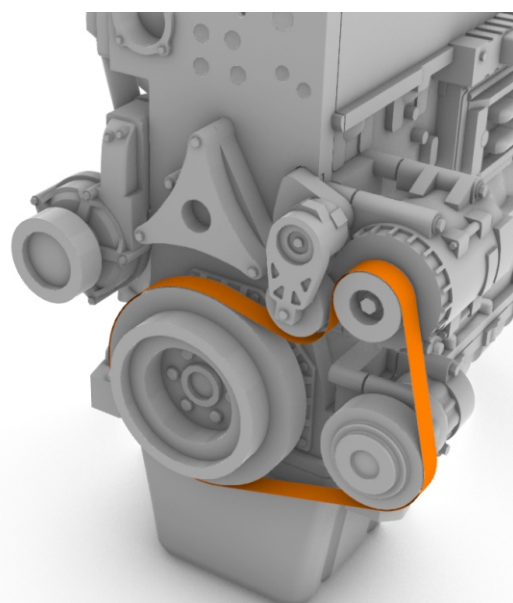

20. 



21.  

22. 

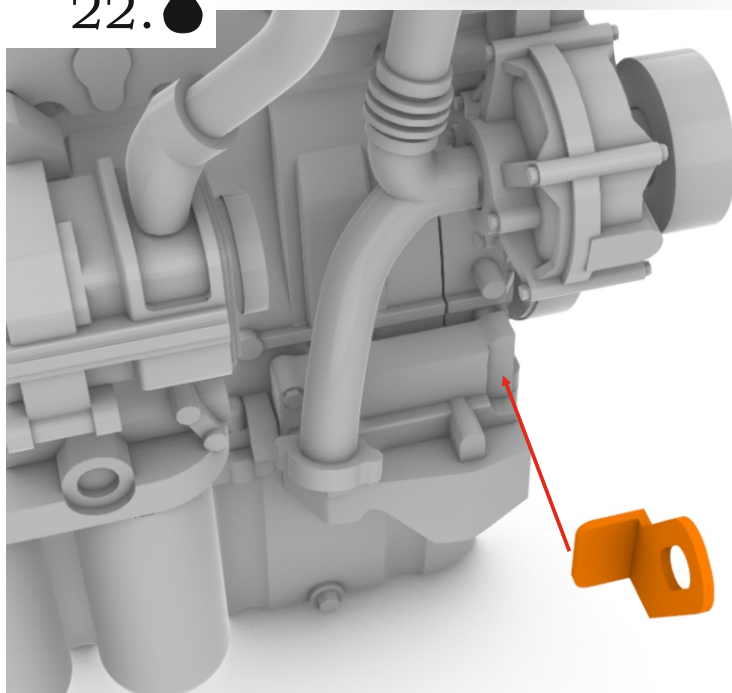

Swedish engine D13

23. 

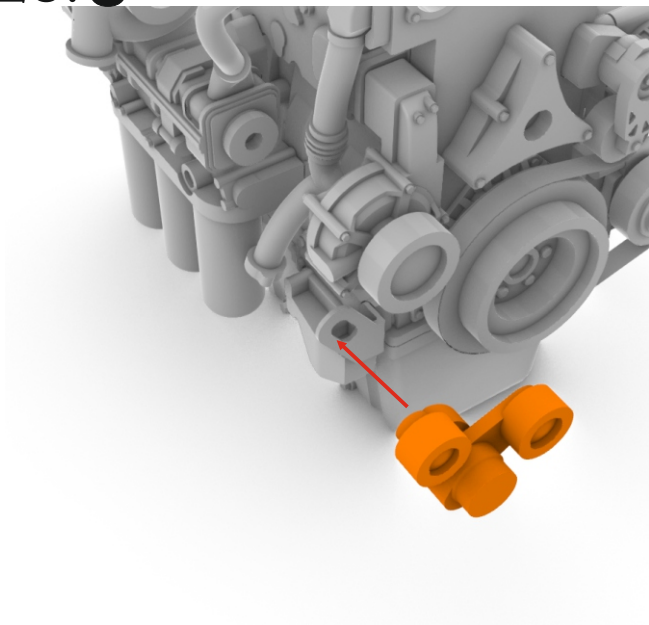

24. 

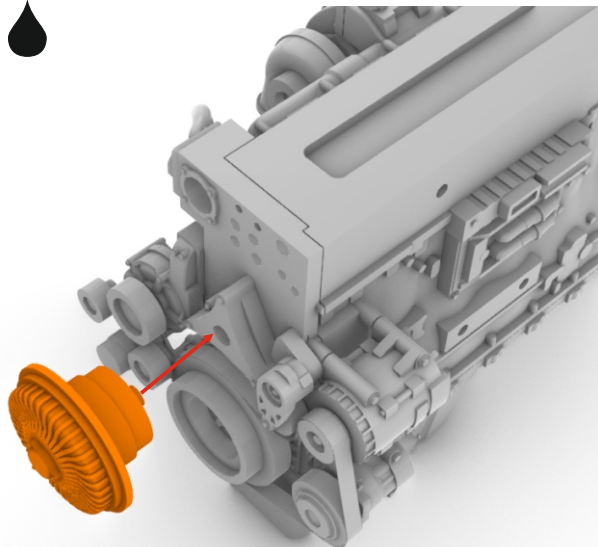

Use black isolating tape for belts imitation.
Width of belt - 1.5 mm

25. 

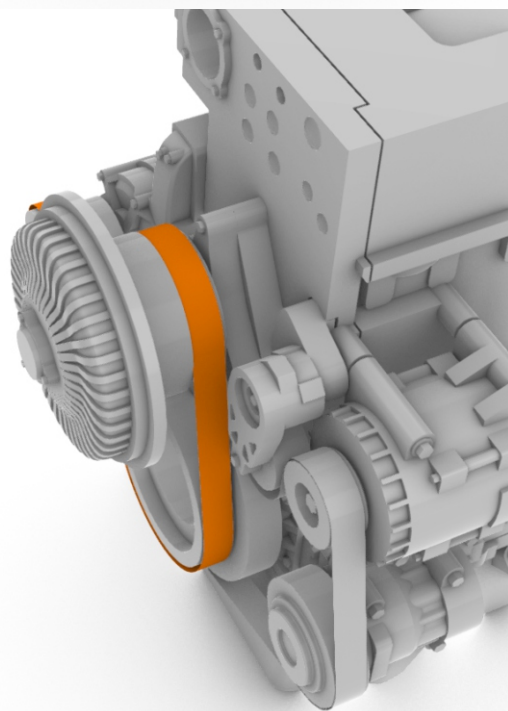

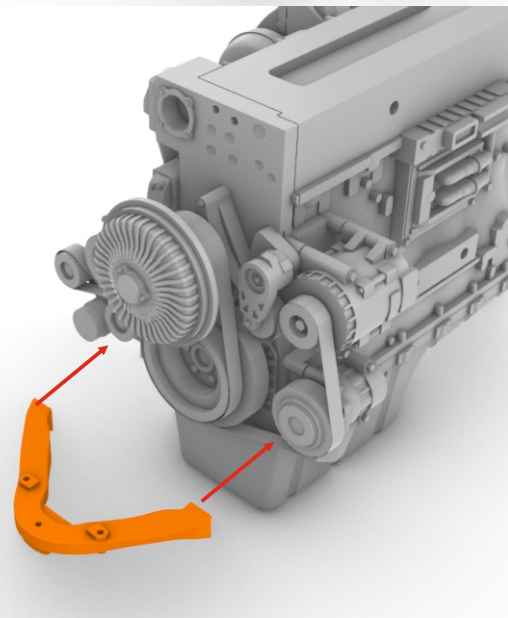
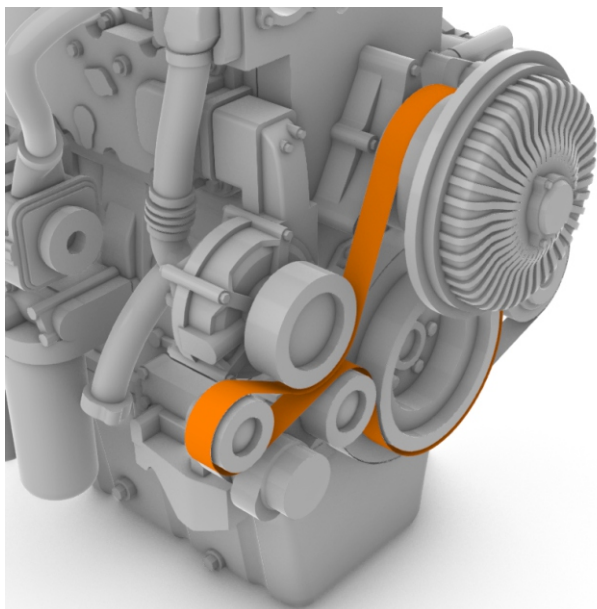

26. 

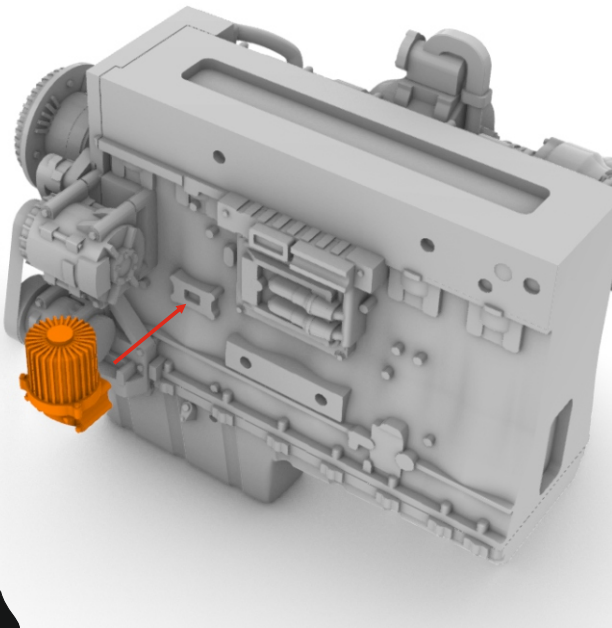

Swedish engine D13

27. 



28. 

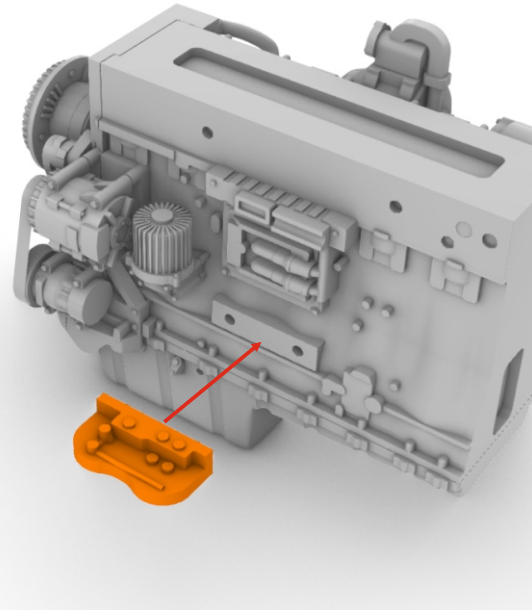

29. 

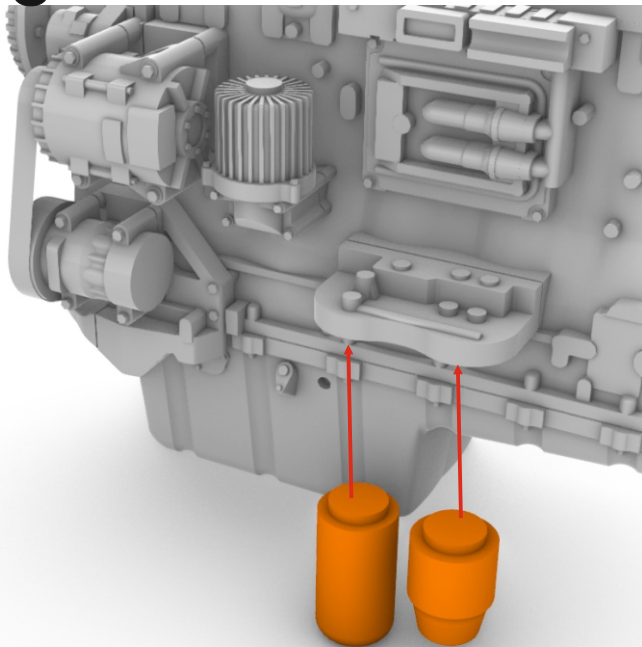

30. 

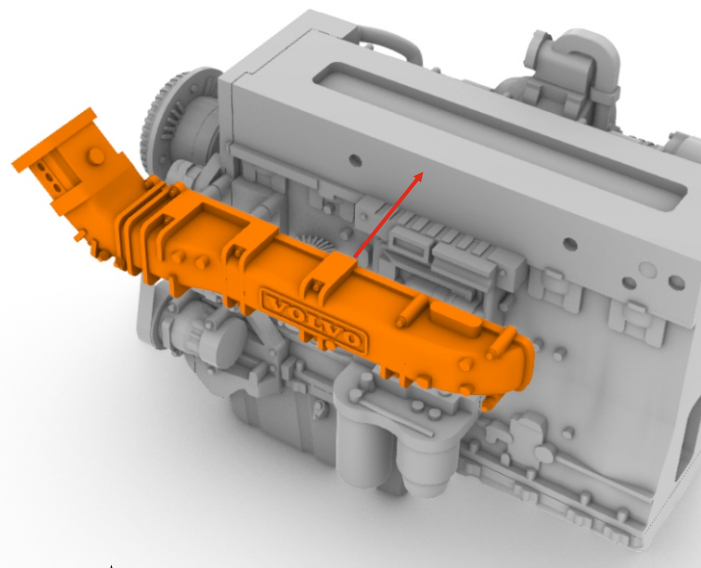

31. 

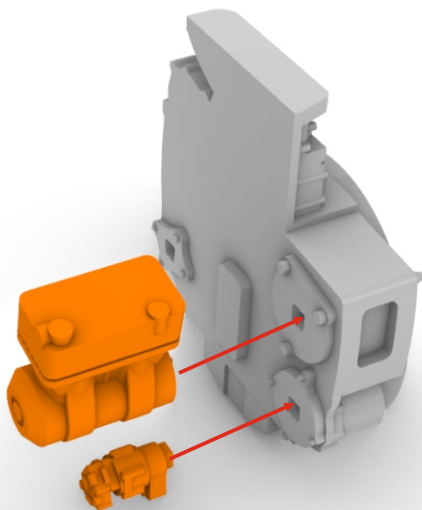

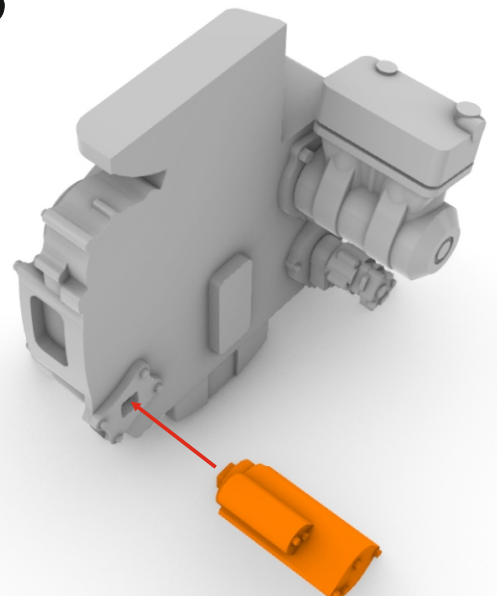

32. 



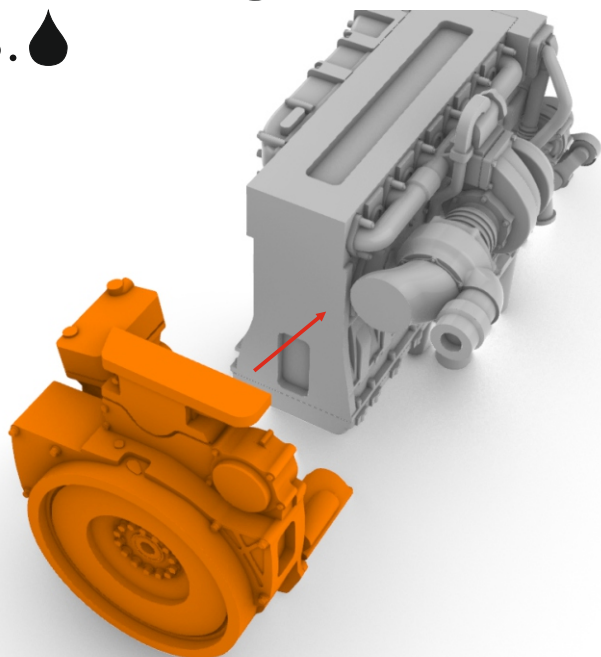

Swedish engine D13

33. 

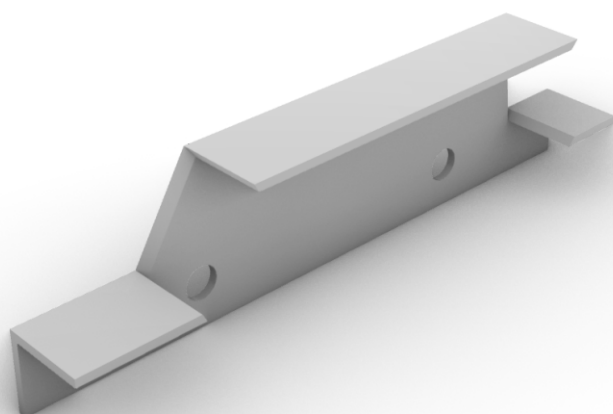

34. 



35. 

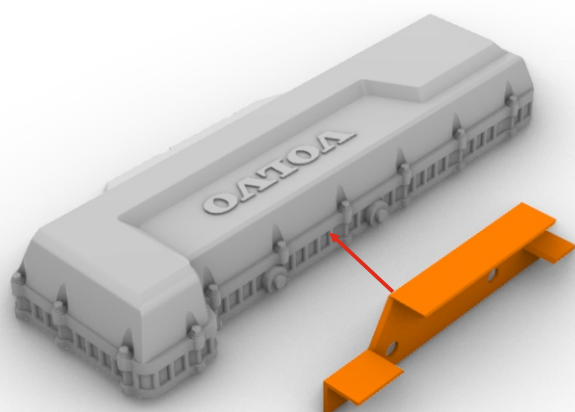

36. 

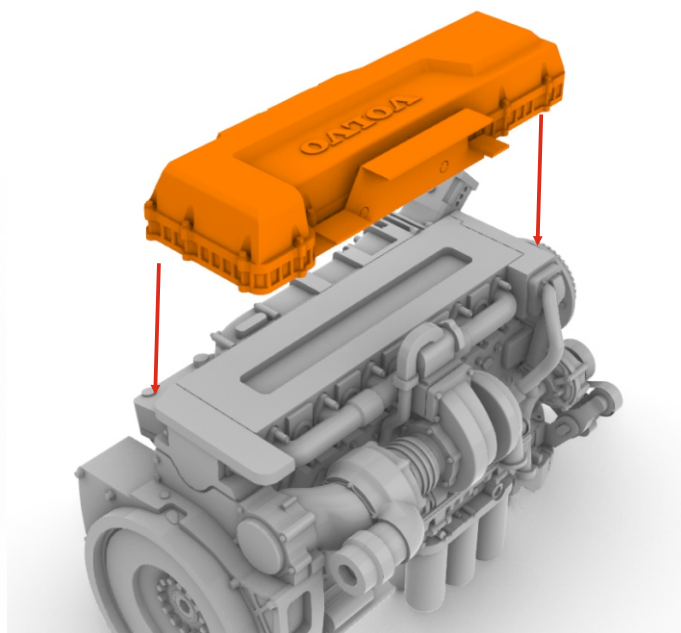

37. 

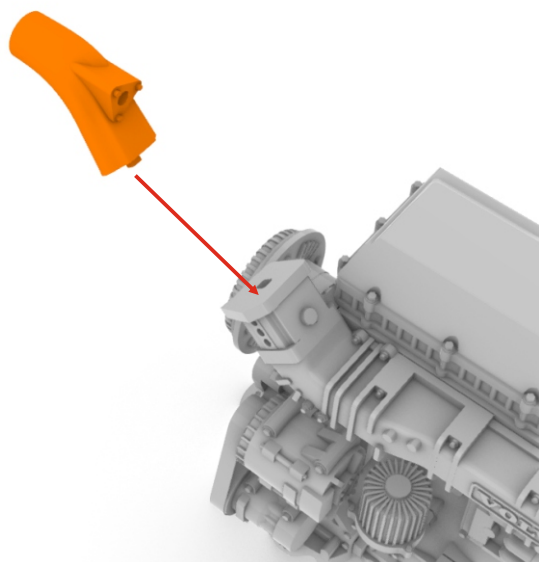

38. 

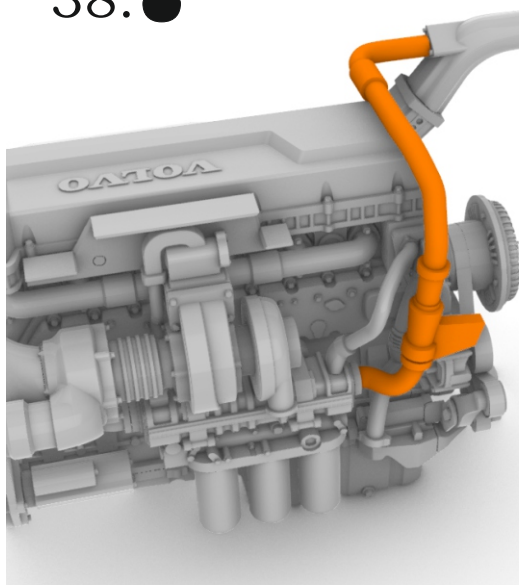

Swedish engine D13

39. 

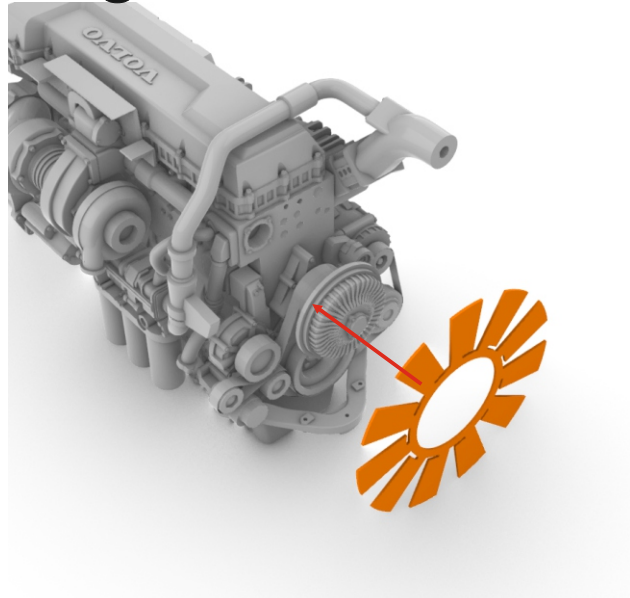

40. 

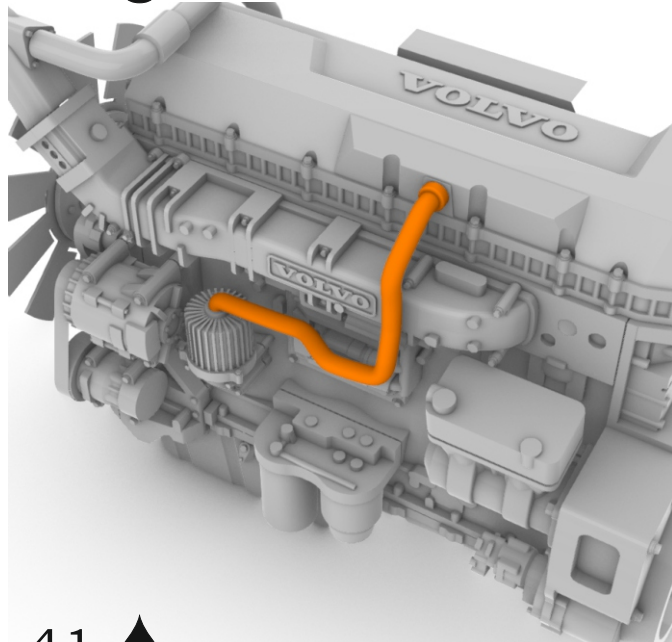

40. 

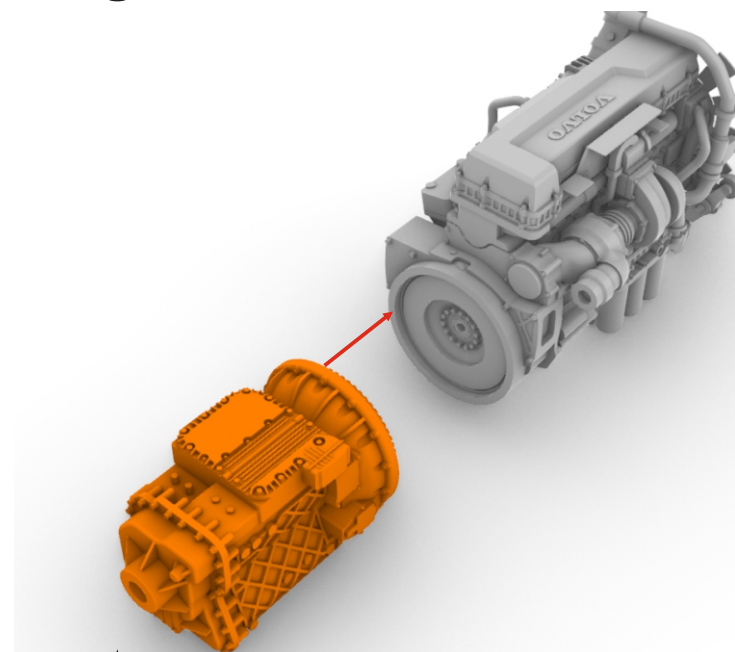

41. 

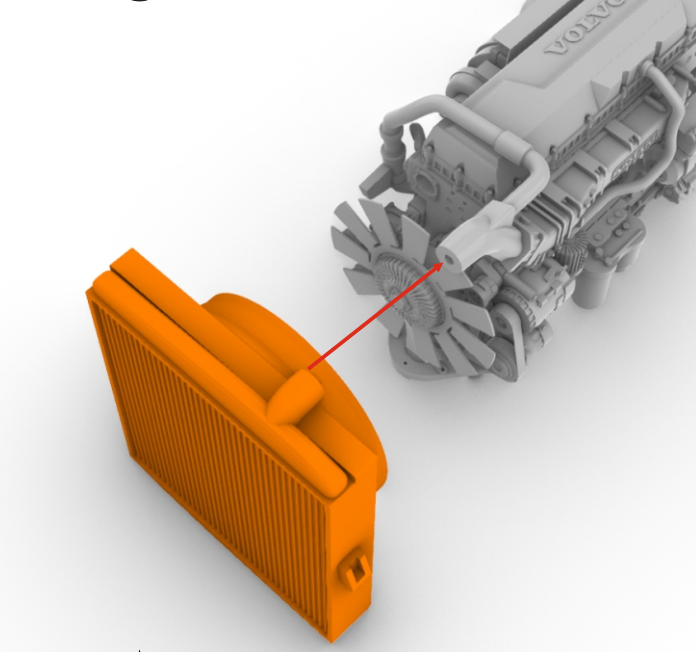

42. 

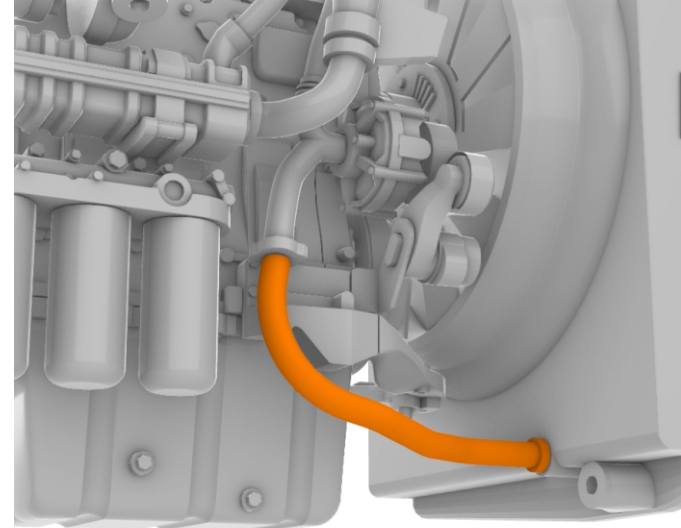

43. 

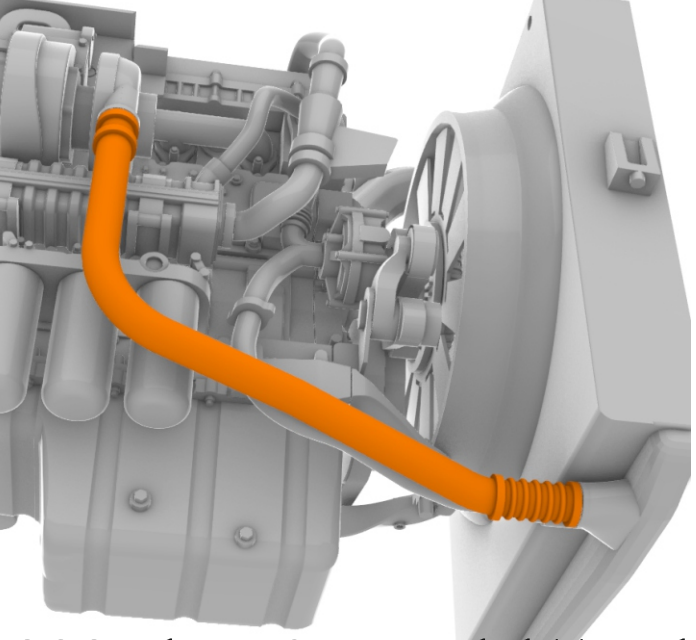

Swedish engine D13

44. 