

A&N Model Trucks

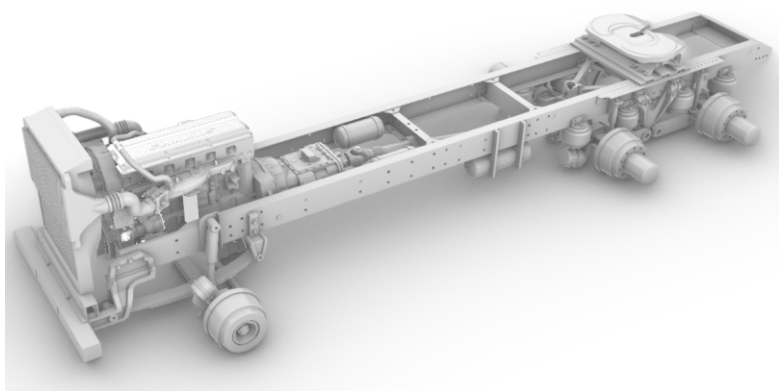

Photo-etched chassis for
Aussie T610 regular truck

Scale 1/24

Warning!

Please follow this instruction while assembling, otherwise you could face problems with assembling the model.

Photo-etched parts have sharp edges, please be careful.

This model kit contains small parts and is not suitable for children.

This model is for advanced modellers only.

Symbols:

● - glue parts;

⊗ - do not glue parts;

→└┐ - bend parts;

! - attention;

↔ - moving parts;

? - your choice;

h# - frame rails holes' numbers;

1. →└┐

2. →└┐ x8

3. ●

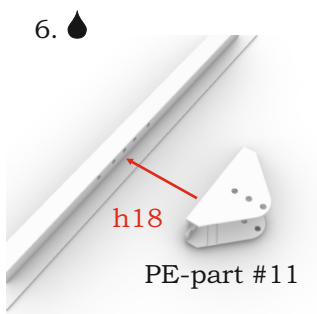
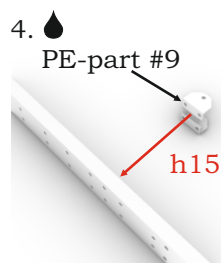
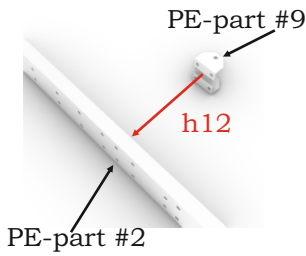
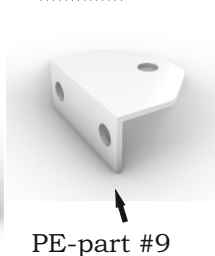
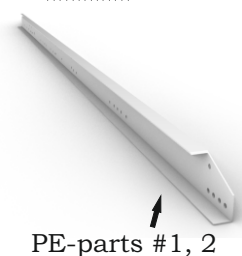

7.



PE-parts #3, 4

8.

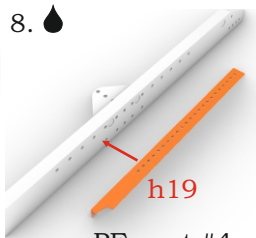

PE-part #4

9.



PE-parts #7, 8

10.

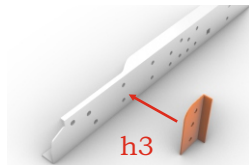

PE-part #8

11.

Repeat steps
2-10 for right
side

12.

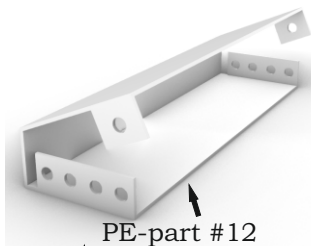

PE-part #12

13.



h20

14.

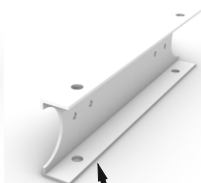

PE-part #5

15.

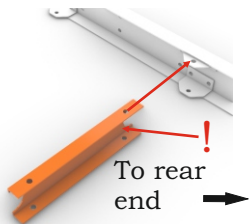

To rear
end

16.

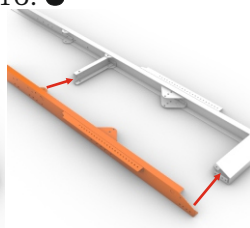

17.

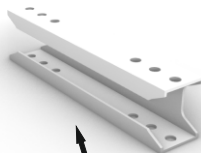

PE-part #13

18.

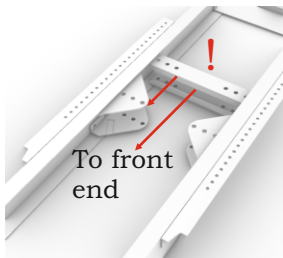

To front
end

19.

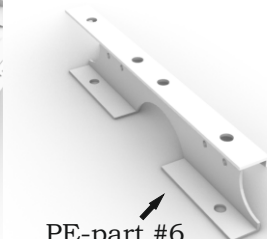

PE-part #6

20.



PE-part #10

21.

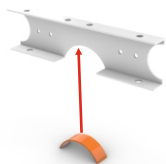

22.

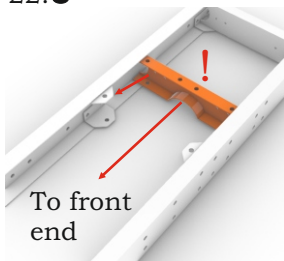

!

Green parts in this instruction are from T610 cab kit.

23. x2

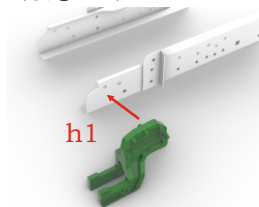

24.

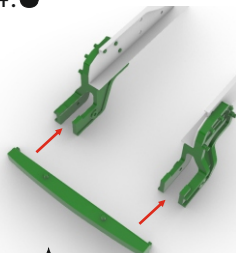

25. x2

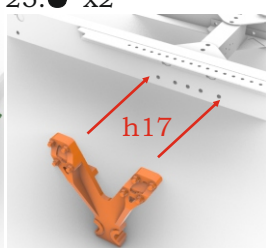

26. x2

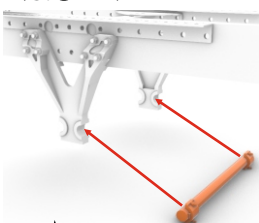

27. x2

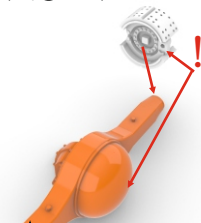

! Find this mark



28. To rear end; left side

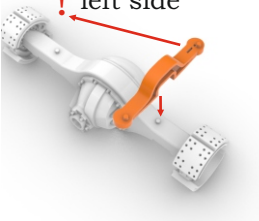

29.

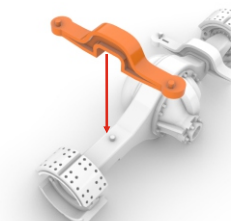

30. x2

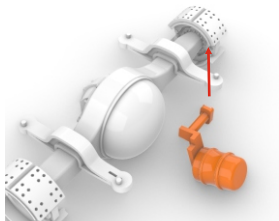

31. x2



32. x2

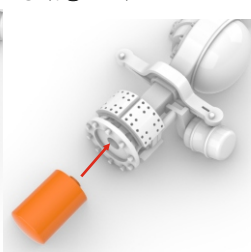

33. x2

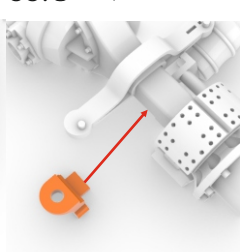

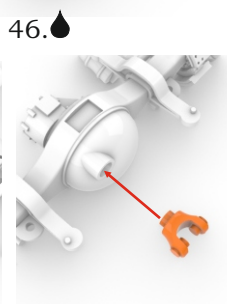
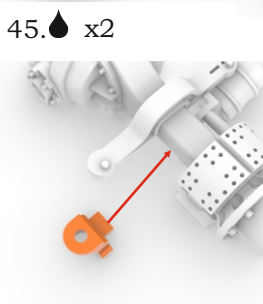
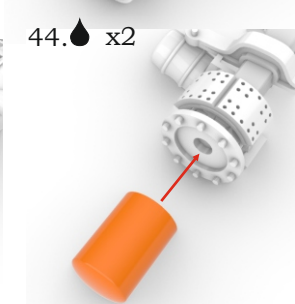
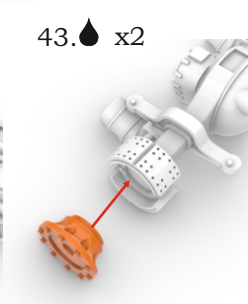
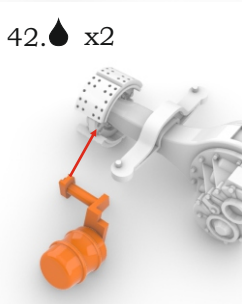
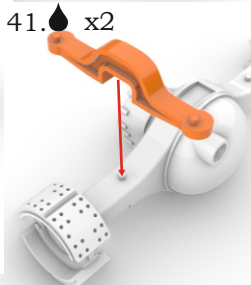
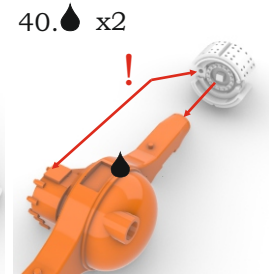
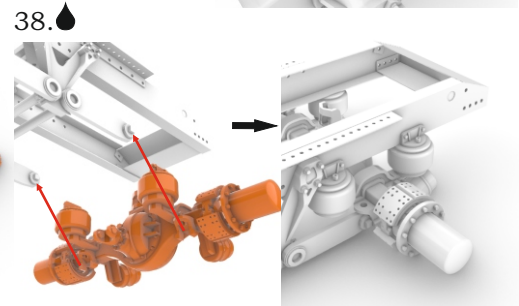
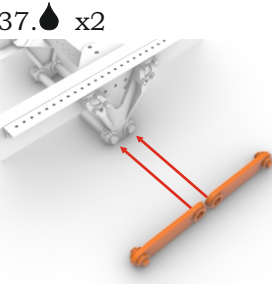
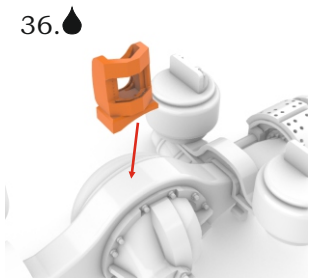
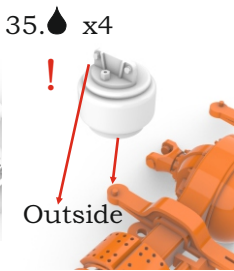

48.  x4

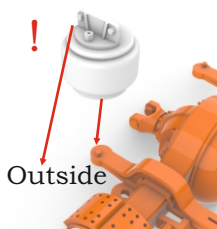

49. 

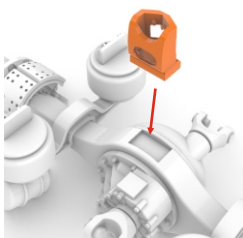

50. 

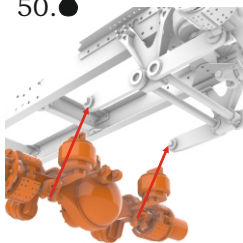

51.  x4

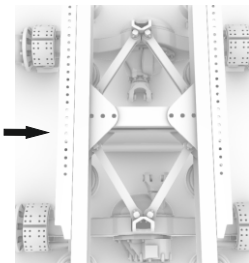
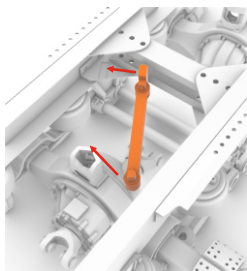

52. 

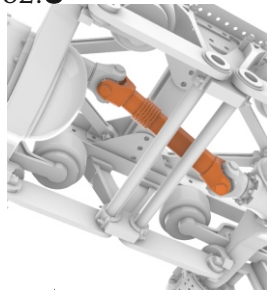

53.  x4

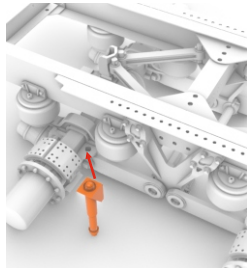

54.  x4

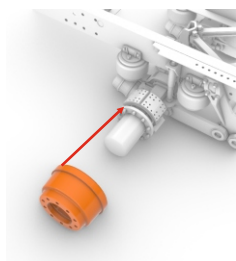

55. 

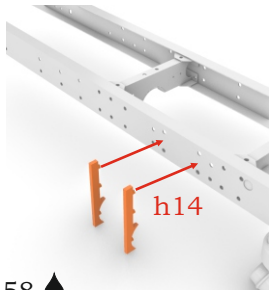

56. 

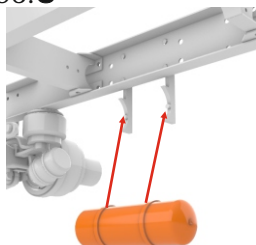

57. 

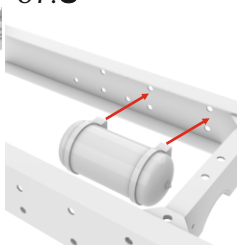

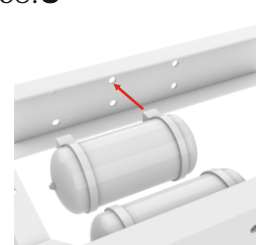

58. 

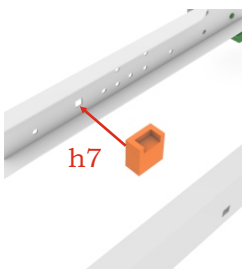

59. 

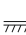

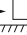
60.   
PE-part #39
from T610
cab kit

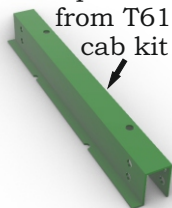

61. 

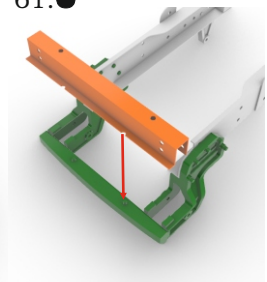

62.  x2

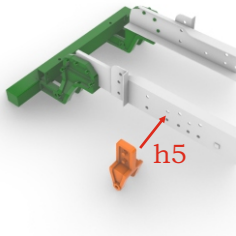

63.  x2

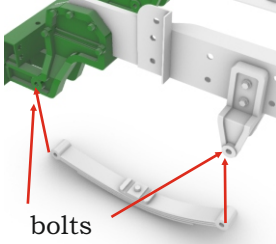

64. 

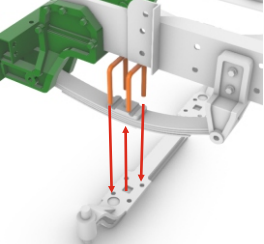

65.  x2

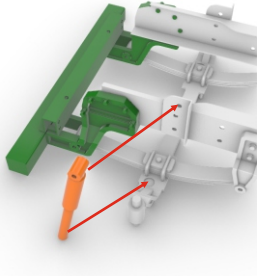

66.  x2

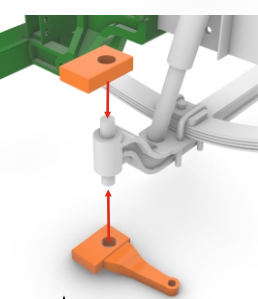

67.  x2

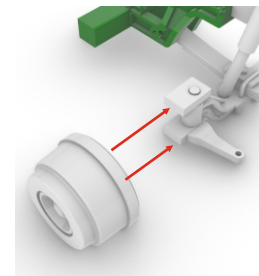

68.  x2

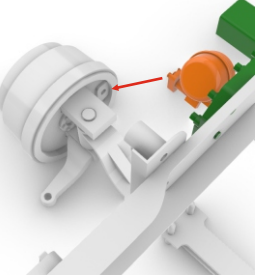

69. 

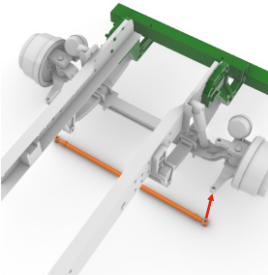

70. 

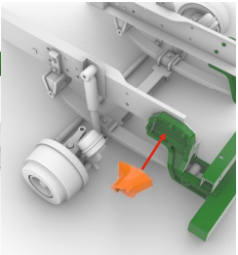

71. 



72. 

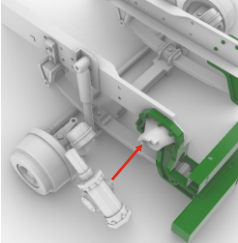

73. 

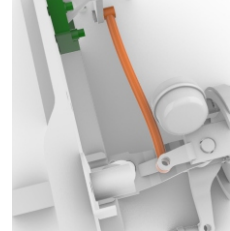

74. 

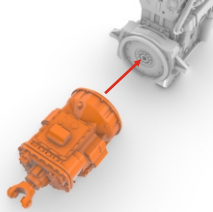

75. 

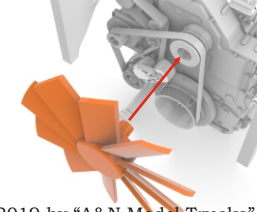

!
The engine in
this instruction -
X15 engine by
A&N Model Trucks

