



# Reefer body for 3.5 ton truck. Resin kit, 1/24

## Warning!

This is the full resin kit; no donor kits required.

Read carefully this instruction and please follow it during assembling, otherwise you could face problems with assembling the model.

Photo-etched parts have sharp edges, please be careful.

This model kit contains very small parts and is not suitable for children.

This model kit for advanced modellers only!

You can download this instruction as PDF-file at the our site at «Instructions» section.

---

## Symbols:

 - glue parts;

 - do not glue parts;

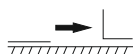
 - bend parts;

 - attention;

 - moving parts;

 - your choice;

 - cut;

# Numbers of photo-etched parts

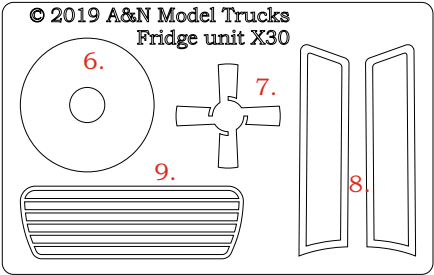
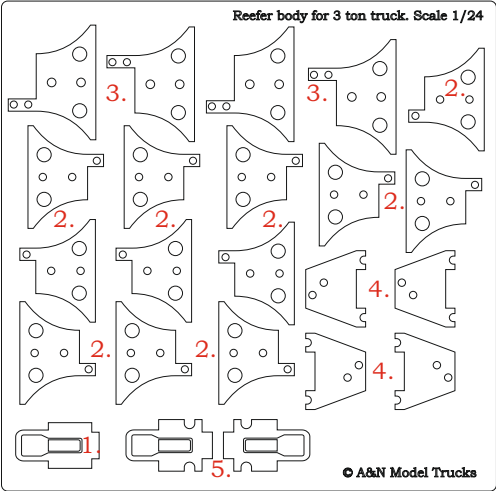

1. x12

PE-part #2

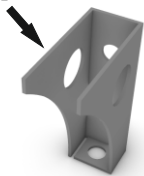

2. x4

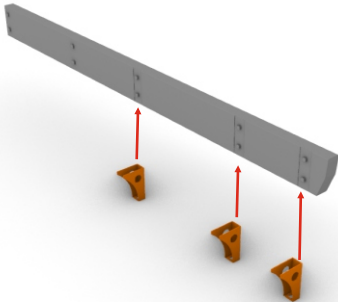

3. x4

PE-part #3



4. x2

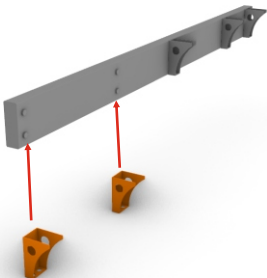

5.

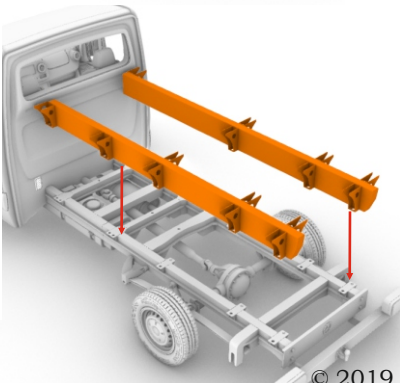

6. x20

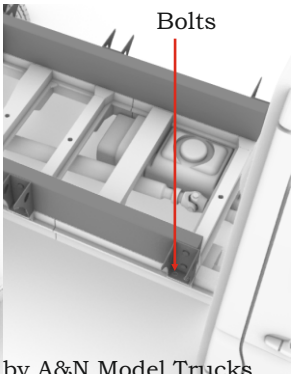

Bolts

# Reefer body for 3.5 ton truck. Resin kit, 1/24

6.

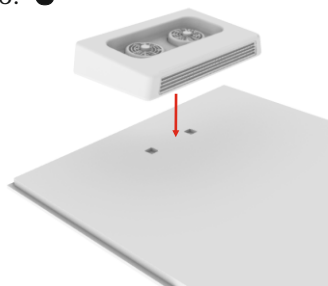

7.

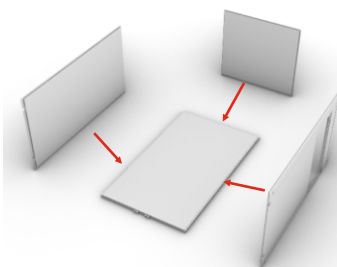

8.

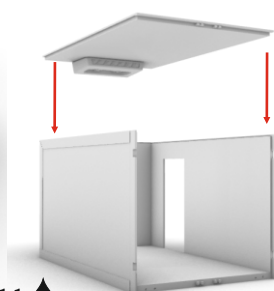

9. x2

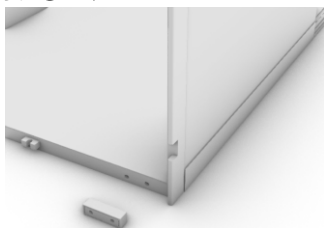

10. x2

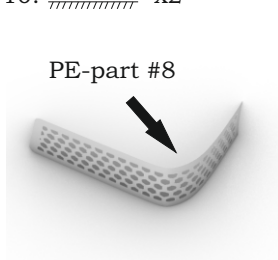

11.

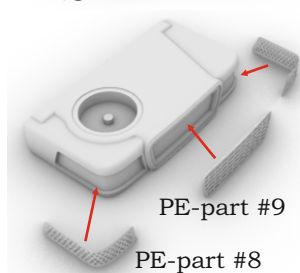

12.

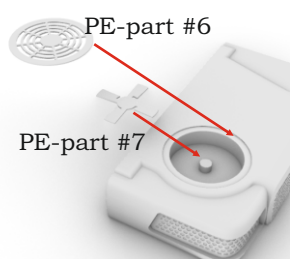

13.



14. x2



15.

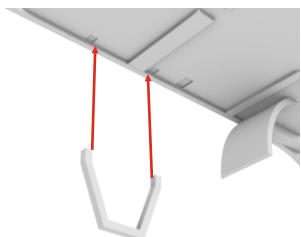

16. x2

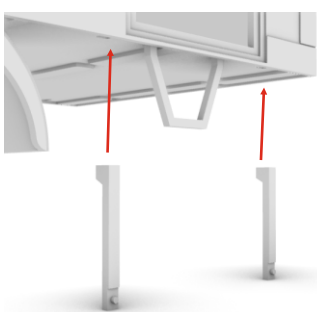

17. x2

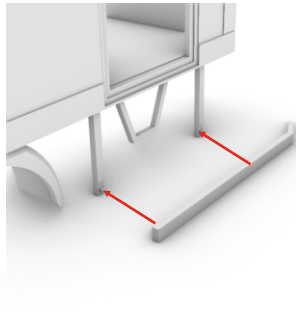

# Reefer body for 3.5 ton truck. Resin kit, 1/24

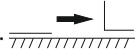
18.  x4

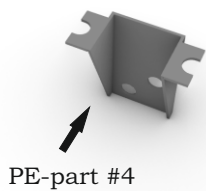

19.  x2

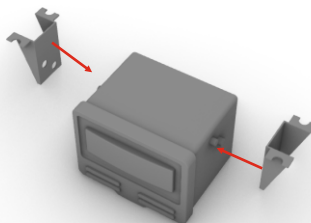

20.  x2

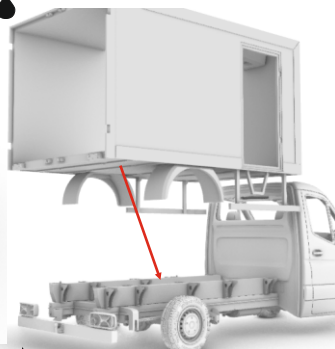

21.  x2

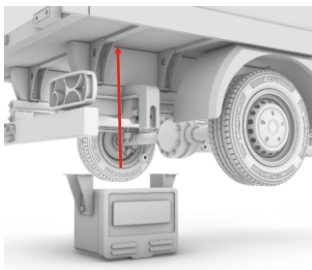

22.  x2

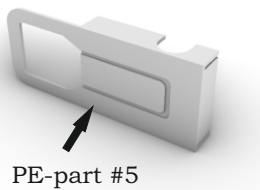

23.  x2

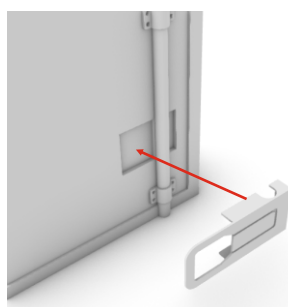

24.  x2

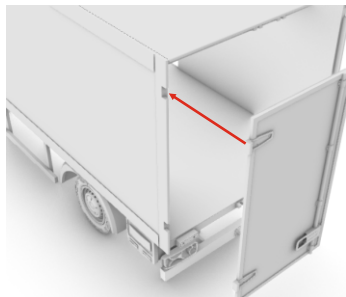

OR

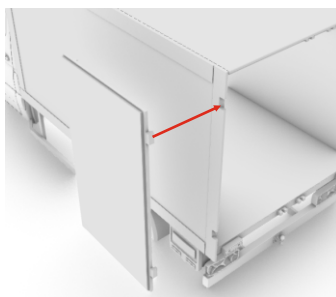

25.  x2

PE-part #1

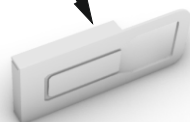

26.  x2

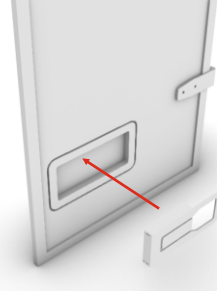

27.  x2

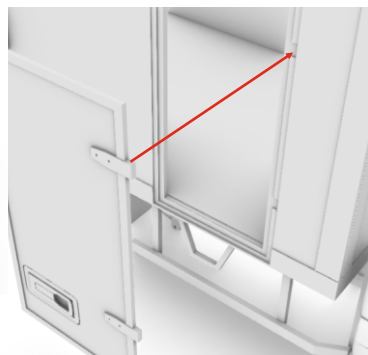

OR

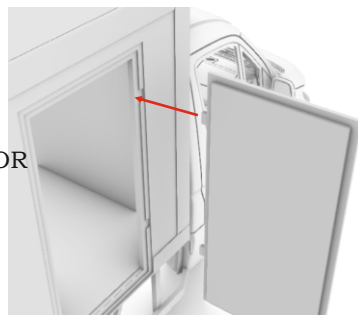

Reefer body for 3.5 ton truck. Resin kit, 1/24

27. 

