



# German construction truck

## Conversion kit, 1/24

## Warning!

This kit requires a donor chassis. As default chassis we suggest to use Italeri's generic American chassis (except Volvo VN and Perbilts).

Read carefully this instruction and please follow it during assembling, otherwise you could face problems with assembling the model.

Photo-etched parts have sharp edges, please be careful.

This model kit contains very small parts and is not suitable for children.

This model kit is for advanced modellers only!

You can download this instruction as PDF-file at the our site at «Instructions» section.

---

## Symbols:

 - glue parts;

 - do not glue parts;

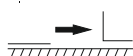
 - bend parts;

 - attention;

 - moving parts;

 - your choice;

 - cut;

### Numbers of photo-etched parts

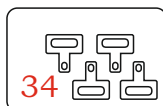
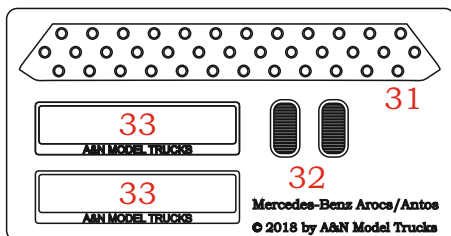
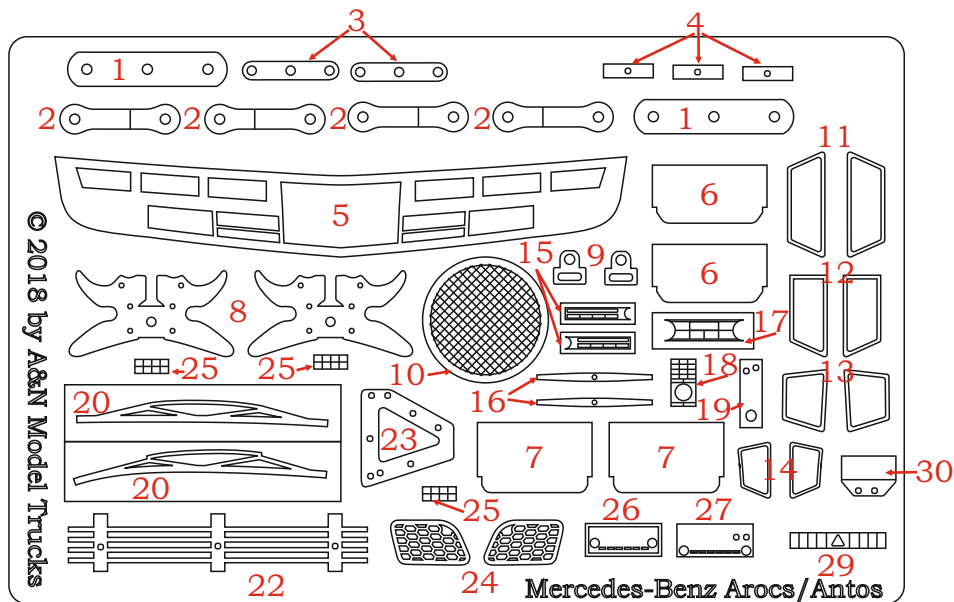

1.  x2

2. 

3. 

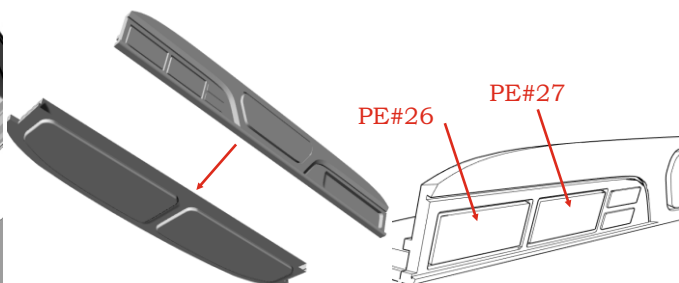
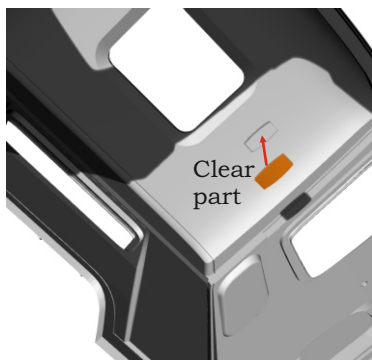

German construction truck. Conversion kit, 1/24

4.

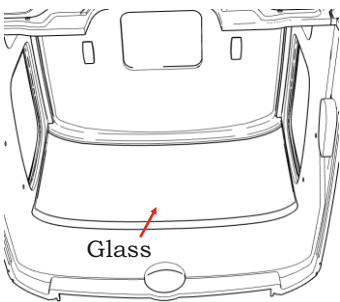

5.

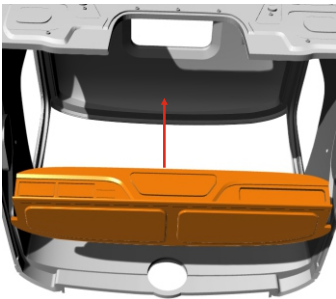

6. x

PE#7

PE#6



7. x2

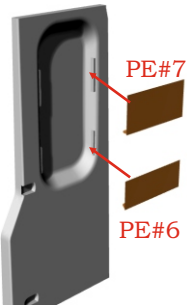

8. x2

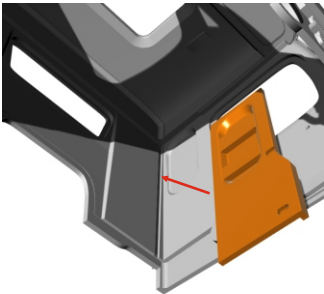

9. x2

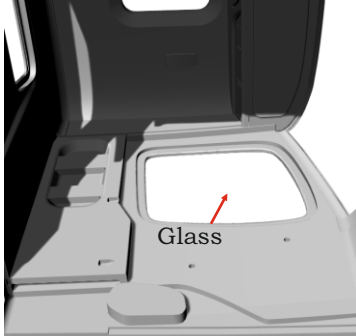

10. x2

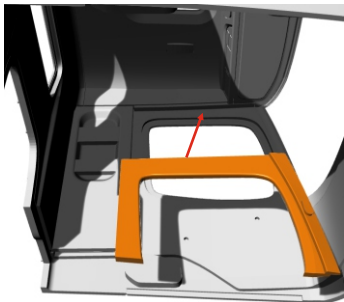

11.

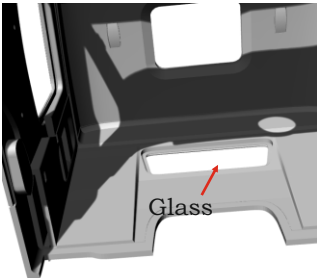

12. x2

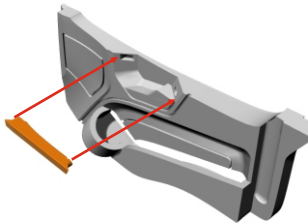

13. x2

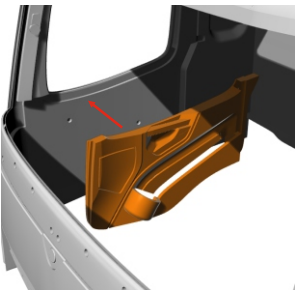

14. x2

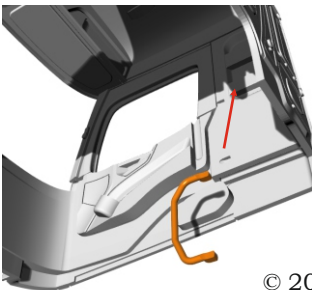

15.

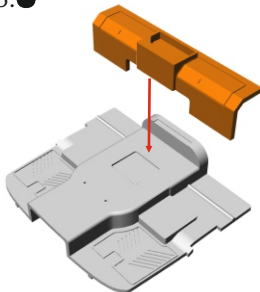

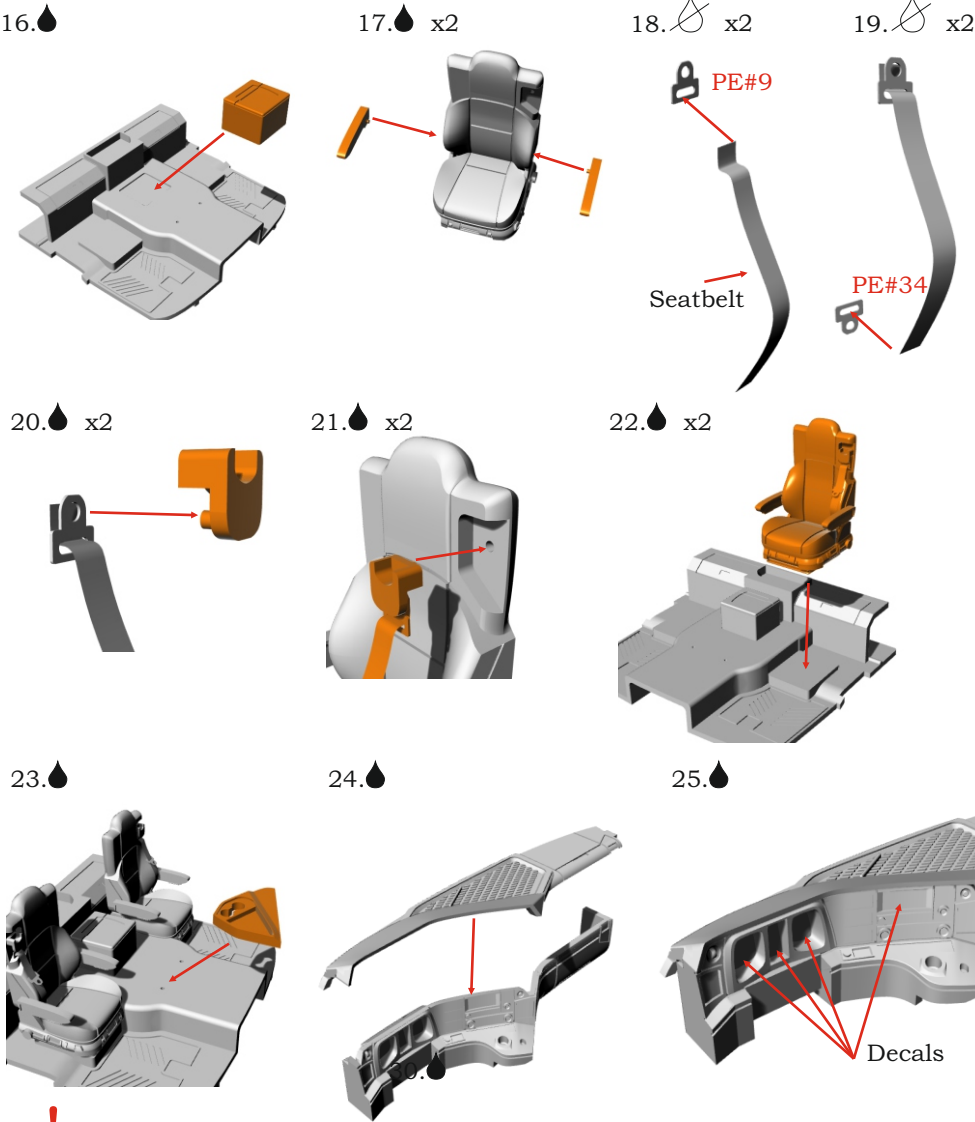

! For RHD setup  
look for marked  
packet with parts

26. 

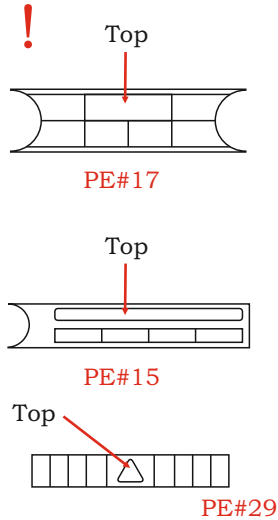
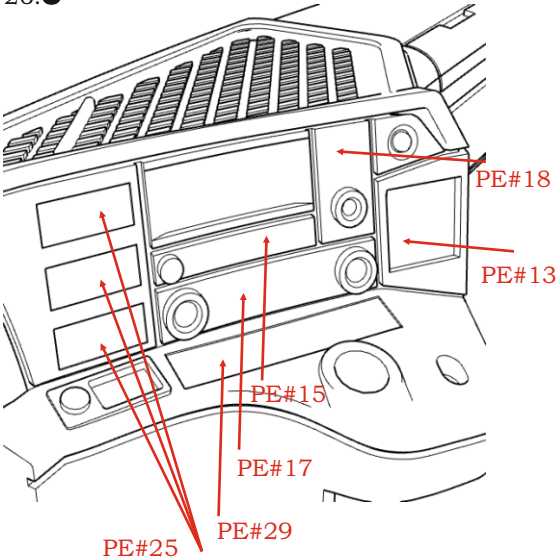

27. 

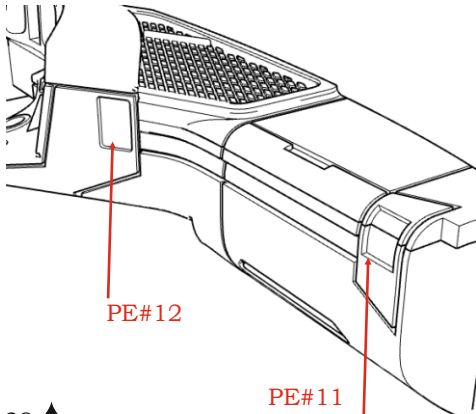

28. 

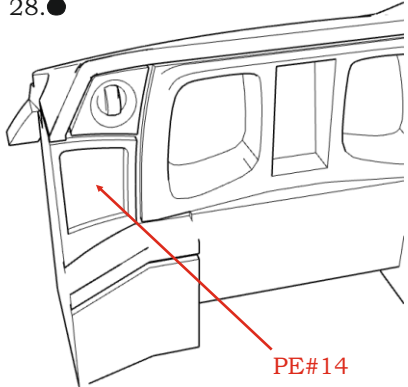

29. 

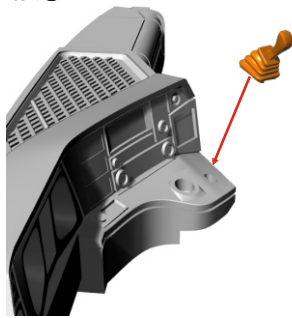

30. 

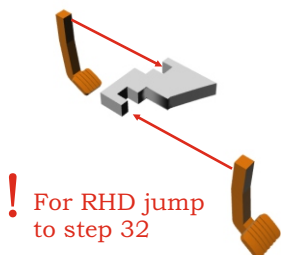

31. 

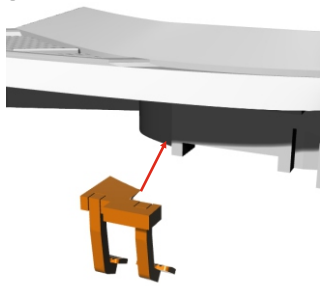

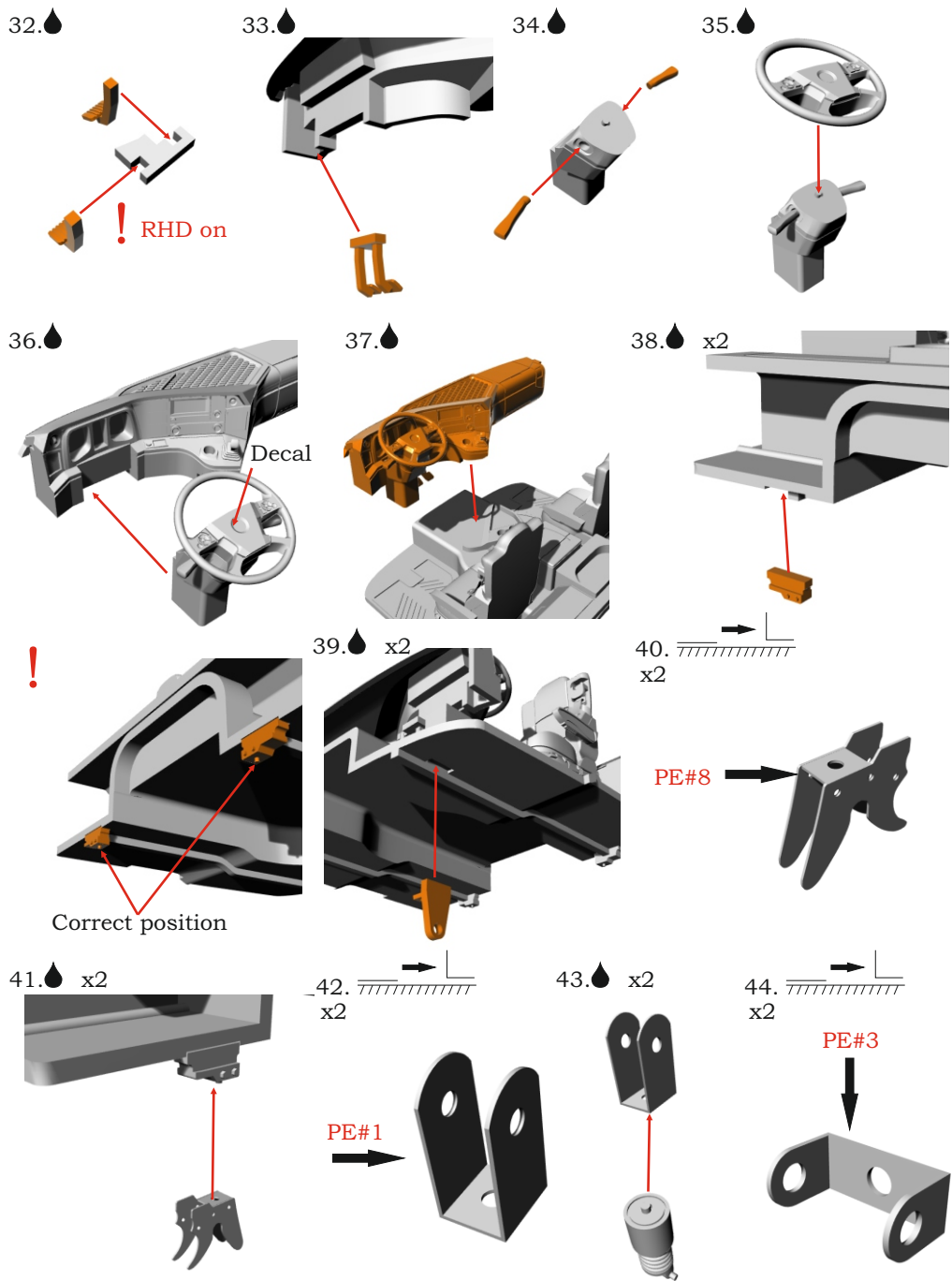

45.  x2

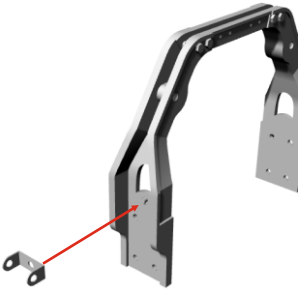

46.  x2

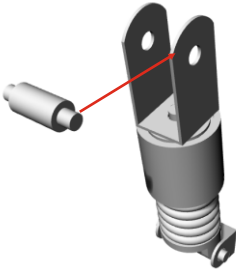

47.  x2

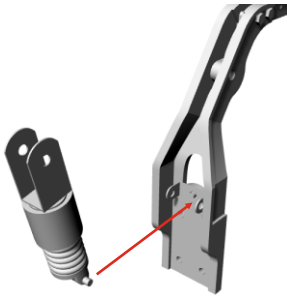

48.  x4

PE#2

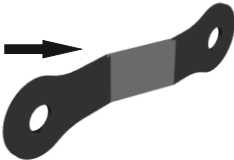

49.  x2

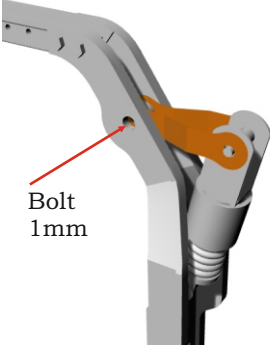

50. 

Step 16 of Italeri assembling instruction.

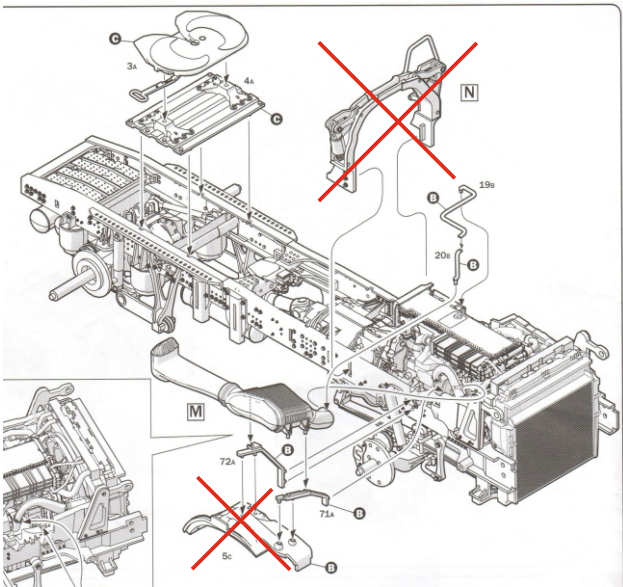
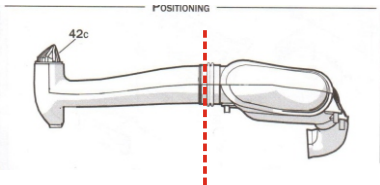



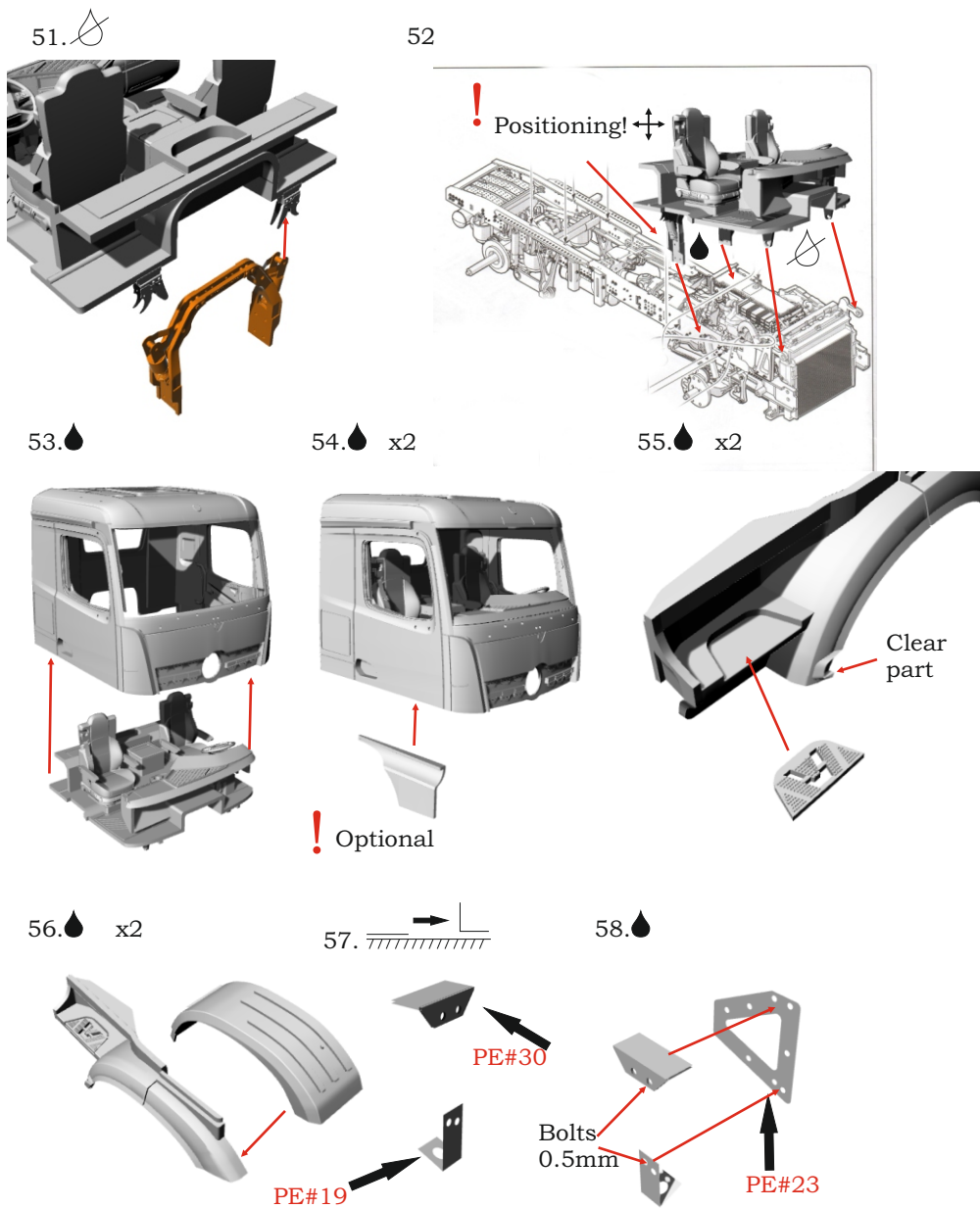

59. 

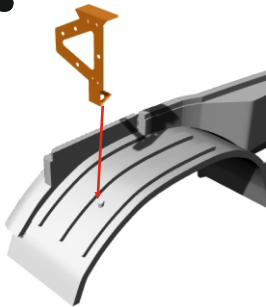

60. 

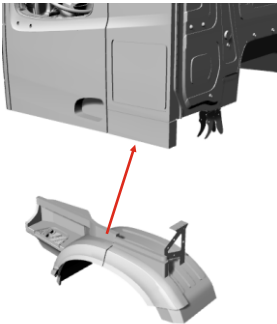

61. 

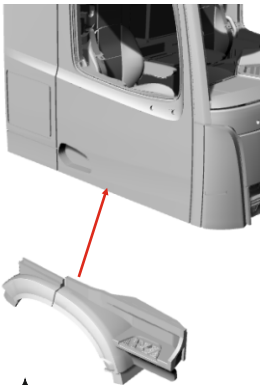

62. x2

Step 20 of instruction  
by Italeri.

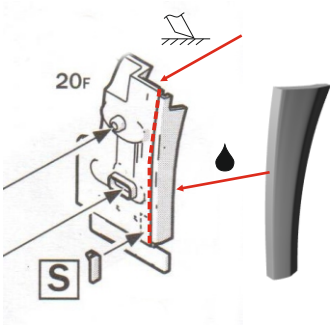

63.  x2

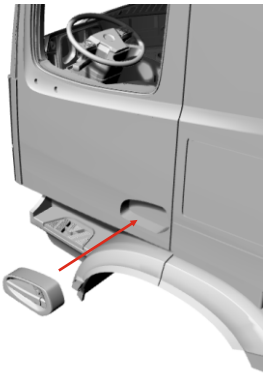

64. 

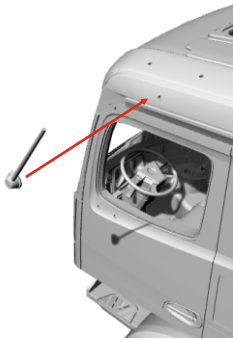

65. 



66.  x2

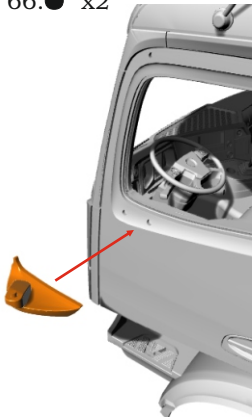

67.  x2

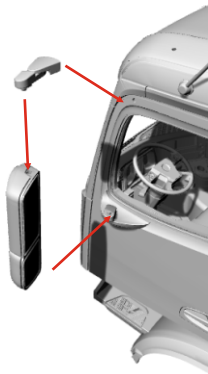

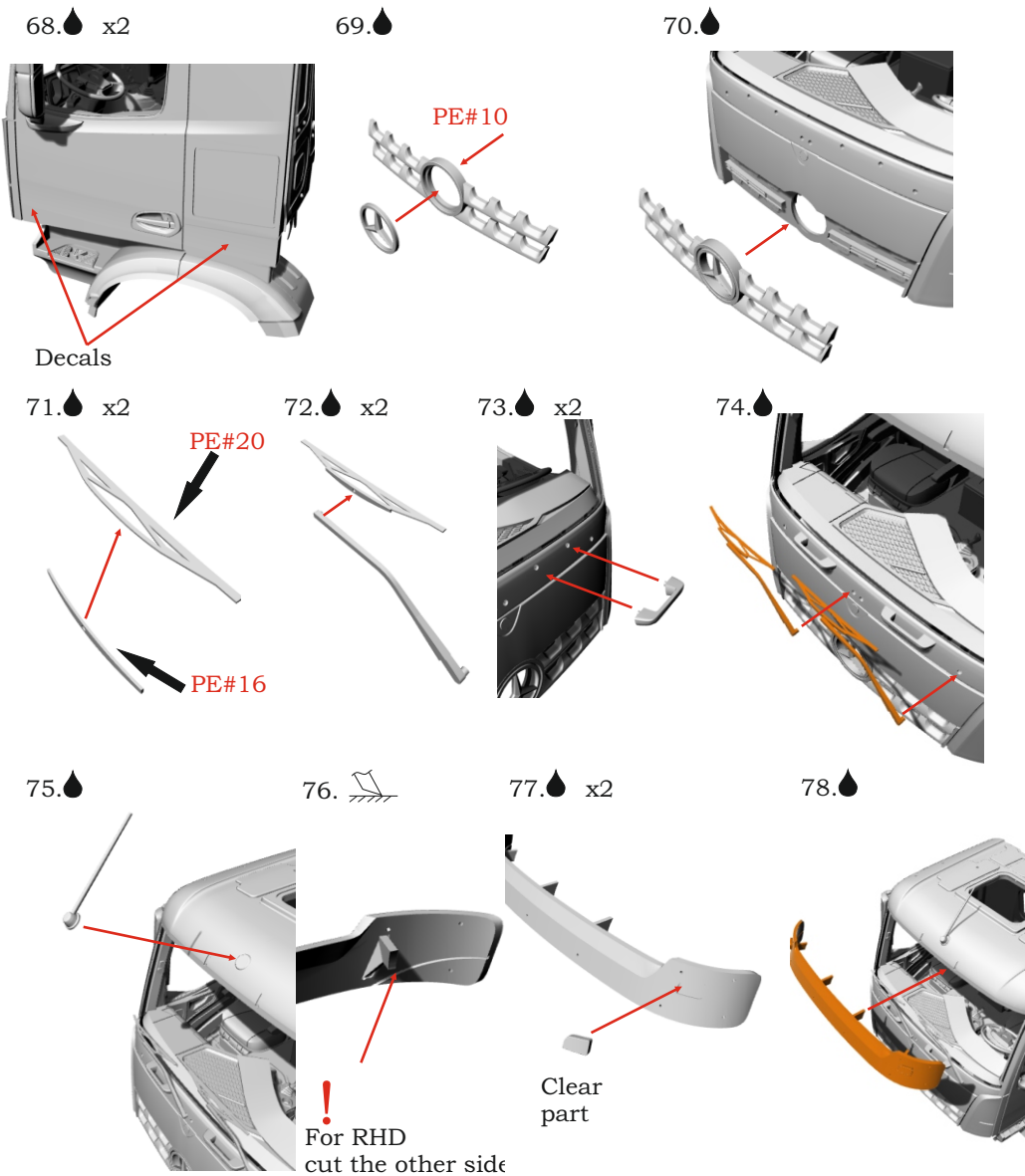

79. 

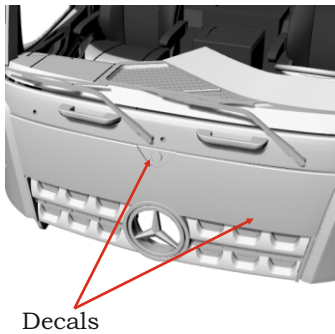

80. 

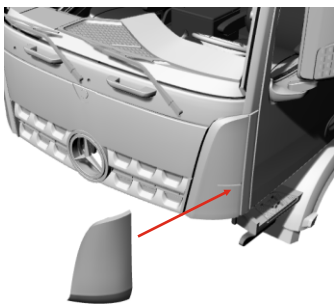

81. 

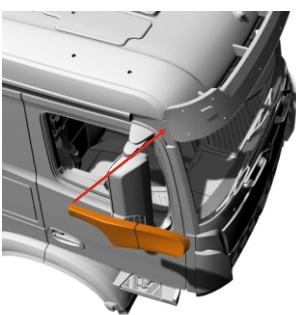

82. 



83. 



84.  x2

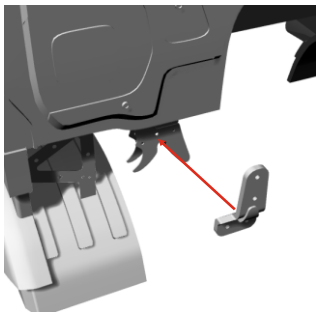

85.  x2

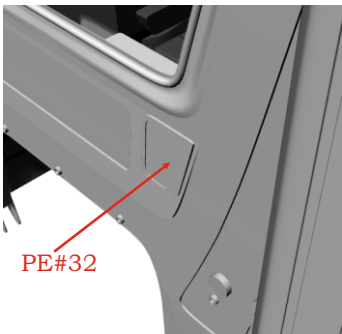

86. 

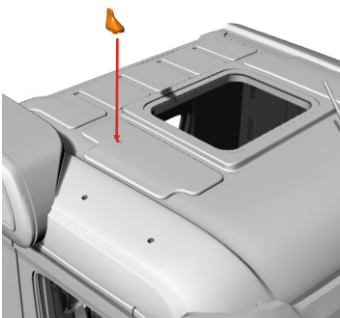

87.  x2

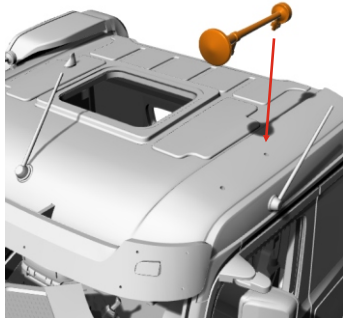

German construction truck. Conversion kit, 1/24

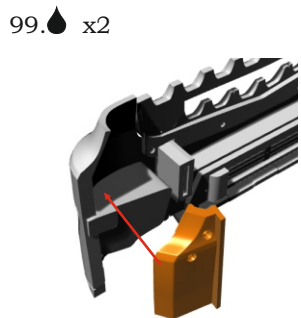
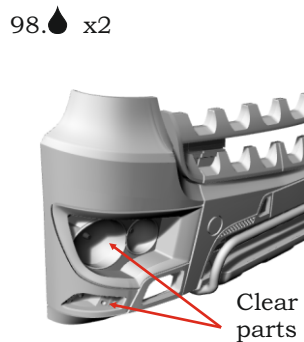
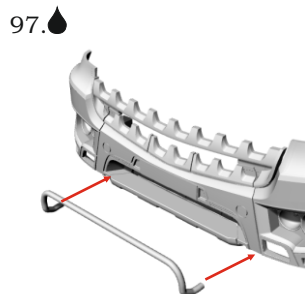
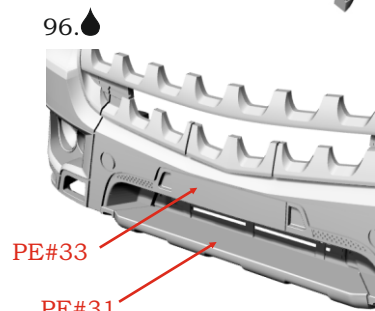
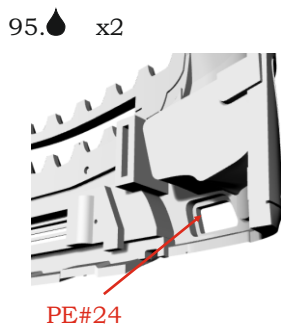
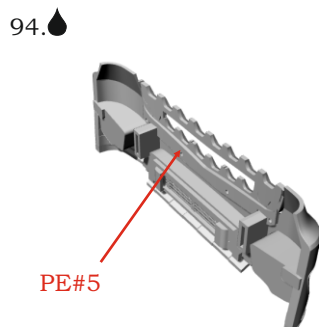
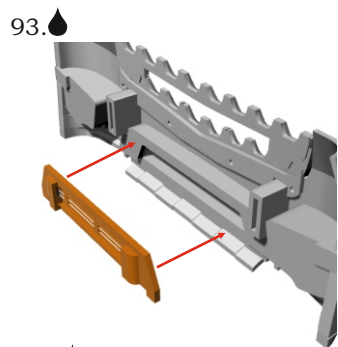
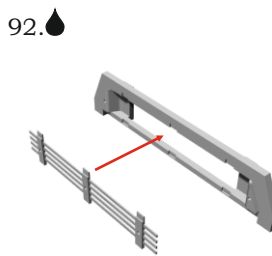
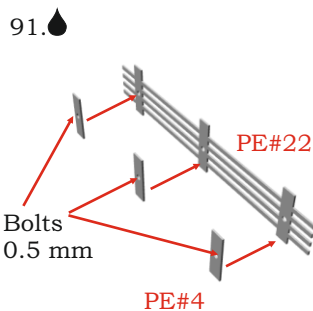
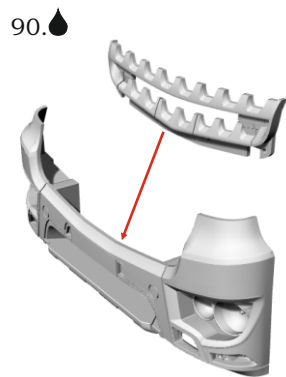
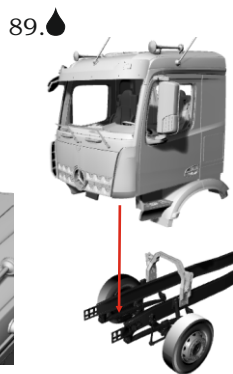
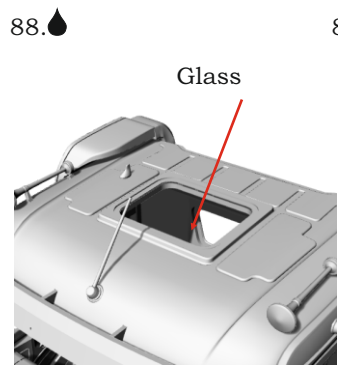

Clear parts

German construction truck. Conversion kit, 1/24

100.  x2

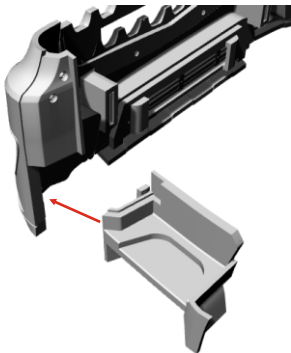

101.  x2

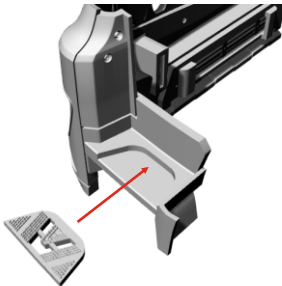

102.  x2

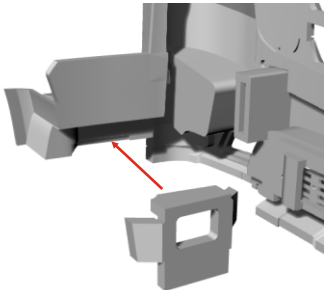

103.  x2

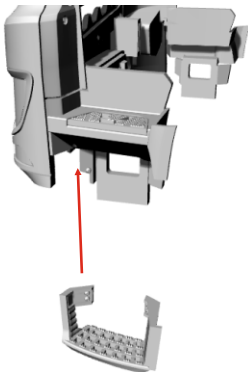

104. 

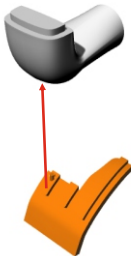

105. 

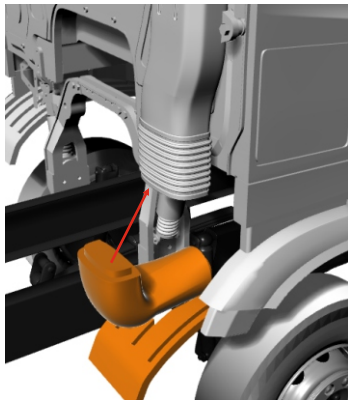

106. 

