

6x2/4 pusher chassis
for Swedish truck

Scale 1/24

Warning!

Please follow this instruction while assembling, otherwise you could face problems with assembling the model.

Photo-etched parts have sharp edges, please be careful.

This model kit contains small parts and is not suitable for children.

For building this model some modelling skills are required.

Symbols:

● - glue parts;

⌀ - do not glue parts;

→└ - bend parts;

! - attention;

↔ - moving parts;

? - your choice;

h# - frame rails holes' numbers;

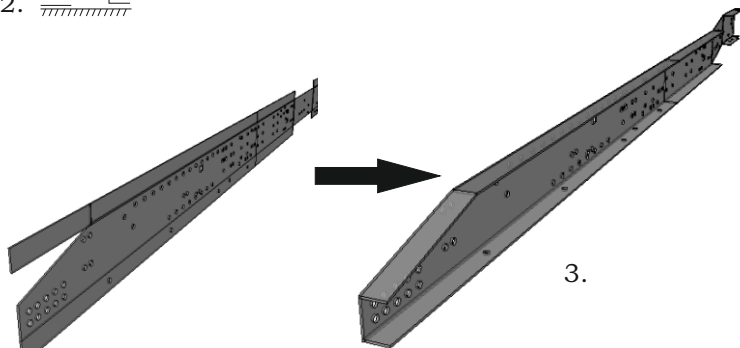
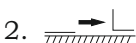
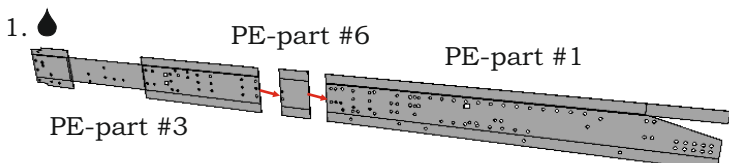

6x2/4 pusher chassis for Swedish truck

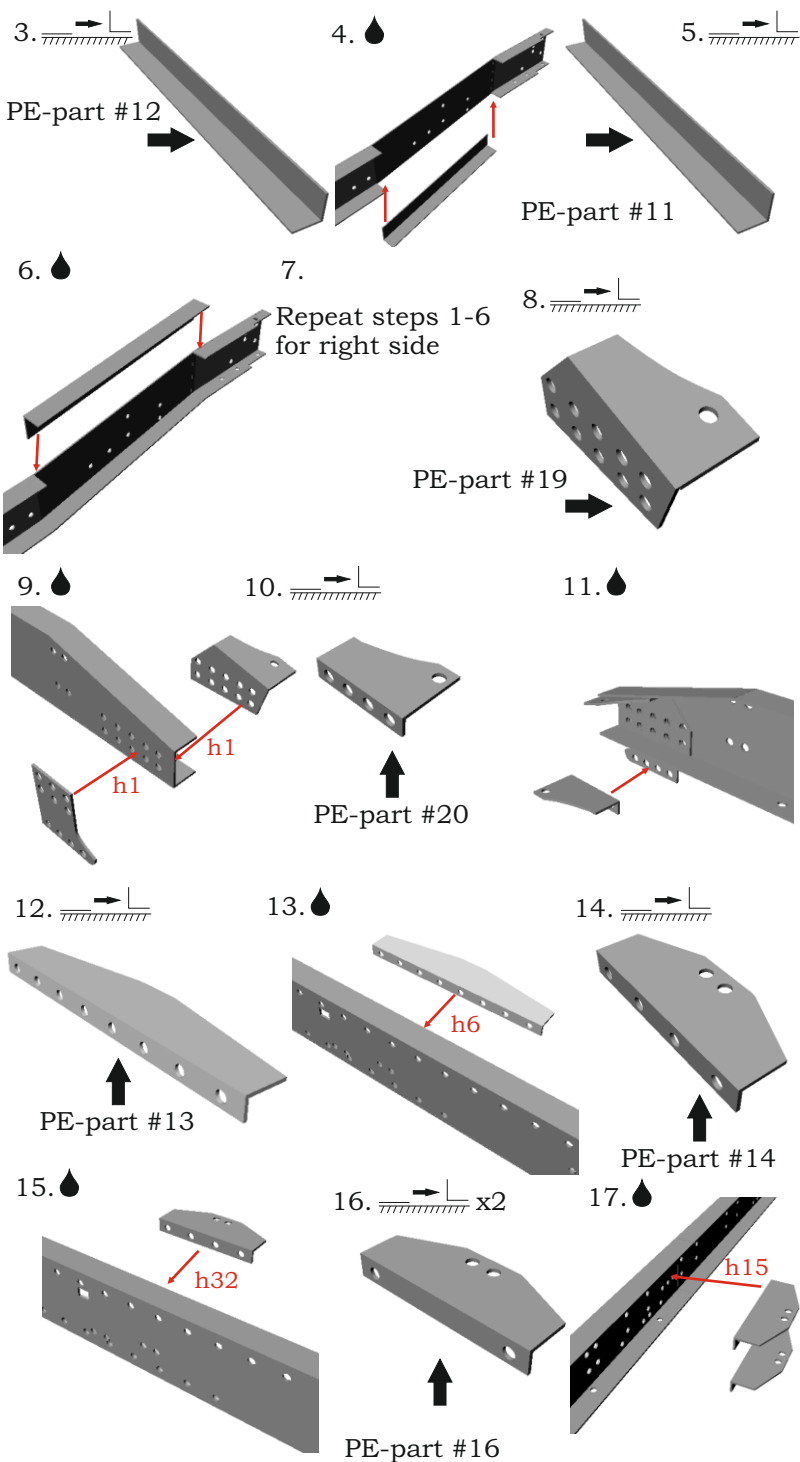

6x2/4 pusher chassis for Swedish truck

18. 

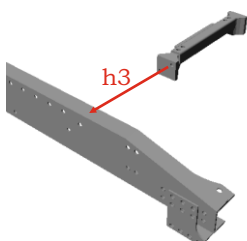

19.

Repeat steps
3-17 for right
side.

20. 

PE-part #15

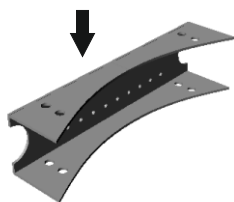

21. 

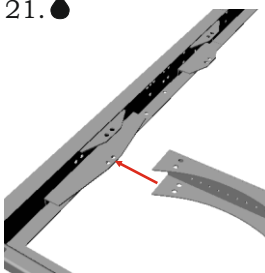

22. 

PE-part #17

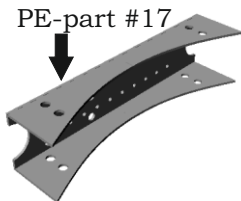

23. 

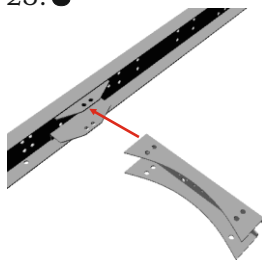

24. 

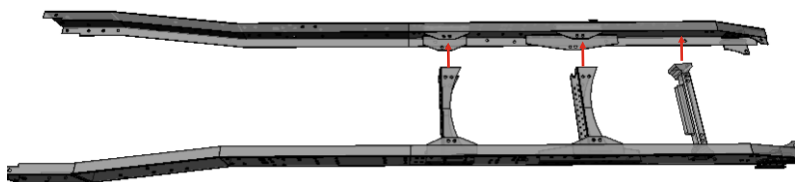

25. 

PE-part #21

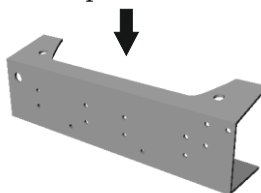

26. 

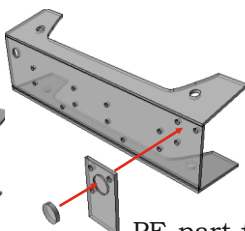

27. 

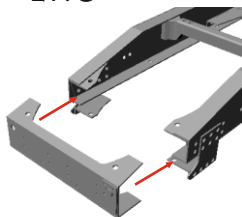

PE-part #23

PE-part #22

28. 

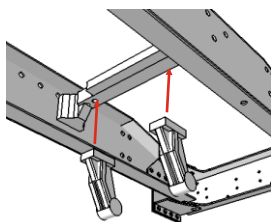

29. 

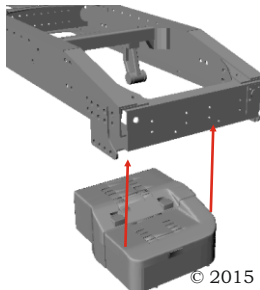

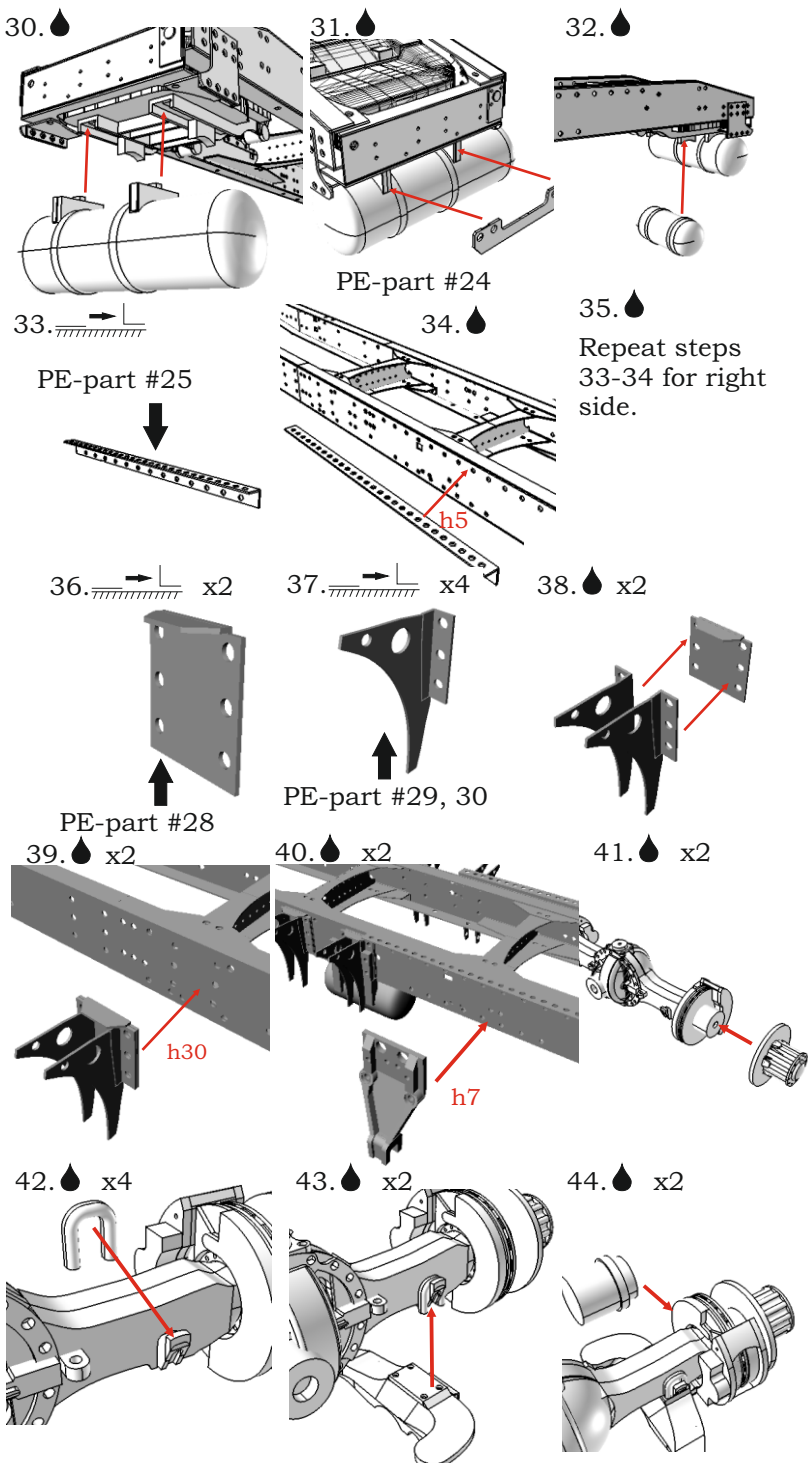

6x2/4 pusher chassis for Swedish truck

45.  x2

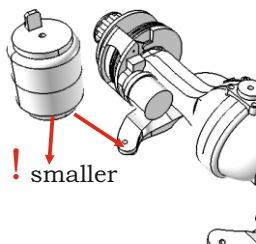

46.  x2

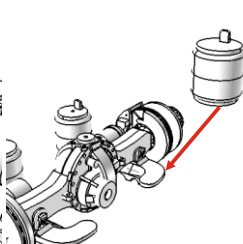

47.  x2

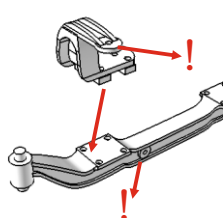

48.  x2

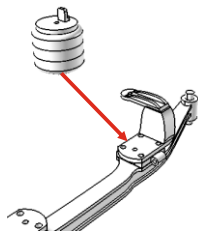

49.  x2

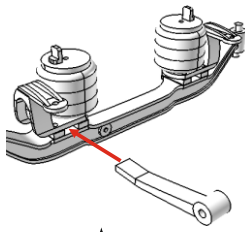

50.  x2

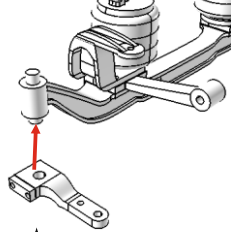

51.  x2

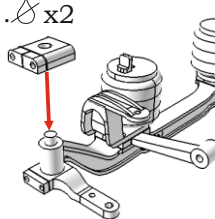

52.  x2

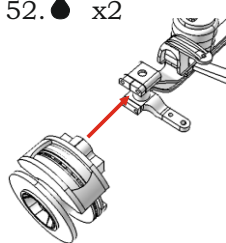

53.  x2

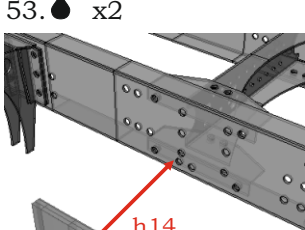

54.  x2

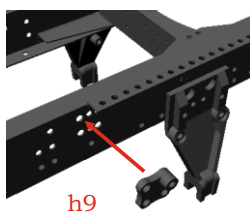

55.  x2

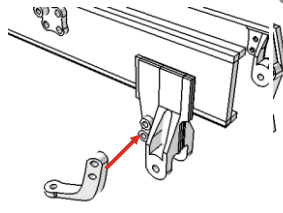

56.  x2

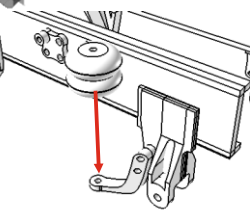

57. 

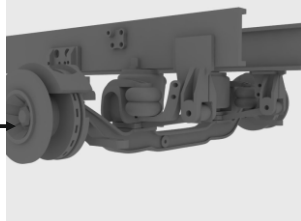
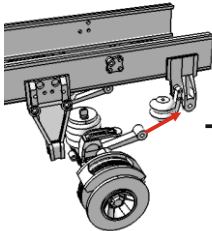

58. 

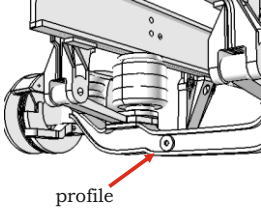

6x2/4 pusher chassis for Swedish truck

59. 

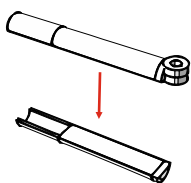

60. 

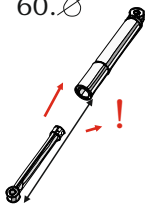

61. 

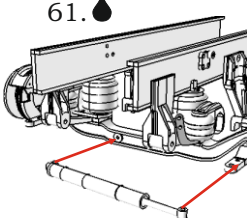

62. 

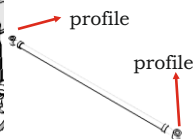

63. 

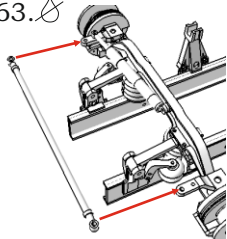

64.  x2

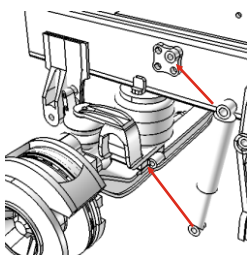

65. 

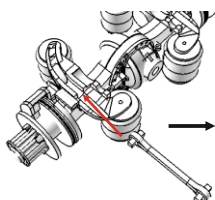

66. 

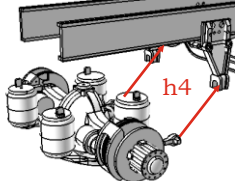

67. 

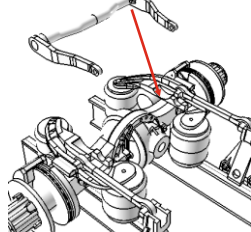

68. 

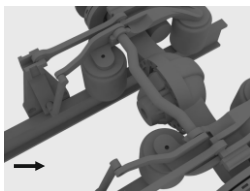
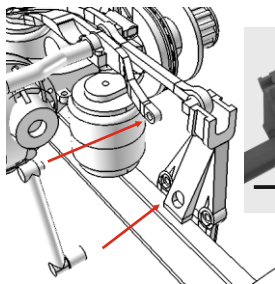

69. 

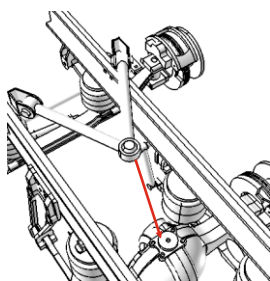

70. 

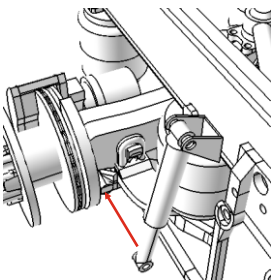

6x2/4 pusher chassis for Swedish truck

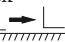
71. 

72. 

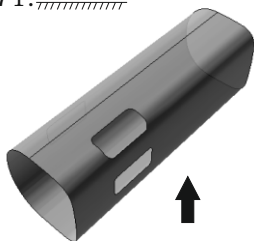

PE-part #46

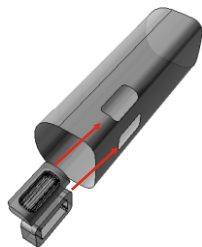

73.  x4

74.  x2

75. 

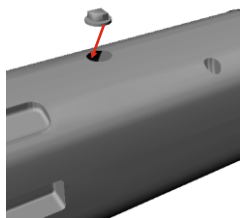
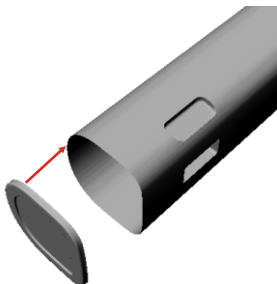

76. 

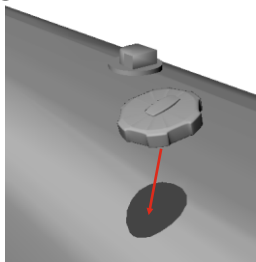

!

Please visit our site <http://an-modeltrucks.com> for detailed photo-instruction for fuel tanks.



“Instructions”section->How to make photo-etched fuel tank.
Photo-instruction, or use this link:

<http://an-modeltrucks.com/how-to-make-photo-etched-fuel-tank-photo-instruction/>

Or use QR-code below:



6x2/4 pusher chassis for Swedish truck

77.  x2 78. 



PE-part #44

round profile

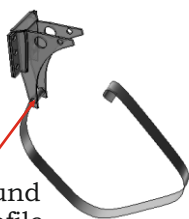

79. 

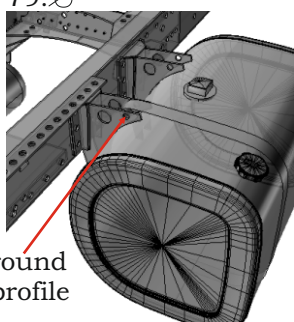

round profile

80.

81. 

82. 

Repeat steps
78-79

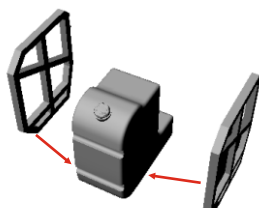
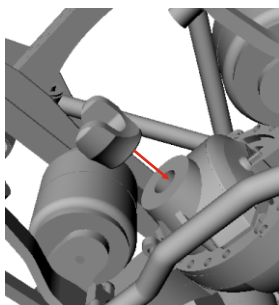

83. 

84. 

85. 

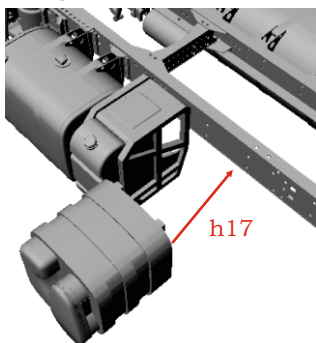
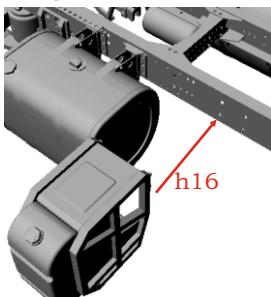
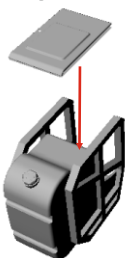

86. 

87. 

88.  ?



PE-part #27

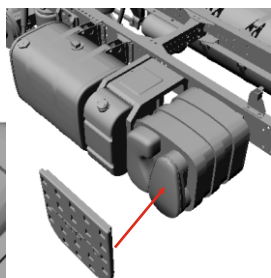
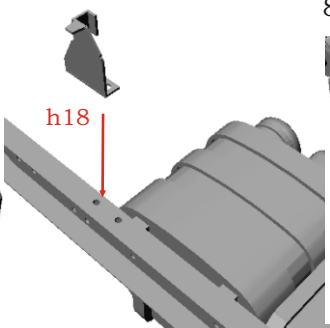

6x2/4 pusher chassis for Swedish truck

89.

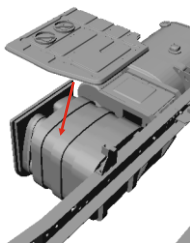

90.

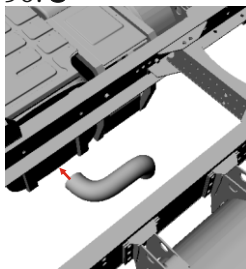

91. x2

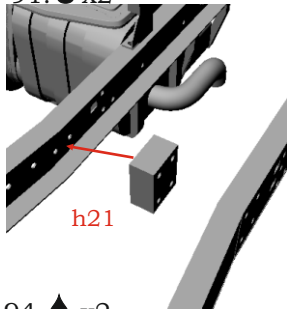

92.

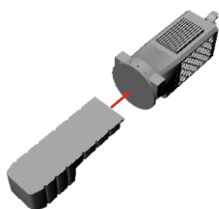

93.

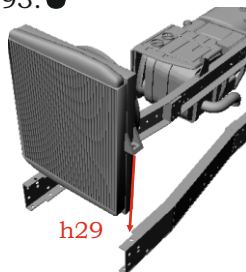

94. x2

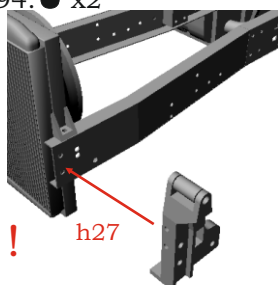

95.

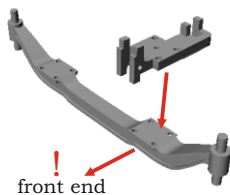

96.

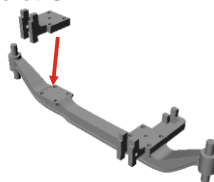

This part is from our
"Swedish truck (Euro6)
kit!"

97.

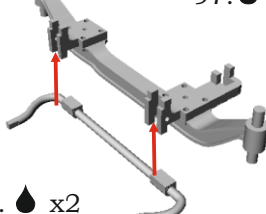

98. x2

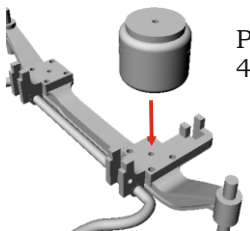

99. x2

PE-parts #41R,
41L



100. x2

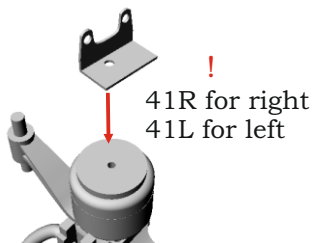

101.

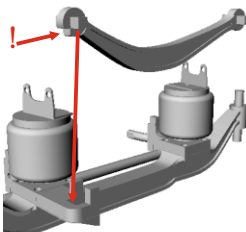

102. x2

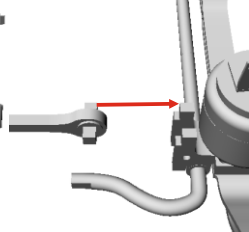

103. x2

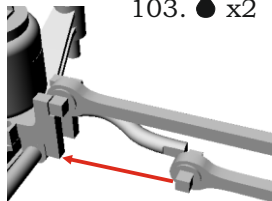

6x2/4 pusher chassis for Swedish truck

104.  x2

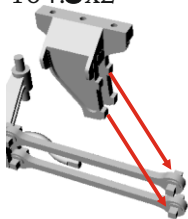

105. 

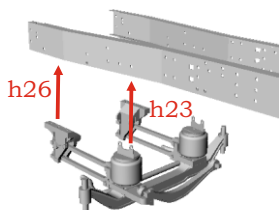

106. 

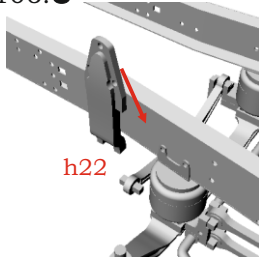

107.  x2

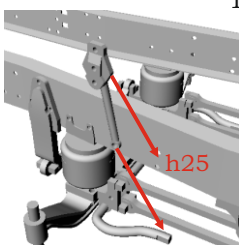

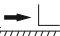
108.  x2

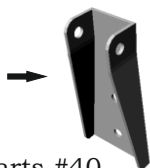

PE-parts #40

109. 

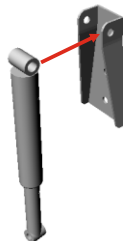

110.  x2

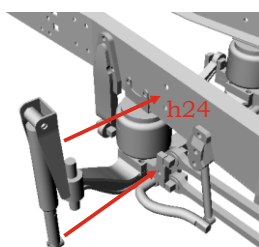

111. 



112. 

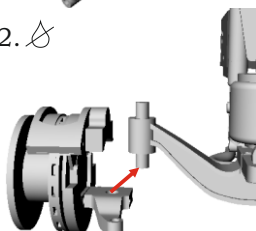

113.  x2

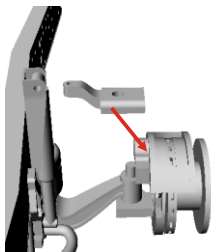

114. 

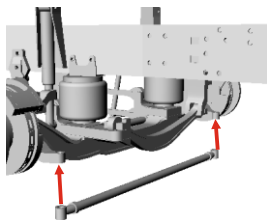

115. 

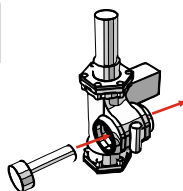

116. 

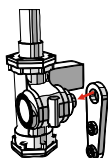

117. 

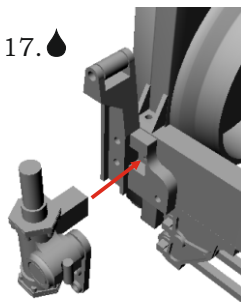

118. 

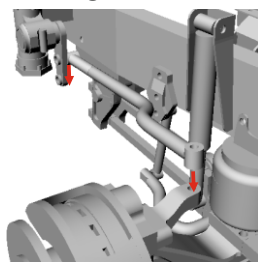

6x2/4 pusher chassis for Swedish truck

119. 

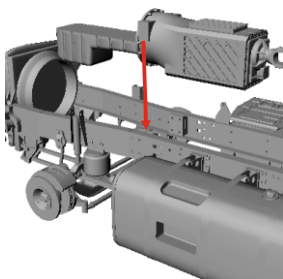

120. 

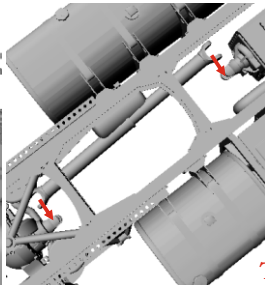

121.  x2

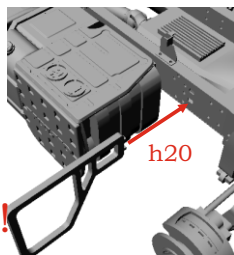

h20

This part is from our
"Swedish truck (Euro6)
kit!

122. 

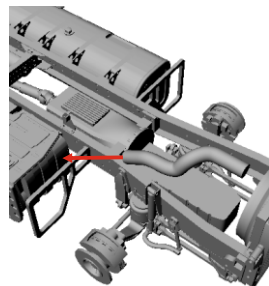

123. 

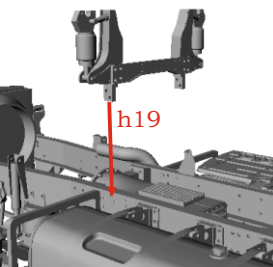

h19

This part is from our
"Swedish truck (Euro6)
kit!

124. 

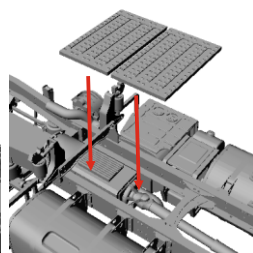

125. 



126. 

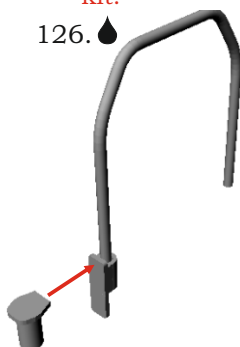

127. 

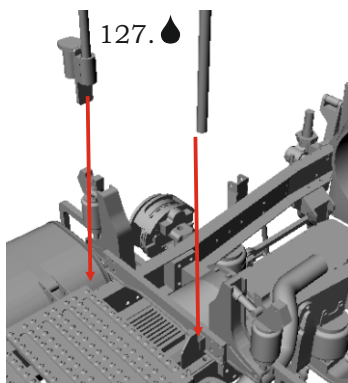

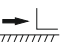
128. 

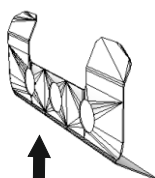

PE-part #35

129. 

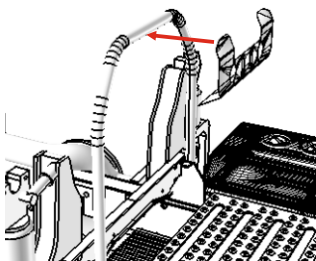

6x2/4 pusher chassis for Swedish truck

130. 

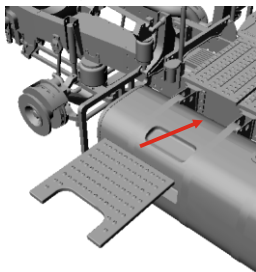

131.  x2

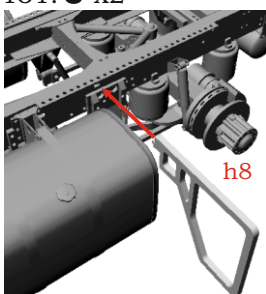

132.  x2

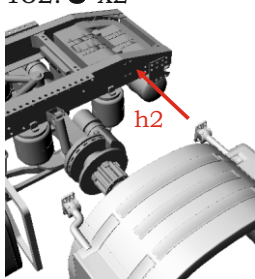

! These parts are from our “Swedish truck (Euro6) kit!

133.  x2

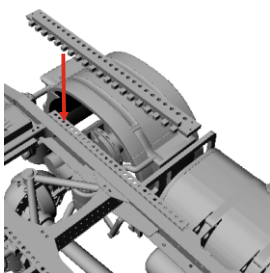

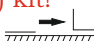
134.  x2

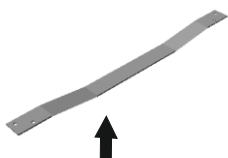

PE-parts #37, 38

135.  x2

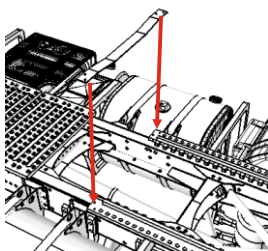

136. 

137. 

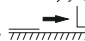
138. 

139.  x2

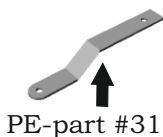

PE-part #31

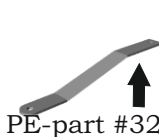
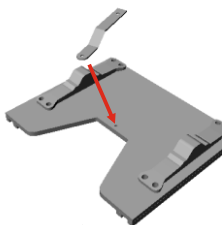

PE-part #32



PE-parts
#36, #39

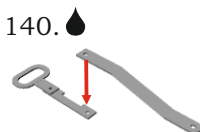

140. 

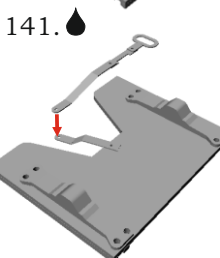

141. 

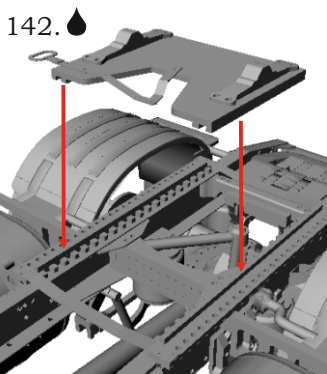

142. 

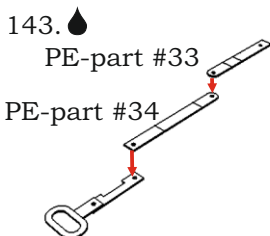

143. 

PE-part #33

PE-part #34

6x2/4 pusher chassis for Swedish truck

144. 

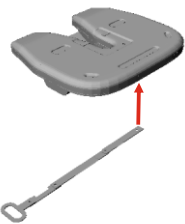

145. 

