

4x2 chassis for Swedish truck.

Scale 1/24

### Warning!

Please follow this instruction while assembling, otherwise you could face problems with assembling the model.

Photo-etched parts have sharp edges, please be careful.

This model kit contains small parts and is not suitable for children.

For building this model some modelling skills are required.

### Symbols:

● - glue parts;

⊗ - do not glue parts;

→└┐ - bend parts;

! - attention;

↔ - moving parts;

? - your choice;

h# - frame rails holes' numbers;

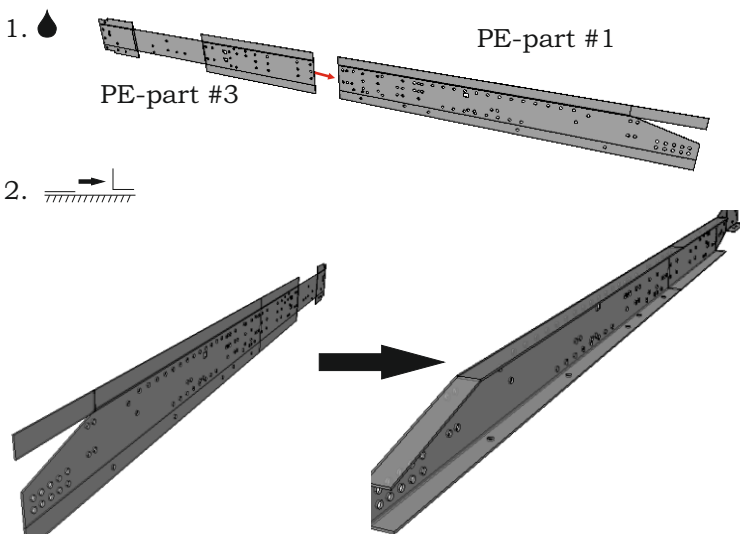

4x2 chassis for Swedish truck

3. 

PE-part #12

4. 

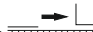
5. 

PE-part #11

6. 

7.

Repeat steps 1-6  
for right side

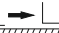
8. 

PE-part #19

9. 

10. 

11. 

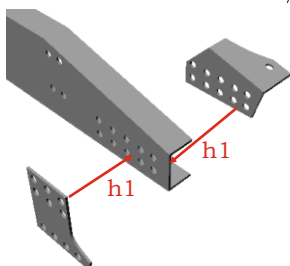

PE-part #20

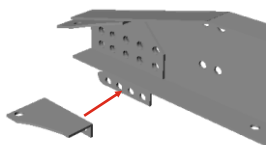

12. 

13. 

14. 

PE-part #13

15. 

16.  x2

17. 

h32

PE-part #16

h15

4x2 chassis for Swedish truck

18. 

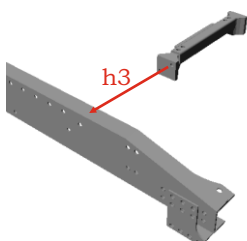

19.

Repeat steps  
3-17 for right  
side.

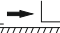
20. 

PE-part #15

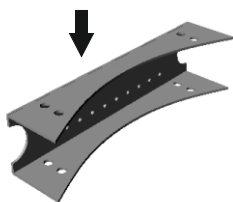

21. 

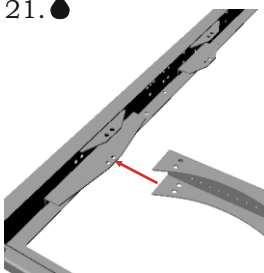

22. 

PE-part #17

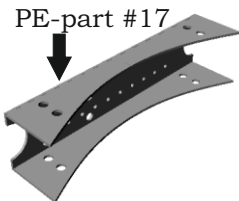

23. 

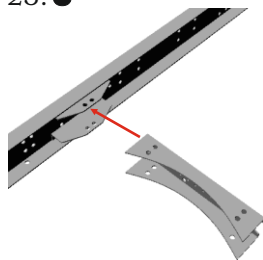

24. 

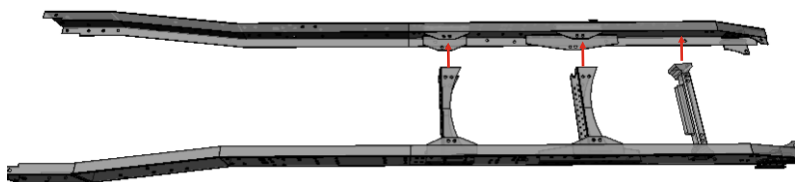

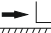
25. 

PE-part #21

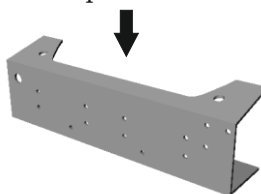

26. 

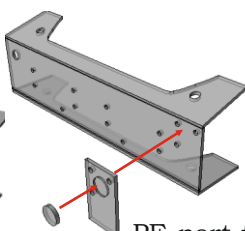

27. 

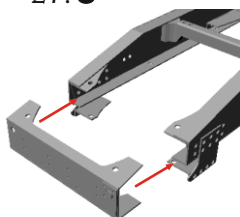

PE-part #22

PE-part #23

28. 

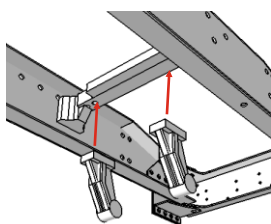

29. 

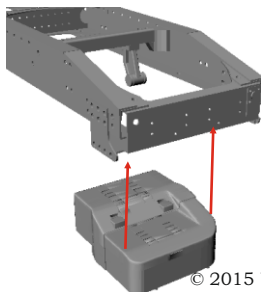

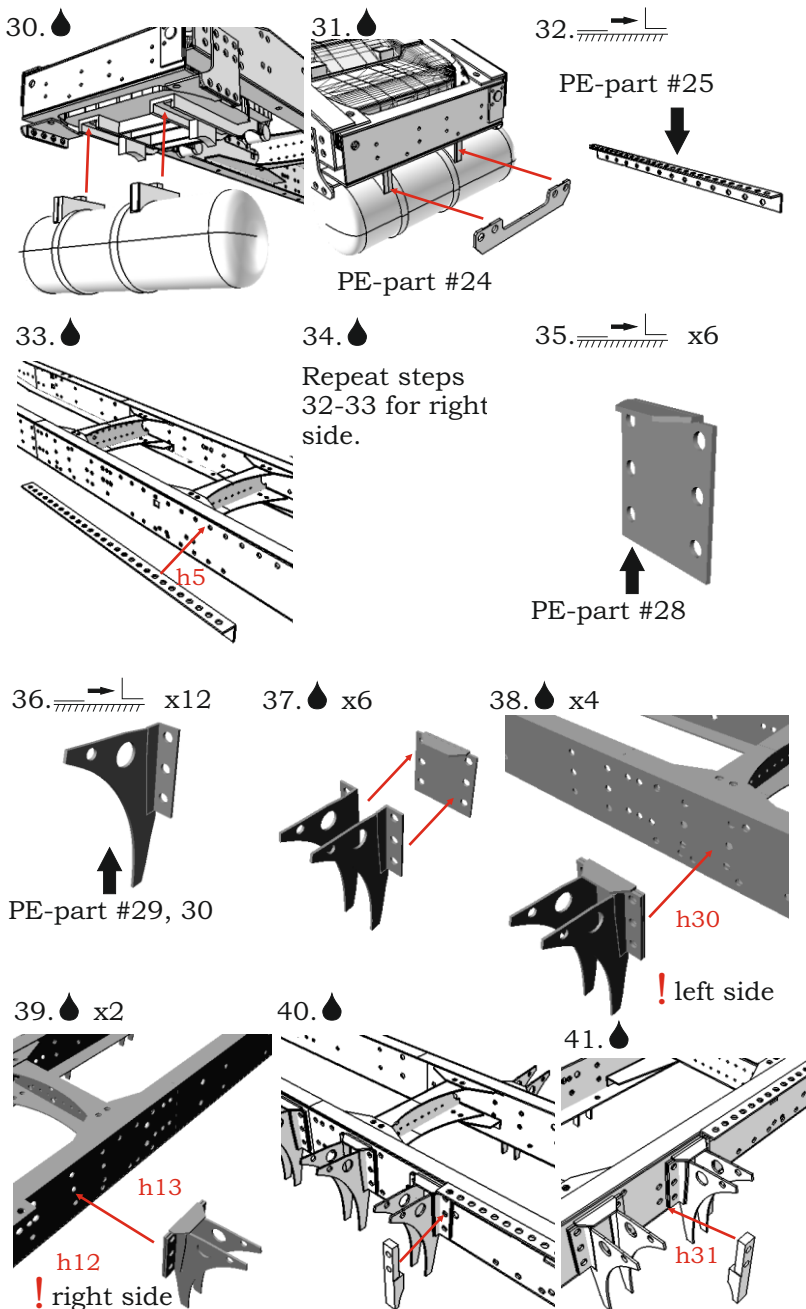

4x2 chassis for Swedish truck

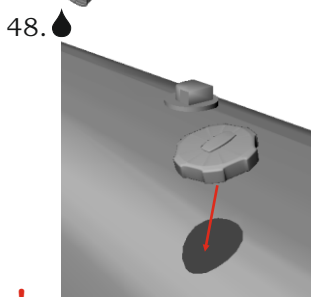
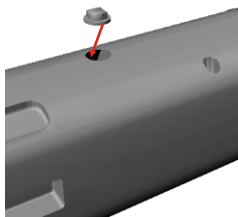
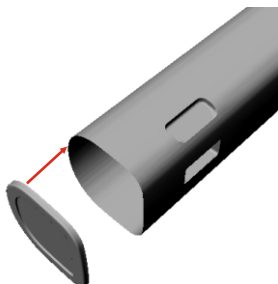
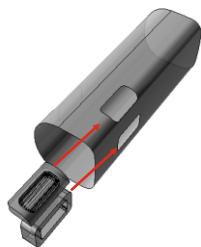
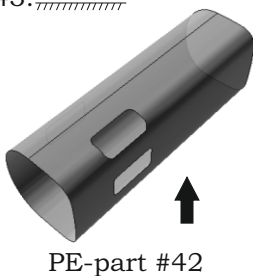
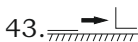
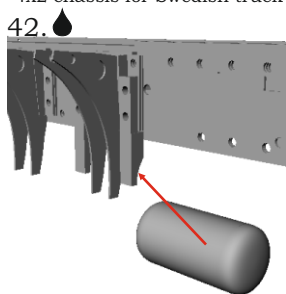

49.

Repeat steps  
43-48 for right  
fuel tank.



Please visit our site <http://an-modeltrucks.com> for  
detailed photo-instruction for fuel tanks.

“Instructions”section->How to make photo-etched fuel tank.  
Photo-instruction, or use this link:

<http://an-modeltrucks.com/how-to-make-photo-etched-fuel-tank-photo-instruction/>

Or use QR-code below:



4x2 chassis for Swedish truck

50. ● x2

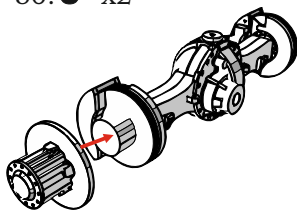

51. ● x4

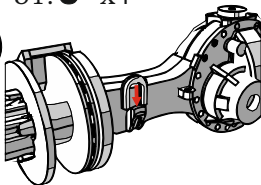

52. ● x2

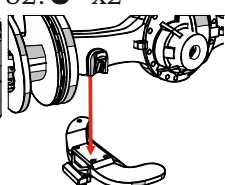

53. ● x2

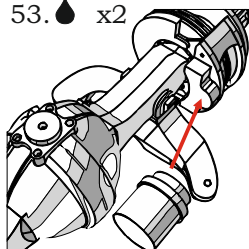

54. ● x2 bigger

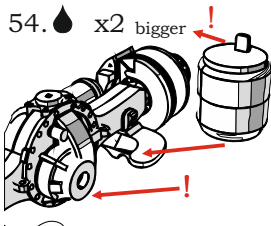

55. ● x2

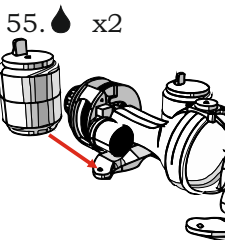

56. ● x2

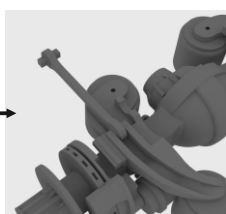
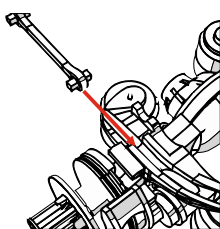

57. ● x2

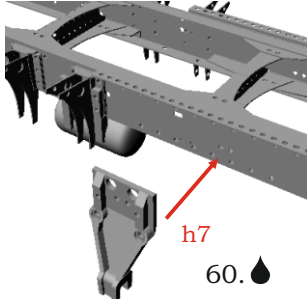

58. ●

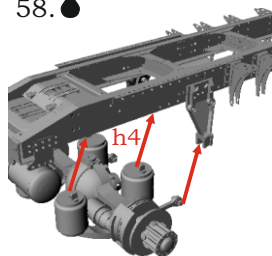

59. ●

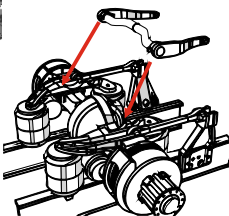

60. ●

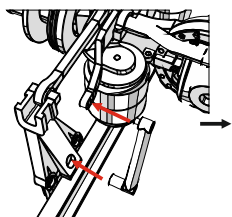

61. ● x2

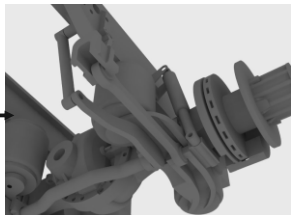
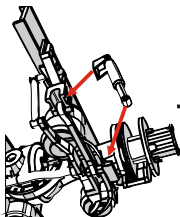

62. ●

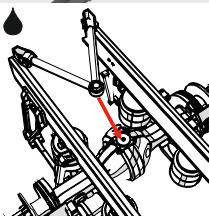

4x2 chassis for Swedish truck

63.  x6

64. 

65. 

PE-part #44

round profile

round profile

66. x5

67. 

68. 

Repeat steps  
64-65

69. 

70. 

71. 

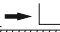
72. 

73. 

74.  ?

PE-part #27

h16

h17

h18



75. ●

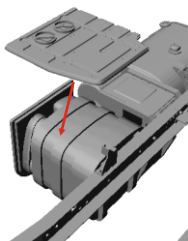

76. ●

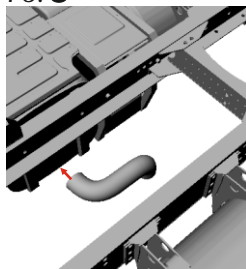

77. ● x2

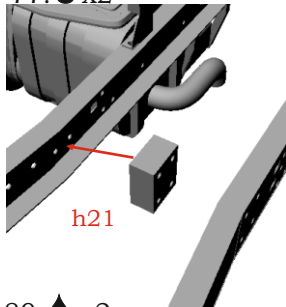

78. ●

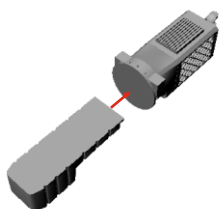

79. ●

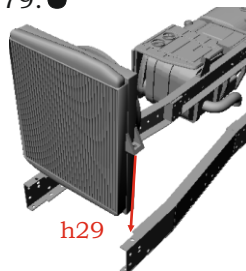

80. ● x2

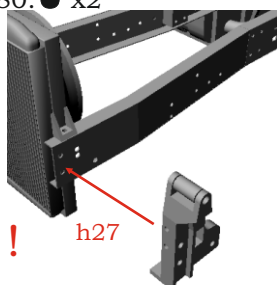

81. ●

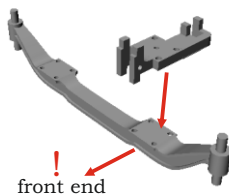

82. ●

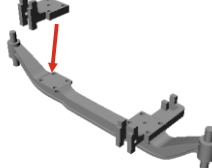

This part is from our  
"Swedish truck (Euro6)  
kit!"

83. ●

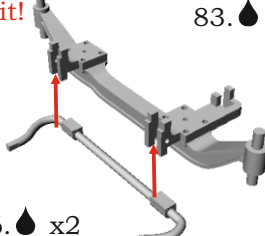

84. ● x2

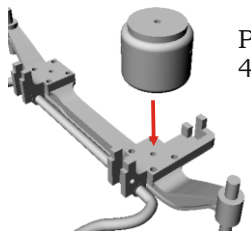

85. → x2

PE-parts #41R,  
41L



86. ● x2

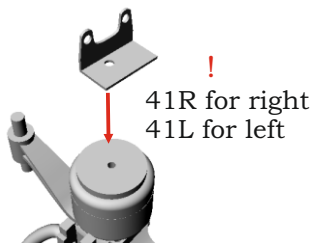

87. ●

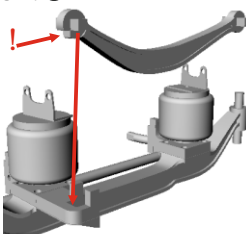

88. ● x2

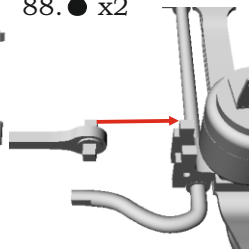

89. ● x2

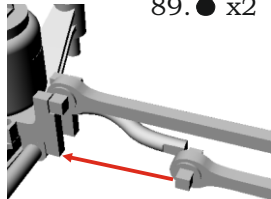

4x2 chassis for Swedish truck

90.  x2

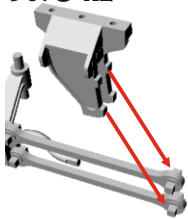

91. 

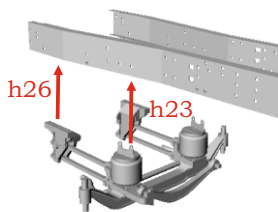

92. 

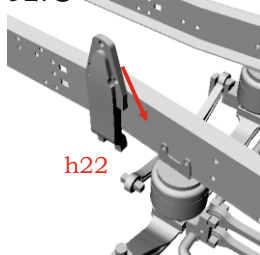

93.  x2

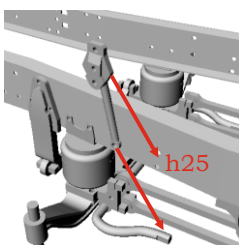

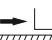
94.  x2

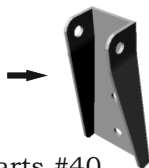

PE-parts #40

95. 

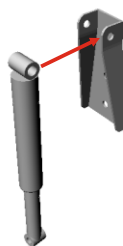

96.  x2

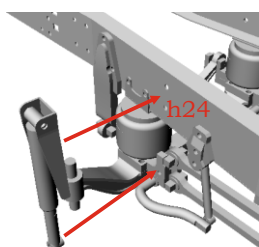

97. 



98. 

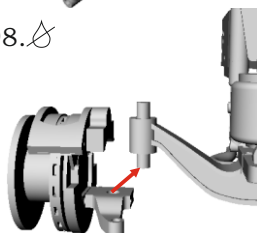

99.  x2

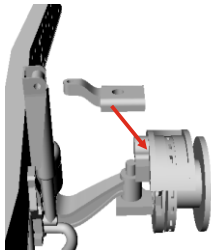

100. 

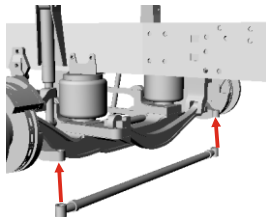

101. 

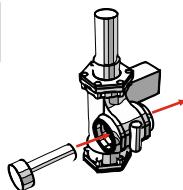

102. 

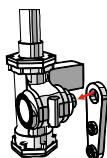

103. 

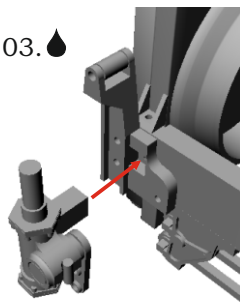

104. 

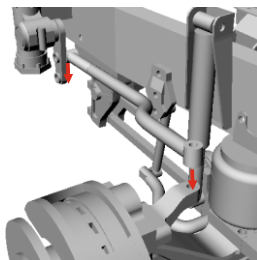

4x2 chassis for Swedish truck

105. 

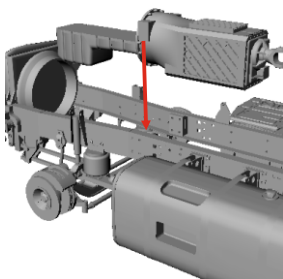

106. 

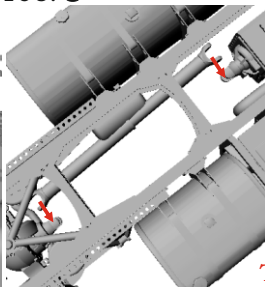

107.  x2

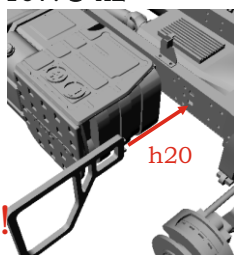

This part is from our  
“Swedish truck (Euro6)  
kit!

108. 

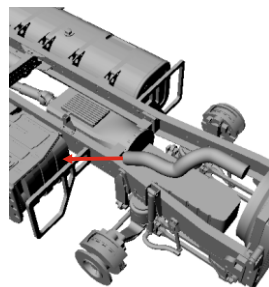

109. 

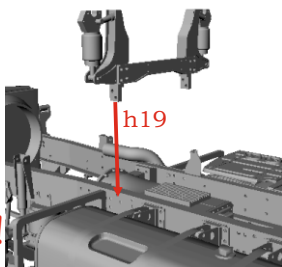

This part is from our  
“Swedish truck (Euro6)  
kit!

110. 

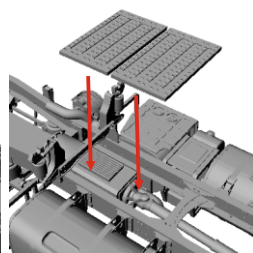

111. 



112. 

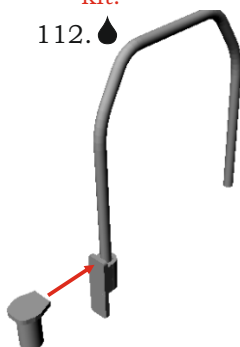

113. 

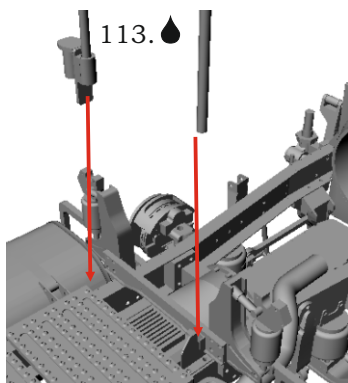

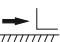
114. 

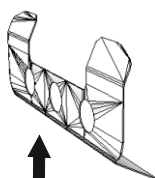

PE-part #35

115. 

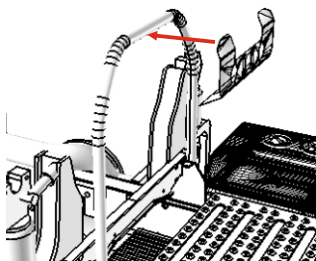

4x2 chassis for Swedish truck

116. 

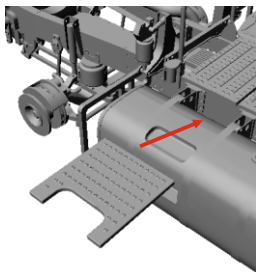

117.  x2

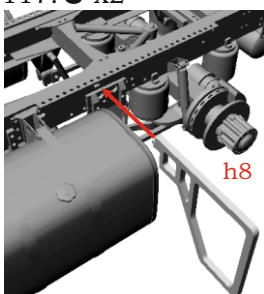

118.  x2

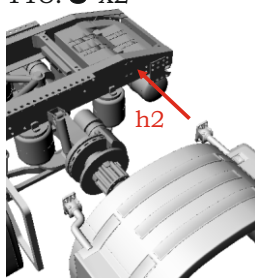

! These parts are from our “Swedish truck (Euro6) kit!

119.  x2

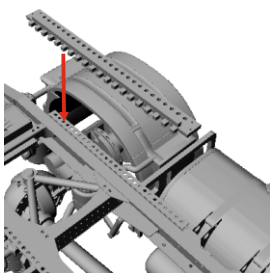

120.  x2

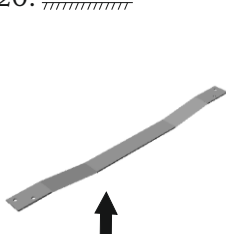

PE-parts #37, 38

121.  x2

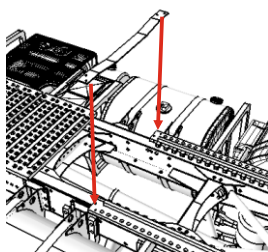

122. 

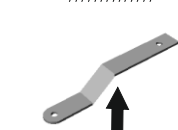

PE-part #31

123. 

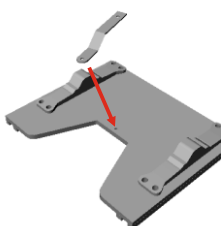

124. 

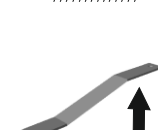

PE-part #32

125.  x2



PE-parts  
#36, #39

126. 

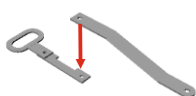

127. 

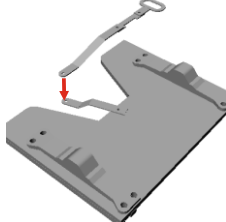

128. 

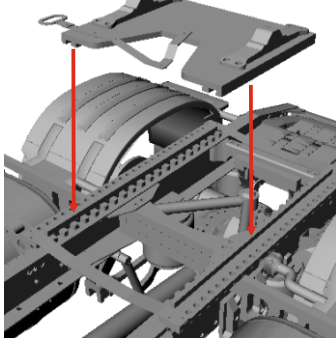

129. 

PE-part #33

PE-part #34

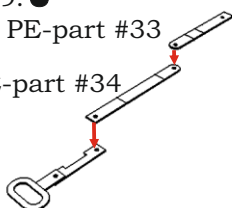

4x2 chassis for Swedish truck

130. 



131. 

