

Red American engine X15

Resin kit, 1/24

© 2017 by A&N Model Trucks

Red American engine X15

Highest detailed replica of most popular North American red engine X15. Suits for all modern American and Australian trucks. Perfect fits to Italeri's American generic chassis. 3D printed master patterns with many small details.

Warning!

This kit for advanced modellers only!

Contains many small parts, not suitable for children!

Please read this instruction carefully and follow it during assembling.

Reference pictures are available at the our site - <http://an-modeltrucks.com/shop/red-american-engine-x15/>

Red American engine X15

1. 

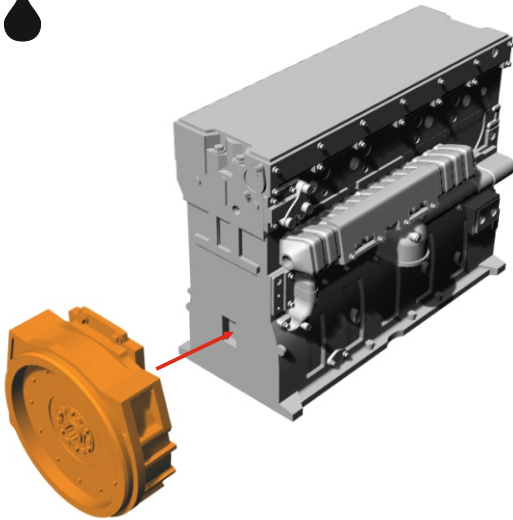

2. 

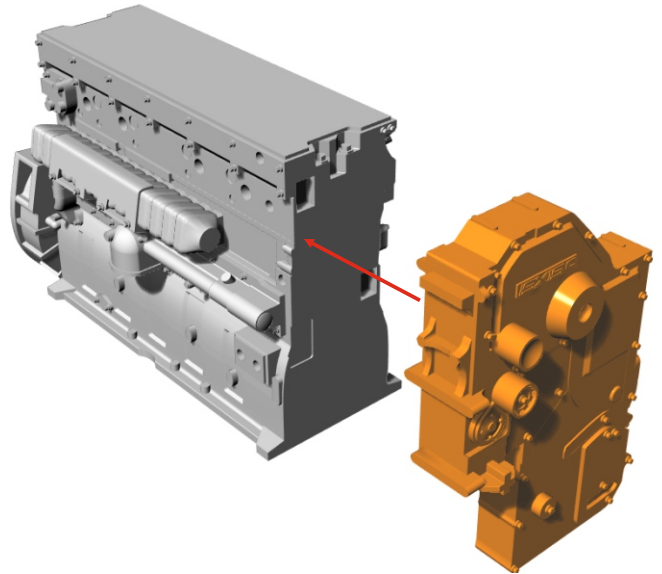

3. 

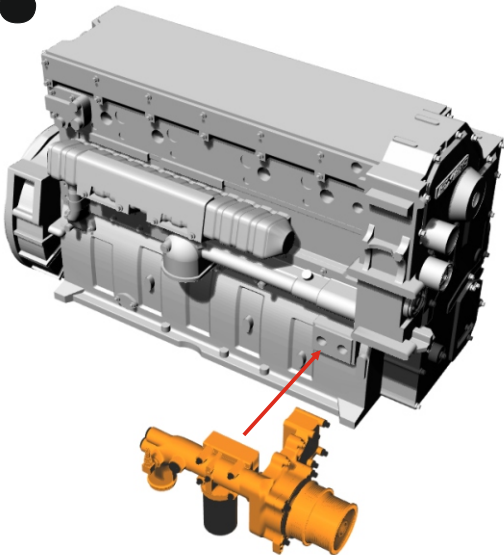

4. 

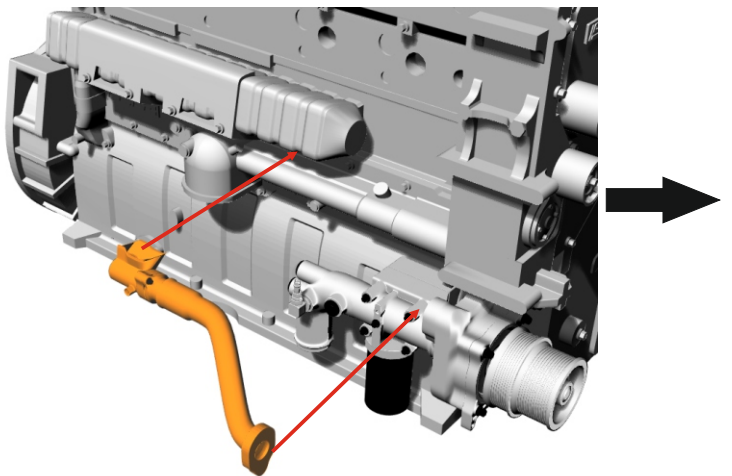

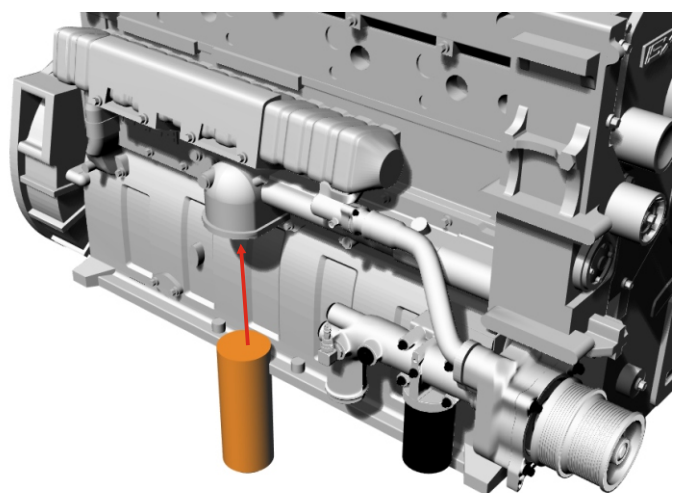
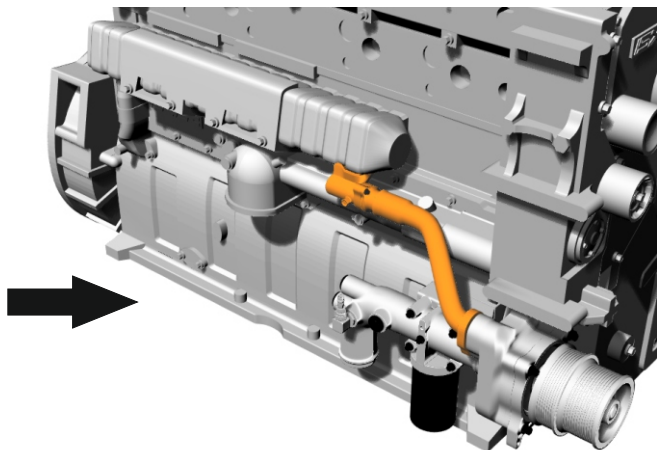

5. 

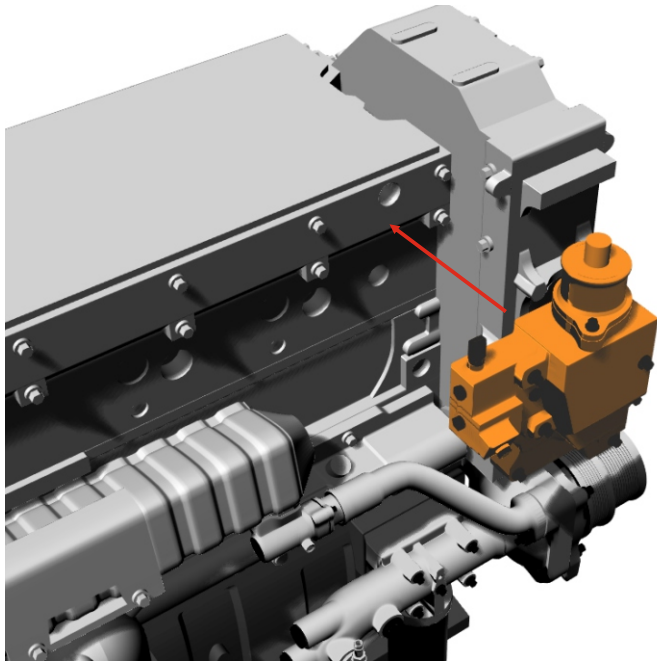

Red American engine X15

6. 



7. 

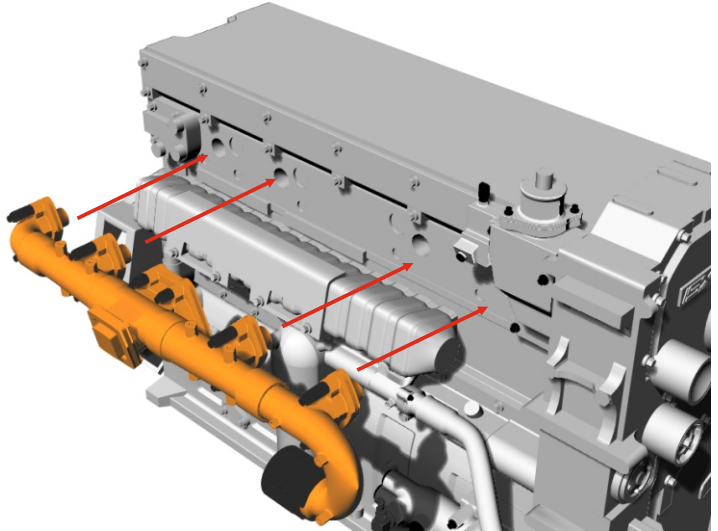

8. 

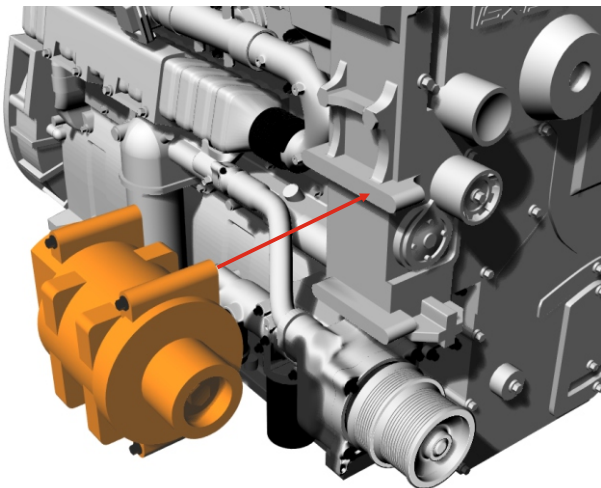

9. 

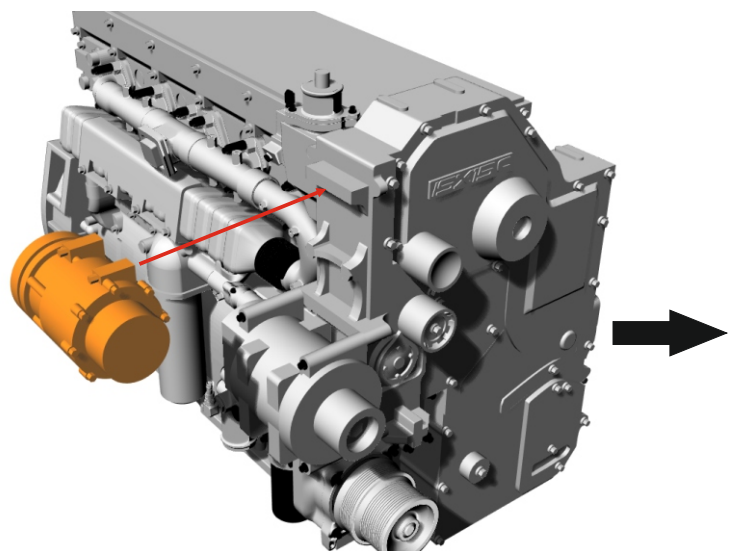

10. 

Use black isolating tape
for belts imitation.
Width of belt - 1.5 mm

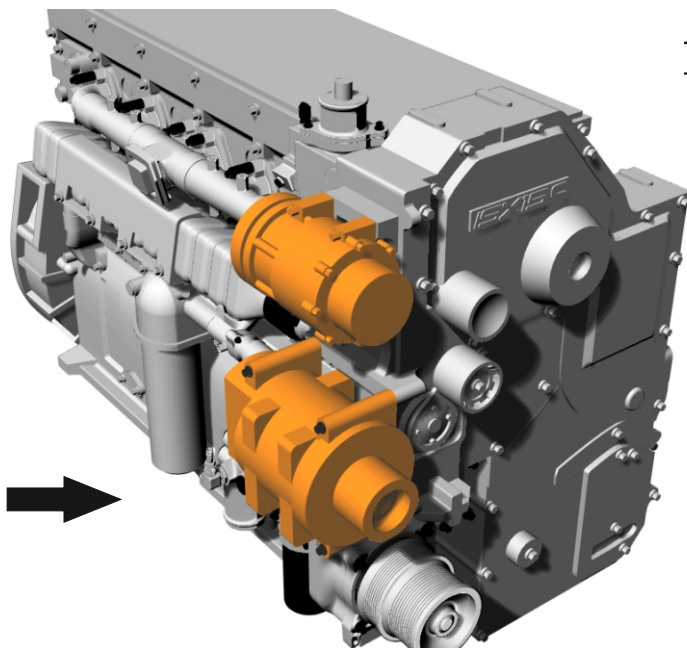

Red American engine X15



11.

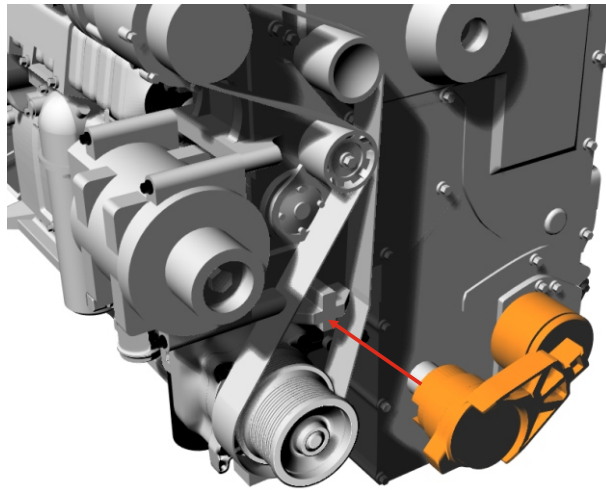

12.

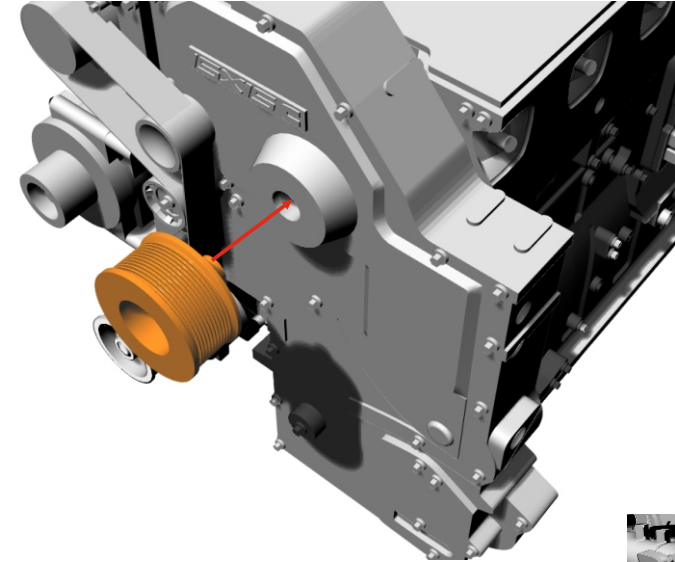

13.

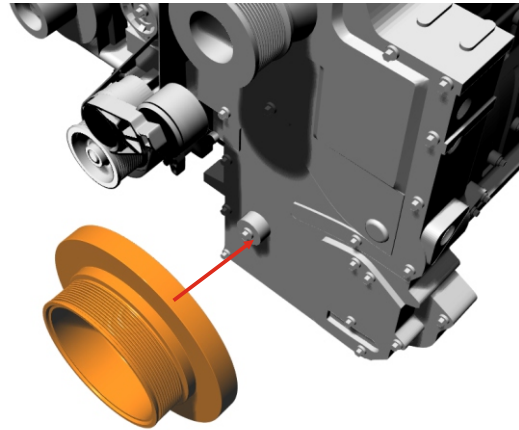

14.

Use black isolating tape
for belts imitation.
Width of belt - 1.5 mm

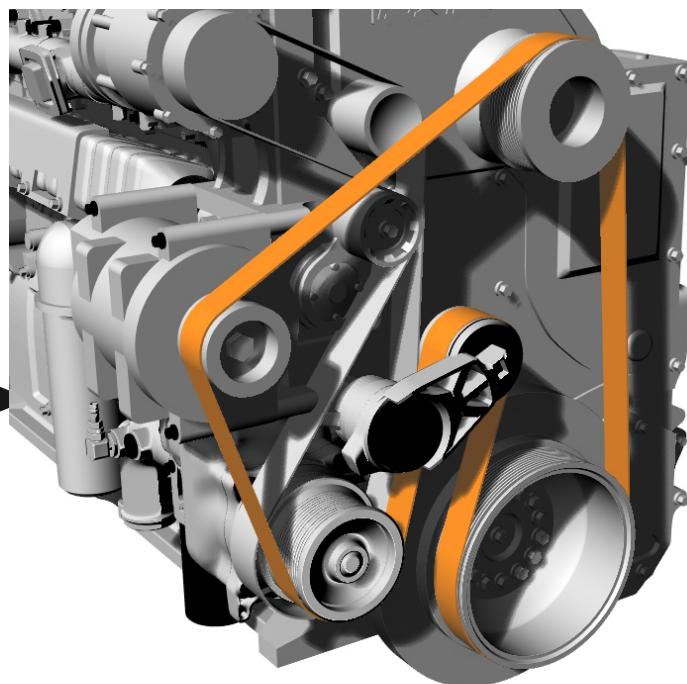

Red American engine X15

15. 🖤

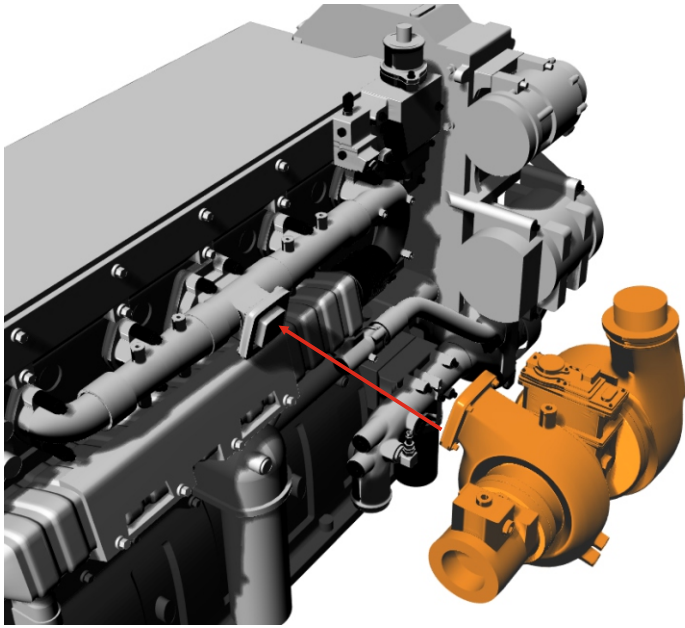

16. 🖤

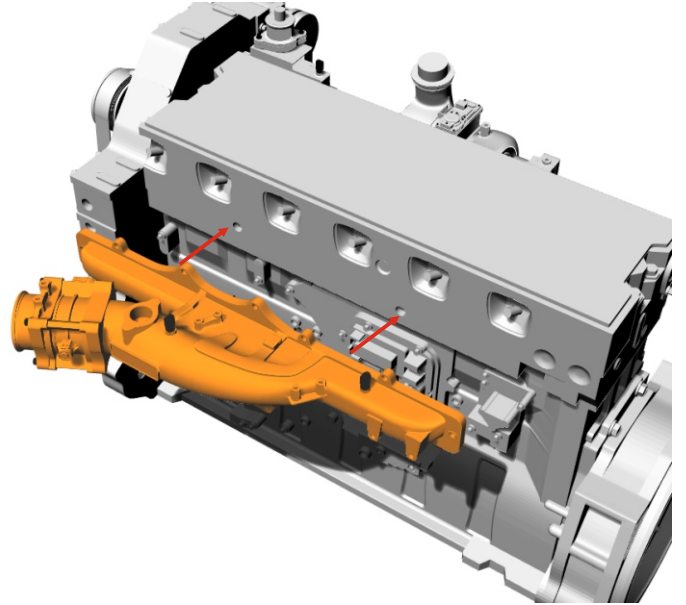

17. 🖤

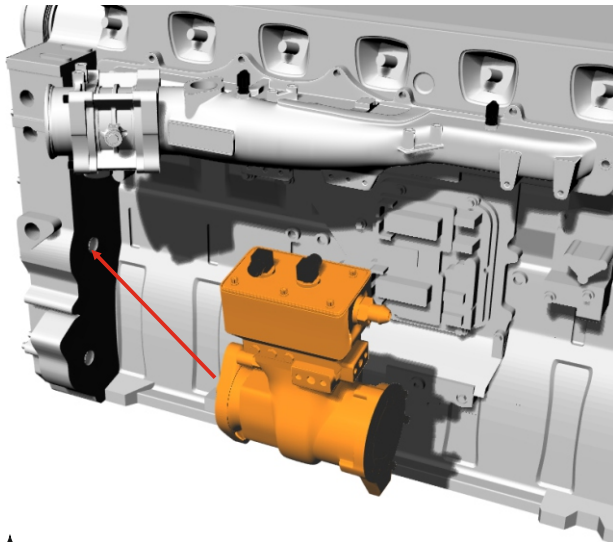

18. 🖤

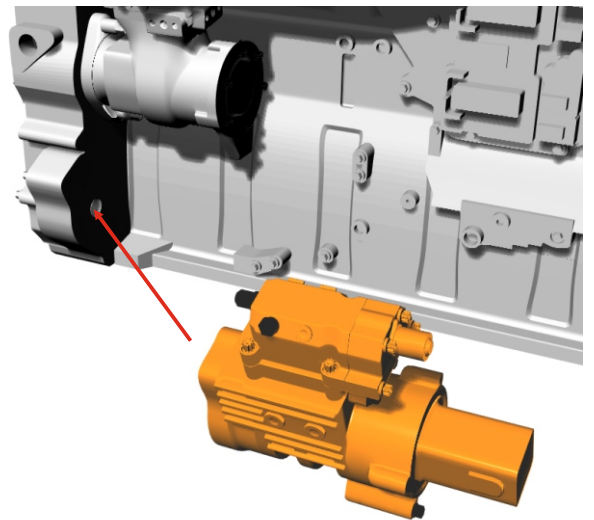

19. 🖤

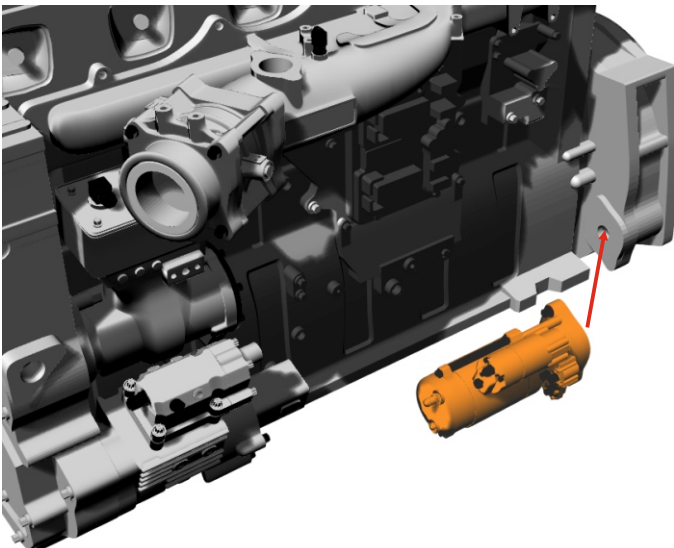

20. 🖤

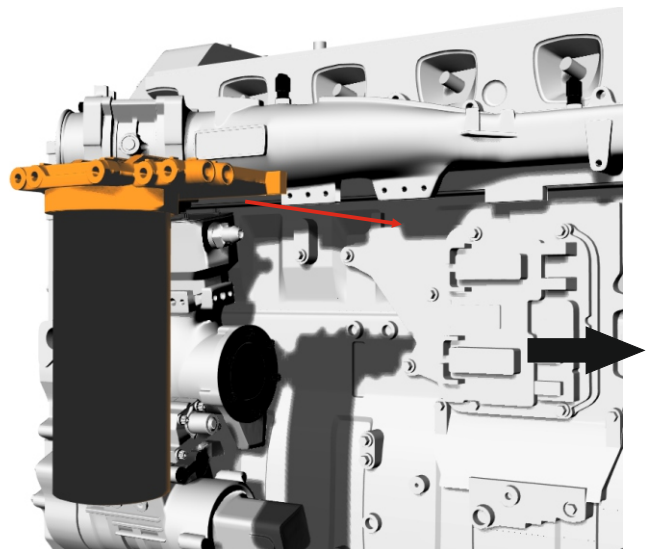

Red American engine X15

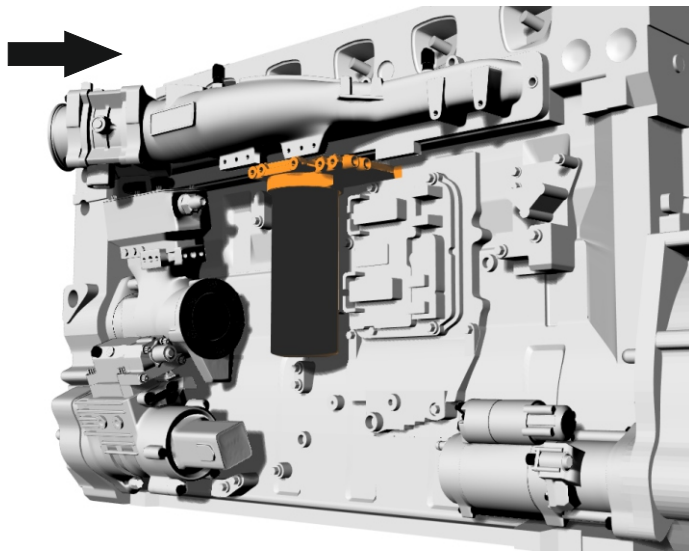

21.  x2

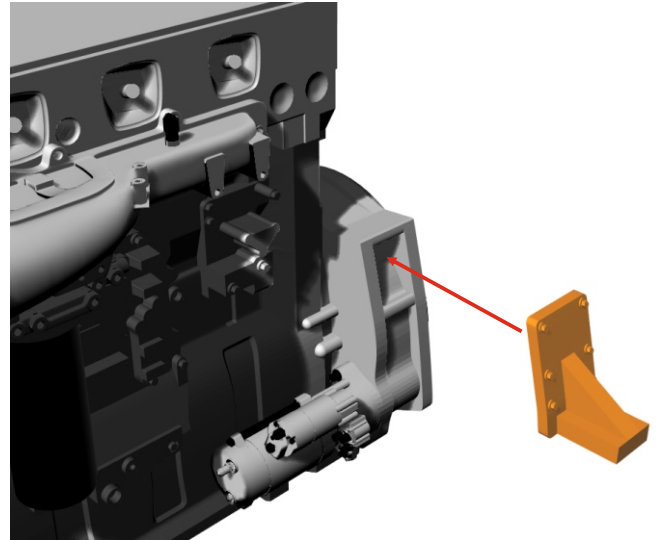

22. 

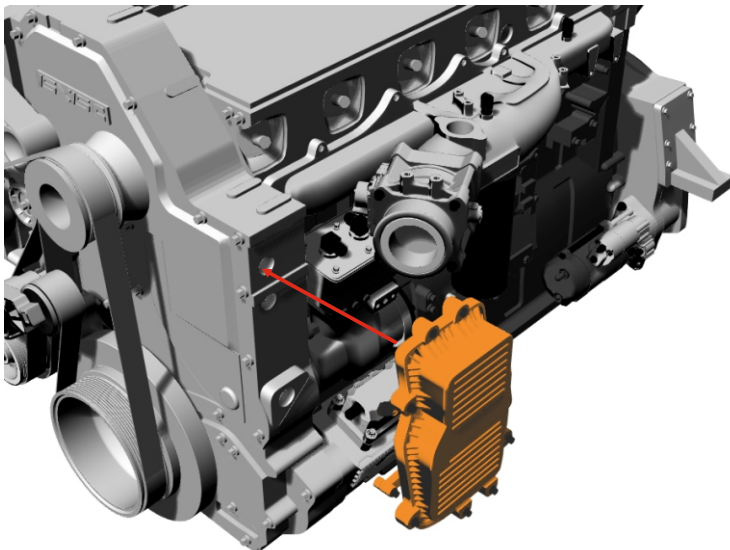

23. 

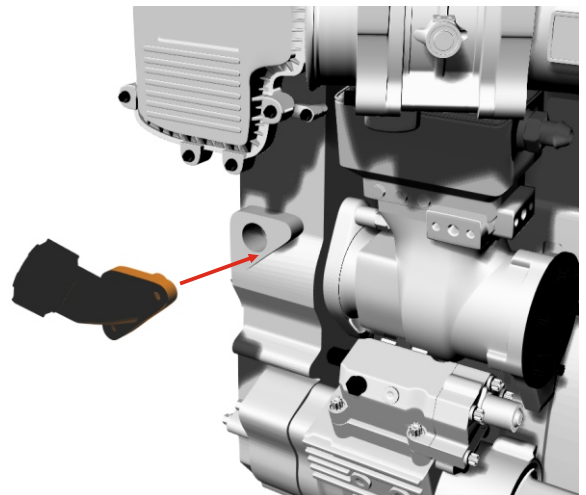

24. 

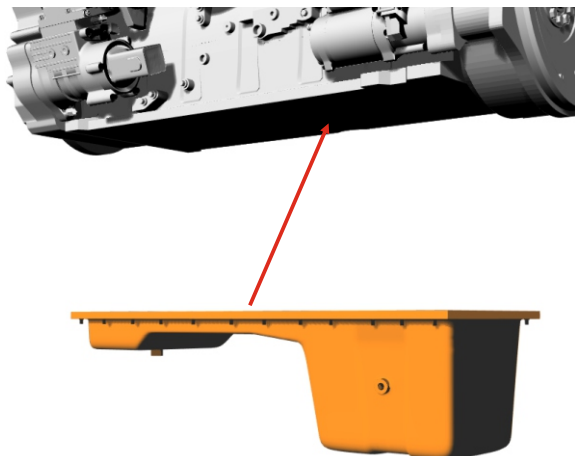

25. 

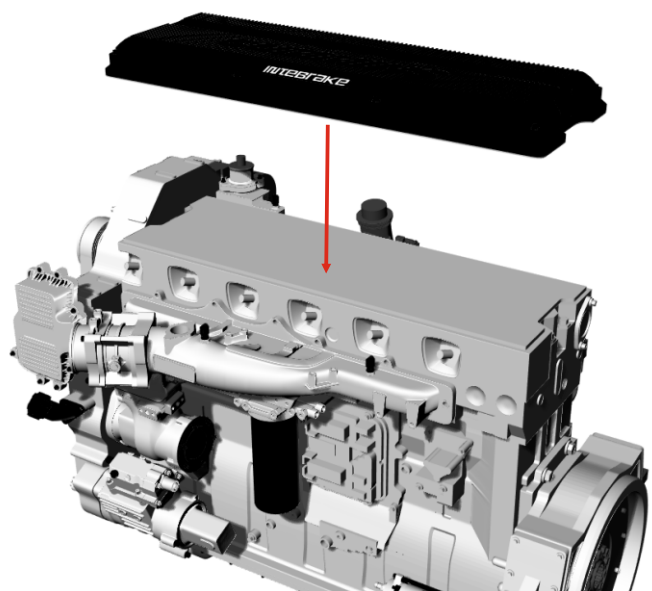

Red American engine X15

26. 

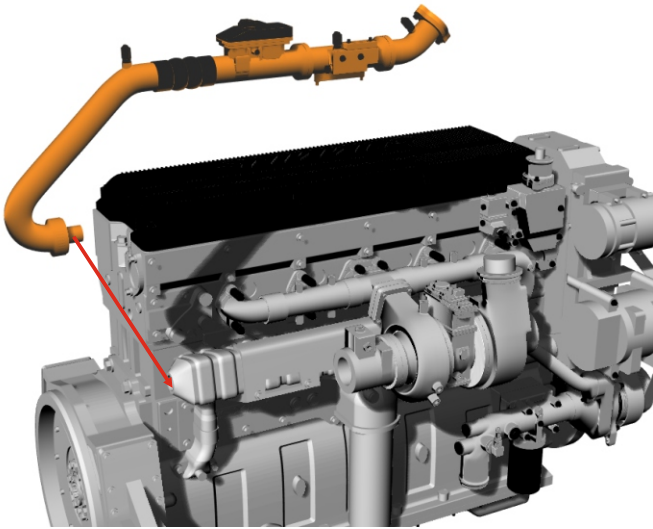

27. 

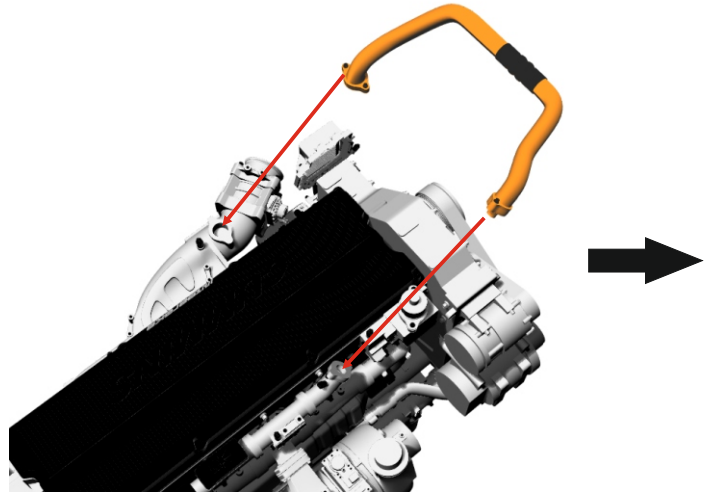

28. 

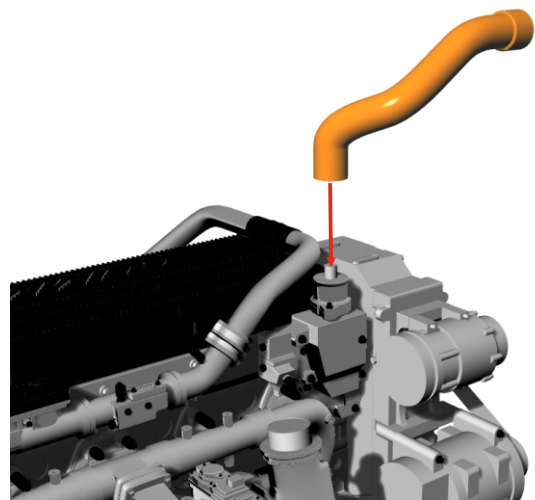
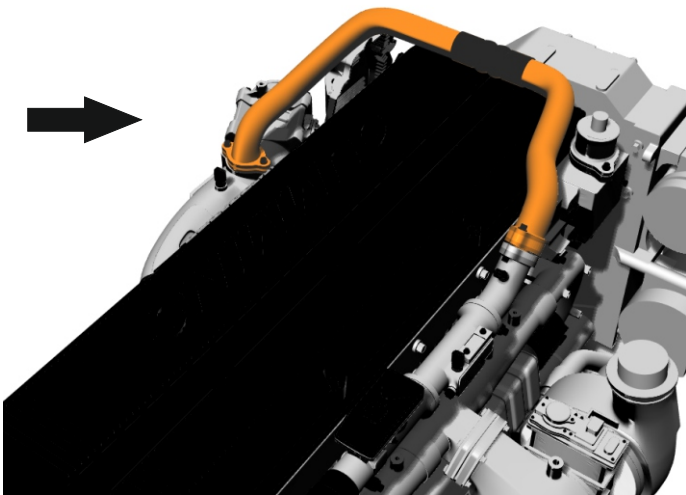

29. 

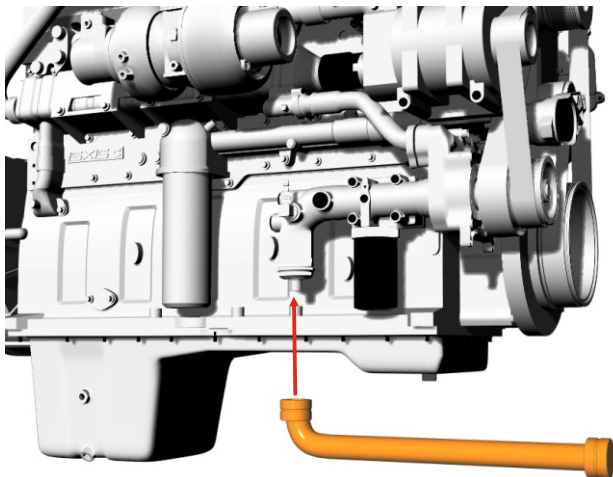

30. 

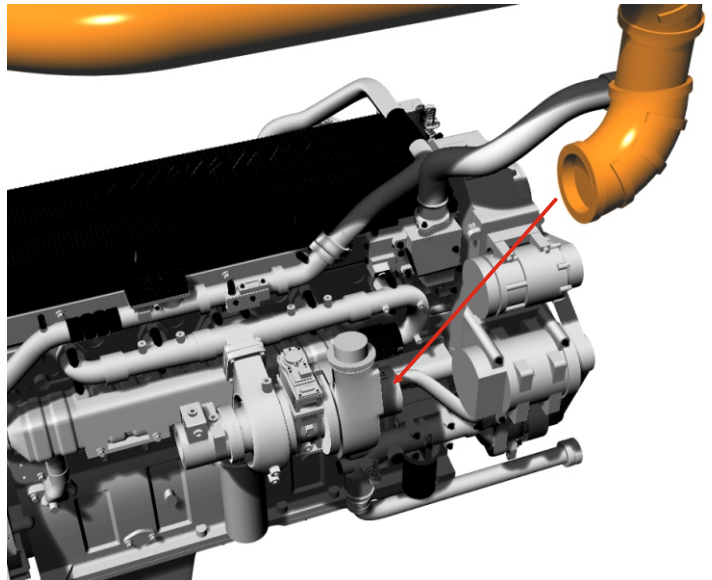

Red American engine X15

31. 

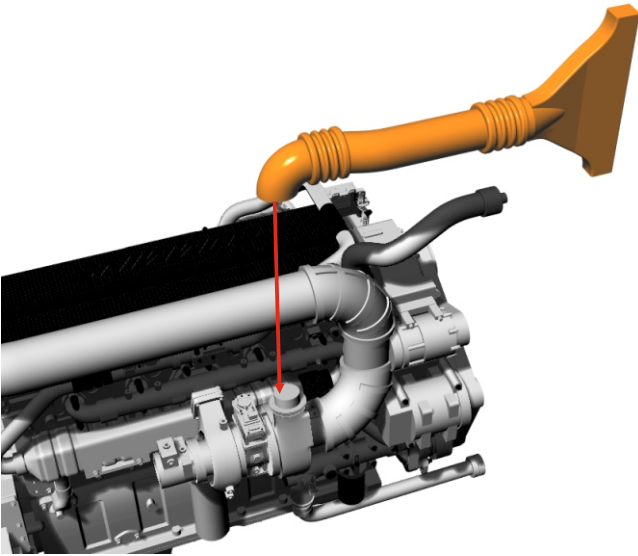

32. 

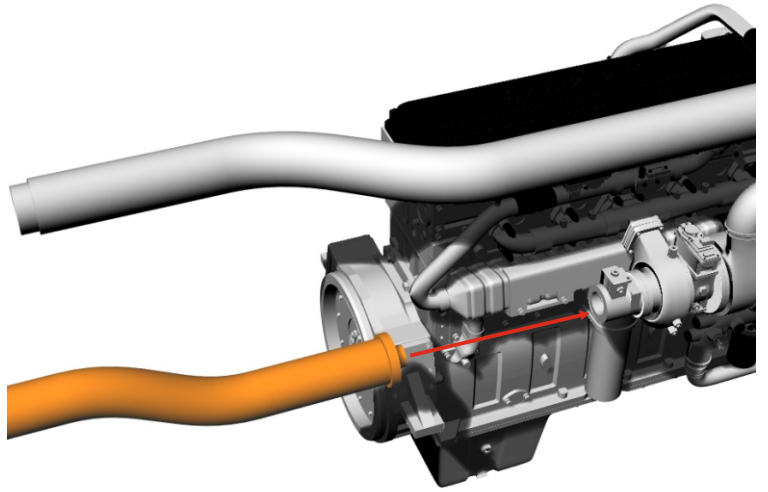

33. 

