

6x2/4 tag chassis
for Swedish truck

Scale 1/24

Warning!

Please follow this instruction while assembling, otherwise you could face problems with assembling the model.

Photo-etched parts have sharp edges, please be careful.

This model kit contains small parts and is not suitable for children.

For building this model some modelling skills are required.

Symbols:

● - glue parts;

⌀ - do not glue parts;

→└ - bend parts;

! - attention;

↔ - moving parts;

? - your choice;

h# - frame rails holes' numbers;

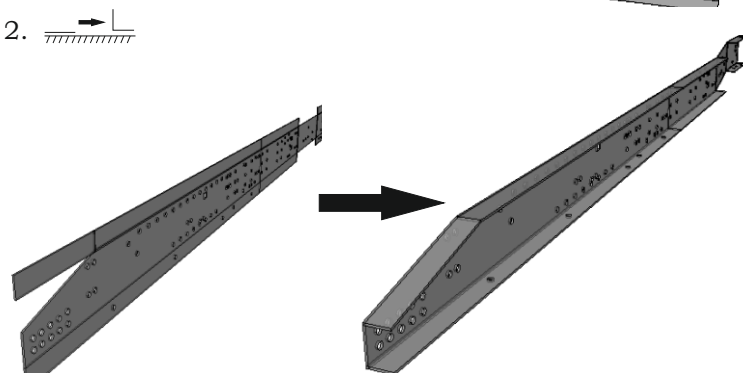
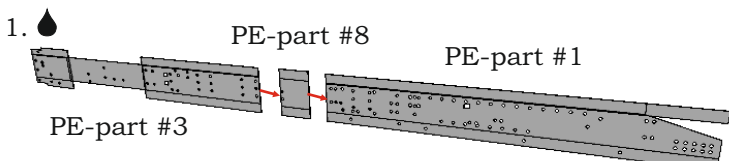

6x2/4 tag chassis for Swedish truck

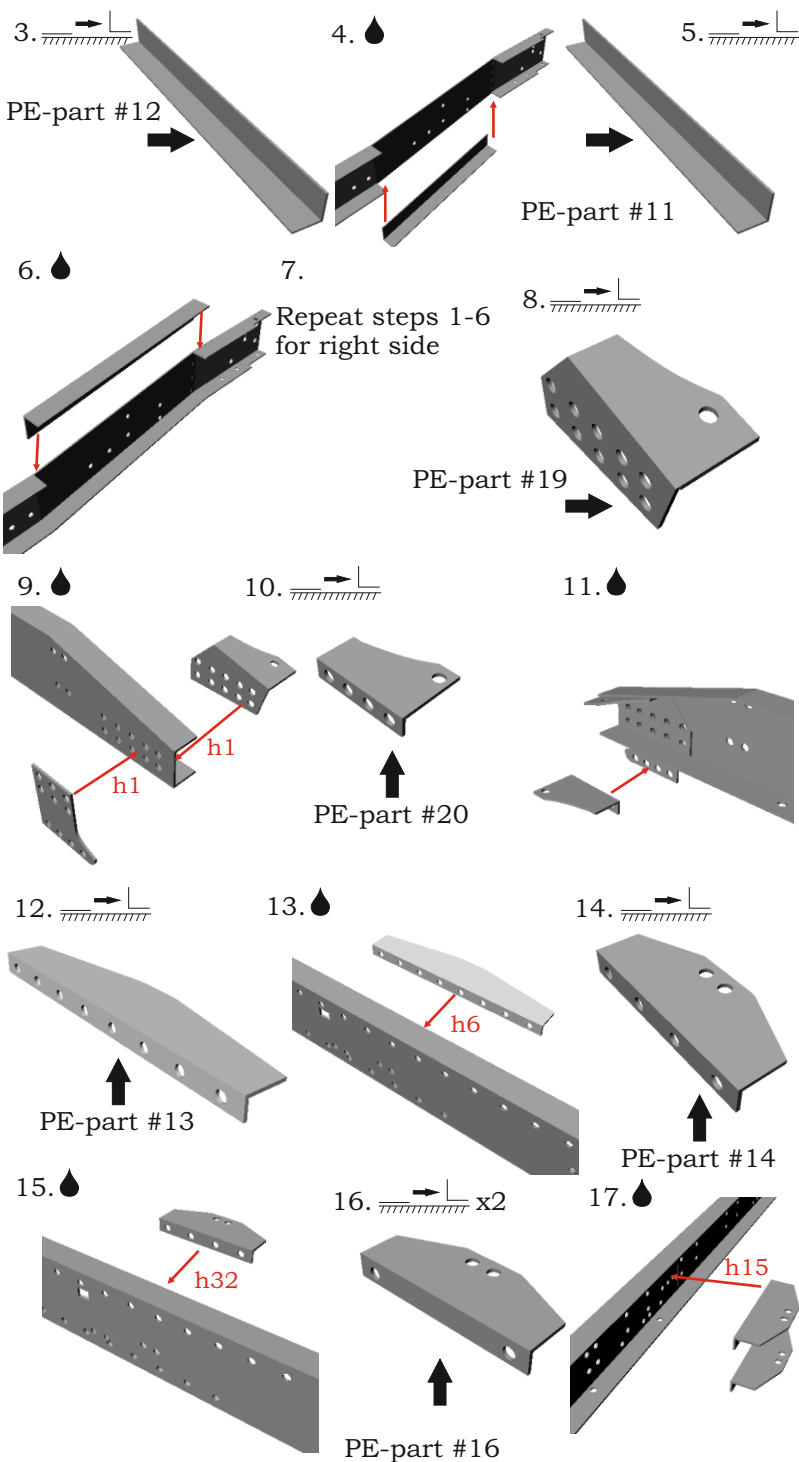

6x2/4 tag chassis for Swedish truck

18.

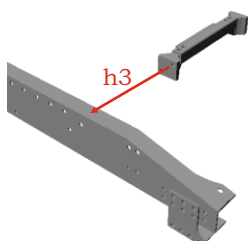

19.

Repeat steps
3-17 for right
side.

20.

PE-part #15

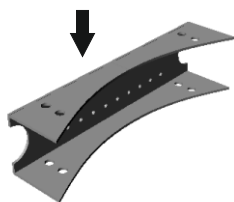

21.

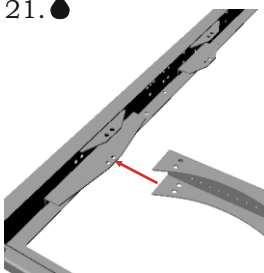

22.

PE-part #17

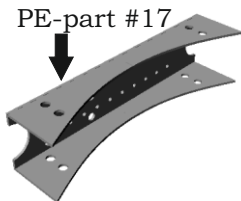

23.

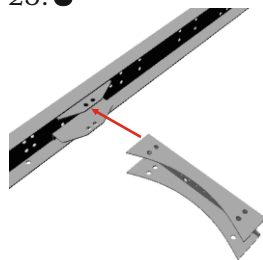

24.

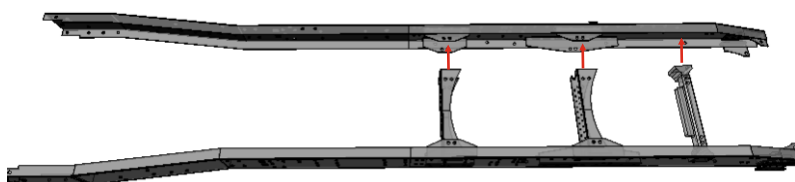

25.

PE-part #21

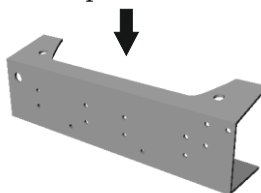

26.

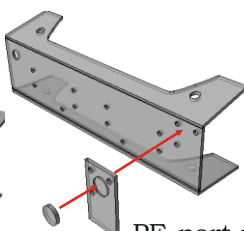

27.

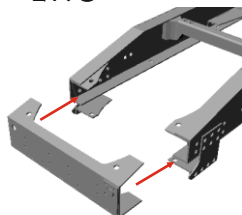

28.

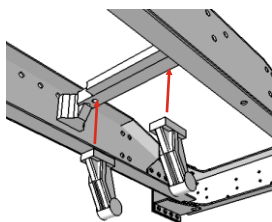

PE-part #23

PE-part #22

29.

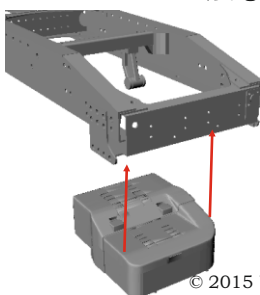

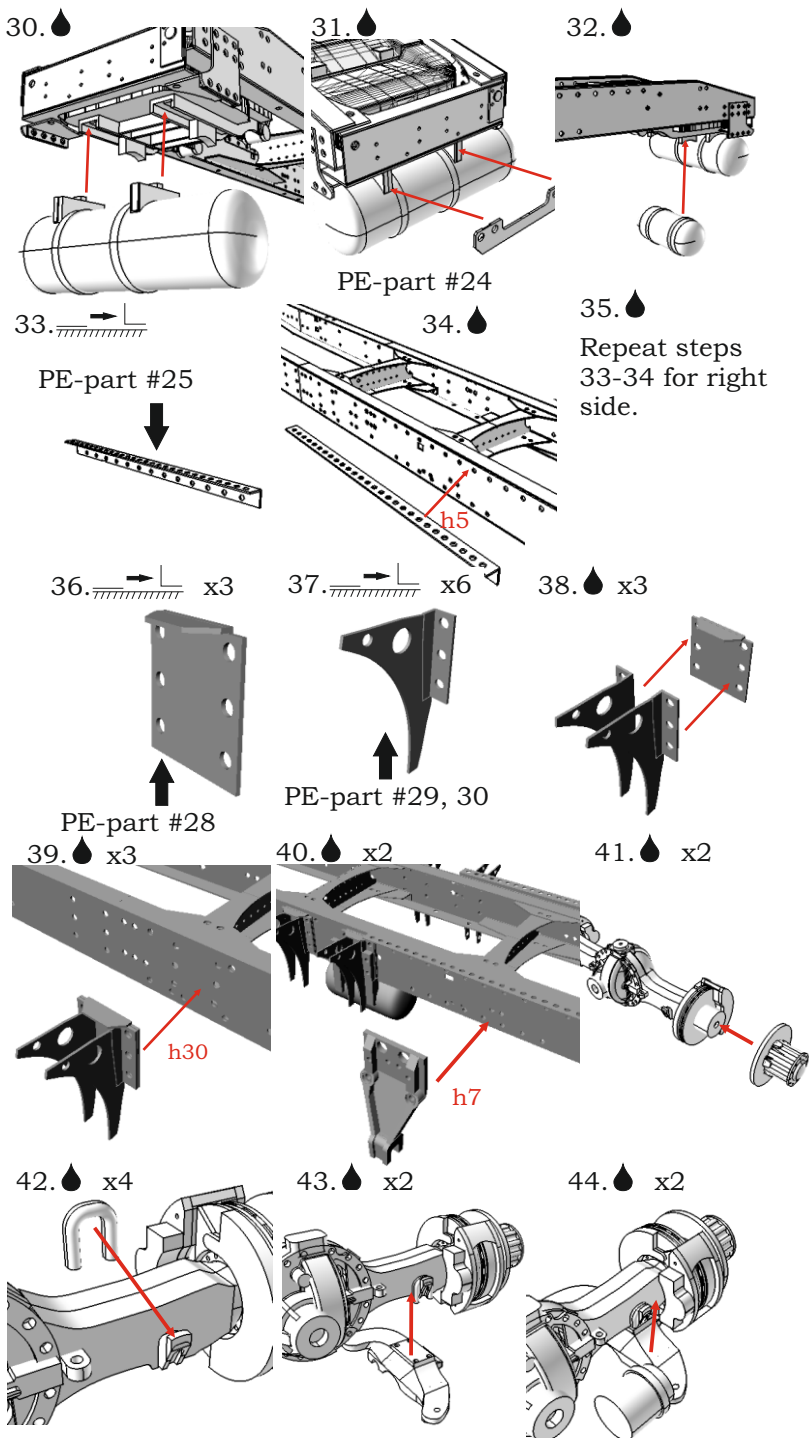

45.  x2

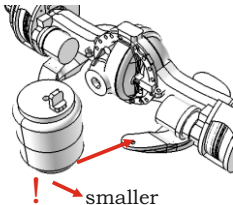

46.  x2

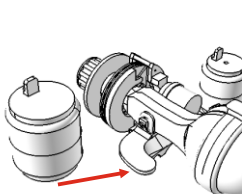

47.  x2

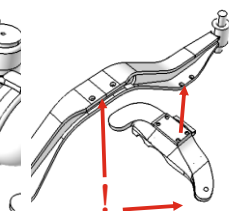

48.  x2

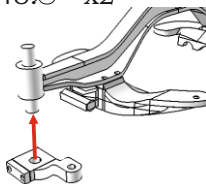

49.  x2

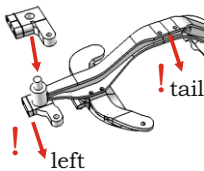

50.  x2

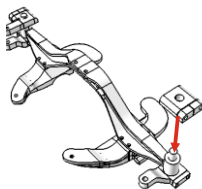

51.  x2

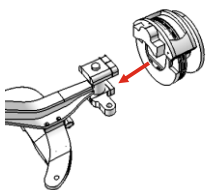

52.  x2

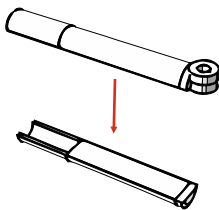

53. 

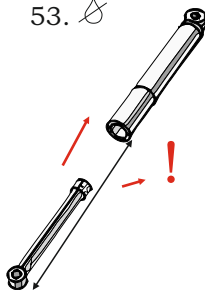

54. 

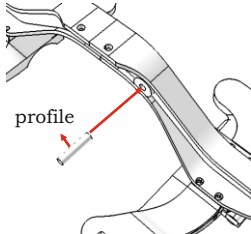

55. 

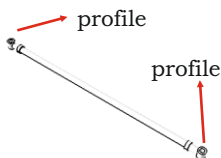

56. 

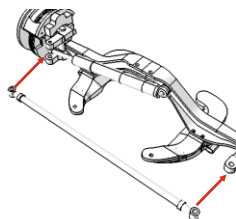

57.  x2

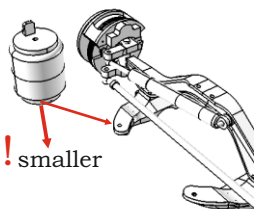

58.  x2

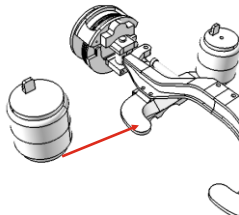

59.  x2

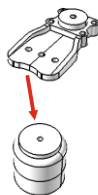

6x2/4 tag chassis for Swedish truck

60. 

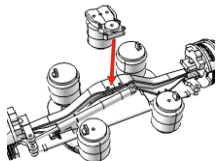

61. 

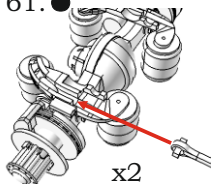

x2



62. 

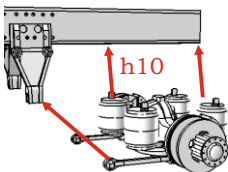

h10

63.  x2

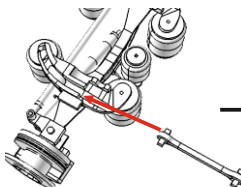

64. 

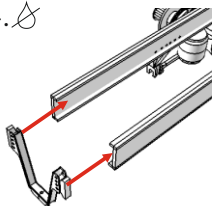

65. 

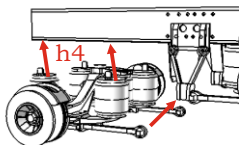

h4

66. 

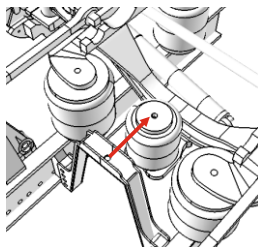

67. 

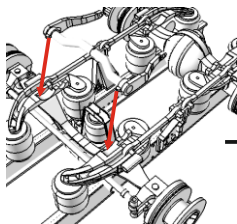

68.  x4

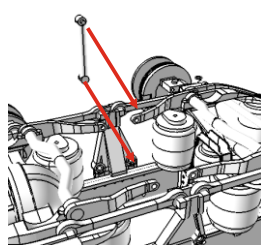

69.  x4

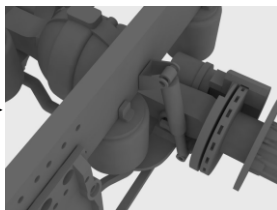
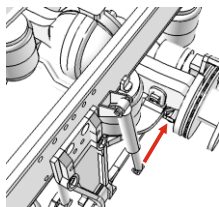

70.  x2

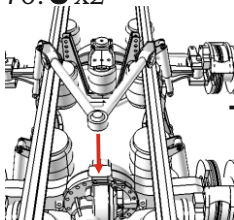

6x2/4 tag chassis for Swedish truck

71.

72.

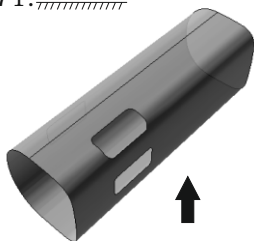

PE-part #46

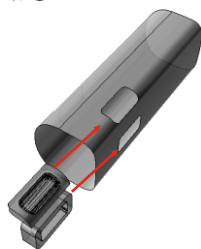

73. x4

74. x2

75.

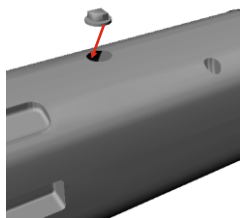
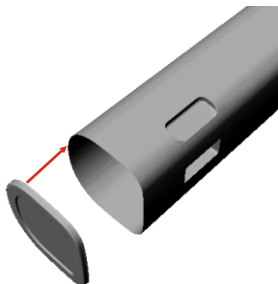

76.

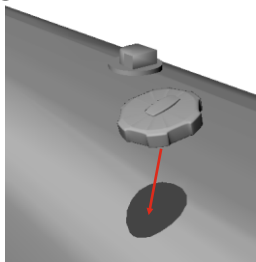

!

Please visit our site <http://an-modeltrucks.com> for detailed photo-instruction for fuel tanks.



“Instructions”section->How to make photo-etched fuel tank.
Photo-instruction, or use this link:

<http://an-modeltrucks.com/how-to-make-photo-etched-fuel-tank-photo-instruction/>

Or use QR-code below:



6x2/4 tag chassis for Swedish truck

77.  x3 78. 



PE-part #44

round profile

79. 

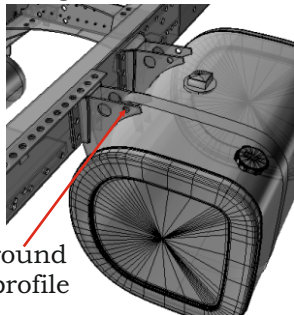

round profile

80. x2

81. 

82. 

Repeat steps
78-79

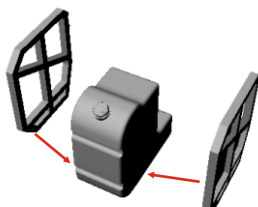
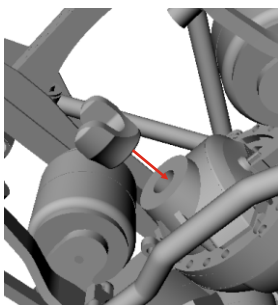

83. 

84. 

85. 

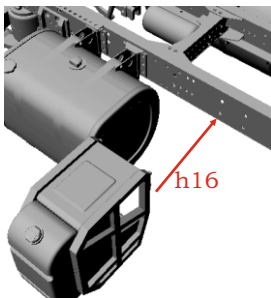
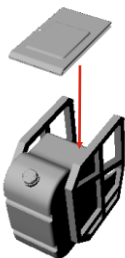

h16

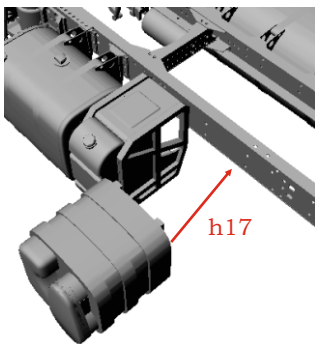

h17

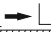
86. 

87. 

88.  ?



PE-part #27

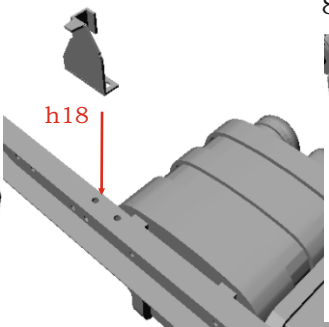

h18

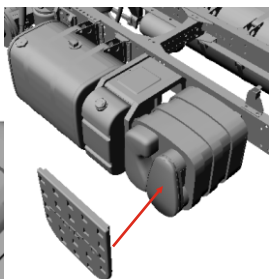

6x2/4 tag chassis for Swedish truck

89.

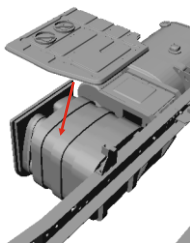

90.

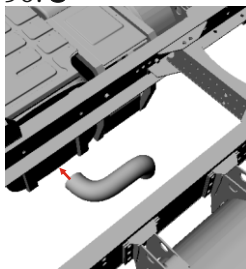

91. x2

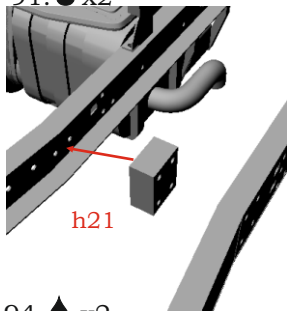

92.

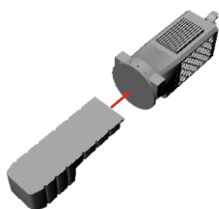

93.

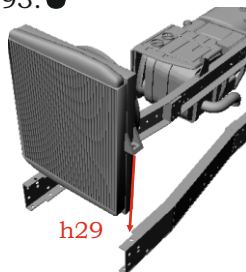

94. x2

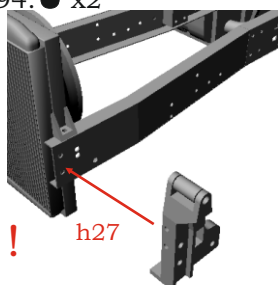

This part is from our
"Swedish truck (Euro6)
kit!"

97.

95.

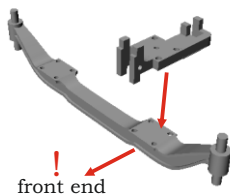

96.

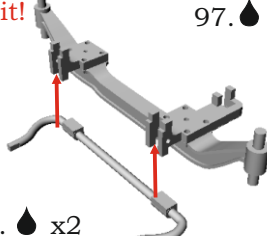
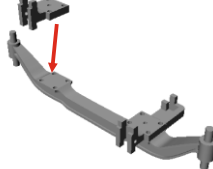

98. x2

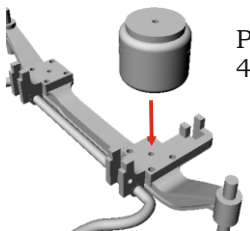

99. x2

PE-parts #41R,
41L



100. x2

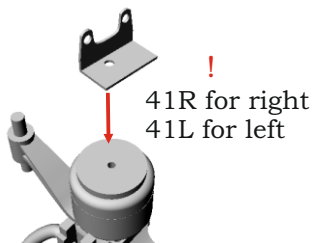

41R for right
41L for left

101.

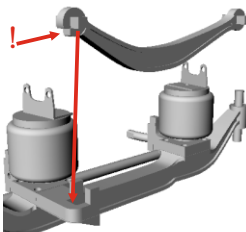

102. x2

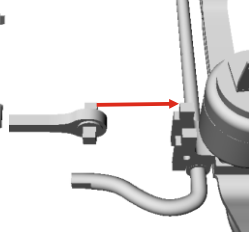

103. x2

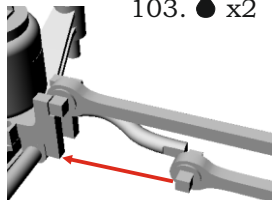

6x2/4 tag chassis for Swedish truck

104.  x2

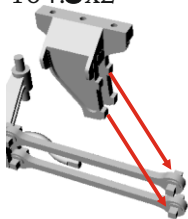

105. 

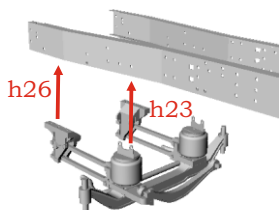

106. 

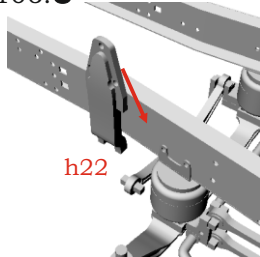

107.  x2

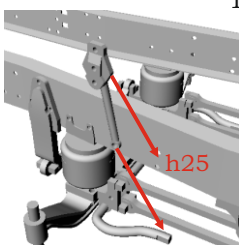

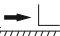
108.  x2

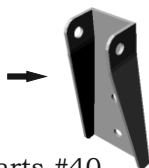

PE-parts #40

109. 

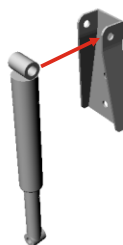

110.  x2

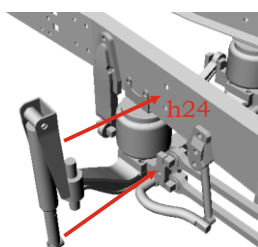

111. 



112. 

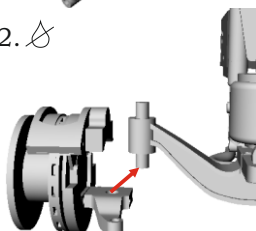

113.  x2

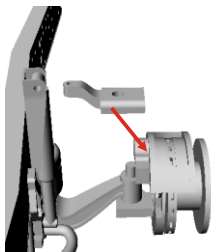

114. 

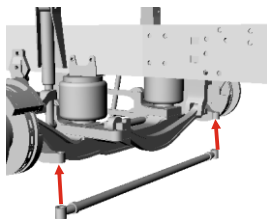

115. 

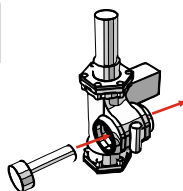

116. 

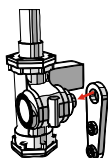

117. 

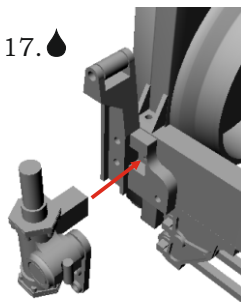

118. 

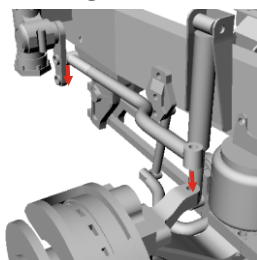

6x2/4 tag chassis for Swedish truck

119. 

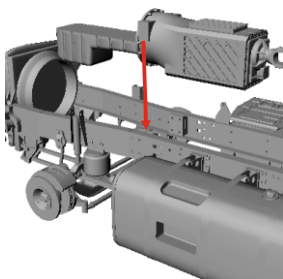

120. 

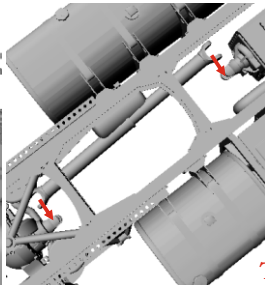

121.  x2

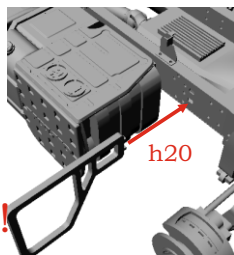

This part is from our
“Swedish truck (Euro6)
kit!

122. 

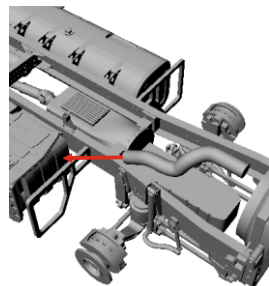

123. 

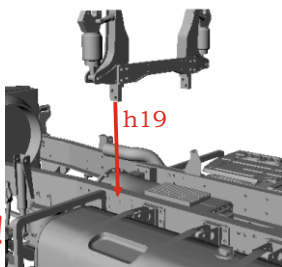

This part is from our
“Swedish truck (Euro6)
kit!

124. 

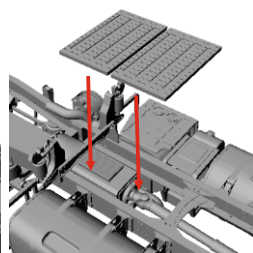

125. 



126. 

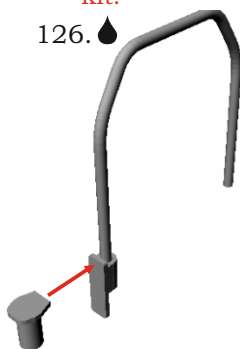

127. 

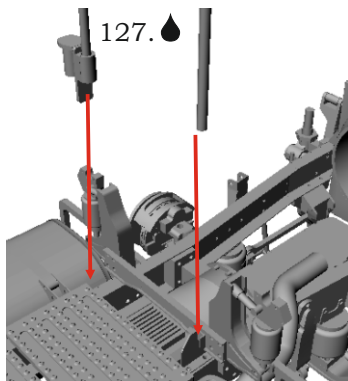

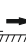
128. 

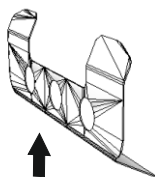

PE-part #35

129. 

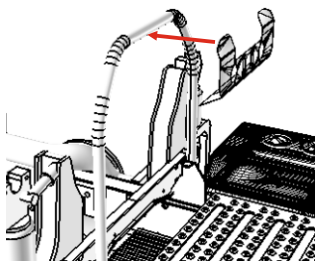

6x2/4 tag chassis for Swedish truck

130. 

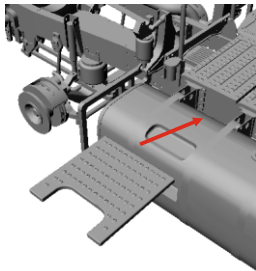

131.  x2

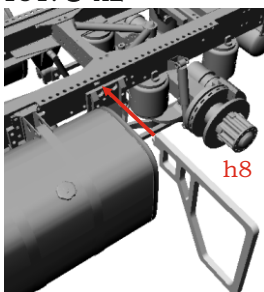

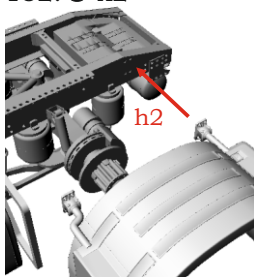

132.  x2

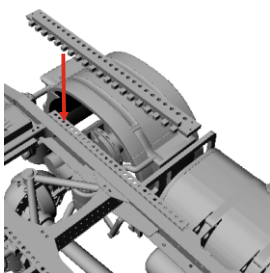

! These parts are from our “Swedish truck (Euro6) kit!

133.  x2



134.  x2

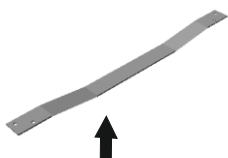

PE-parts #37, 38

135.  x2

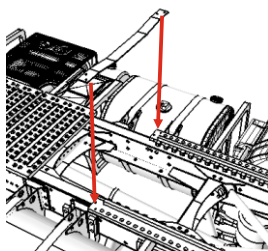

136. 

137. 

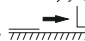
138. 

139.  x2

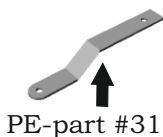

PE-part #31

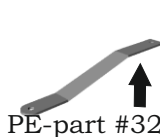
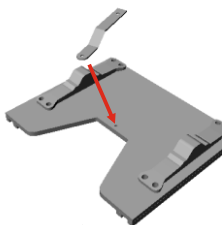

PE-part #32



PE-parts #36, #39

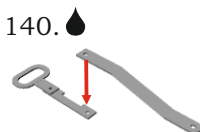

140. 

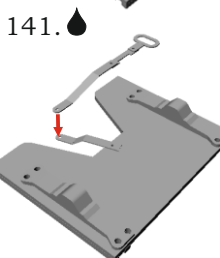

141. 

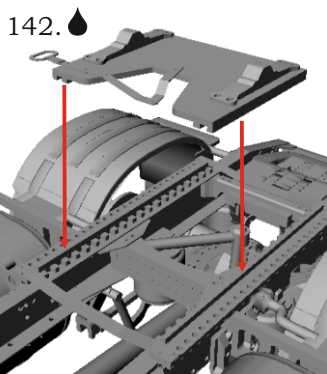

142. 

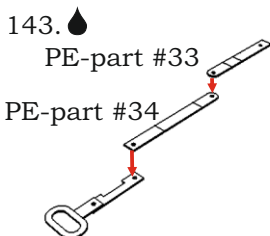

143. 
PE-part #33

PE-part #34

6x2/4 tag chassis for Swedish truck

144. 

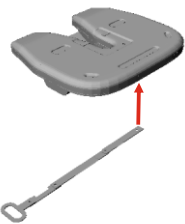

145. 

